

DOUBLE RIB PANEL INSTALLATION DETAILS

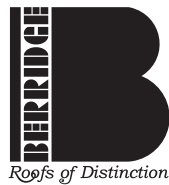
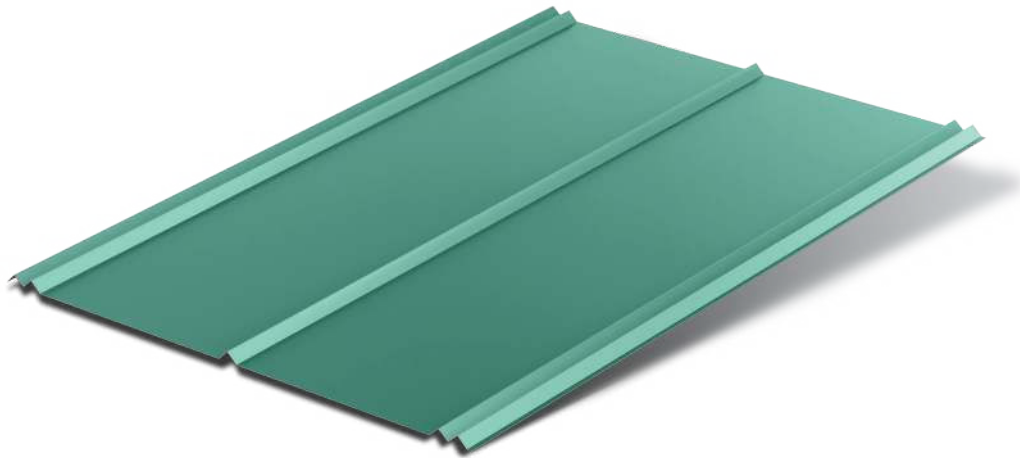

**BERRIDGE
MANUFACTURING
COMPANY**

800-669-0009 • www.Berridge.com

INDEX	DR-0
INDEX	DR-1
INSTALLATION INSTRUCTIONS	DR-1-1
INSTALLATION INSTRUCTIONS	DR-1-2
INSTALLATION INSTRUCTIONS	DR-1-3
INSTALLATION INSTRUCTIONS	DR-1-4
INTRODUCTION TO TYPICAL DETAILS	DR-2
OVERVIEW DOUBLE RIB PANEL	DR-3
FASTENER LOCATIONS	DR-4
FOAM CLOSURE DETAILS	DR-5
EAVE DETAIL;	DR-10
EAVE DETAIL;	DR-11
HIP RIDGE;	DR-20
SHED ROOF RIDGE	DR-21
RIDGE TERMINATION AT DORMER VALLEY	DR-22
GABLE;	DR-30
GABLE;	DR-31
HEAD WALL; WITH PARAPET	DR-40
HEAD WALL; WITH WALL PANEL	DR-41
HEAD WALL; WITH REGLET	DR-42
RAKE WALL; WITH WALL PANEL	DR-50
RAKE WALL; REGLET	DR-51
RAKE WALL; WALL PANEL	DR-52
SLOPE TRANSITION WITH FLASHING	DR-60
VALLEY	DR-70



**Berridge
Manufacturing
Company**

INDEX

DOUBLE RIB PANEL

DATE: 1/15/03

PAGE\FILE
DR-0

ROOF PENETRATION; PIPE PENETRATION
ROOF PENETRATION; SQUARE (PLAN VIEW)
ROOF PENETRATION; SIDE A
ROOF PENETRATION; SIDE B
ROOF PENETRATION; SIDE C

DR-80
DR-81
DR-82
DR-83
DR-84

DATE: 1/15/03

INDEX

PAGE\FILE
DR-1

DOUBLE RIB PANEL



**Berridge
Manufacturing
Company**

- A. BERRIDGE DOUBLE RIB PANEL: PANEL IS FACTORY FABRICATED TO A CONSTANT CORRUGATION DEPTH OF 1/2" AND PANEL COVERAGE OF A NOMINAL 24".
PANELS ARE FABRICATED TO A MINIMUM LENGTH OF 5'-0" AND A MAXIMUM LENGTH OF 40'-0".
- B. MINIMUM SLOPE: THE DOUBLE RIB PANELS ARE RECOMMENDED FOR ROOF SLOPES OF 3 ON 12 OR GREATER. SLOPES LESS CONSULT BERRIDGE MANUFACTURING COMPANY.
- C. MATERIAL STORAGE: CAUTION MUST BE EXERCISED IN STORAGE OF MATERIAL PRIOR TO INSTALLATION. KEEP ALL BERRIDGE PREFINISHED MATERIAL IN A DRY LOCATION WITH ADEQUATE VENTILATION AND OUT OF DIRECT SUNLIGHT.
EXPOSURE TO DIRECT SUNLIGHT AND/OR MOISTURE MAY CAUSE THE FACTORY APPLIED STRIPPABLE PLASTIC FILM TO ADHERE TO THE METAL PERMANENTLY AND DISCOLOR THE FINISH. IF THIS SHOULD OCCUR THE PAINT WARRANTY WILL BE VOID.
- D. STRIPPABLE FILM: THE STRIPPABLE PLASTIC FILM, WHICH IS APPLIED OVER MOST BERRIDGE PREFINISHED PRODUCTS, PANELS, FLASHINGS, COILS AND FLAT SHEETS, PROVIDES PROTECTION OF THE FINISH DURING FABRICATION AND TRANSIT. THIS FILM MUST BE REMOVED PRIOR TO INSTALLATION.
- E. SOLID SHEATHING REQUIREMENTS:
BERRIDGE MANUFACTURING COMPANY RECOMMENDS THE USE OF EITHER BERRIDGE 24 GA. CORRUGATED SHEATHING (NOMINAL 2 1/2" PITCH BY 7/8" DEPTH) OR A MINIMUM OF 1/2" PLYWOOD SHEATHING TO PROVIDE SUFFICIENT HOLDING POWER FOR FASTENERS. CONTACT BERRIDGE MANUFACTURING'S ENGINEERING DEPARTMENT FOR USE OF ANY OTHER TYPE OF SOLID SHEATHING. (# 30 FELT UNDERLAYMENT OR EQUAL MUST BE USED OVER ANY SOLID SHEATHING).
DUE TO # 30 FELTS TENDENCY TO TEAR WHEN USED OVER CORRUGATED DECKING, BERRIDGE MANUFACTURING RECOMMENDS GRACE ICE AND WATERSHIELD OR EQUAL TO BE USED AS AN UNDERLAYMENT FOR ALL CORRUGATED DECKS.
- F. SHEATHING INSPECTION:
1. SHEATHING END JOINTS SHOULD BE STAGGERED.
 2. ALL END JOINTS SHOULD MEET AT EITHER A JOIST OR RAFTER.
 3. BLOCKING OF "H" CLIPS SHOULD BE USED IF JOINTS DO NOT REMAIN FLAT UNDER THE WEIGHT OF WORKMEN.
 4. USE SHIMS TO KEEP ENTIRE SUBSTRATE EVEN; UNEVEN SUBSTRATE WILL RESULT IN "OIL-CANNING" IN THE PANELS. SUBSTRATE SHOULD BE LEVEL TO 1/4" IN 20'-0".
 5. ALL CUTS AT PENETRATIONS SHOULD BE TIGHT, WITHOUT GAPS.
 6. USE WOOD FRAMED CRICKETS AT LARGE PENETRATIONS.
 7. MAKE SURE SUBSTRATE JOINTS ARE TIGHT AT ALL HIPS, VALLEYS AND RIDGES.



**Berridge
Manufacturing
Company**

INSTALLATION INSTRUCTIONS

DOUBLE RIB PANEL

DATE: 1/15/03

PAGE \ FILE
DRI-1

G. FASCIA/RAKE INSPECTION:

1. STRIKE A LINE THE FULL LENGTH OF THE FASCIA OR RAKE. IF NOT STRAIGHT, CORRECT WITH SHIMS.
2. MAKE SURE FASCIA/RAKE IS FLUSH WITH SHEATHING.

H. FELT UNDERLAYMENT: A SINGLE LAYER OF NUMBER THIRTY FELT UNDERLAYMENT (OR EQUAL) MUST BE APPLIED OVER SOLID SHEATHING, AS SHOWN IN THE BERRIDGE MANUFACTURING COMPANY TYPICAL FELTING DETAILS. THE USE OF ADDITIONAL LAYERS OF NUMBER THIRTY FELT IS RECOMMENDED ON LOW SLOPED ROOFS, AT ALL VALLEY CONDITIONS, AT ROOF PENETRATIONS AND AT CERTAIN OTHER FLASHING CONDITIONS AS DEPICTED IN THE DOUBLE RIB PANEL TYPICAL DETAILS.

GRACE ICE AND WATERSHIELD MAY BE REQUIRED ON LOW SLOPED ROOFS OR AT CERTAIN FLASHING CONDITIONS.

I. FELTING INSTALLATION:

1. DO NOT USE RED ROSIN PAPER UNDER METAL ROOFING PANELS.
2. SWEEP ROOF AREA CLEAN.
3. USE FLAT HEAD GALVANIZED ROOFING NAILS 1 1/4" LONG WITH BERRIDGE GALVANIZED FELT CAPS.
4. INSTALL VALLEY FELT FIRST.
5. INSTALL FELT PARALLEL TO THE EAVE, (2 LAYERS REQUIRED AT EAVE) STARTING AT EAVE AND USING MINIMUM 6" LAPS. USE 2 LAYERS OF FELT ON ENTIRE ROOF DECK IF ROOF SLOPE IS 3 ON 12.
6. REFER TO FELTING DETAILS WHEN VALLEYS OR ROOF PENETRATIONS ARE INVOLVED.
7. INSULATE BETWEEN WOOD BLOCKING AND METAL WITH FELT OR GRACE ICE AND WATERSHIELD
8. VERIFY CORRECT METHOD OF INSTALLING ICE AND WATERSHIELD WITH ICE AND WATERSHIELD MANUFACTURE.

J. ELECTROLYSIS: AVOID ALLOWING FLASHINGS AND PANELS TO COME INTO CONTACT WITH EITHER LEAD, COPPER, OR OTHER DISSIMILAR METALS, AND PREVENT EXPOSURE TO WATER RUNDOWN FROM COPPER AND/OR LEAD.

K. SEALANT RECOMMENDATIONS: TREMCO, INC. SPECTREM 1 SILICONE SEALANT.
DO NOT USE CLEAR CAULK.

DATE: 1/15/03

PAGE\FILE

DRI-2

INSTALLATION
INSTRUCTIONS

DOUBLE RIB PANEL



**Berridge
Manufacturing
Company**

- L. FLASHING: IF BERRIDGE MANUFACTURING COMPANY IS TO SUPPLY FLASHING, ALL FLASHINGS WILL BE FABRICATED IN 10'-0" LENGTHS WITH SQUARE END CUTS ONLY. THE PURCHASER MUST PROVIDE ALL DIMENSIONS AND DEGREES OF ANGLE.
- M. FLASHING INSTALLATION:
1. REMOVE STRIPPABLE PLASTIC FILM FROM ALL FLASHINGS PRIOR TO INSTALLATION.
 2. ALWAYS STAGGER JOINTS WHEN ONE FLASHING IS INSTALLED OVER OTHER FLASHINGS.
 3. INSTALL ALL FLASHINGS AS PER BERRIDGE TYPICAL DETAILS.
 4. ALL FLASHINGS ARE TO BE DESIGNED AND INSTALLED TO AVOID TRAPING WATER.
- N. PANELS: BERRIDGE MANUFACTURING COMPANY WILL PROVIDE SQUARE END CUTS ONLY ON ALL DOUBLE RIB PANELS. COMPUTATION OF ALL QUANTITIES AND DIMENSIONS ARE THE RESPONSIBILITY OF THE PURCHASER.
- O. PANEL INSTALLATION:
1. REMOVE STRIPPABLE PLASTIC FILM FROM EACH PANEL PRIOR TO INSTALLATION.
 2. START AT ONE GABLE END OF THE ROOF AND WORK TOWARD THE OTHER GABLE.
 3. EACH PANEL IS TO BE KEPT TIGHT AGAINST THE ADJOINING PANEL. NEVER PERMIT A GAP BETWEEN VERTICAL LAP. ANY CRIMPS OR BENDS MUST BE STRAIGHTENED PRIOR INSTALLATION.
 4. KEEP PANELS ALIGNED SO THAT RIBS MATCH AT HIPS, VALLEYS. DO NOT INSTALL LONG CONTINUOUS RUNS OF PANELS ALL AT ONE TIME WHERE RIB LINES MUST MATCH. INSTALL TEN OR TWELVE PANELS IN ONE ELEVATION AND THEN FOLLOW WITH A LIKE NUMBER OF PANELS ON THE OTHER ELEVATION. WHEN YOU INSTALL PANELS IN THIS MANNER, YOU WILL BE ABLE TO MAKE ANY ADJUSTMENTS REQUIRED TO INSURE RIB MATCHING.
 5. COPPER-COTE,[™] CHAMPAGNE, LEAD-COTE,[™] AND PREWEATHERED GALVALUME[®] PANEL INSTALLATION: NOTE THE SERIES OF ARROWS PAINTED ON THE UNDERSIDE OF THE PANEL. ALL PANELS MUST BE INSTALLED IN A CONSISTENT MANNER, MEANING THAT THE ARROWS ON EVERY PANEL ARE ALL POINTING IN THE SAME DIRECTION. IF A PANEL IS REVERSED (ARROWS POINTING OPPOSITE OF THOSE ON OTHER PANELS) IT WILL APPEAR, FROM A DISTANCE, A DIFFERENT SHADE DUE TO THE GRANULAR EFFECT OF THE PIGMENTS IN THE FINISH. METALLIC FINISHES ARE MATCH - LOT FINISHES. DO NOT MIX LOTS.
- P. FASTENERS: INSTALL FASTENERS AS PER TYPICAL DETAILS. USE #10 HEX HEAD ZINC PLATED FASTENER WITH METAL BACKED NEOPRENE FASTENER WHEN FASTENING TO WOOD. USE #12 HEX HEAD ZINC PLATED FASTENER WITH A METAL BACKED NEOPRENE WASHER WHEN FASTENING TO METAL * WHEN USING POP RIVETS ON FLASHING, STAINLESS STEEL RIVETS ARE RECOMMENDED TO AVOID RUST STAINS.

MAKE SURE ALL FASTENERS ARE DRIVEN STRAIGHT AND SET FLAT. DO NOT OVERDRIVE FASTENERS AS THIS WILL CAUSE THE CLIP AND/OR FLASHINGS TO BUCKLE OR BECOME RECESSED BELOW THE ELEVATION OF THE SUBSTRATE.

* CONSULT BERRIDGE MANUFACTURING'S ENGINEERING DEPARTMENT REGARDING FASTENER SPACING TO MEET DESIGN CRITERIA AND THE USE OF ANY OTHER TYPE OF FASTENER.



INSTALLATION INSTRUCTIONS

DOUBLE RIB PANEL

DATE: 1/15/03

PAGE \ FILE

DRI-3

BERRIDGE MANUFACTURING COMPANY STRIVES TO PROVIDE ITS CUSTOMERS WITH THE HIGHEST QUALITY STRETCHER LEVELED STEEL AVAILABLE. THE LATEST TECHNOLOGY IS ALSO INCORPORATED IN BERRIDGE'S HIGH-PRECISION COIL HANDLING AND ROLL FORMING EQUIPMENT TO MINIMIZE THE STRESS ON METAL DURING PRODUCTION. FURTHERMORE, BERRIDGE UTILIZES HEAVIER 24 GAUGE METAL RATHER THAN 26 GAUGE STEEL OR LIGHT GAUGE ALUMINUM AS OFFERED BY MANY COMPETITORS. ALL THESE MEASURES HAVE BEEN TAKEN TO MINIMIZE THE AMOUNT OF "OIL-CANNING" (WAVINESS) WHICH IS NATURALLY INHERENT IN FLAT SHEET METAL. MANY TIMES, HOWEVER, THE CAUSE OF WAVINESS OR "OIL-CANNING" CAN BE TRACED TO UNEVEN SHEATHING, IMPROPER FELT INSTALLATION, OR, FOOT TRAFFIC ON THE PANELS.

ALL ARCHITECTURAL PANELS REQUIRE CARE IN HANDLING AND INSTALLATION TO AVOID DAMAGING OR DEFORMING THE PANELS.

THESE INSTALLATION INSTRUCTIONS AND THE FOLLOWING TYPICAL DETAILS ARE INTENDED TO PROVIDE OUR CUSTOMERS WITH THE INFORMATION REQUIRED FOR AN AESTHETICALLY PLEASING AND FUNCTIONAL INSTALLATION OF THE BERRIDGE DOUBLE RIB PANEL SYSTEM.

NOTE: ALL PRODUCT SPECIFICATIONS, DETAILS AND INSTALLATION INSTRUCTIONS SUBJECT TO CHANGE WITHOUT NOTICE. FOR SPECIFIC PROJECT DETAILS, CONTACT BERRIDGE.

DATE: 1/15/03

PAGE\FILE
DRI-4

INSTALLATION INSTRUCTIONS

DOUBLE RIB PANEL



**Berridge
Manufacturing
Company**

THE DETAILS CONTAINED IN THE FOLLOWING PAGES ARE MERELY RECOMMENDATIONS AS TO HOW BERRIDGE MANUFACTURING MATERIALS SHOULD BE INSTALLED. THEY MAY REQUIRE ADAPTATIONS OR MODIFICATIONS FOR A SPECIFIC PROJECT AS CONDITIONS VARY IN BOTH BUILDING DESIGN AND LOCAL WEATHER PECULIARITIES.

BERRIDGE MANUFACTURING COMPANY SHALL BE HELD HARMLESS FROM ANY AND ALL CLAIMS ARISING FROM LACK OF WATERTIGHTNESS AS A RESULT OF FOLLOWING THESE RECOMMENDED DETAILS. ENSURING WATERTIGHTNESS ON ANY GIVEN PROJECT IS THE FUNCTION OF THE INSTALLER. THE ARCHITECT/GENERAL CONTRACTOR/INSTALLER MUST ACCEPT THE RESPONSIBILITY TO ADAPT THESE DETAILS TO MEET PARTICULAR BUILDING REQUIREMENTS AND TO ASSURE ADEQUATE WATERTIGHTNESS.

THE INSTALLER CAN VIRTUALLY ASSURE WATERTIGHTNESS IF THESE FLASHING DETAILS HAVE BEEN PROPERLY ADAPTED, ADEQUATE LAPS HAVE BEEN PROVIDED, CORRECT TYPE OF SEALANT USED, ALL JOINTS ADEQUATELY CAULKED, AND PROFESSIONAL WORKMANSHIP EMPLOYED.



**Berridge
Manufacturing
Company**

INTRODUCTION TO
TYPICAL DETAILS

DOUBLE RIB PANEL

DATE: 1/15/03

PAGE\FILE
DR-2

BERRIDGE DOUBLE RIB PANEL

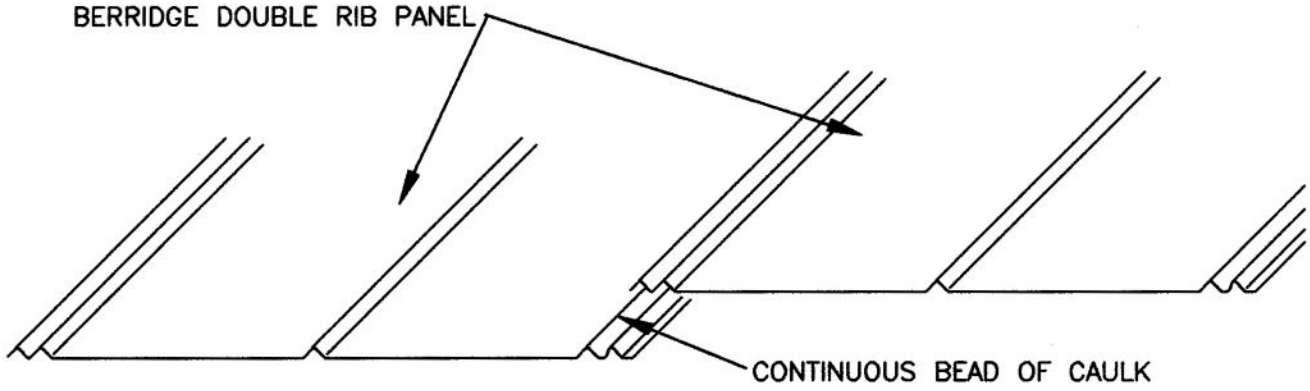

CONTINUOUS BEAD OF CAULK

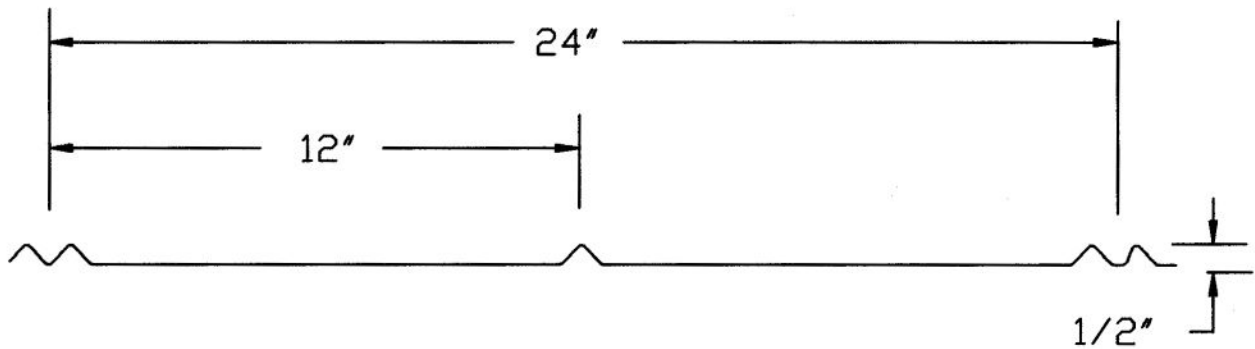

OVERVIEW DOUBLE RIB PANEL

BERRIDGE
DOUBLE RIB PANEL

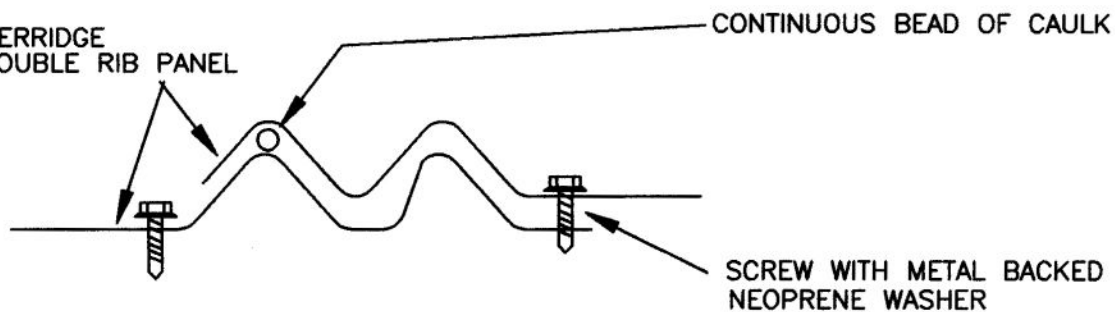

CONTINUOUS BEAD OF CAULK

SCREW WITH METAL BACKED
NEOPRENE WASHER

SIDE LAP DETAIL (TYPICAL)



Berridge
Manufacturing
Company

OVERVIEW

DOUBLE RIB PANEL

DATE: 1/15/03

PAGE\FILE
DR-3

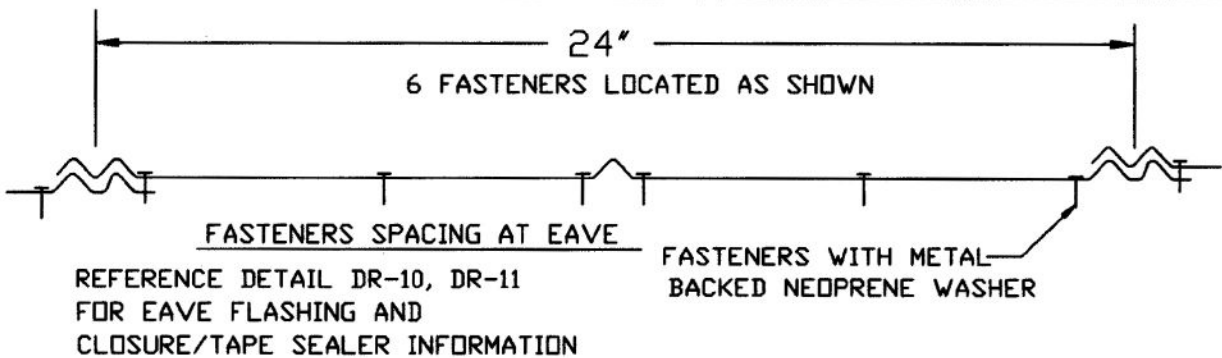
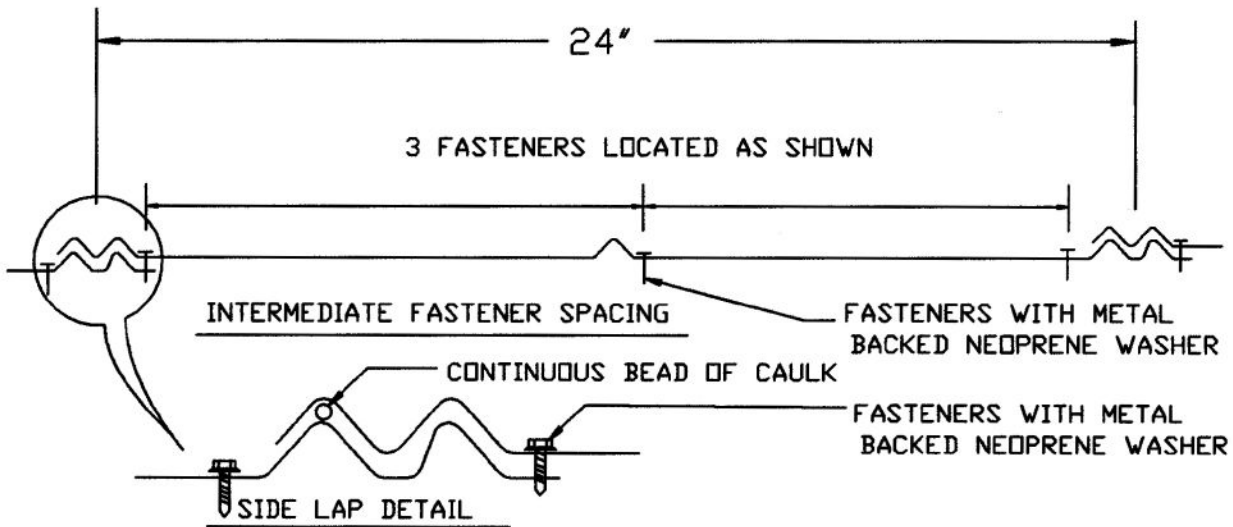
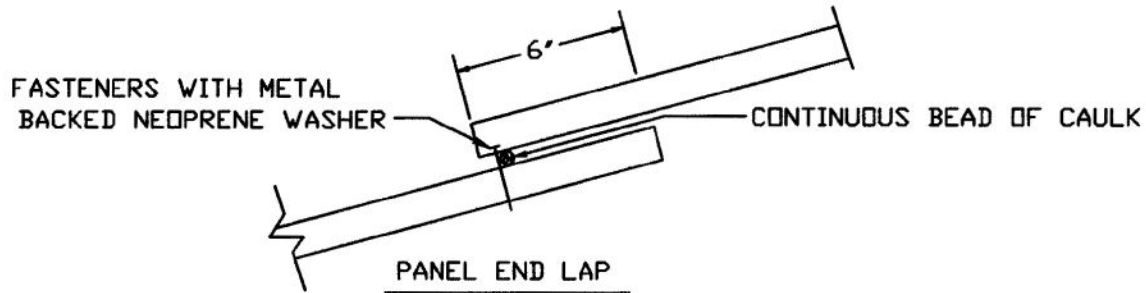
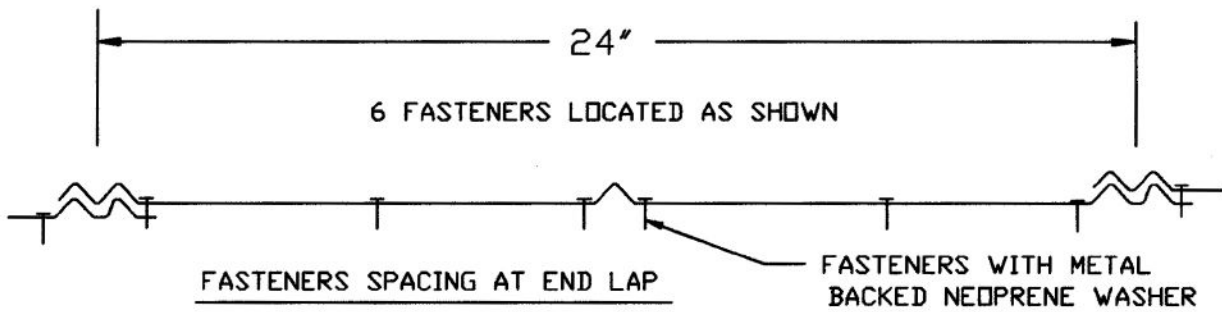

DATE: 1/15/03

FASTENER LOCATIONS

PAGE\FILE
DR-4

DOUBLE RIB PANEL



Berridge
Manufacturing
Company

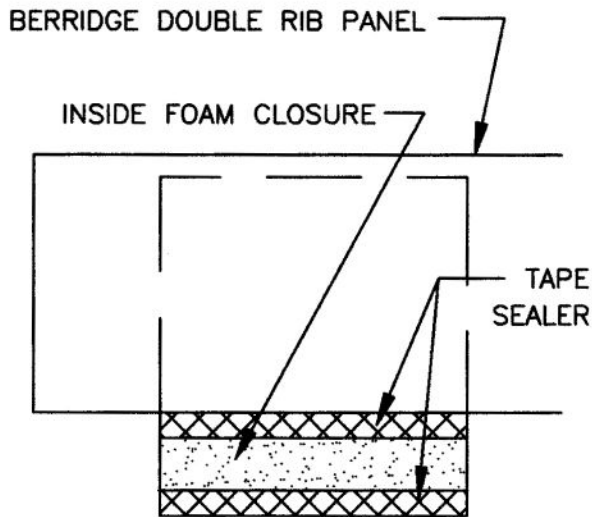

USE THIS DETAIL AT EAVE, AND USE THIS DETAIL WHEN PANEL EDGE IS AT 90° TO PANEL RIB.

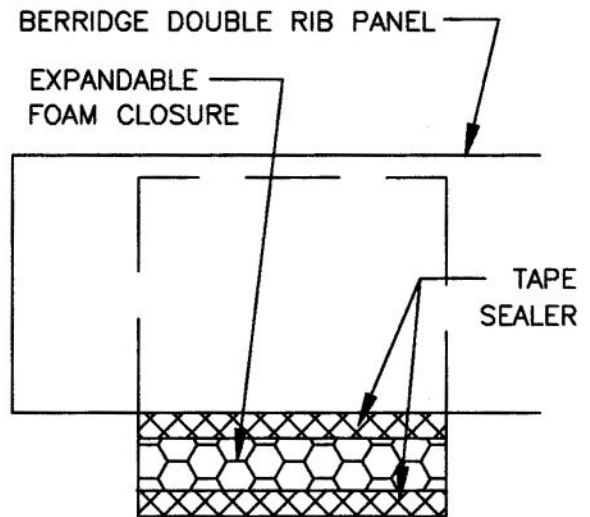

USE THIS DETAIL AT THE VALLEY, AND USE THIS DETAIL WHEN PANEL EDGE IS AT AN ANGLE OTHER THAN 90° TO PANEL RIB (SKEWED CONDITIONS).

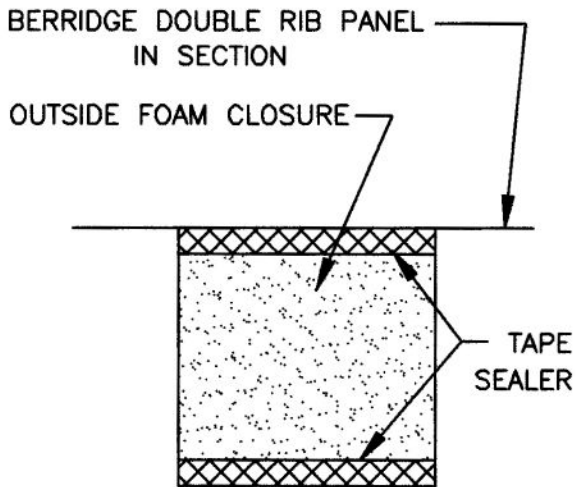

USE THIS DETAIL AT THE RIDGE, HEADWALL, AND WHEN PANEL EDGE IS AT 90° TO PANEL RIB.

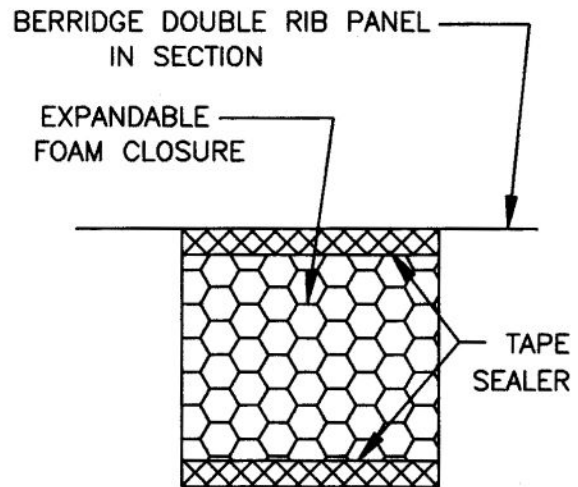

USE THIS DETAIL AT THE HIP, AND USE THIS DETAIL WHEN PANEL EDGE IS AT AN ANGLE OTHER THAN 90° TO PANEL RIB (SKEWED CONDITIONS).



**Berridge
Manufacturing
Company**

FOAM CLOSURE DETAILS

DOUBLE RIB PANEL

DATE: 1/15/03

PAGE\FILE

DR-5

BERRIDGE DOUBLE RIB PANEL

INSIDE FOAM CLOSURE WITH TAPE SEALER TOP & BOTTOM

PANEL FASTENER WITH METAL BACKED NEOPRENE WASHER

EAVE FLASHING, 4" END LAPS WITH CONTINUOUS CAULK AT LAPS

30 FELT UNDERLAYMENT

FASTENERS, 20" O.C. MAX.

SOLID SHEATHING

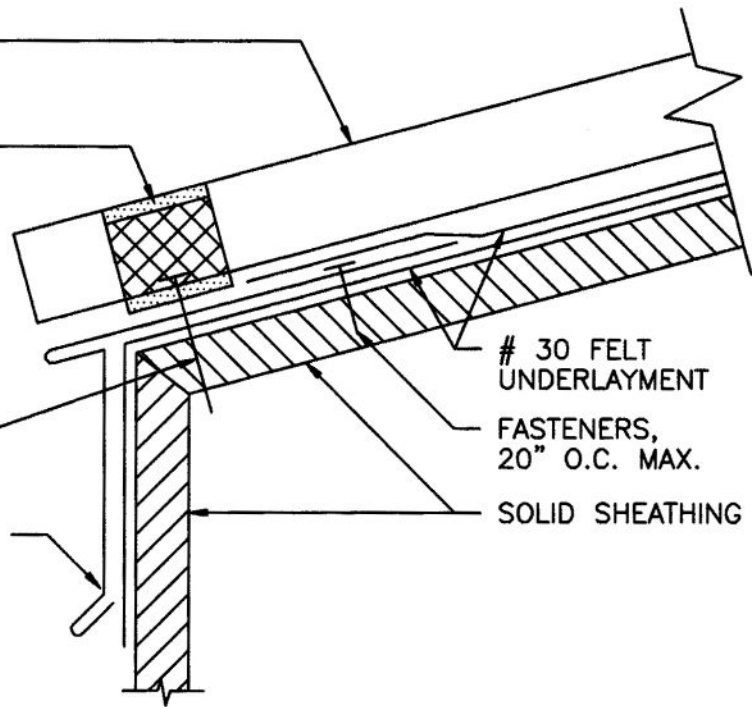

1. SOLID SHEATHING (BY OTHERS) TO BE MINIMUM 1/2" PLYWOOD OR EQUIVALENT IN STRENGTH FOR HOLDING POWER OF FASTENERS.
2. ALL FELT UNDERLAYMENT, CAULKING AND FASTENERS ARE ITEMS TO BE FURNISHED AND INSTALLED BY THE ROOFING INSTALLER AT THE DISCRETION OF THE ARCHITECT.

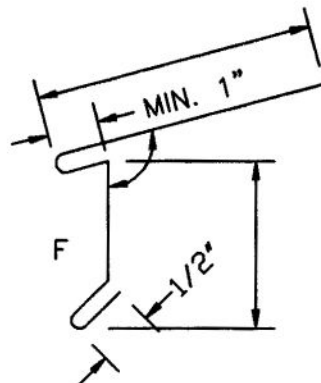

F = FINISH SIDE

EAVE FLASHING



**Berridge
Manufacturing
Company**

EAVE DETAIL
SOLID SHEATHING

DOUBLE RIB PANEL

DATE: 1/15/03

PAGE\FILE

DR-10

BERRIDGE DOUBLE RIB PANEL

INSIDE FOAM CLOSURE WITH TAPE SEALER TOP & BOTTOM

PANEL FASTENER WITH METAL BACKED NEOPRENE WASHER

EAVE FLASHING, 4" END LAPS WITH CONTINUOUS CAULK AT LAPS

BERRIDGE WALL PANEL

30# FELT UNDERLAYMENT

FASTENERS, 20" O.C. MAX.

SOLID SHEATHING

30# FELT UNDERLAYMENT

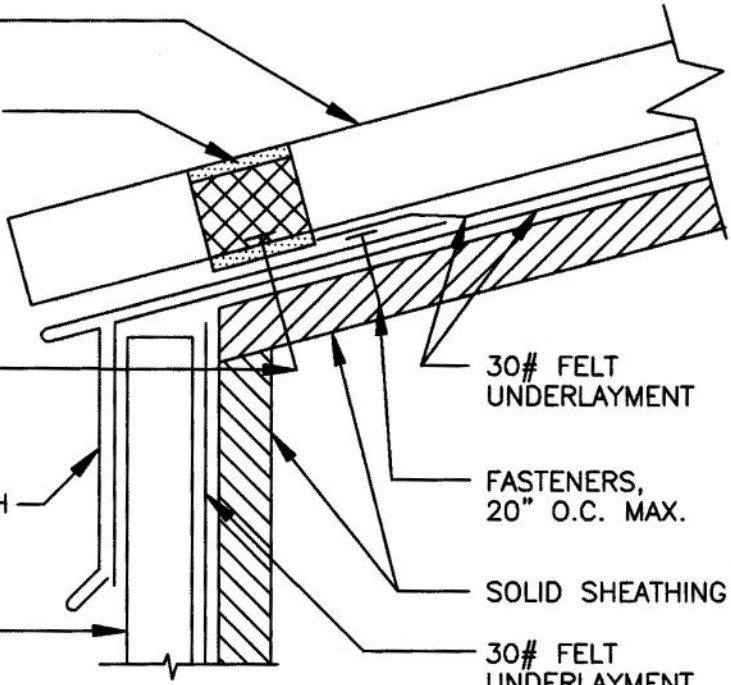

1. SOLID SHEATHING (BY OTHERS) TO BE MINIMUM 1/2" PLYWOOD OR EQUIVALENT IN STRENGTH FOR HOLDING POWER OF FASTENERS.
2. ALL FELT UNDERLAYMENT, CAULKING AND FASTENERS ARE ITEMS TO BE FURNISHED AND INSTALLED BY THE ROOFING INSTALLER AT THE DISCRETION OF THE ARCHITECT.

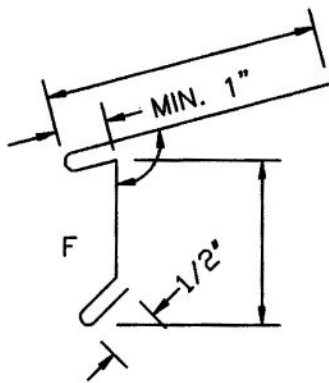

F = FINISH SIDE

EAVE FLASHING

DATE: 1/15/03

PAGE\FILE
DR-II

EAVE DETAIL
SOLID SHEATHING

DOUBLE RIB PANEL



Berridge
Manufacturing
Company

RIDGE/HIP CAP; 4" END LAPS WITH CONTINUOUS CAULK AT LAPS. POP RIVET AT LAPS AND CAULK RIVET HEADS.

BERRIDGE DOUBLE RIB PANEL

PANEL FASTENER WITH METAL BACKED NEOPRENE WASHER

FASTENERS WITH METAL BACKED NEOPRENE WASHER 20" O.C.

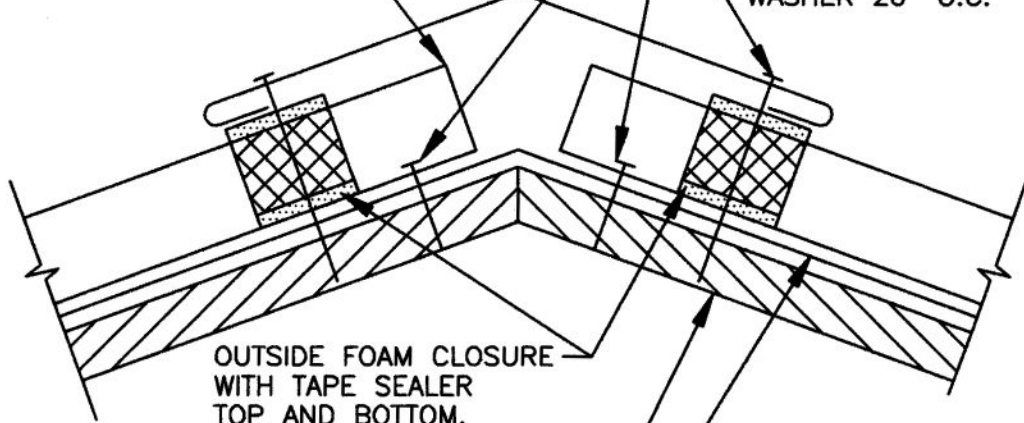

OUTSIDE FOAM CLOSURE WITH TAPE SEALER TOP AND BOTTOM. USE EXPANDABLE FOAM CLOSURE WITH TAPE SEALER TOP AND BOTTOM AT HIP

30 FELT UNDERLAYMENT
SOLID SHEATHING

1. SOLID SHEATHING (BY OTHERS) TO BE MINIMUM 1/2" PLYWOOD OR EQUIVALENT IN STRENGTH FOR HOLDING POWER OF FASTENERS.
2. ALL FELTING UNDERLAYMENT, CAULKING, AND FASTENERS, ARE ITEMS TO BE FURNISHED AND INSTALLED BY THE ROOFING INSTALLER AT THE DISCRETION OF THE ARCHITECT.

F = FINISH SIDE

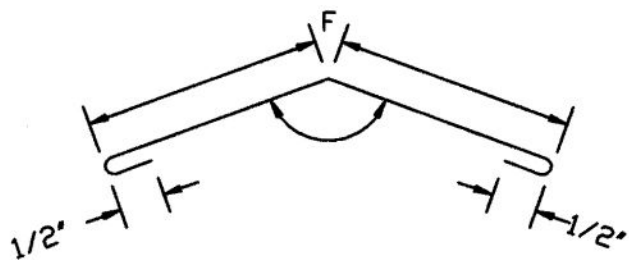

RIDGE/HIP CAP

BERRIDGE
B Berridge
 Manufacturing
 Company
Roofs of Distinction

RIDGE AND HIP DETAIL

DATE: 1/15/03

DOUBLE RIB PANEL

PAGE\FILE
DR-20

RIDGE CAP; 4" END LAPS WITH CONTINUOUS CAULK AT LAPS. POP RIVET AT LAPS AND CAULK RIVET HEADS.

BERRIDGE DOUBLE RIB PANEL

FASTENERS WITH METAL BACKED NEOPRENE WASHER 20" O.C.

OUTSIDE FOAM CLOSURE WITH TAPE SEALER TOP AND BOTTOM

PANEL FASTENER WITH METAL BACKED NEOPRENE WASHER

FASTENER WITH METAL BACKED NEOPRENE WASHER. 40" O.C. MAX

30 FELT UNDERLAYMENT LAP FELT OVER RIDGE

SOLID SHEATHING

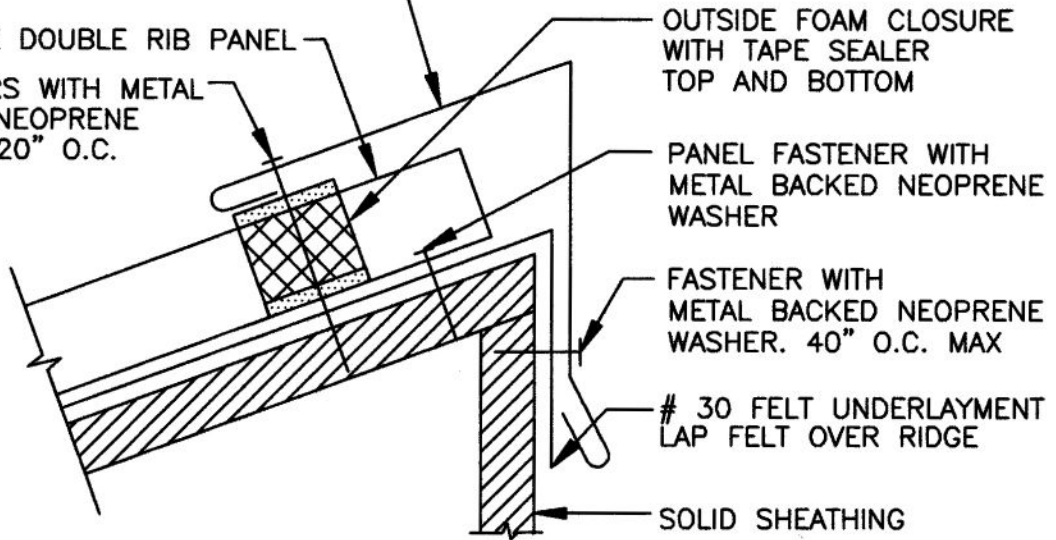

1. SOLID SHEATHING (BY OTHERS) TO BE MINIMUM 1/2" PLYWOOD OR EQUIVALENT IN STRENGTH FOR HOLDING POWER OF FASTENERS.
2. ALL FELTING UNDERLAYMENT, CAULKING, AND FASTENERS, ARE ITEMS TO BE FURNISHED AND INSTALLED BY THE ROOFING INSTALLER AT THE DISCRETION OF THE ARCHITECT.

F = FINISH SIDE

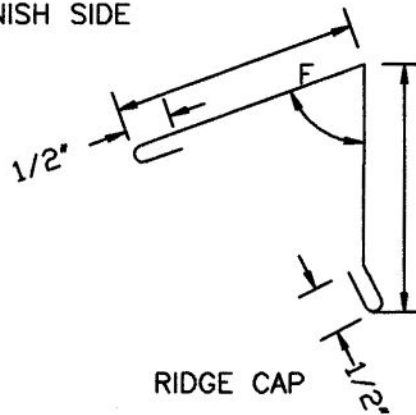

RIDGE CAP

DATE: 1/15/03

SHED ROOF RIDGE
CAP DETAIL

PAGE\FILE
DR-21

DOUBLE RIB PANEL



**Berridge
Manufacturing
Company**

SECTION VIEW

FIELD FORM END OF RIDGE FLASHING
AND EXTEND UNDER UPPER PANEL

RIDGE FLASHING; 4" END LAPS
WITH CONTINUOUS CAULK AT LAPS

FIELD TAPERED OUTSIDE CLOSURE

BERRIDGE DOUBLE RIB
PANEL

EXPANDABLE FOAM
CLOSURE WITH TAPE
SEALER TOP AND BOTTOM

DR-20

30 FELT
UNDERLAYMENT

PANEL FASTENER WITH
METAL BACKED
NEOPRENE WASHER

SOLID SHEATHING

VALLEY FLASHING; 12" LAPS WITH
CONTINUOUS CAULK AT LAPS

PLAN VIEW

MAIN ROOF
PANELS

RIDGE FLASHING

INSIDE FOAM CLOSURE

VALLEY FLASHING

DORMER PANEL

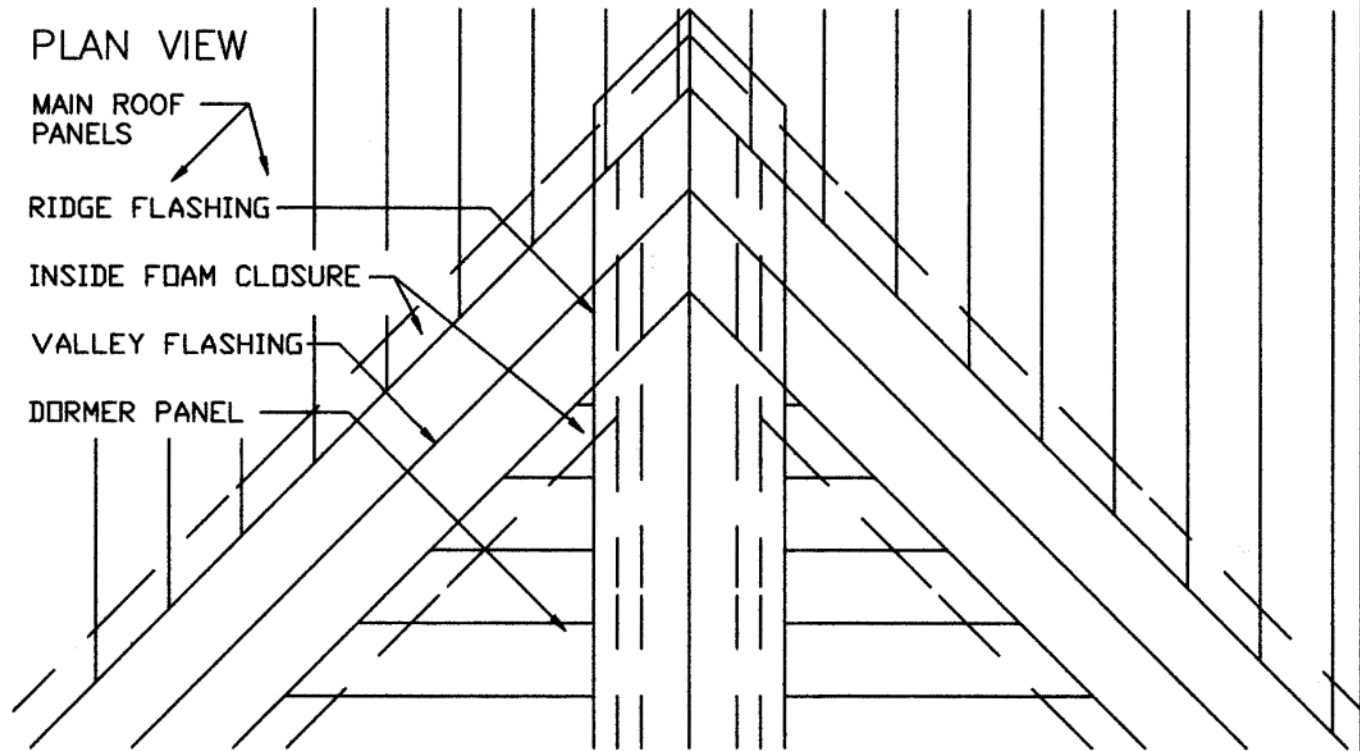

**Berridge
Manufacturing
Company**

Roofs of Distinction

RIDGE TERMINATION
AT DORMER VALLEY

DOUBLE RIB PANEL

DATE: 1/15/03

PAGE\FILE

DR-22

GABLE CHANNEL 4" END LAPS WITH CONTINUOUS CAULK AT LAPS

CONTINUOUS BEAD OF CAULK

1/2"

GABLE FLASHING; 4" END LAPS WITH CONTINUOUS CAULK AT LAPS

FASTENER WITH METAL BACKED NEOPRENE WASHER 20" O.C.

BERRIDGE DOUBLE RIB PANEL

FASTENERS; 20" O.C. MAX.

30 FELT UNDERLAYMENT

TOP LAYER OF FELT TO BE PARALLEL WITH ROOF SLOPE

FASTENERS; 20" O.C. MAX.

SOLID SHEATHING

1. SOLID SHEATHING (BY OTHERS) TO BE MINIMUM 1/2" PLYWOOD OR EQUIVALENT IN STRENGTH FOR HOLDING POWER OF FASTENERS.

2. ALL FELT UNDERLAYMENT, CAULKING, AND FASTENERS, ARE ITEMS TO BE FURNISHED AND INSTALLED BY THE ROOFING INSTALLER AT THE DISCRETION OF THE ARCHITECT.

F = FINISH SIDE

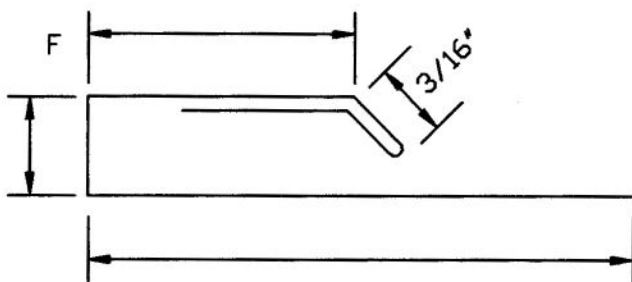

GABLE CHANNEL

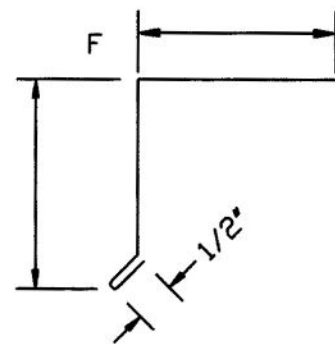

GABLE FLASHING



**Berridge
Manufacturing
Company**

GABLE DETAIL

DOUBLE RIB PANEL

DATE: 1/15/03

PAGE\FILE

DR-30

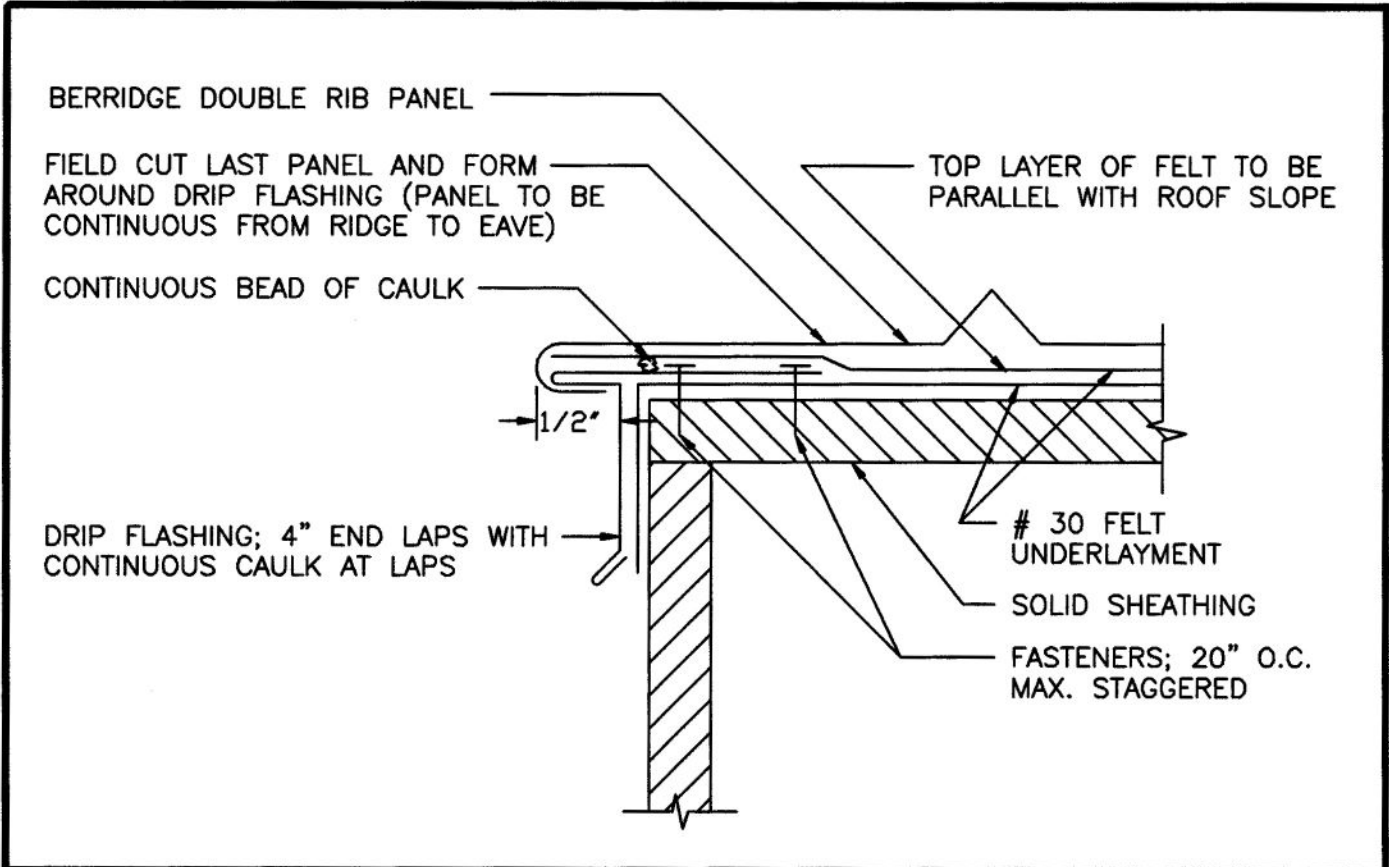

1. FIELD CUT AND FORM LAST PANEL AROUND DRIP FLASHING. PANEL MUST BE CONTINUOUS FROM RIDGE TO EAVE.
2. SOLID SHEATHING (BY OTHERS) TO BE MINIMUM 1/2" PLYWOOD OR EQUIVALENT IN STRENGTH FOR HOLDING POWER OF FASTENERS.
3. ALL FELT UNDERLAYMENT, CAULKING, AND FASTENERS, ARE ITEMS TO BE FURNISHED AND INSTALLED BY THE ROOFING INSTALLER AT THE DISCRETION OF THE ARCHITECT.

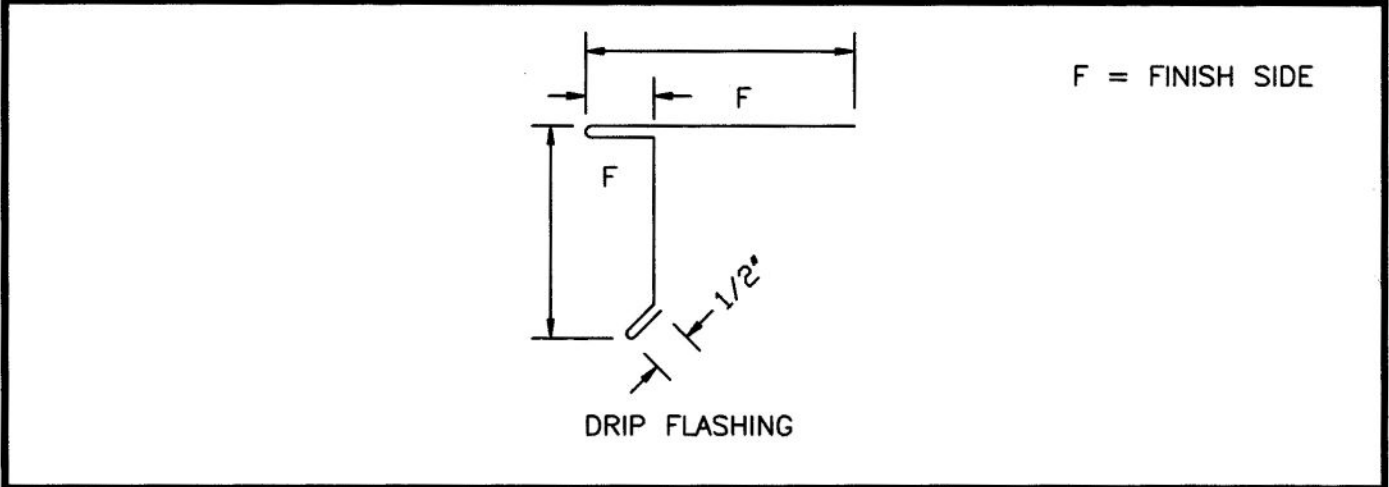

DATE: 1/15/03

PAGE\FILE
DR-31

GABLE DETAIL

DOUBLE RIB PANEL

Berridge
Manufacturing
Company

Roofs of Distinction

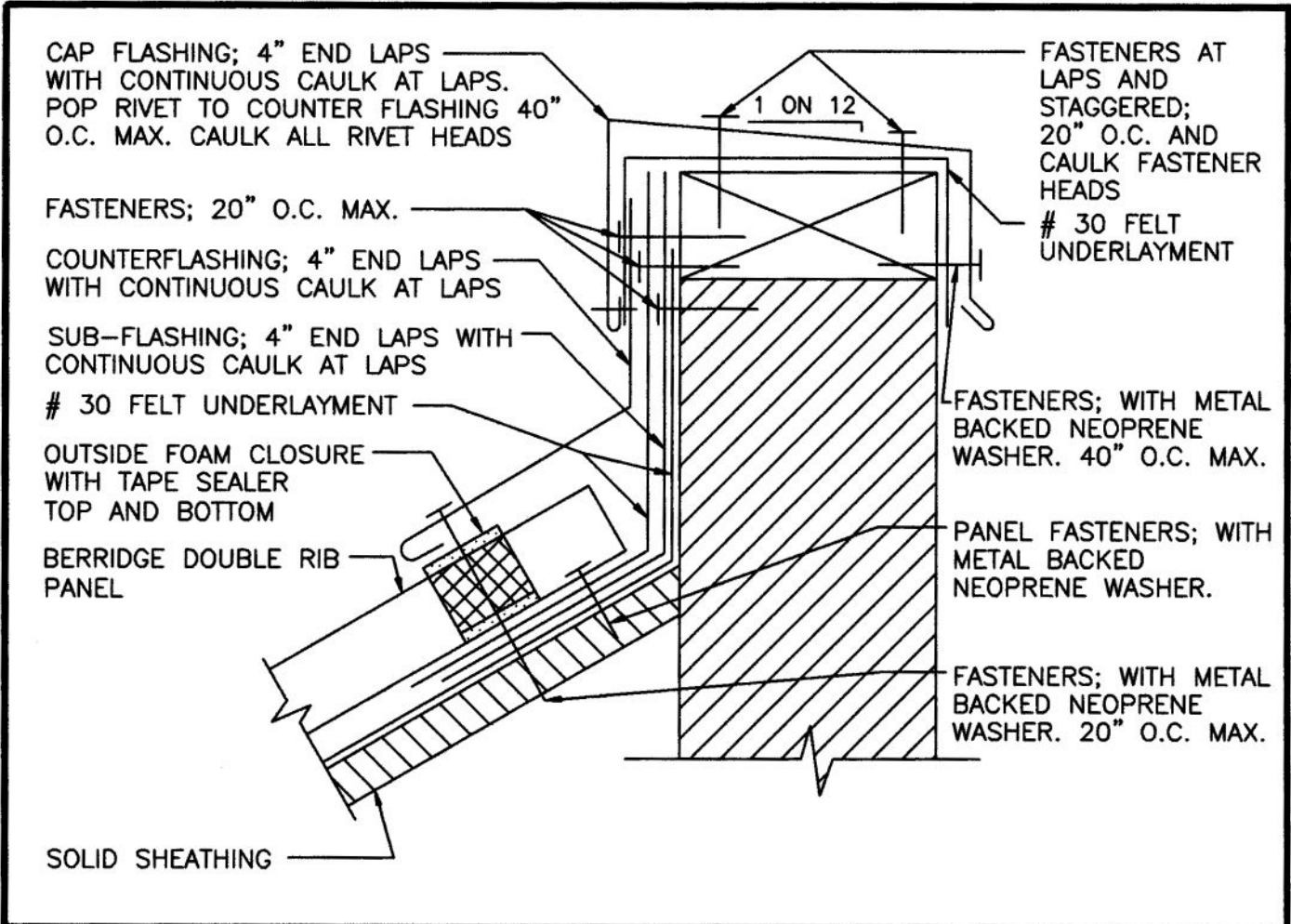

1. SOLID SHEATHING (BY OTHERS) TO BE MINIMUM 1/2" PLYWOOD OR EQUIVALENT IN STRENGTH FOR HOLDING POWER OF FASTENERS.
2. ALL FELT UNDERLAYMENT, CAULKING, AND FASTENERS, ARE ITEMS TO BE FURNISHED AND INSTALLED BY THE ROOFING INSTALLER AT THE DISCRETION OF THE ARCHITECT.

F = FINISH SIDE

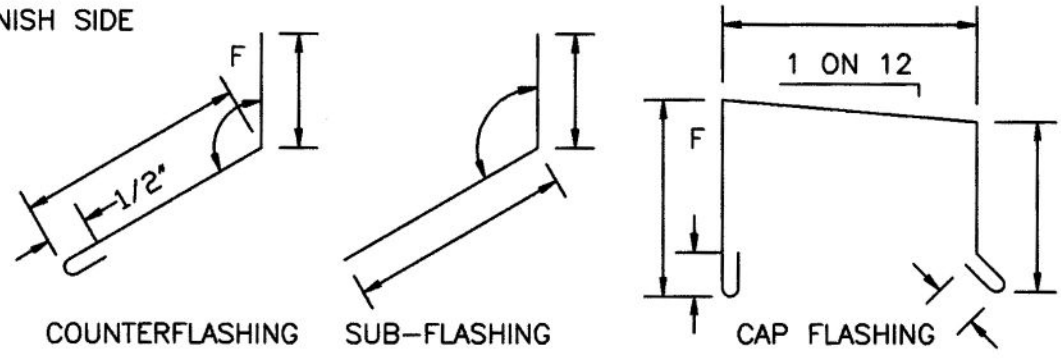

BERRIDGE
B
 Berridge
 Manufacturing
 Company
Roofs of Distinction

PARAPET DETAIL

DOUBLE RIB PANEL

DATE: 1/15/03

PAGE\FILE
DR-40

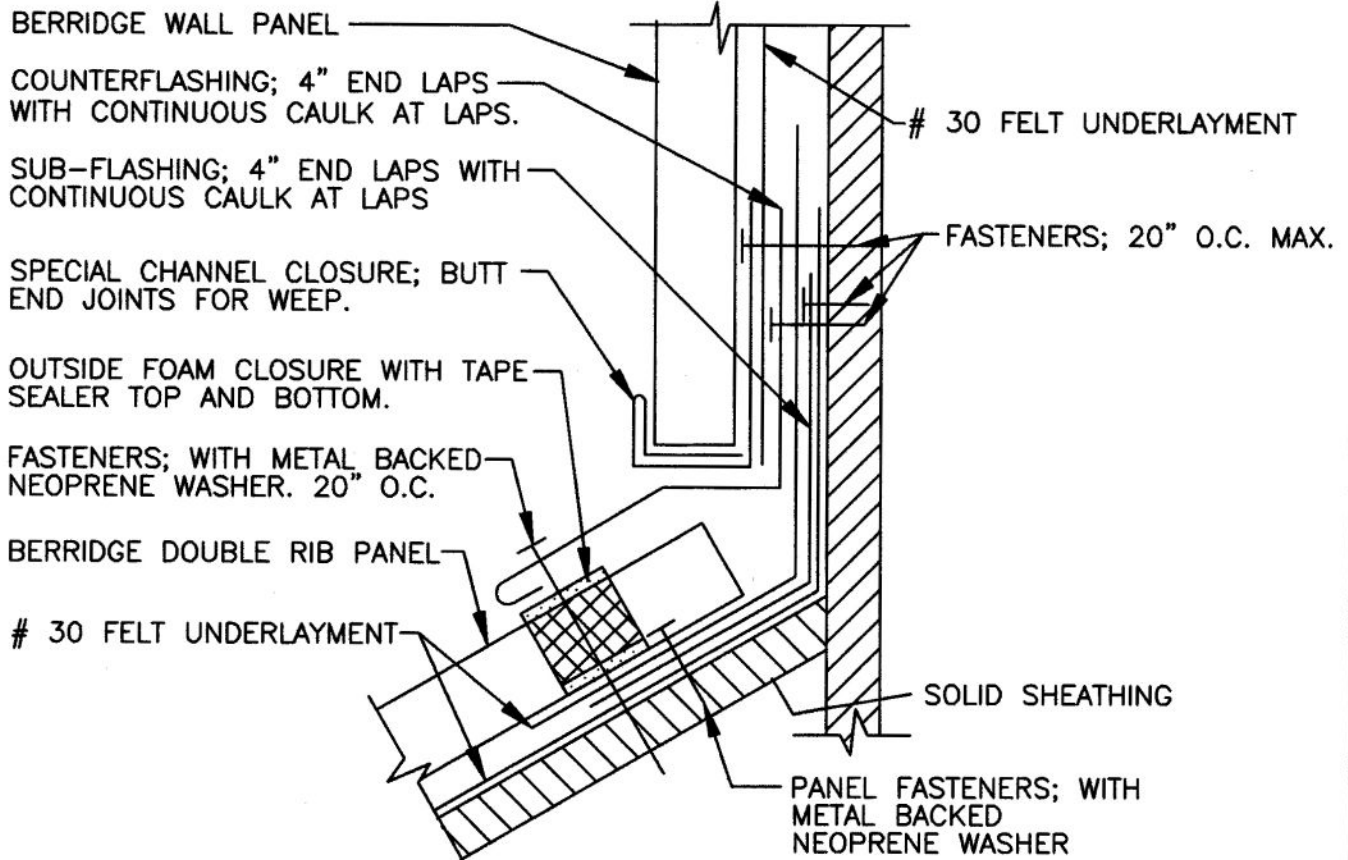

1. SOLID SHEATHING (BY OTHERS) TO BE MINIMUM 1/2" PLYWOOD OR EQUIVALENT IN STRENGTH FOR HOLDING POWER OF FASTENERS.
2. ALL FELT UNDERLAYMENT, CAULKING, AND FASTENERS, ARE ITEMS TO BE FURNISHED AND INSTALLED BY THE ROOFING INSTALLER AT THE DISCRETION OF THE ARCHITECT.

F = FINISH SIDE

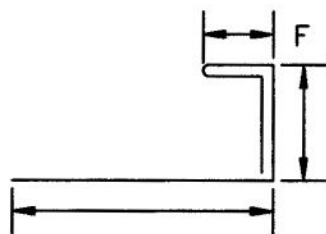

SPECIAL CHANNEL

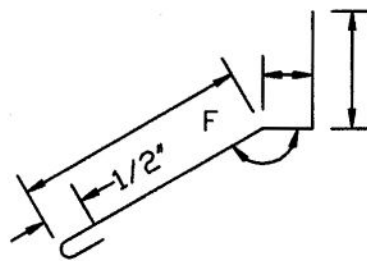

COUNTERFLASHING

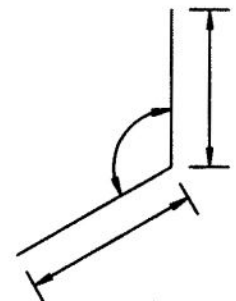

SUB-FLASHING

DATE: 1/15/03

HEAD WALL DETAIL

PAGE \ FILE

DR-41

DOUBLE RIB PANEL



**Berridge
Manufacturing
Company**

REGLET FLASHING; 4" END LAPS WITH CONTINUOUS CAULK AT LAPS

FASTENERS; 20" O.C. MAX.

COUNTERFLASHING; 4" END LAPS WITH CONTINUOUS CAULK AT LAPS.

SUB-FLASHING; 4" END LAPS WITH CONTINUOUS CAULK AT LAPS

BERRIDGE DOUBLE RIB PANEL

OUTSIDE FOAM CLOSURE WITH TAPE SEALER TOP AND BOTTOM.

#30 FELT UNDERLAYMENT

SOLID SHEATHING

REGLET

CONTINUOUS CAULK AT REGLET

CONTINUOUS BEAD OF CAULK

PANEL FASTENERS WITH METAL BACKED NEOPRENE WASHER.

FASTENERS WITH METAL BACKED NEOPRENE WASHER. 20" O.C.

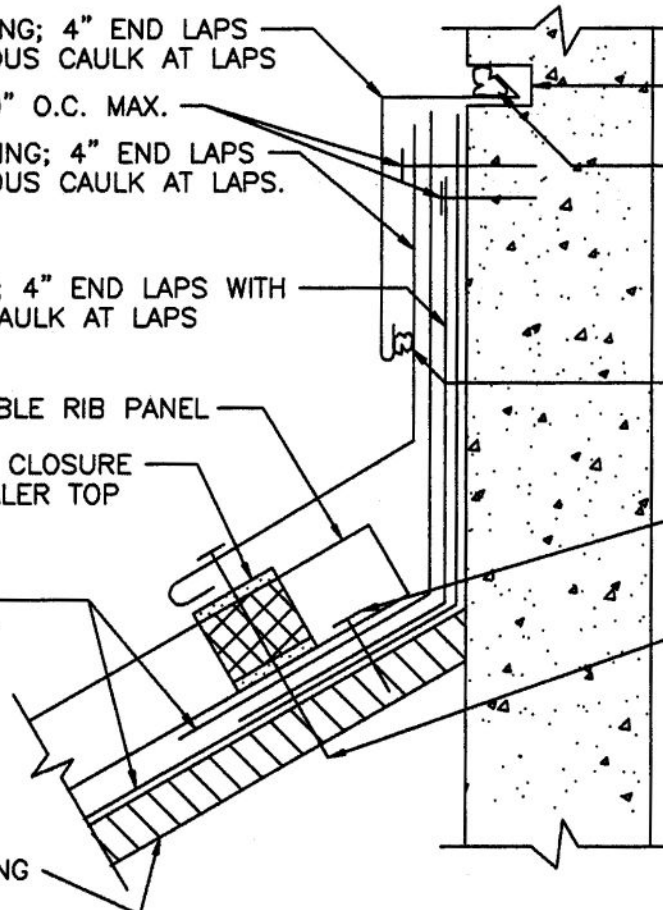

1. SOLID SHEATHING (BY OTHERS) TO BE MINIMUM 1/2" PLYWOOD OR EQUIVALENT IN STRENGTH FOR HOLDING POWER OF FASTENERS.
2. ALL FELT UNDERLAYMENT, CAULKING, AND FASTENERS, ARE ITEMS TO BE FURNISHED AND INSTALLED BY THE ROOFING INSTALLER AT THE DISCRETION OF THE ARCHITECT.

F = FINISH SIDE

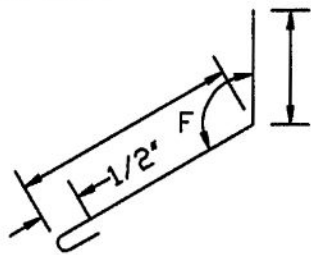

COUNTERFLASHING

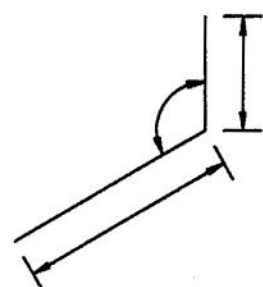

SUB-FLASHING

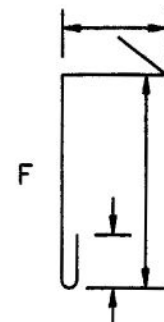

REGLET FLASHING



**Berridge
Manufacturing
Company**

Roofs of Distinction

HEAD WALL DETAIL

DOUBLE RIB PANEL

DATE: 1/15/03

PAGE\FILE

DR-42

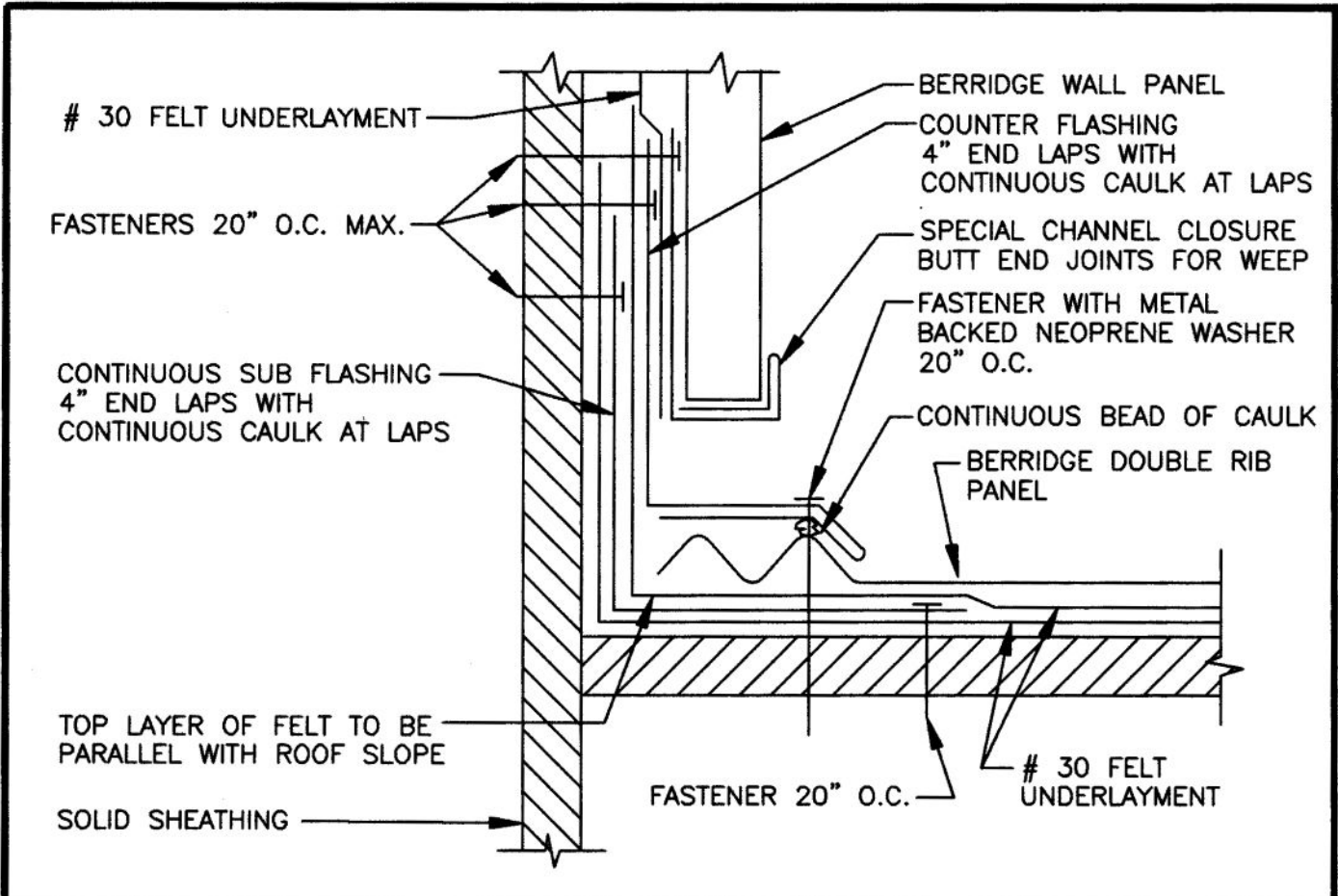

1. SOLID SHEATHING (BY OTHERS) TO BE MINIMUM 1/2" PLYWOOD OR EQUIVALENT IN STRENGTH FOR HOLDING POWER OF FASTENERS.
2. ALL FELT UNDERLAYMENT, CAULKING, AND FASTENERS, ARE ITEMS TO BE FURNISHED AND INSTALLED BY THE ROOFING INSTALLER AT THE DISCRETION OF THE ARCHITECT.

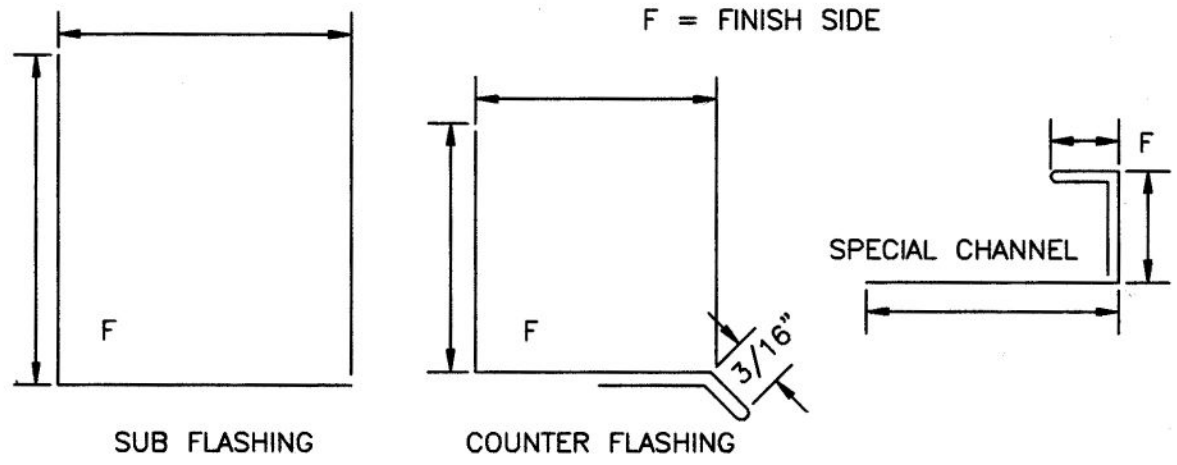

RAKE WALL
 WITH WALL PANEL
DOUBLE RIB PANEL

DATE: 1/15/03
 PAGE\FILE
DR-50

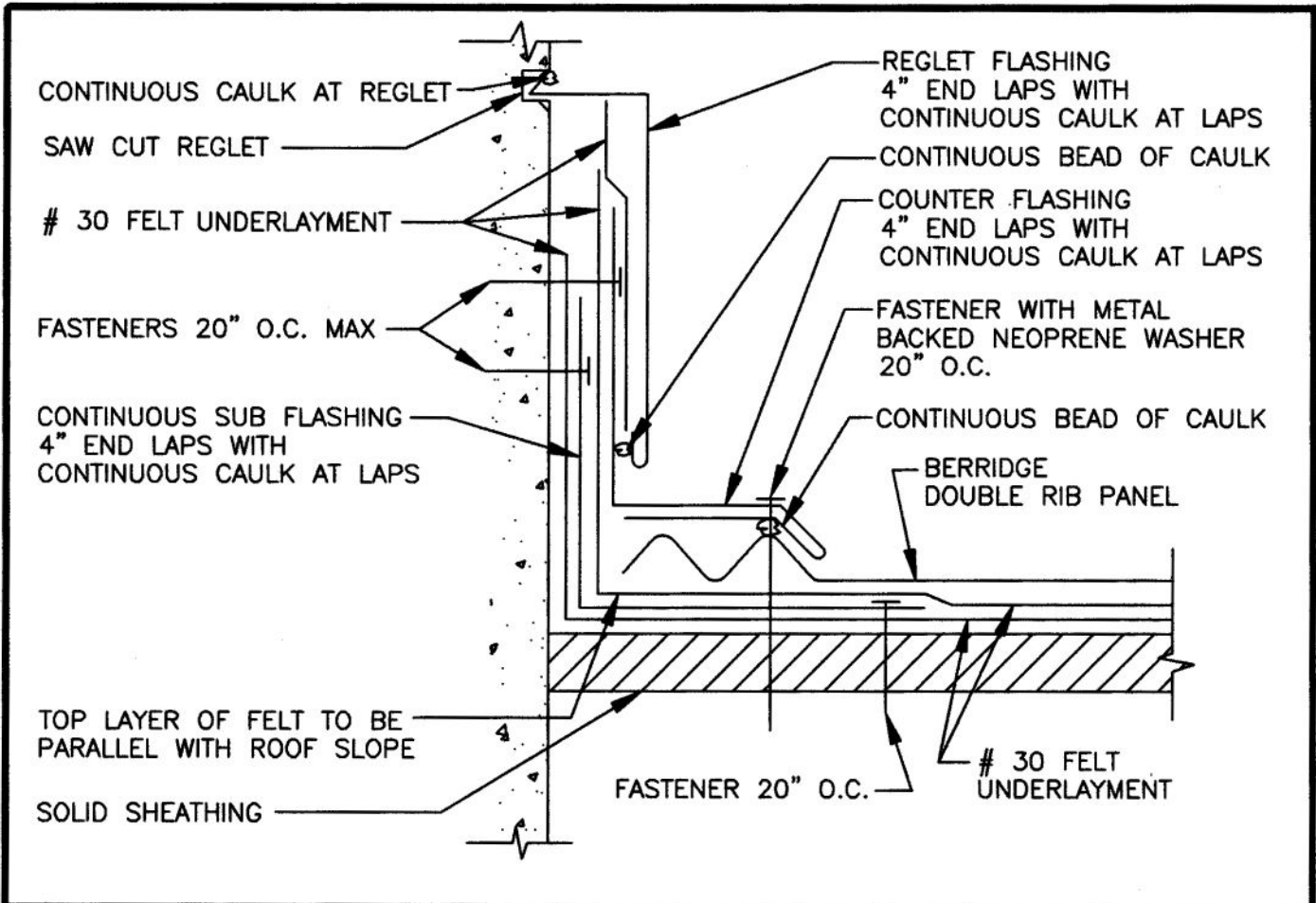

1. SOLID SHEATHING (BY OTHERS) TO BE MINIMUM 1/2" PLYWOOD OR EQUIVALENT IN STRENGTH FOR HOLDING POWER OF FASTENERS.
2. ALL FELT UNDERLAYMENT, CAULKING, AND FASTENERS, ARE ITEMS TO BE FURNISHED AND INSTALLED BY THE ROOFING INSTALLER AT THE DISCRETION OF THE ARCHITECT.

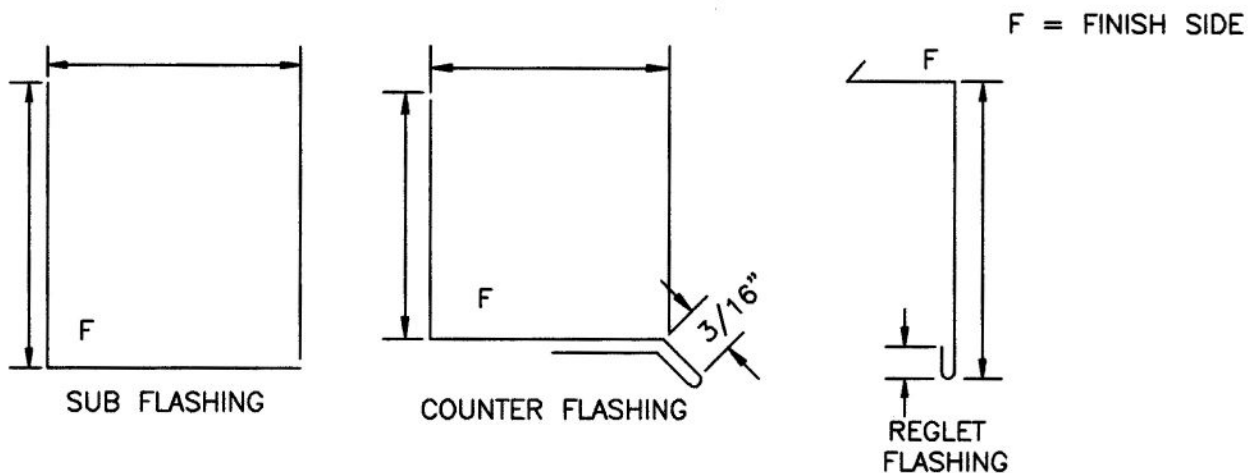

DATE: 1/15/03

PAGE\FILE
DR-51

RAKE WALL DETAIL
WITH REGLET

DOUBLE RIB PANEL

BERRIDGE
B
Berridge
Manufacturing
Company
Roofs of Distinction

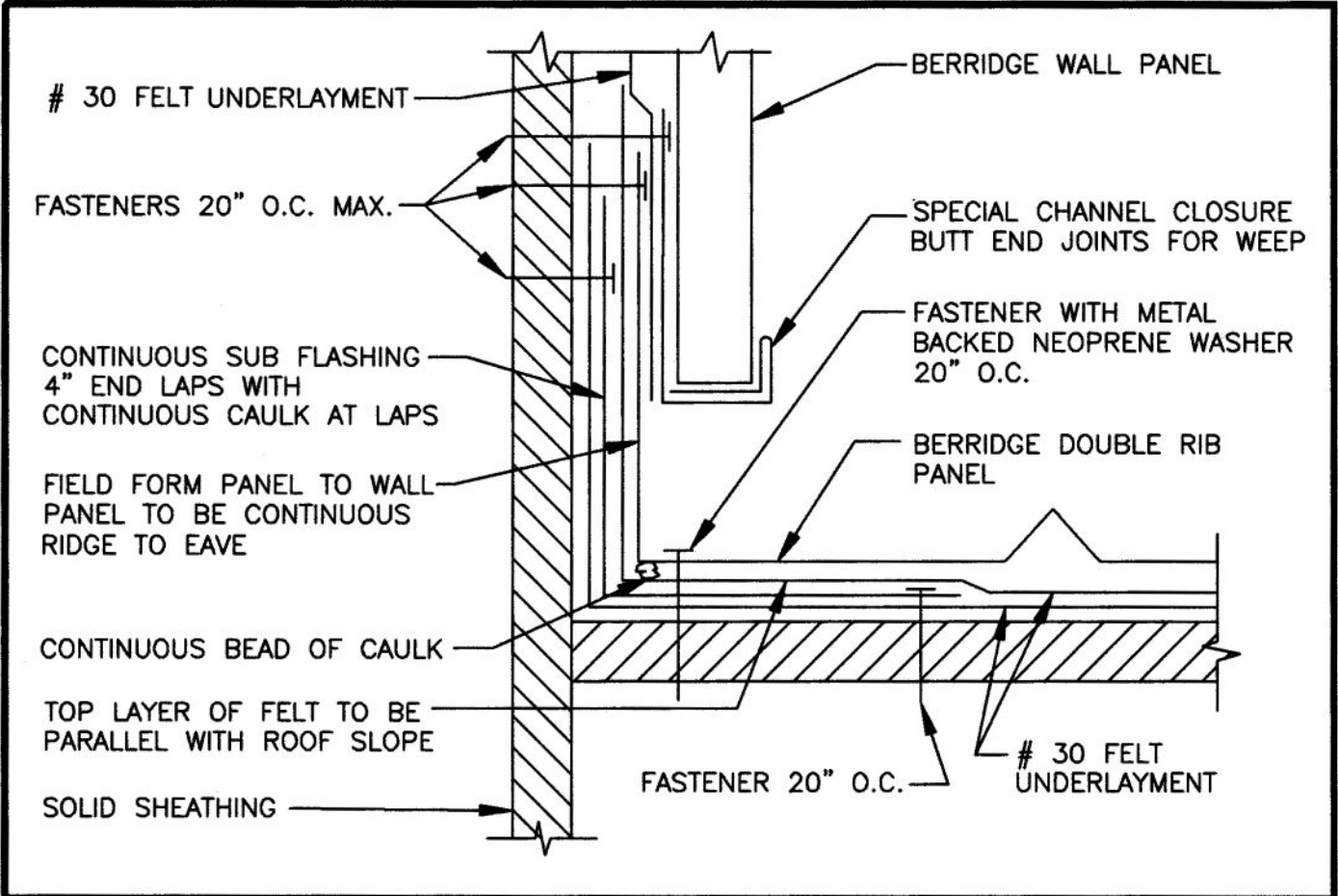

1. SOLID SHEATHING (BY OTHERS) TO BE MINIMUM 1/2" PLYWOOD OR EQUIVALENT IN STRENGTH FOR HOLDING POWER OF FASTENERS.
2. ALL FELT UNDERLAYMENT, CAULKING, AND FASTENERS, ARE ITEMS TO BE FURNISHED AND INSTALLED BY THE ROOFING INSTALLER AT THE DISCRETION OF THE ARCHITECT.

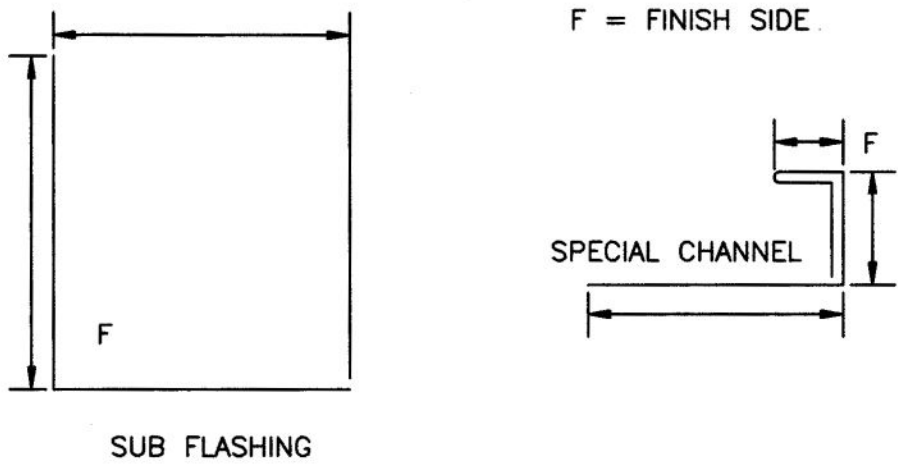

RAKE WALL
 WITH WALL PANEL
DOUBLE RIB PANEL

DATE: 1/15/03
 PAGE\FILE
DR-52

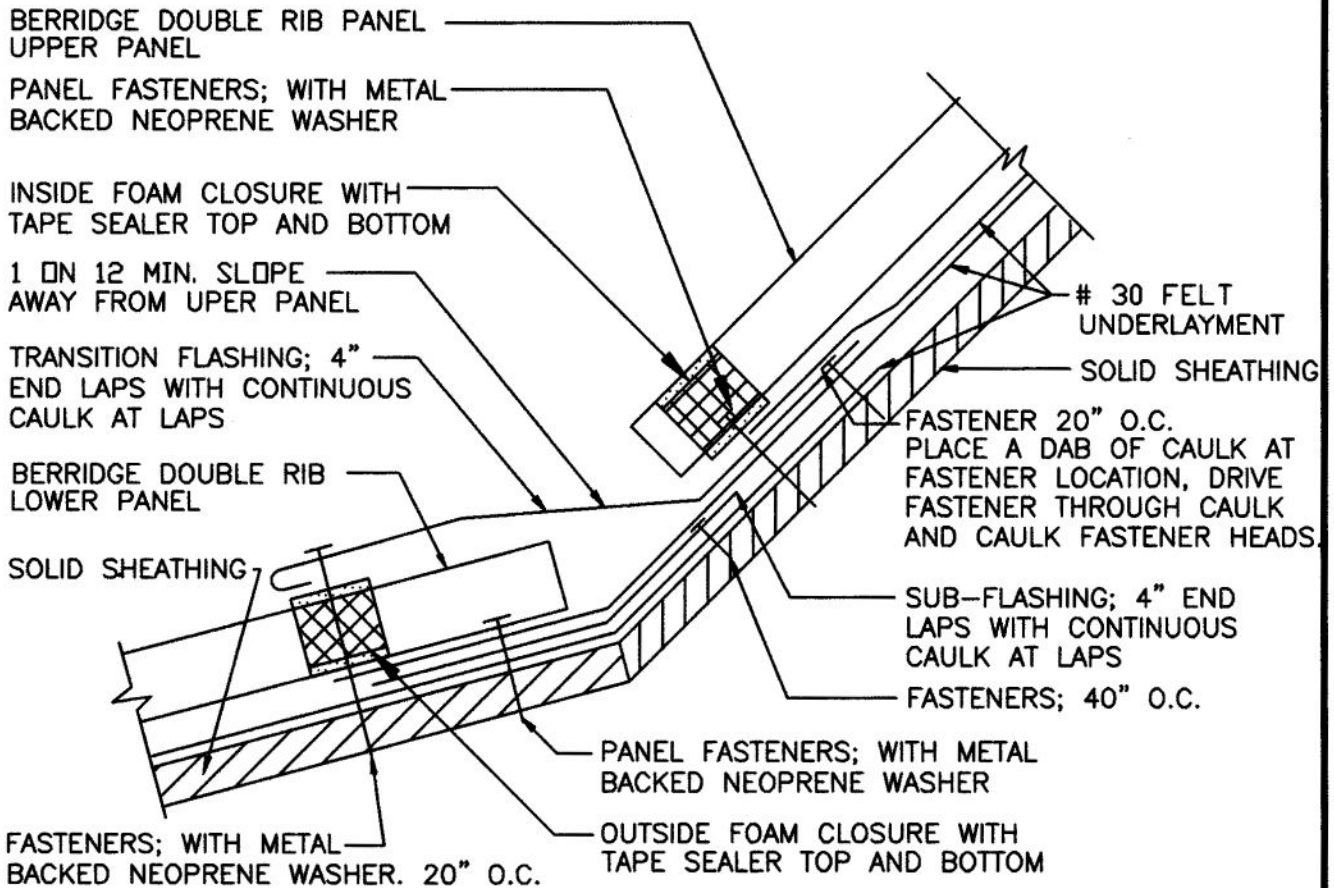

1. SOLID SHEATHING (BY OTHERS) TO BE MINIMUM 1/2" PLYWOOD OR EQUIVALENT IN STRENGTH FOR HOLDING POWER OF FASTENERS.
2. ALL FELT UNDERLAYMENT, CAULKING, AND FASTENERS, ARE ITEMS TO BE FURNISHED AND INSTALLED BY THE ROOFING INSTALLER AT THE DISCRETION OF THE ARCHITECT.

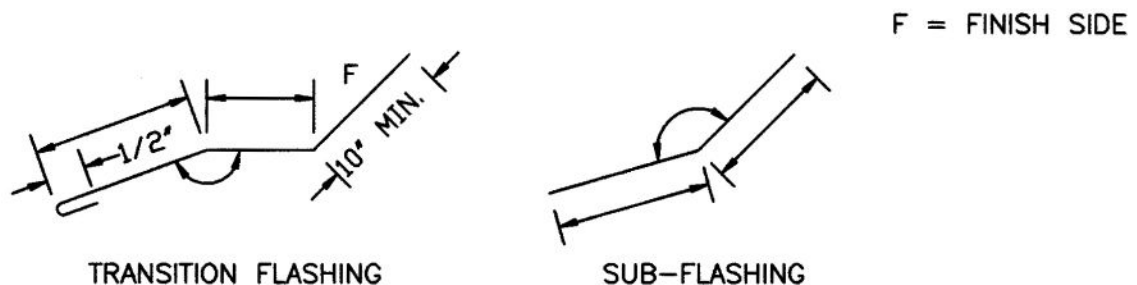

BERRIDGE DOUBLE RIB PANEL

CONTINUOUS BEAD OF CAULK
BETWEEN VALLEY FLASHING
AND FELT UNDERLAYMENT

EXPANDABLE FOAM
CLOSURE WITH TAPE
SEALER TOP AND BOTTOM

FASTENERS
20" O.C. MAX.

30 FELT
UNDERLAYMENT

VALLEY FLASHING
12" END LAPS WITH (2)
CONTINUOUS BEADS CAULK
AT LAPS

SOLID SHEATHING

9" MIN.

PANEL FASTENER WITH
METAL BACKED NEOPRENE
WASHER

1. SOLID SHEATHING (BY OTHERS) TO BE A MINIMUM OF 1/2" PLYWOOD OR EQUIVALENT IN STRENGTH FOR HOLDING POWER OF FASTENERS.
2. ALL FELT UNDERLAYMENT, CAULKING, AND FASTENERS, ARE ITEMS TO BE FURNISHED AND INSTALLED BY THE ROOFING INSTALLER AT THE DISCRETION OF THE ARCHITECT.

F = FINISH SIDE

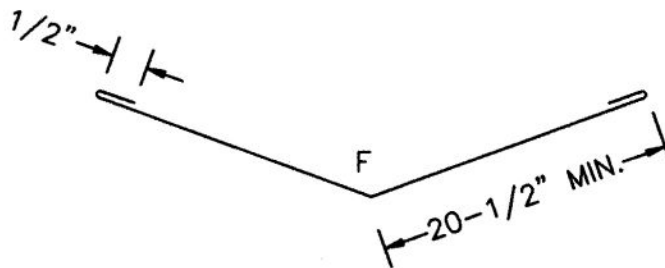

VALLEY FLASHING



**Berridge
Manufacturing
Company**

VALLEY DETAIL

DOUBLE RIB PANEL

DATE: 1/15/03

PAGE\FILE

DR-70

ROOF PIPE PENETRATION OF
4" IN DIA. OR LESS

RUBBERIZED BOOT FLASHING

CONTINUOUS CAULK

PIPE PENETRATION
NOT TO BE
AT PANEL SIDE LAP

BERRIDGE DOUBLE RIB
PANEL

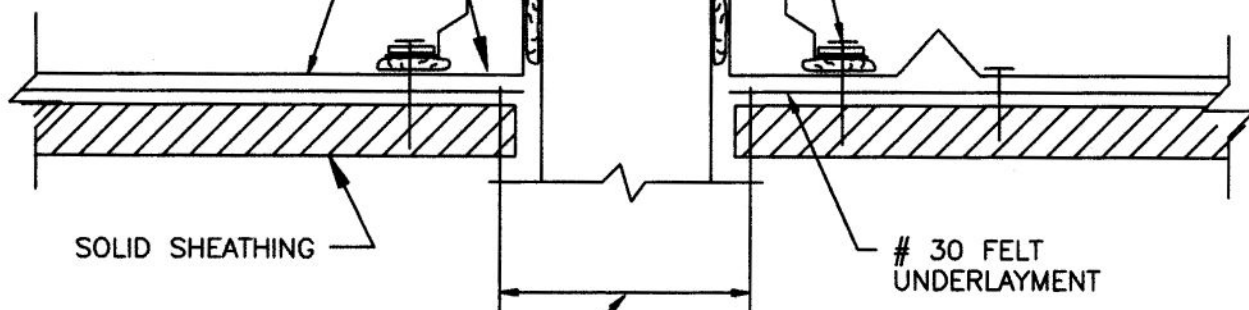

SET RUBBERIZED BOOT INTO
CONTINUOUS BEAD OF CAULK.
USE FASTENERS AS SPECIFIED
BY BOOT MANUFACTURER.
CAULK FASTENER HEADS

SOLID SHEATHING

30 FELT
UNDERLAYMENT

CUT PANEL 1" SMALLER THAN
PENETRATION, BACK CUT TABS,
FOLD TABS UP AROUND
PENETRATION, AND CAULK.

NOTE: IF PIPE IS MADE OF METAL,
IT MUST BE PAINTED TO PREVENT RUST
RUN-OFF FROM STAINING PANELS.

NOTE: POSITION SQUARE BASED BOOTS IN A DIAMOND
ORIENTATION WHERE POSSIBLE TO AID IN DIVERTING WATER.



**Berridge
Manufacturing
Company**

Roofs of Distinction

PIPE PENETRATION
(PREFERRED METHOD)
IN PAN OF PANEL ONLY
4" DIA. OR LESS

DOUBLE RIB PANEL

DATE: 1/15/03

PAGE\FILE

DR-80

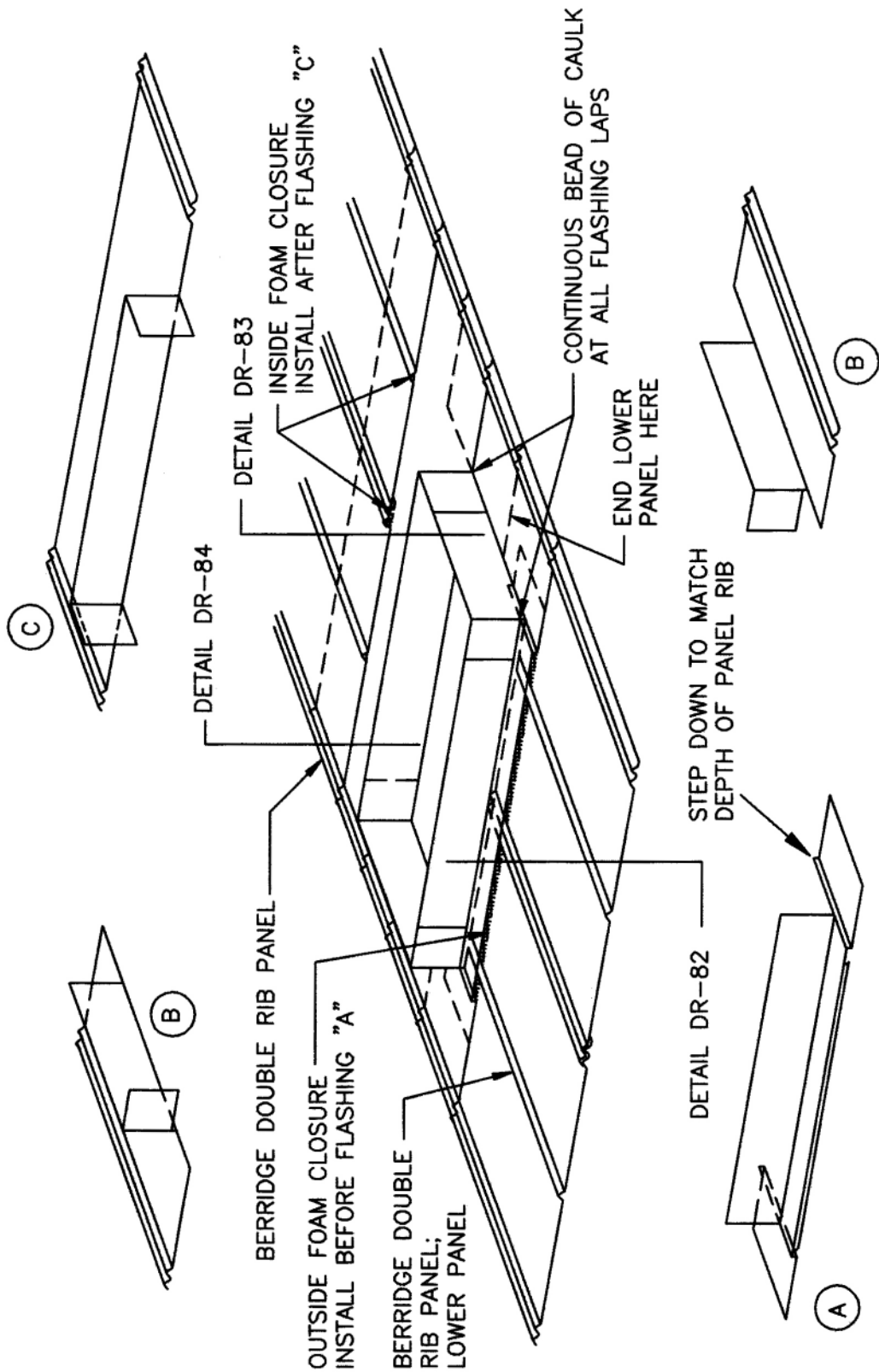

FIELD CUT PANEL ALONG DOTTED LINE AND INSTALL PANEL. INSTALL FLASHING "A" FIRST ALONG WITH FOAM CLOSURE. INSTALL FLASHING "B" SECOND. CAULK ALL FLASHING LAPS. INSTALL FLASHING "C" LAST. THIS FLASHING IS TO BE SLIPPED UNDER THE DOUBLE RIB PANEL AND FELT AS SHOWN IN DETAIL DR-84 BEFORE THE FOAM CLOSURE OR FASTENERS ARE INSTALLED. SEE ALSO DETAILS DR-82 AND DR-83 FOR FELTING AND SUBFLASHING.

DATE: 1/15/03

ROOF PENETRATION

PAGE \ FILE
DR-81

DOUBLE RIB PANEL



Berridge
Manufacturing
Company

FASTENERS; 20" O.C. MAX.

COUNTERFLASHING; 4" END LAPS WITH CONTINUOUS CAULK AT LAPS FLASHING "A" SEE DETAIL DR-81

PANEL FASTENERS WITH METAL BACKED NEOPRENE WASHER.

OUTSIDE FOAM CLOSURE WITH TAPE SEALER TOP AND BOTTOM

BERRIDGE DOUBLE RIB PANEL

SOLID SHEATHING

FLASHING FROM MECHANICAL EQUIPMENT BY OTHERS

CONTINUOUS ANGLE FLASHING TYPICAL ALL 4 SIDES OF PENETRATION

30 FELT UNDERLAYMENT

TOP LAYER OF # 30 FELT UNDERLAYMENT TO BE PERPENDICULAR TO ROOF SLOPE

FASTENERS WITH METAL BACKED NEOPRENE WASHER. 20" O.C. MAX.

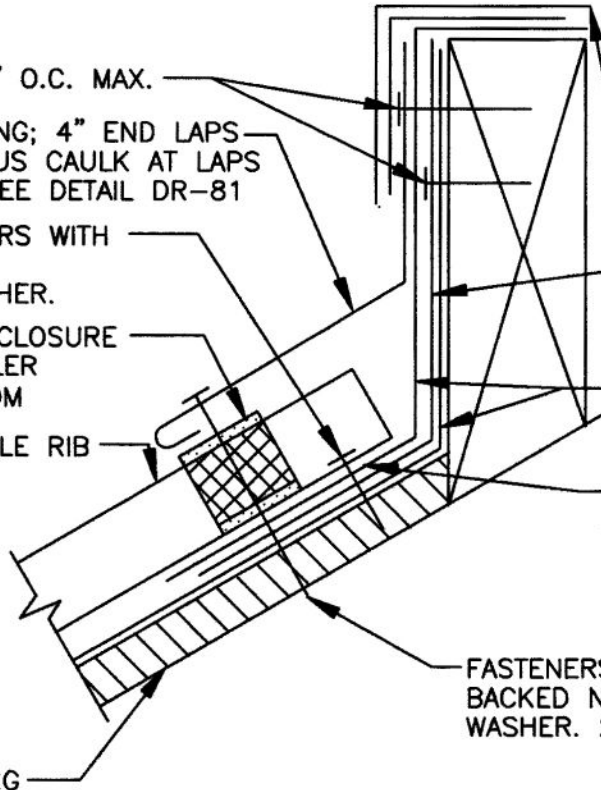

1. SOLID SHEATHING (BY OTHERS) TO BE MINIMUM 1/2" PLYWOOD OR EQUIVALENT IN STRENGTH FOR HOLDING POWER OF FASTENERS.

2. ALL FELT UNDERLAYMENT, CAULKING, AND FASTENERS, ARE ITEMS TO BE FURNISHED AND INSTALLED BY THE ROOFING INSTALLER AT THE DISCRETION OF THE ARCHITECT.

F = FINISH SIDE

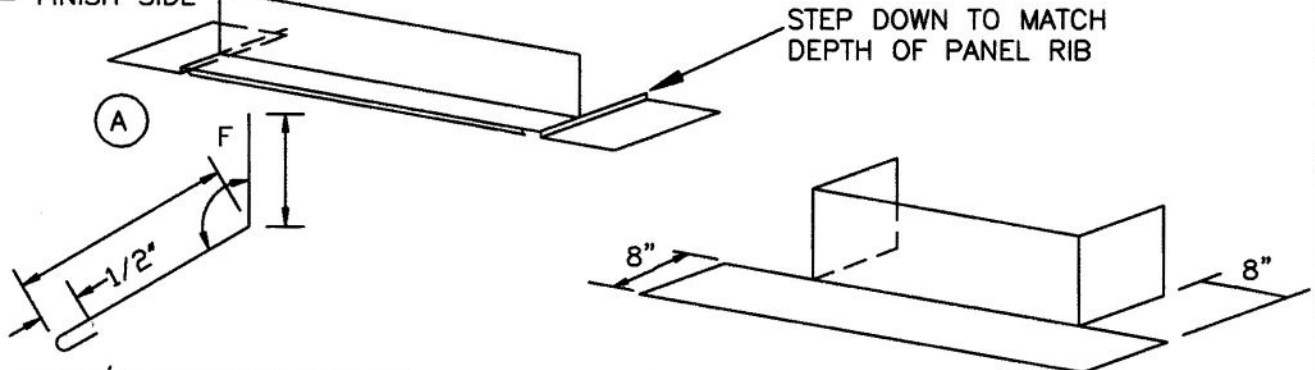

COUNTER FLASHING SECTION SIDE "A" SEE DETAIL DR-81

ANGLE FLASHING



**Berridge
Manufacturing
Company**

Roofs of Distinction

ROOF PENETRATION
SIDE A

DOUBLE RIB PANEL

DATE: 1/15/03

PAGE\FILE

DR-82

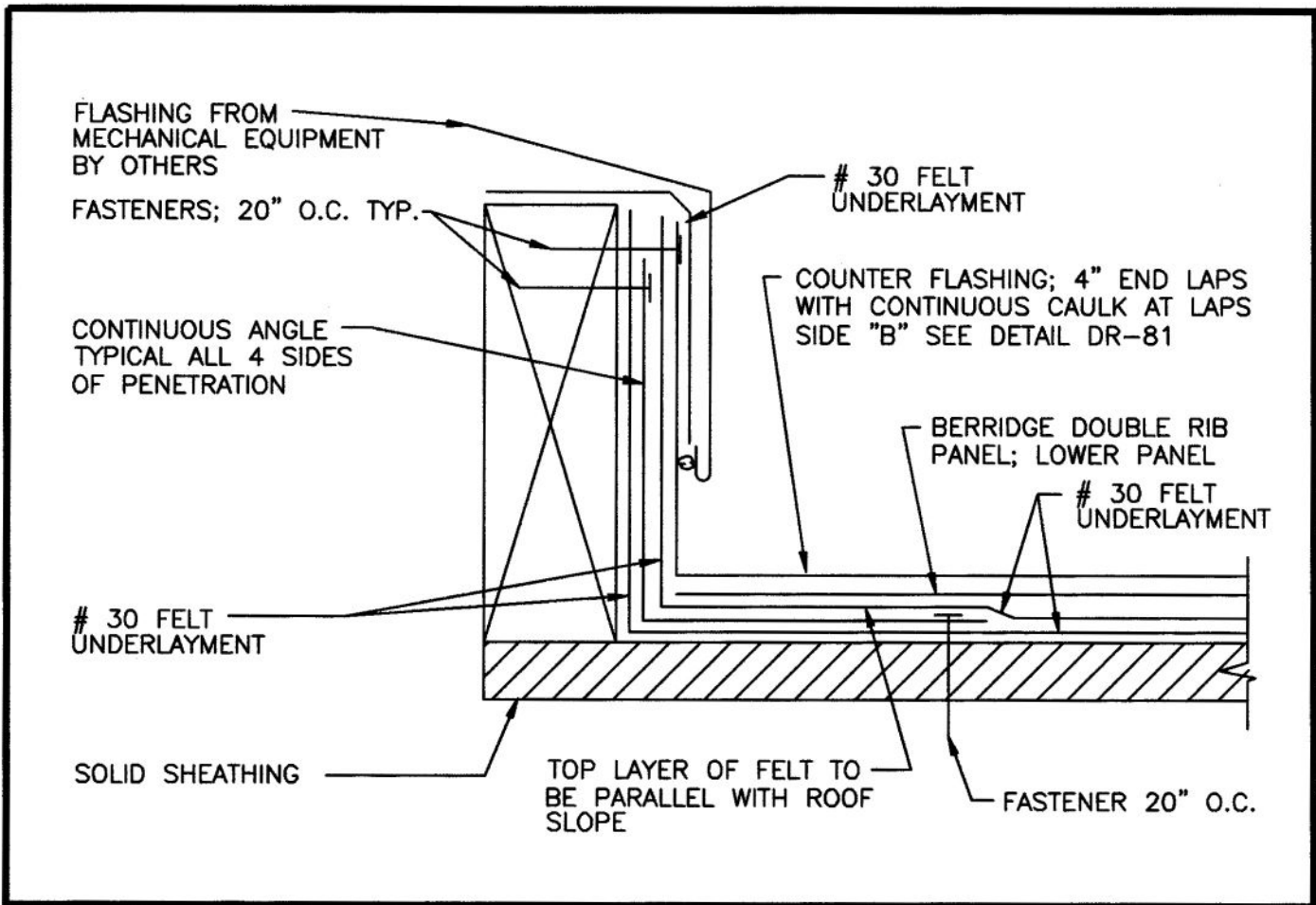

1. SOLID SHEATHING (BY OTHERS) TO BE MINIMUM 1/2" PLYWOOD OR EQUIVALENT IN STRENGTH FOR HOLDING POWER OF FASTENERS.
2. ALL FELT UNDERLAYMENT, CAULKING, AND FASTENERS, ARE ITEMS TO BE FURNISHED AND INSTALLED BY THE ROOFING INSTALLER AT THE DISCRETION OF THE ARCHITECT.

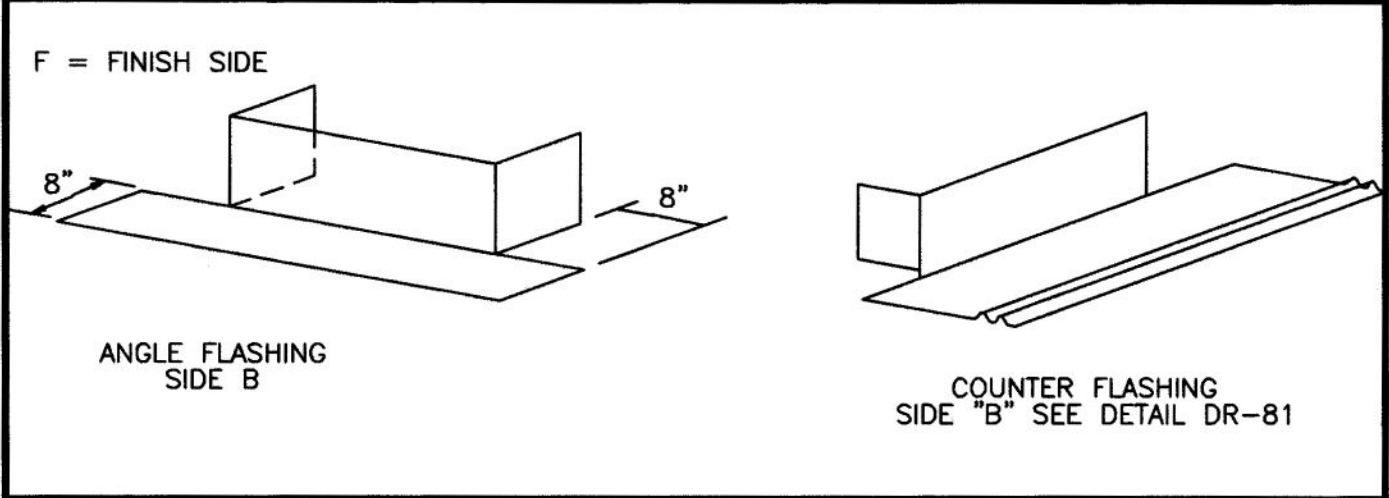

DATE: 1/15/03	ROOF PENETRATION SIDE B	
PAGE \ FILE DR-83	DOUBLE RIB PANEL	

CONTINUOUS COUNTER FLASHING
INSTALL AFTER PANEL INSTALLATION.
SLIP FLASHING UP UNDER FELT
AND PANEL. SIDE "C" SEE DETAIL DR-81

COUNTER FLASHING FROM
MECHANICAL EQUIPMENT
BY OTHERS

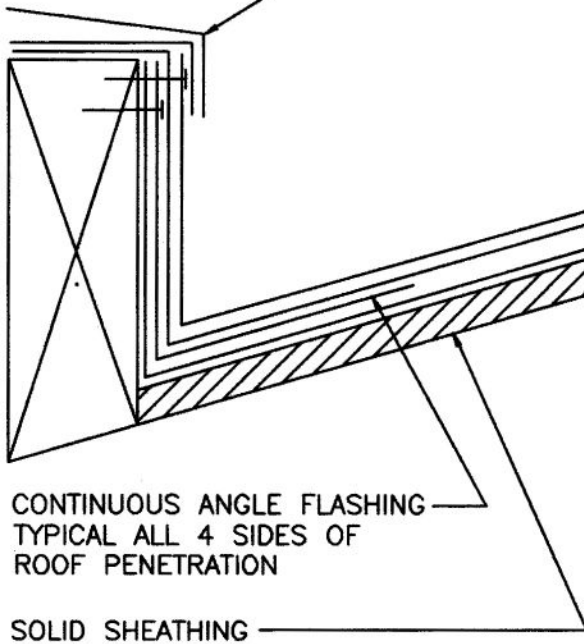

BERRIDGE DOUBLE RIB PANEL

INSIDE FOAM CLOSURE WITH
TAPE SEALER TOP AND BOTTOM
INSTALL AFTER CONTINUOUS
COUNTER FLASHING

30 FELT
UNDERLAYMENT

PANEL FASTENERS WITH METAL
BACKED NEOPRENE WASHER

SLIP COUNTER FLASHING
UNDER FELT BEFORE
FASTENING PANEL

CONTINUOUS BEAD OF CAULK
BETWEEN FLASHING AND FELT

1. SOLID SHEATHING (BY OTHERS) TO BE MINIMUM 1/2" PLYWOOD OR EQUIVALENT IN STRENGTH FOR HOLDING POWER OF FASTENERS.
2. ALL FELT UNDERLAYMENT, CAULKING, AND FASTENERS, ARE ITEMS TO BE FURNISHED AND INSTALLED BY THE ROOFING INSTALLER AT THE DISCRETION OF THE ARCHITECT.

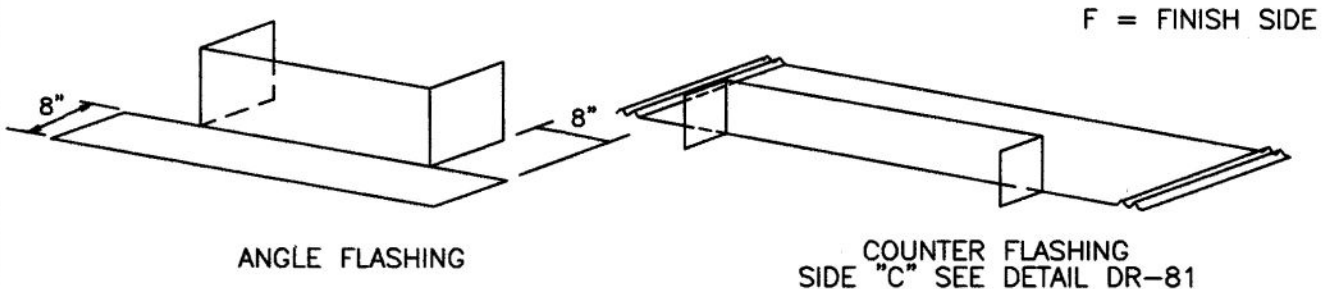

**Berridge
Manufacturing
Company**

Roofs of Distinction

ROOF PENETRATION
SIDE C

DOUBLE RIB PANEL

DATE: 1/15/03

PAGE\FILE

DR-84