

M & R PANEL INSTALLATION DETAILS



**BERRIDGE
MANUFACTURING
COMPANY**

800-669-0009 • www.Berridge.com

INDEX	MR-0
INDEX	MR-1
INSTALLATION INSTRUCTIONS	MRI-1
INSTALLATION INSTRUCTIONS	MRI-2
INSTALLATION INSTRUCTIONS	MRI-3
INSTALLATION INSTRUCTIONS	MRI-4
INTRODUCTION TO TYPICAL DETAILS	MR-2
OVERVIEW M-PANEL	MR-3
OVERVIEW R-PANEL	MR-4
FASTENER LOCATIONS WOOD DECK	MR-5
FASTENER LOCATIONS OPEN FRAMING	MR-6
FOAM CLOSURE DETAILS	MR-7
EAVE DETAIL; SOLID SHEATHING	MR-10
EAVE DETAIL; OPEN FRAMING	MR-11
EAVE DETAIL; W/WALL PANEL; OPEN FRAMING	MR-12
EAVE DETAIL; W/WALL PANEL; OPEN FRAMING	MR-13
HIP RIDGE; SOLID SHEATHING	MR-20
SHED ROOF RIDGE	MR-21
HIP RIDGE; OPEN FRAMING	MR-22
SHED RIDGE DETAIL	MR-23
RIDGE TERMINATION AT DORMER VALLEY	MR-24
GABLE;	MR-30
GABLE; WITH WALL PANEL; OPEN FRAMING	MR-31
GABLE; WITH WALL PANEL; OPEN FRAMING	MR-32
HEAD WALL; WITH PARAPET	MR-40
HEAD WALL; WITH WALL PANEL	MR-41
HEAD WALL; WITH REGLET	MR-42
RAKE WALL; WITH WALL PANEL	MR-50
RAKE WALL; WITH WALL PANEL	MR-51
RAKE WALL; WITH REGLET	MR-52
SLOPE TRANSITION WITH FLASHING	MR-60
VALLEY	MR-70
VALLEY; OPEN FRAMING	MR-71



**Berridge
Manufacturing
Company**

INDEX

M & R PANEL

DATE: 11/05/02

PAGE\FILE
MR-0

ROOF PENETRATION; PIPE PENETRATION	MR-80
ROOF PENETRATION; SQUARE (PLAN VIEW)	MR-81
ROOF PENETRATION; SIDE A	MR-82
ROOF PENETRATION; SIDE B	MR-83
ROOF PENETRATION; SIDE C	MR-84
ROOF PENETRATION; LARGER THAN 4"; OPEN FRAMING	MR-85
UL 90 APPROVED ASSEMBLY CONSTRUCTION NO. 39 (M-PANEL)	MR-90
UL 90 APPROVED ASSEMBLY CONSTRUCTION NO. 30 (R-PANEL)	MR-91
UL 90 APPROVED ASSEMBLY CONSTRUCTION NO. 79 (R-PANEL)	MR-92
UL 90 APPROVED ASSEMBLY CONSTRUCTION NO. 161 (R-PANEL)	MR-93
GRADE DETAIL; OPEN FRAMING	MR-100
GRADE DETAIL	MR-101
OUTSIDE CORNER; OPEN FRAMING	MR-102
OUTSIDE CORNER; SOLID SHEATHING	MR-103
INSIDE CORNER; OPEN FRAMING	MR-104
INSIDE CORNER; SOLID SHEATHING	MR-105
HEAD DETAIL; OPEN FRAMING	MR-106
HEAD DETAIL; SOLID SHEATHING	MR-107
JAMB DETAIL; OPEN FRAMING	MR-108
JAMB DETAIL; SOLID SHEATHING	MR-109
SILL DETAIL; OPEN FRAMING	MR-110

DATE: 11/05/02

INDEX

PAGE\FILE
MR-1

M & R PANEL



Berridge
Manufacturing
Company

- A. BERRIDGE M PANEL: THE BERRIDGE M PANEL IS FACTORY FABRICATED TO A CONSTANT PANEL WIDTH OF 38 1/4" AND A CONSTANT CORRUGATION DEPTH OF 3/4". PANEL COVERAGE IS A NOMINAL 36".
 BERRIDGE R PANEL: THE BERRIDGE R PANEL IS FACTORY FABRICATED TO A CONSTANT PANEL WIDTH OF 38 1/4" AND A CONSTANT DEPTH OF MAJOR CORRUGATION OF 1 1/4". PANEL COVERAGE IS A NOMINAL 36".
 PANELS ARE FABRICATED TO A MINIMUM LENGTH OF 5'-0" AND A MAXIMUM LENGTH OF 40'-0".
- B. MINIMUM SLOPE: THE "M & R" PANELS ARE RECOMMENDED FOR ROOF SLOPES OF 3 ON 12 OR GREATER. SLOPES LESS CONSULT BERRIDGE MANUFACTURING COMPANY.
- C. MATERIAL STORAGE: CAUTION MUST BE EXERCISED IN STORAGE OF MATERIAL PRIOR TO INSTALLATION. KEEP ALL BERRIDGE PREFINISHED MATERIAL IN A DRY LOCATION WITH ADEQUATE VENTILATION AND OUT OF DIRECT SUNLIGHT.
 EXPOSURE TO DIRECT SUNLIGHT AND/OR MOISTURE MAY CAUSE THE FACTORY APPLIED STRIPPABLE PLASTIC FILM TO ADHERE TO THE METAL PERMANENTLY AND DISCOLOR THE FINISH. IF THIS SHOULD OCCUR THE PAINT WARRANTY WILL BE VOID.
- D. STRIPPABLE FILM: THE STRIPPABLE PLASTIC FILM, WHICH IS APPLIED OVER MOST BERRIDGE PREFINISHED PRODUCTS, PANELS, FLASHINGS, COILS AND FLAT SHEETS, PROVIDES PROTECTION OF THE FINISH DURING FABRICATION AND TRANSIT. THIS FILM MUST BE REMOVED PRIOR TO INSTALLATION.
- E. SOLID SHEATHING REQUIREMENTS:
 BERRIDGE MANUFACTURING COMPANY RECOMMENDS THE USE OF EITHER BERRIDGE 24 GA. CORRUGATED SHEATHING (NOMINAL 2 1/2" PITCH BY 7/8" DEPTH) OR A MINIMUM OF 1/2" PLYWOOD SHEATHING TO PROVIDE SUFFICIENT HOLDING POWER FOR FASTENERS. CONTACT BERRIDGE MANUFACTURING'S ENGINEERING DEPARTMENT FOR USE OF ANY OTHER TYPE OF SOLID SHEATHING. (# 30 FELT UNDERLAYMENT OR EQUAL MUST BE USED OVER ANY SOLID SHEATHING).
 DUE TO # 30 FELTS TENDENCY TO TEAR WHEN USED OVER CORRUGATED DECKING, BERRIDGE MANUFACTURING RECOMMENDS GRACE ICE AND WATERSHIELD OR EQUAL TO BE USED AS AN UNDERLAYMENT FOR ALL CORRUGATED DECKS.
- F. SHEATHING INSPECTION:
1. SHEATHING END JOINTS SHOULD BE STAGGERED.
 2. ALL END JOINTS SHOULD MEET AT EITHER A JOIST OR RAFTER.
 3. BLOCKING OR "H" CLIPS SHOULD BE USED IF JOINTS DO NOT REMAIN FLAT UNDER THE WEIGHT OF WORKMEN.
 4. USE SHIMS TO KEEP ENTIRE SUBSTRATE EVEN; UNEVEN SUBSTRATE WILL RESULT IN "OIL-CANNING" IN THE PANELS. SUBSTRATE SHOULD BE LEVEL TO 1/4" IN 20'-0".
 5. ALL CUTS AT PENETRATIONS SHOULD BE TIGHT, WITHOUT GAPS.
 6. USE WOOD FRAMED CRICKETS AT LARGE PENETRATIONS.
 7. MAKE SURE SUBSTRATE JOINTS ARE TIGHT AT ALL HIPS, VALLEYS AND RIDGES.
- G. INSTALLATION OVER OPEN FRAMING:
 FOR DIAPHRAGM CAPABILITIES OF "M & R" PANEL CONSULT BERRIDGE TECHNICAL DEPT. PURLIN OR OTHER STRUCTURAL BRACING IS THE RESPONSIBILITY OF OTHERS.



INSTALLATION INSTRUCTIONS

M & R PANEL

DATE: 11/05/02

PAGE\FILE
MRI-1

H. OPEN FRAMING INSPECTION:

1. PURLINS SHOULD BE ALIGNED WITH TOP FLANGES IN THE SAME PLANE TO A TOLERANCE OF 1/4" IN 20'-0". UNEVENNESS IN THE TOP PLANE OF THE PURLINS WILL RESULT IN ABNORMAL "OIL CANNING" OF PANELS. PURLINS SHALL BE ADEQUATELY BRACED.
2. BERRIDGE MANUFACTURING COMPANY RECOMMENDS SOLID SHEATHING IN VALLEY AND AROUND ROOF PENETRATIONS. DO NOT APPLY PANELS ON OPEN FRAMING AT VALLEYS OR ROOF PENETRATIONS WITHOUT REFERRING TO DETAILS MR-71 AND MR-85.
3. FOOT TRAFFIC ON THE PANELS MUST BE KEPT TO A MINIMUM. ARCHITECTURAL PANELS ARE DESIGNED FOR AESTHETICS AND CAN BE EASILY DAMAGED OR DEFORMED IF EXTREME CARE IS NOT USED.

I. FASCIA/RAKE INSPECTION:

1. STRIKE A LINE THE FULL LENGTH OF THE FASCIA OR RAKE. IF NOT STRAIGHT, CORRECT WITH SHIMS.
2. MAKE SURE FASCIA/RAKE IS FLUSH WITH SHEATHING.

J. FELT UNDERLAYMENT: A SINGLE LAYER OF NUMBER THIRTY FELT UNDERLAYMENT (OR EQUAL) MUST BE APPLIED OVER SOLID SHEATHING, AS SHOWN IN THE BERRIDGE MANUFACTURING COMPANY TYPICAL FELTING DETAILS. THE USE OF ADDITIONAL LAYERS OF NUMBER THIRTY FELT IS RECOMMENDED ON LOW SLOPED ROOFS, AT ALL VALLEY CONDITIONS, AT ROOF PENETRATIONS AND AT CERTAIN OTHER FLASHING CONDITIONS AS DEPICTED IN THE "M & R" PANEL TYPICAL DETAILS.

GRACE ICE AND WATERSHIELD MAY BE REQUIRED ON LOW SLOPED ROOFS OR AT CERTAIN FLASHING CONDITIONS.

K. FELTING INSTALLATION:

1. DO NOT USE RED ROSIN PAPER UNDER METAL ROOFING PANELS.
2. SWEEP ROOF AREA CLEAN.
3. USE FLAT HEAD GALVANIZED ROOFING NAILS 1 1/4" LONG WITH BERRIDGE GALVANIZED FELT CAPS.
4. INSTALL VALLEY FELT FIRST.
5. INSTALL FELT PARALLEL TO THE EAVE, (2 LAYERS REQUIRED AT EAVE) STARTING AT EAVE AND USING MINIMUM 6" LAPS. USE 2 LAYERS OF FELT ON ENTIRE ROOF DECK IF ROOF SLOPE IS 3 ON 12.
6. REFER TO FELTING DETAILS WHEN VALLEYS OR ROOF PENETRATIONS ARE INVOLVED ON OPEN FRAMING CONDITIONS.
7. INSULATE BETWEEN WOOD BLOCKING AND METAL WITH FELT OR GRACE ICE AND WATERSHIELD
8. VERIFY CORRECT METHOD OF INSTALLING ICE AND WATERSHIELD WITH ICE AND WATERSHIELD MANUFACTURE.

L. ELECTROLYSIS: AVOID ALLOWING FLASHINGS AND PANELS TO COME INTO CONTACT WITH EITHER LEAD, COPPER, OR OTHER DISSIMILAR METALS, AND PREVENT EXPOSURE TO WATER RUNDOWN FROM COPPER AND/OR LEAD.

M. SEALANT RECOMMENDATIONS: TREMCO, INC. SPECTREM 1 SILICONE SEALANT.
DO NOT USE CLEAR CAULK.

DATE: 11/05/02

PAGE\FILE
MRI-2

INSTALLATION
INSTRUCTIONS

M & R PANEL



Berridge
Manufacturing
Company

- N. FLASHING: IF BERRIDGE MANUFACTURING COMPANY IS TO SUPPLY FLASHING, ALL FLASHINGS WILL BE FABRICATED IN 10'-0" LENGTHS WITH SQUARE END CUTS ONLY. THE PURCHASER MUST PROVIDE ALL DIMENSIONS AND DEGREES OF ANGLE.
- O. FLASHING INSTALLATION:
1. REMOVE STRIPPABLE PLASTIC FILM FROM ALL FLASHINGS PRIOR TO INSTALLATION.
 2. ALWAYS STAGGER JOINTS WHEN ONE FLASHING IS INSTALLED OVER OTHER FLASHINGS.
 3. INSTALL ALL FLASHINGS AS PER BERRIDGE TYPICAL DETAILS.
 4. ALL FLASHINGS ARE TO BE DESIGNED AND INSTALLED TO AVOID TRAPING WATER.
- P. PANELS: BERRIDGE MANUFACTURING COMPANY WILL PROVIDE SQUARE END CUTS ONLY ON ALL "M & R" PANELS. COMPUTATION OF ALL QUANTITIES AND DIMENSIONS ARE THE RESPONSIBILITY OF THE PURCHASER.
- Q. PANEL INSTALLATION:
1. REMOVE STRIPPABLE PLASTIC FILM FROM EACH PANEL PRIOR TO INSTALLATION.
 2. START AT ONE GABLE END OF THE ROOF AND WORK TOWARD THE OTHER GABLE.
 3. EACH PANEL IS TO BE KEPT TIGHT AGAINST THE ADJOINING PANEL. NEVER PERMIT A GAP BETWEEN VERTICAL LAP. ANY CRIMPS OR BENDS MUST BE STRAIGHTENED PRIOR INSTALLATION.
 4. KEEP PANELS ALIGNED SO THAT RIBS MATCH AT HIPS, VALLEYS AND WHERE VERTICAL PANELS ADJOIN ROOF PANELS. DO NOT INSTALL LONG CONTINUOUS RUNS OF PANELS ALL AT ONE TIME WHERE RIB LINES MUST MATCH. INSTALL TEN OR TWELVE PANELS IN ONE ELEVATION AND THEN FOLLOW WITH A LIKE NUMBER OF PANELS ON THE OTHER ELEVATION. WHEN YOU INSTALL PANELS IN THIS MANNER, YOU WILL BE ABLE TO MAKE ANY ADJUSTMENTS REQUIRED TO INSURE RIB MATCHING.
 5. COPPER-COTE,[™] CHAMPAGNE, LEAD-COTE,[™] AND PREWEATHERED GALVALUME[®] PANEL INSTALLATION: NOTE THE SERIES OF ARROWS PAINTED ON THE UNDERSIDE OF THE PANEL. ALL PANELS MUST BE INSTALLED IN A CONSISTENT MANNER, MEANING THAT THE ARROWS ON EVERY PANEL ARE ALL POINTING IN THE SAME DIRECTION. IF A PANEL IS REVERSED (ARROWS POINTING OPPOSITE OF THOSE ON OTHER PANELS) IT WILL APPEAR, FROM A DISTANCE, A DIFFERENT SHADE DUE TO THE GRANULAR EFFECT OF THE PIGMENTS IN THE FINISH. METALLIC FINISHES ARE MATCH - LOT FINISHES. DO NOT MIX LOTS.
- R. FASTENERS: INSTALL FASTENERS AS PER TYPICAL DETAILS. USE #10 HEX HEAD ZINC PLATED FASTENER WITH METAL BACKED NEOPRENE FASTENER WHEN FASTENING TO WOOD. USE #12 HEX HEAD ZINC PLATED FASTENER WITH A METAL BACKED NEOPRENE WASHER WHEN FASTENING TO METAL * WHEN USING POP RIVETS ON FLASHING, STAINLESS STEEL RIVETS ARE RECOMMENDED TO AVOID RUST STAINS.
- MAKE SURE ALL FASTENERS ARE DRIVEN STRAIGHT AND SET FLAT. DO NOT OVERDRIVE FASTENERS AS THIS WILL CAUSE THE CLIP AND/OR FLASHINGS TO BUCKLE OR BECOME RECESSED BELOW THE ELEVATION OF THE SUBSTRATE.
- * CONSULT BERRIDGE MANUFACTURING'S ENGINEERING DEPARTMENT REGARDING FASTENER SPACING TO MEET DESIGN CRITERIA AND THE USE OF ANY OTHER TYPE OF FASTENER.



**Berridge
Manufacturing
Company**

INSTALLATION INSTRUCTIONS

M & R PANEL

DATE: 11/05/02

PAGE \ FILE
MRI-3

S. UNDERWRITERS LABORATORIES RATINGS:

THE BERRIDGE "M" PANEL COMPLIES WITH THE FOLLOWING UL RATINGS:

1. "TEST FOR WIND UPLIFT RESISTANCE OF ROOF ASSEMBLIES" CLASS UL 90 CONSTRUCTION NUMBER 39. (REFER TO BERRIDGE TYPICAL DETAIL MR-90)

THE BERRIDGE "R" PANEL COMPLIES WITH THE FOLLOWING UL RATINGS:

1. "TEST FOR WIND UPLIFT RESISTANCE OF ROOF ASSEMBLIES" CLASS UL 90 CONSTRUCTION NUMBER 30. (REFER TO BERRIDGE TYPICAL DETAIL MR-91)
2. "TEST FOR WIND UPLIFT RESISTANCE OF ROOF ASSEMBLIES" CLASS UL 90 CONSTRUCTION NUMBER 79. (REFER TO BERRIDGE TYPICAL DETAIL MR-92)
3. "TEST FOR WIND UPLIFT RESISTANCE OF ROOF ASSEMBLIES" CLASS UL 90 CONSTRUCTION NUMBER 161. (REFER TO BERRIDGE TYPICAL DETAIL MR-93)

BERRIDGE MANUFACTURING COMPANY STRIVES TO PROVIDE ITS CUSTOMERS WITH THE HIGHEST QUALITY STRETCHER LEVELED STEEL AVAILABLE. THE LATEST TECHNOLOGY IS ALSO INCORPORATED IN BERRIDGE'S HIGH-PRECISION COIL HANDLING AND ROLL FORMING EQUIPMENT TO MINIMIZE THE STRESS ON METAL DURING PRODUCTION. FURTHERMORE, BERRIDGE UTILIZES HEAVIER 24 GAUGE METAL RATHER THAN 26 GAUGE STEEL OR LIGHT GAUGE ALUMINUM AS OFFERED BY MANY COMPETITORS. ALL THESE MEASURES HAVE BEEN TAKEN TO MINIMIZE THE AMOUNT OF "OIL-CANNING" (WAVINESS) WHICH IS NATURALLY INHERENT IN FLAT SHEET METAL. MANY TIMES, HOWEVER, THE CAUSE OF WAVINESS OR "OIL-CANNING" CAN BE TRACED TO UNEVEN SHEATHING, IMPROPER FELT INSTALLATION, OR, IN THE CASE OF OPEN FRAMING, UNEVENNESS OF THE TOP PLANE OF THE PURLINS OR FOOT TRAFFIC ON THE PANELS.

ALL ARCHITECTURAL PANELS REQUIRE CARE IN HANDLING AND INSTALLATION TO AVOID DAMAGING OR DEFORMING THE PANELS.

THESE INSTALLATION INSTRUCTIONS AND THE FOLLOWING TYPICAL DETAILS ARE INTENDED TO PROVIDE OUR CUSTOMERS WITH THE INFORMATION REQUIRED FOR AN AESTHETICALLY PLEASING AND FUNCTIONAL INSTALLATION OF THE BERRIDGE S-DECK PANEL SYSTEM.

NOTE: ALL PRODUCT SPECIFICATIONS, DETAILS AND INSTALLATION INSTRUCTIONS SUBJECT TO CHANGE WITHOUT NOTICE. FOR SPECIFIC PROJECT DETAILS, CONTACT BERRIDGE.

DATE: 11/05/02

PAGE \ FILE
MRI-4

INSTALLATION
INSTRUCTIONS

M & R PANEL



**Berridge
Manufacturing
Company**

THE DETAILS CONTAINED IN THE FOLLOWING PAGES ARE MERELY RECOMMENDATIONS AS TO HOW BERRIDGE MANUFACTURING MATERIALS SHOULD BE INSTALLED. THEY MAY REQUIRE ADAPTATIONS OR MODIFICATIONS FOR A SPECIFIC PROJECT AS CONDITIONS VARY IN BOTH BUILDING DESIGN AND LOCAL WEATHER PECULIARITIES.

BERRIDGE MANUFACTURING COMPANY SHALL BE HELD HARMLESS FROM ANY AND ALL CLAIMS ARISING FROM LACK OF WATERTIGHTNESS AS A RESULT OF FOLLOWING THESE RECOMMENDED DETAILS. ENSURING WATERTIGHTNESS ON ANY GIVEN PROJECT IS THE FUNCTION OF THE INSTALLER. THE ARCHITECT/GENERAL CONTRACTOR/INSTALLER MUST ACCEPT THE RESPONSIBILITY TO ADAPT THESE DETAILS TO MEET PARTICULAR BUILDING REQUIREMENTS AND TO ASSURE ADEQUATE WATERTIGHTNESS.

THE INSTALLER CAN VIRTUALLY ASSURE WATERTIGHTNESS IF THESE FLASHING DETAILS HAVE BEEN PROPERLY ADAPTED, ADEQUATE LAPS HAVE BEEN PROVIDED, CORRECT TYPE OF SEALANT USED, ALL JOINTS ADEQUATELY CAULKED, AND PROFESSIONAL WORKMANSHIP EMPLOYED.



INTRODUCTION TO
TYPICAL DETAILS

M & R PANEL

DATE: 11/05/02

PAGE\FILE
MR-2

SECTION PROPERTIES BASED ON 24 GAUGE 40 K.S.I.			
"M" PANEL	DL_x (in ⁴ /ft.)	M_A (ft.-lbs/ft.)	V_A (lbs)
POSITIVE BENDING	0.0277	106.96	1003
NEGATIVE BENDING	0.0224	97.84	1003

RECOMMENDED LOAD IN POUNDS PER SQUARE FOOT PANEL WEIGHT = 1.3 P.S.F.						
SPAN (FEET)	NET VERTICAL LIVE LOAD			NET VERTICAL WIND UPLIFT		
	1-SPAN	2-SPAN	3-SPAN	1-SPAN	2-SPAN	3-SPAN
2'-0"	70	70	70	90d	90	90
2'-8"	70	70	70	75d	90	90
3'-0"	66d	70	70	53d	90	90
3'-4"	47d	68	70	38d	90d	75d
4'-0"		47	52d		55d	43d

1. ALL LOADS MEET L/240 DEFLECTION CRITERIA. (d) DEFLECTION GOVERNS ALLOWABLES.
2. WIND LOAD ALLOWABLE STRESSES INCREASED BY 33%.
3. VALUES BASED ON 1996 EDITION OF AISI AND GOOD ENGINEERING PRACTICE.

FOR SPECIFIC JOB APPLICATION RECOMMENDATIONS, PLEASE CONTACT
BERRIDGE TECHNICAL DEPARTMENT 1-800-231-8127

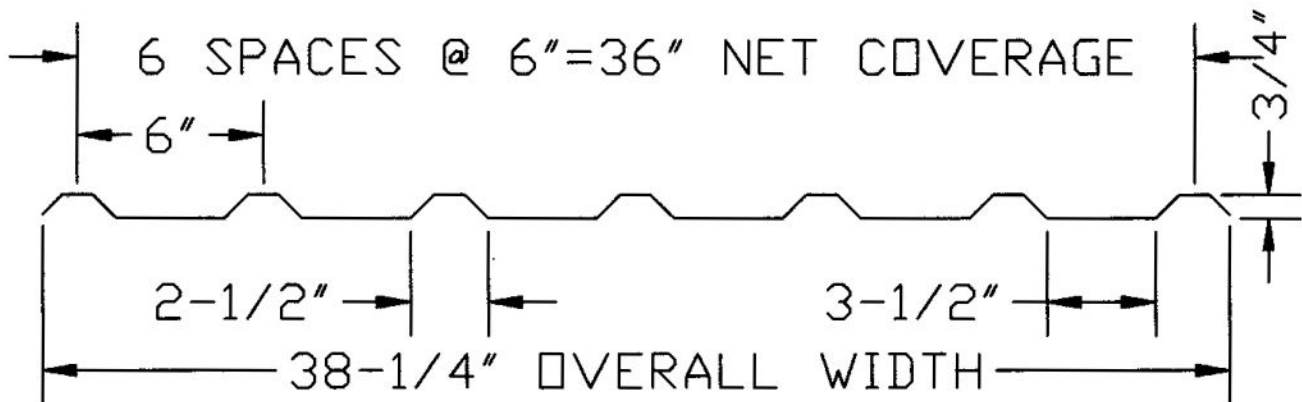

DATE: 11/05/02

OVERVIEW
M PANEL

PAGE \ FILE
MR-3

M PANEL



**Berridge
Manufacturing
Company**

SECTION PROPERTIES BASED ON 24 GAUGE 40 K.S.I.			
"R" PANEL	DL_x ($in^4/ft.$)	M_A (ft.-lbs/ft.)	V_A (lbs)
POSITIVE BENDING	0.0546	118.83	860
NEGATIVE BENDING	0.0530	112.34	860

RECOMMENDED LOAD IN POUNDS PER SQUARE FOOT PANEL WEIGHT = 1.3 P.S.F.						
SPAN (FEET)	NET VERTICAL LIVE LOAD			NET VERTICAL WIND UPLIFT		
	1-SPAN	2-SPAN	3-SPAN	1-SPAN	2-SPAN	3-SPAN
3'-0"	70	70	70	90d	90	90
3'-6"	70	70	70	81d	90	90
4'-0"	54d	54	63	54d	75	87
4'-6"	38d	43	50	38d	59	68
5'-0"			40			54d

1. ALL LOADS MEET L/240 DEFLECTION CRITERIA. (d) DEFLECTION GOVERNS ALLOWABLES.
2. WIND LOAD ALLOWABLE STRESSES INCREASED BY 33%.
3. VALUES BASED ON 1996 EDITION OF AISI AND GOOD ENGINEERING PRACTICE.

FOR SPECIFIC JOB APPLICATION RECOMMENDATIONS, PLEASE CONTACT
BERRIDGE TECHNICAL DEPARTMENT 1-800-231-8127

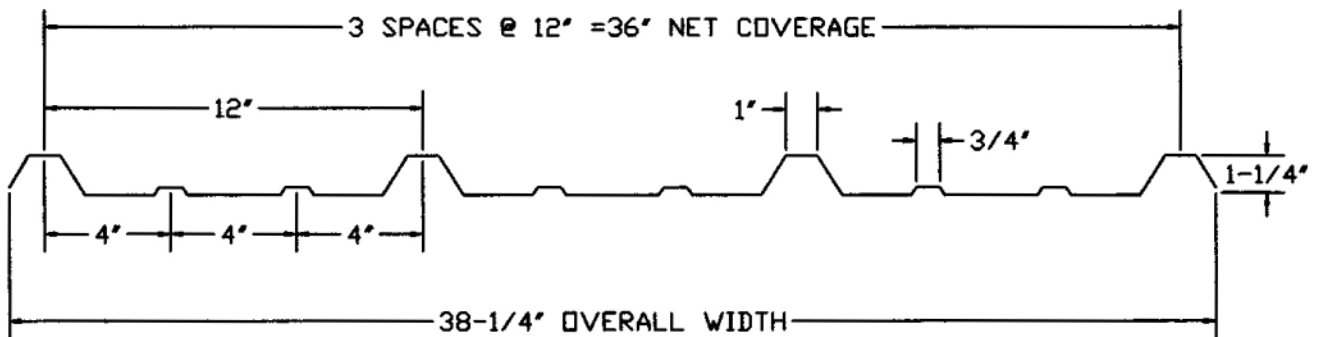

OVERVIEW
R PANEL

R PANEL

DATE: 11/05/02

PAGE \ FILE
MR-4

*SEE MR-6 FOR FASTENER LOCATION OF 'R' PANEL

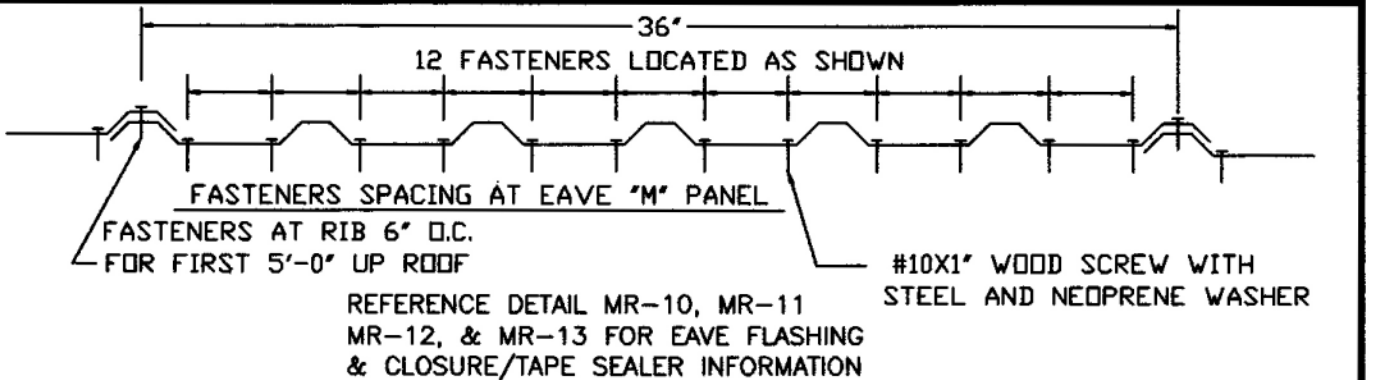
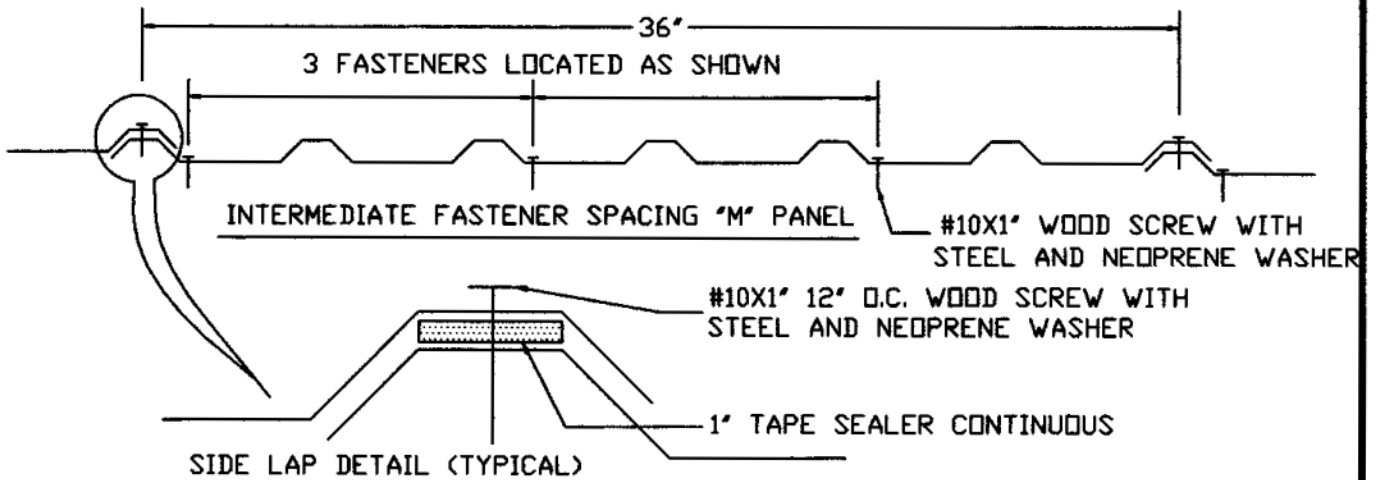
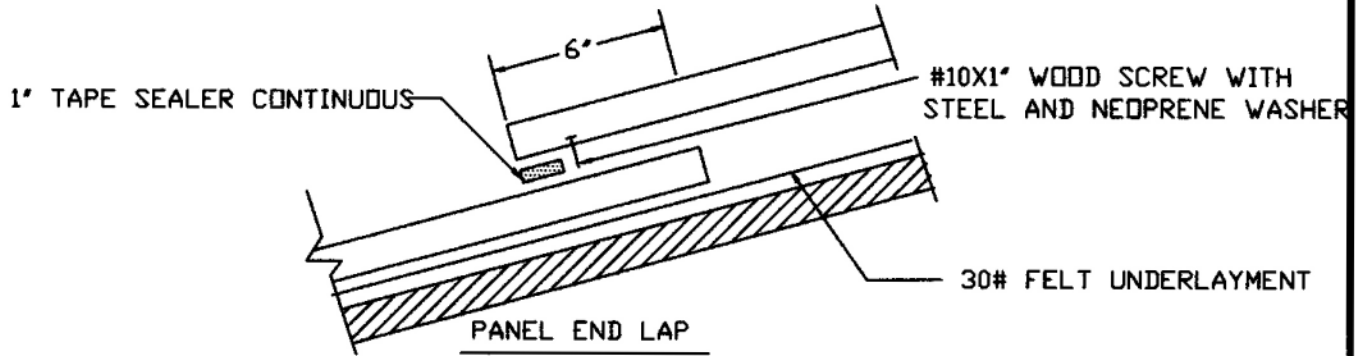
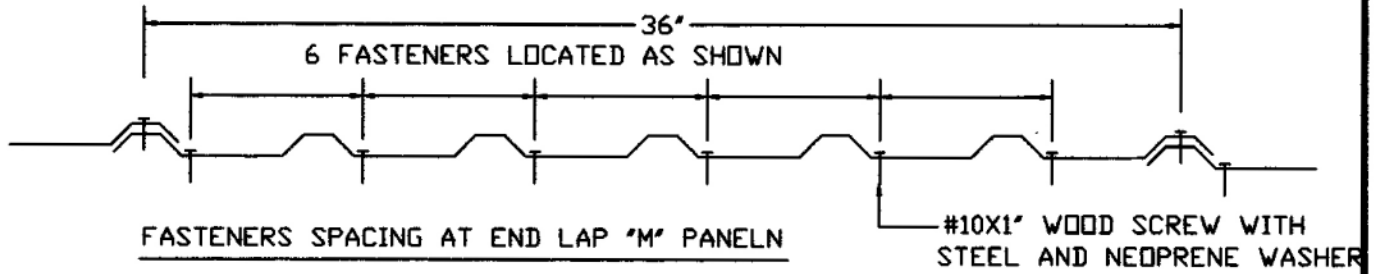

DATE: 11/05/02

PAGE\FILE
MR-5

FASTENER LOCATIONS WOOD DECK M PANEL



Berridge
Manufacturing
Company

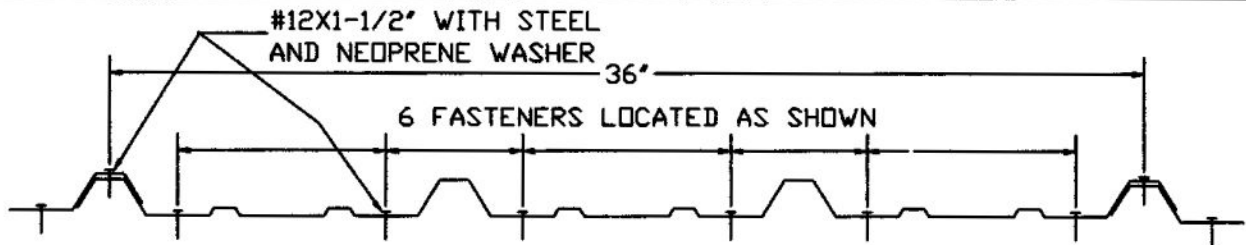

FASTENERS SPACING AT END LAP "R" PANEL

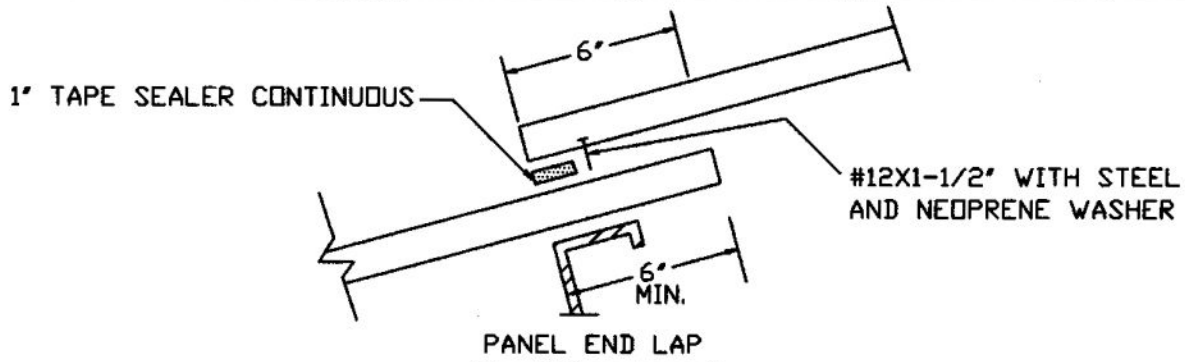

PANEL END LAP

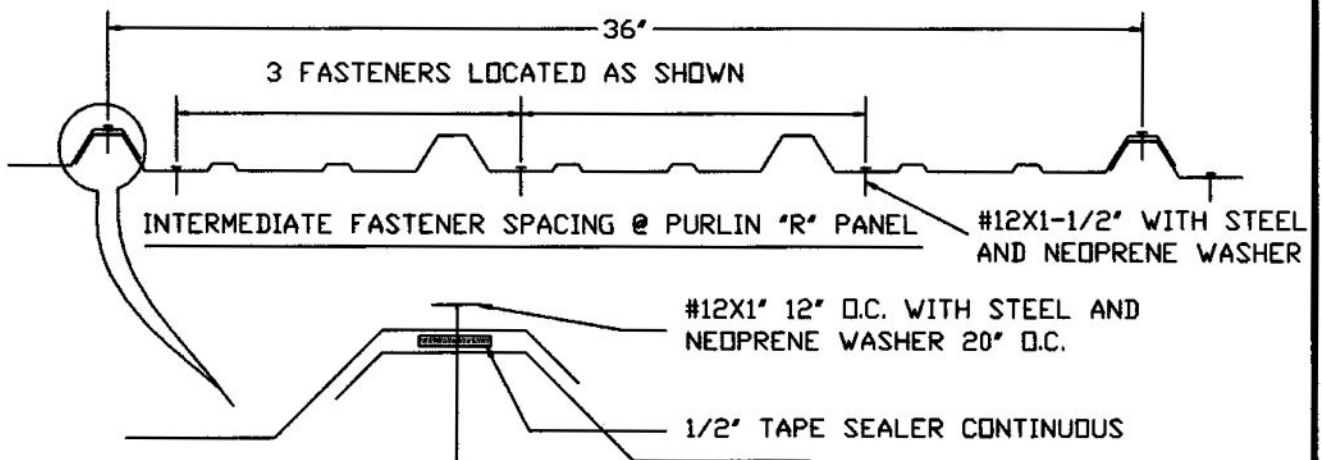

SIDE LAP DETAIL (TYPICAL) "R" PANEL

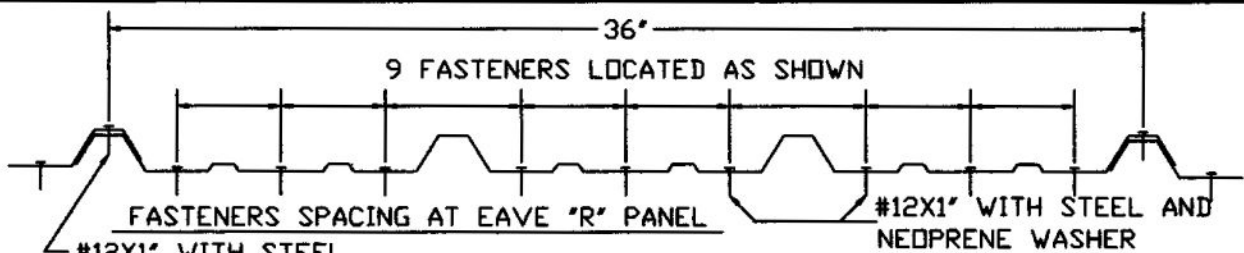

#12X1" WITH STEEL AND NEOPRENE WASHER FASTENERS AT RIB 6" O.C. FOR FIRST 5'-0" UP ROOF

REFERENCE DETAIL MR-10, MR-11 MR-12, & MR-13 FOR EAVE FLASHING & CLOSURE/TAPE SEALER INFORMATION



**Berridge
Manufacturing
Company**

Roofs of Distinction

FASTENER LOCATIONS
PURLIN FRAMING

R PANEL

DATE: 11/05/02

PAGE\FILE
MR-6

BERRIDGE M OR R PANEL

INSIDE FOAM CLOSURE

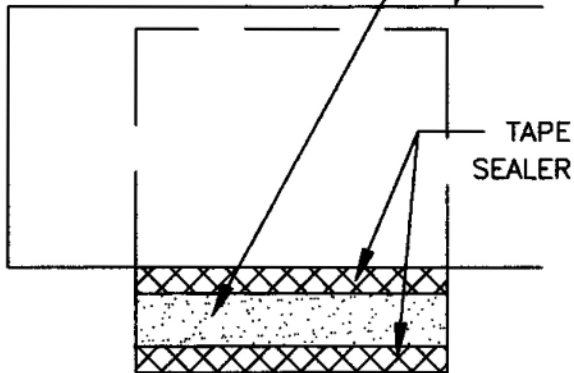

USE THIS DETAIL AT EAVE, AND USE THIS DETAIL WHEN PANEL EDGE IS AT 90 TO PANEL RIB.

BERRIDGE M OR R PANEL

EXPANDABLE FOAM CLOSURE

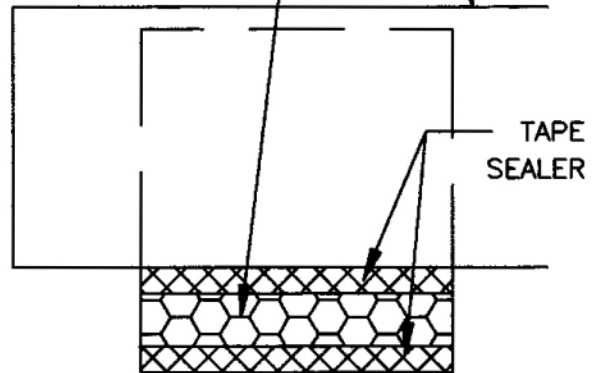

USE THIS DETAIL AT THE VALLEY, AND USE THIS DETAIL WHEN PANEL EDGE IS AT AN ANGLE OTHER THAN 90 TO PANEL RIB (SKEWED CONDITIONS).

BERRIDGE M OR R PANEL
IN SECTION

OUTSIDE FOAM CLOSURE

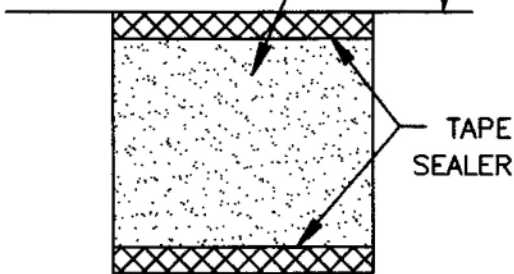

USE THIS DETAIL AT THE RIDGE, HEADWALL, AND WHEN PANEL EDGE IS AT 90 TO PANEL RIB.

BERRIDGE M OR R PANEL
IN SECTION

EXPANDABLE FOAM CLOSURE

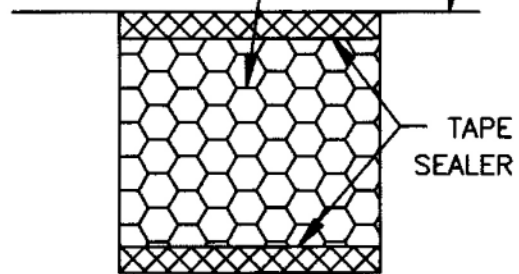

USE THIS DETAIL AT THE HIP, AND USE THIS DETAIL WHEN PANEL EDGE IS AT AN ANGLE OTHER THAN 90 TO PANEL RIB (SKEWED CONDITIONS).

DATE: 11/05/02

FOAM CLOSURE DETAILS

PAGE \ FILE
MR-7

M & R PANEL



**Berridge
Manufacturing
Company**

BERRIDGE M OR R PANEL

INSIDE FOAM CLOSURE WITH TAPE
SEALER TOP & BOTTOM

PANEL FASTENER WITH METAL
BACKED NEOPRENE WASHER

EAVE FLASHING, 4" END LAPS WITH
CONTINUOUS CAULK AT LAPS

30 FELT
UNDERLAYMENT

FASTENERS,
20" O.C. MAX.

SOLID SHEATHING

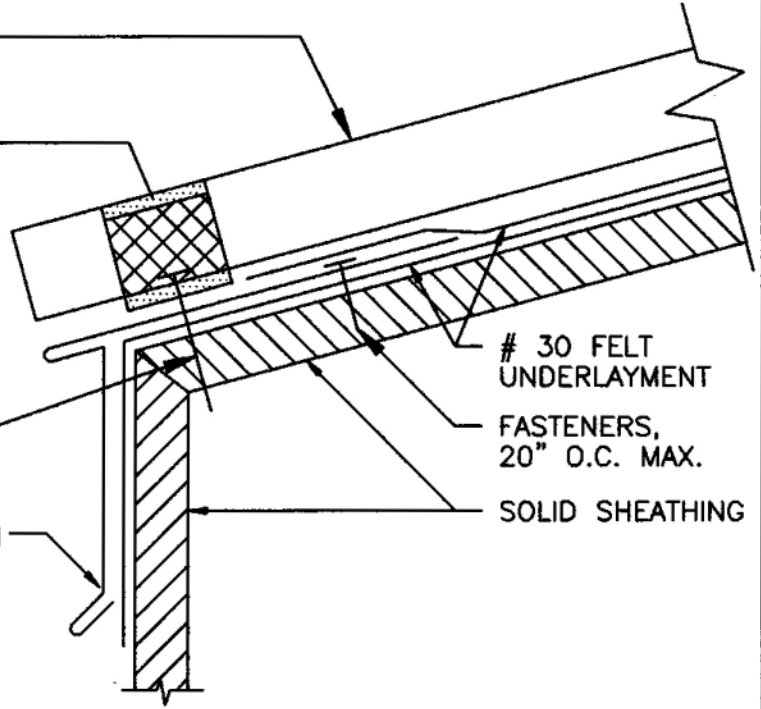

1. SOLID SHEATHING (BY OTHERS) TO BE MINIMUM 1/2" PLYWOOD OR EQUIVALENT IN STRENGTH FOR HOLDING POWER OF FASTENERS.
2. ALL FELT UNDERLAYMENT, CAULKING AND FASTENERS ARE ITEMS TO BE FURNISHED AND INSTALLED BY THE ROOFING INSTALLER AT THE DISCRETION OF THE ARCHITECT.

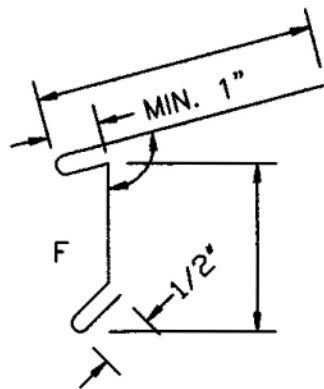

F = FINISH SIDE

EAVE FLASHING



**Berridge
Manufacturing
Company**

Roofs of Distinction

EAVE DETAIL
SOLID SHEATHING

M & R PANEL

DATE: 11/05/02

PAGE\FILE

MR-10

BERRIDGE M OR R PANEL

INSIDE FOAM CLOSURE WITH TAPE SEALER TOP & BOTTOM

PANEL FASTENER WITH METAL BACKED NEOPRENE WASHER

EAVE FLASHING, 4" END LAPS WITH CONTINUOUS CAULK AT LAPS

BERRIDGE WALL PANEL

30# FELT UNDERLAYMENT

FASTENERS, 20" O.C. MAX.

SOLID SHEATHING

30# FELT UNDERLAYMENT

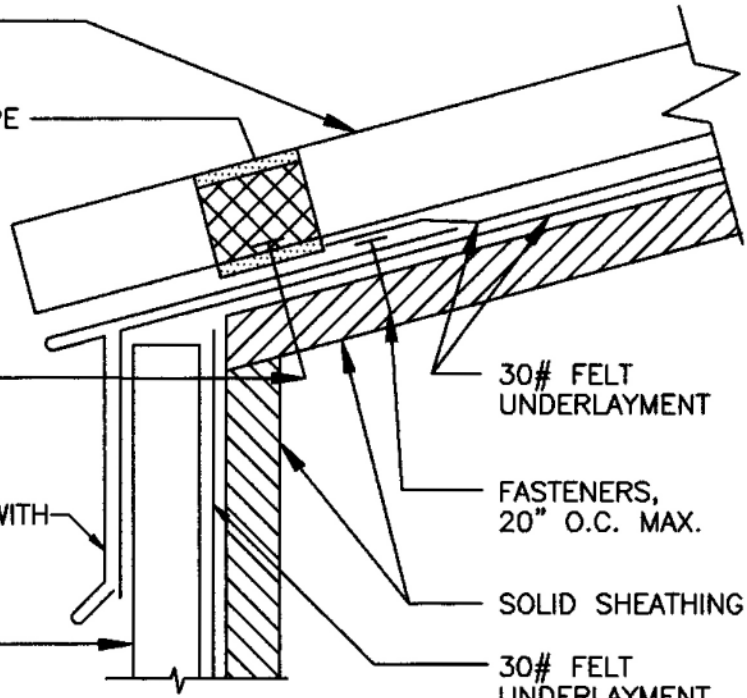

1. SOLID SHEATHING (BY OTHERS) TO BE MINIMUM 1/2" PLYWOOD OR EQUIVALENT IN STRENGTH FOR HOLDING POWER OF FASTENERS.
2. ALL FELT UNDERLAYMENT, CAULKING AND FASTENERS ARE ITEMS TO BE FURNISHED AND INSTALLED BY THE ROOFING INSTALLER AT THE DISCRETION OF THE ARCHITECT.

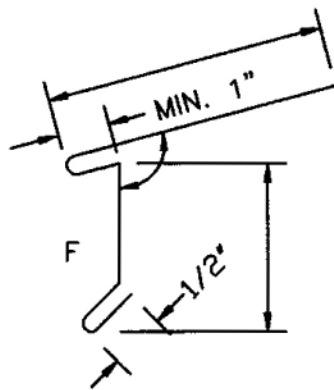

F = FINISH SIDE

EAVE FLASHING

DATE: 11/05/02

PAGE\FILE
MR-II

EAVE DETAIL
SOLID SHEATHING

M & R PANEL



Berridge
Manufacturing
Company

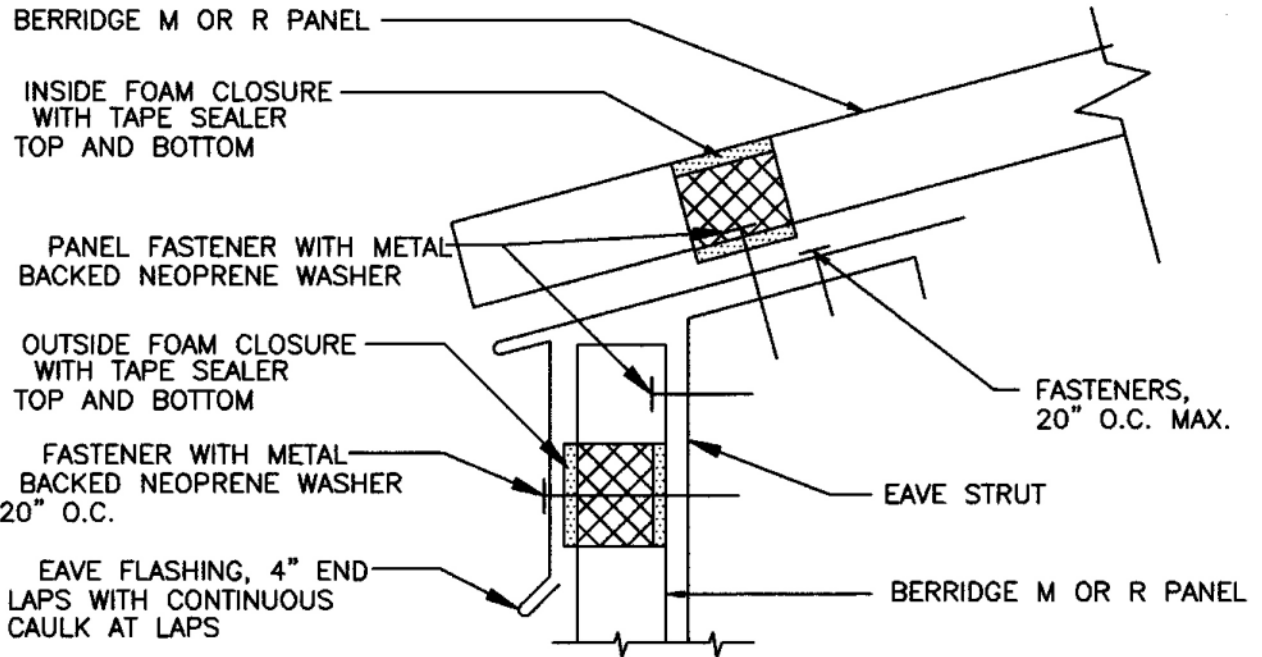

1. CAULKING AND FASTENERS ARE ITEMS TO BE FURNISHED AND INSTALLED BY THE ROOFING INSTALLER AT THE DISCRETION OF THE ARCHITECT.

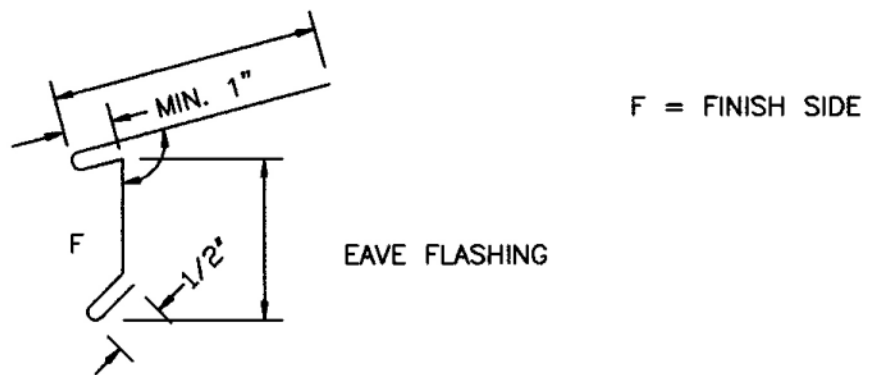

**Berridge
Manufacturing
Company**

Roofs of Distinction

EAVE DETAIL
OPEN FRAMING

DATE: 11/05/02

M & R PANEL

PAGE \ FILE
MR-12

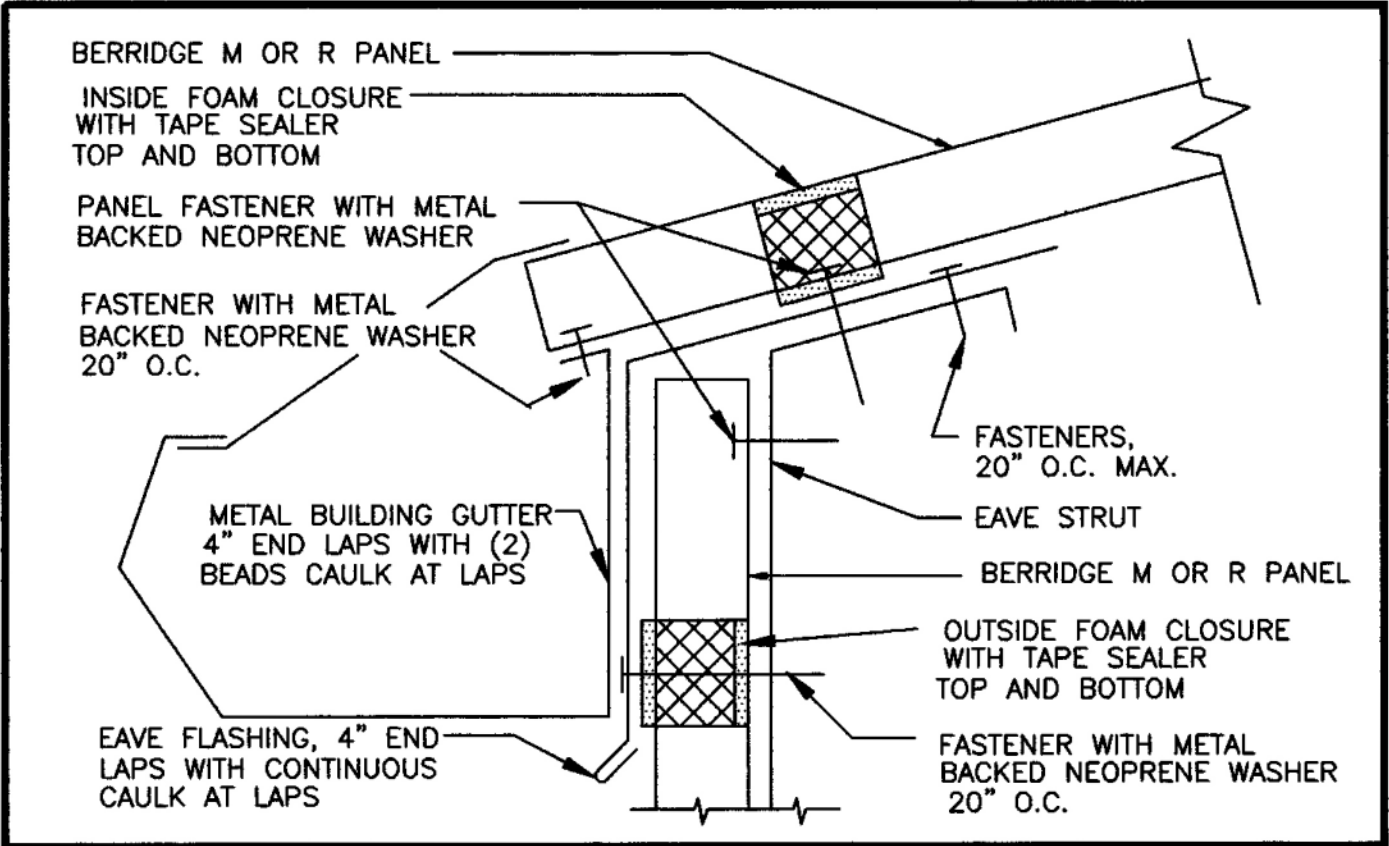

1. CAULKING AND FASTENERS ARE ITEMS TO BE FURNISHED AND INSTALLED BY THE ROOFING INSTALLER AT THE DISCRETION OF THE ARCHITECT.

F = FINISH SIDE

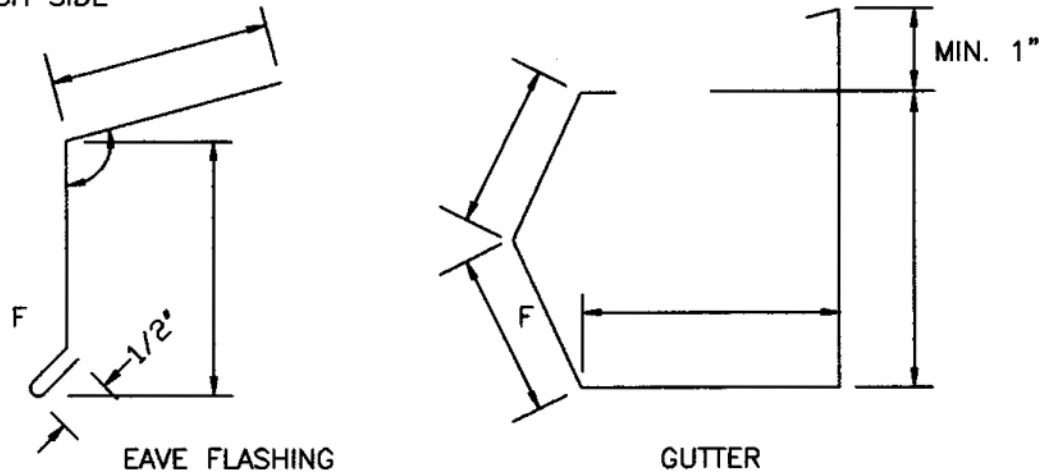

DATE: 11/05/02

EAVE DETAIL
OPEN FRAMING

PAGE\FILE
MR-13

M & R PANEL

Berridge
Manufacturing
Company
Roofs of Distinction

RIDGE/HIP CAP; 4" END LAPS WITH CONTINUOUS CAULK AT LAPS. POP RIVET AT LAPS AND CAULK RIVET HEADS.

BERRIDGE M OR R PANEL

PANEL FASTENER WITH METAL BACKED NEOPRENE WASHER

FASTENERS WITH METAL BACKED NEOPRENE WASHER 20" O.C.

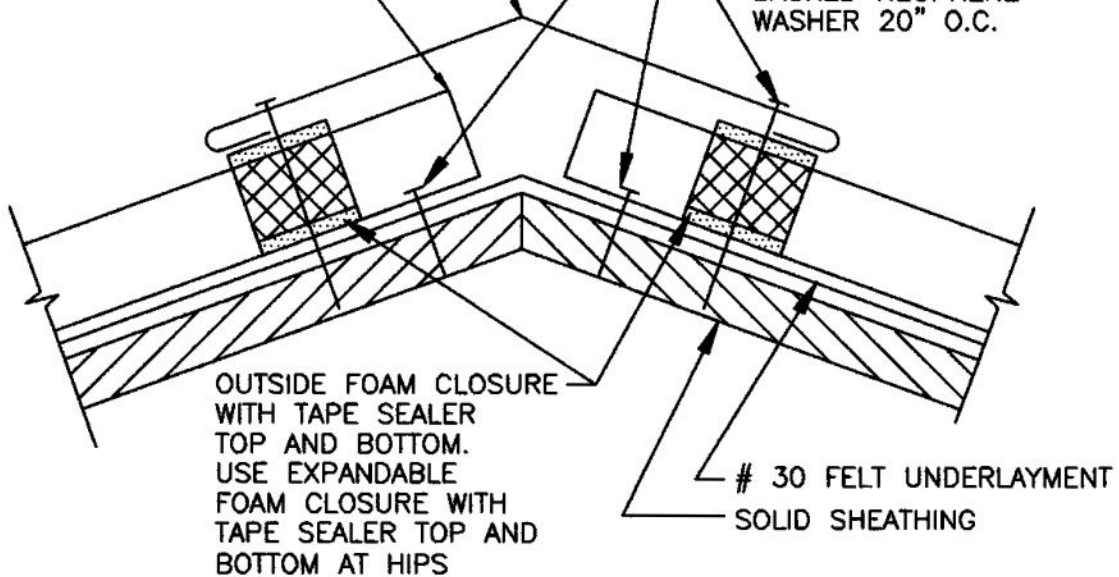

1. SOLID SHEATHING (BY OTHERS) TO BE MINIMUM 1/2" PLYWOOD OR EQUIVALENT IN STRENGTH FOR HOLDING POWER OF FASTENERS.
2. ALL FELTING UNDERLAYMENT, CAULKING, AND FASTENERS, ARE ITEMS TO BE FURNISHED AND INSTALLED BY THE ROOFING INSTALLER AT THE DISCRETION OF THE ARCHITECT.

F = FINISH SIDE

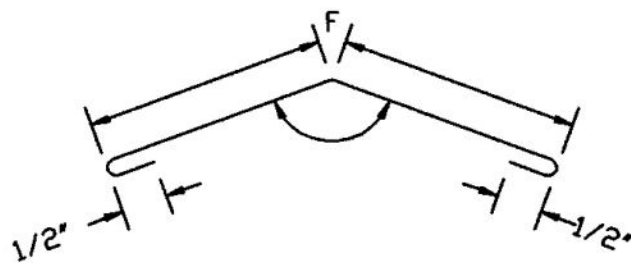

RIDGE/HIP CAP



**Berridge
Manufacturing
Company**

Roofs of Distinction

RIDGE AND HIP DETAIL

M & R PANEL

DATE: 11/05/02

PAGE\FILE

MR-20

RIDGE CAP; 4" END LAPS WITH CONTINUOUS CAULK AT LAPS. POP RIVET AT LAPS AND CAULK RIVET HEADS.

BERRIDGE M OR R PANEL

FASTENERS WITH METAL BACKED NEOPRENE WASHER 20" O.C.

OUTSIDE FOAM CLOSURE WITH TAPE SEALER TOP AND BOTTOM

PANEL FASTENER WITH METAL BACKED NEOPRENE WASHER

FASTENER WITH METAL BACKED NEOPRENE WASHER. 40" O.C. MAX

30 FELT UNDERLAYMENT LAP FELT OVER RIDGE

SOLID SHEATHING

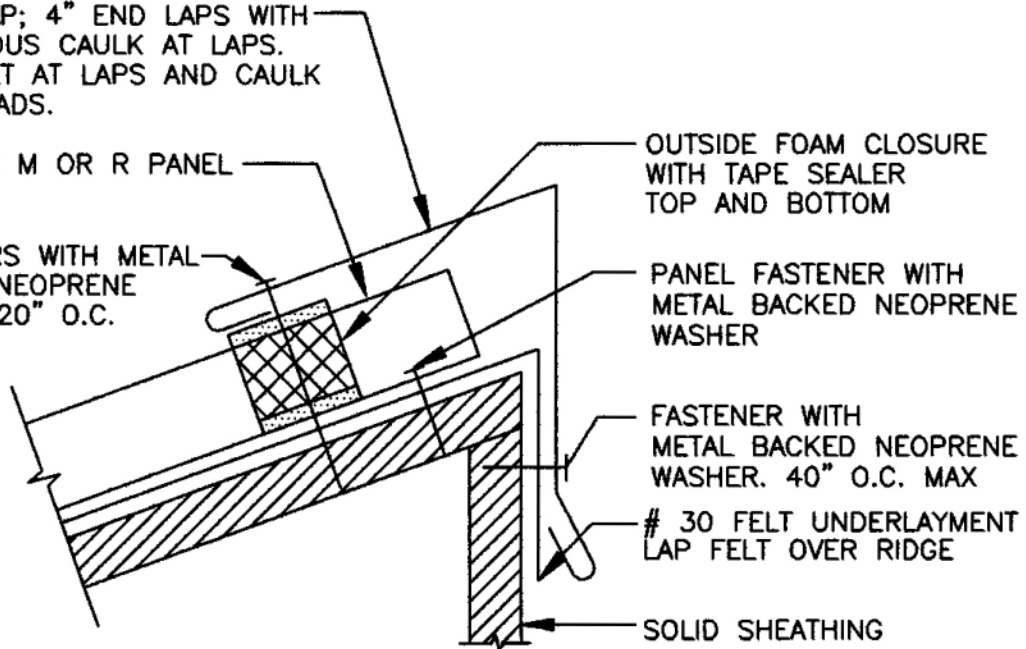

1. SOLID SHEATHING (BY OTHERS) TO BE MINIMUM 1/2" PLYWOOD OR EQUIVALENT IN STRENGTH FOR HOLDING POWER OF FASTENERS.
2. ALL FELTING UNDERLAYMENT, CAULKING, AND FASTENERS, ARE ITEMS TO BE FURNISHED AND INSTALLED BY THE ROOFING INSTALLER AT THE DISCRETION OF THE ARCHITECT.

F = FINISH SIDE

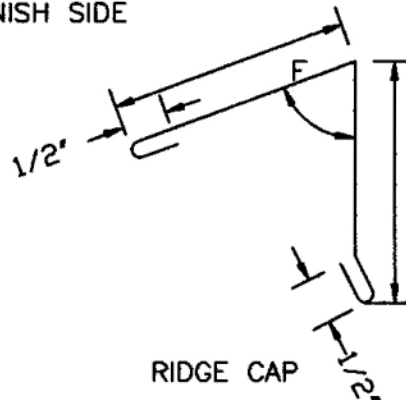

DATE: 11/05/02

SHED ROOF RIDGE
CAP DETAIL

PAGE \ FILE
MR-21

M & R PANEL



Berridge
Manufacturing
Company

Roofs of Distinction

RIDGE/HIP CAP; 4" END LAPS WITH CONTINUOUS CAULK AT LAPS.

BERRIDGE M OR R PANEL

OUTSIDE FOAM CLOSURE WITH TAPE SEALER TOP AND BOTTOM. USE EXPANDABLE FOAM CLOSURE WITH TAPE SEALER TOP AND BOTTOM AT HIPS

PANEL FASTENER WITH METAL BACKED NEOPRENE WASHER

FASTENERS WITH METAL BACKED NEOPRENE WASHER 20" O.C.

SUB FLASHING 4" END LAPS WITH CONTINUOUS CAULK AT LAPS

PURLINS

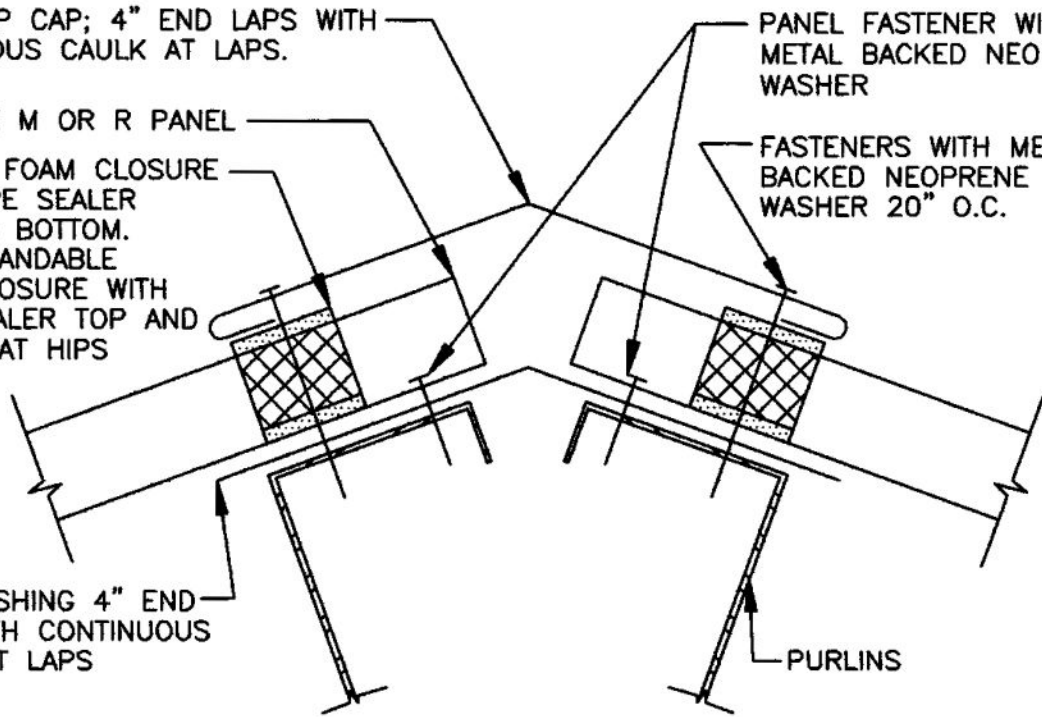

1. ALL CAULKING, AND FASTENERS, ARE ITEMS TO BE FURNISHED AND INSTALLED BY THE ROOFING INSTALLER AT THE DISCRETION OF THE ARCHITECT.

F = FINISH SIDE

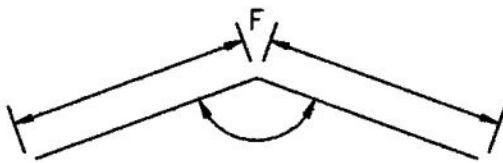

SUB FLASHING

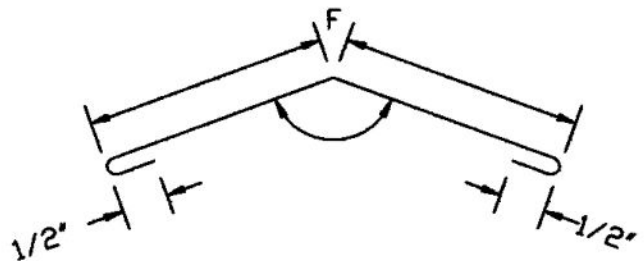

RIDGE/HIP CAP



**Berridge
Manufacturing
Company**

Roofs of Distinction

RIDGE AND HIP DETAIL
OPEN FRAMING

M & R PANEL

DATE: 11/05/02

PAGE \ FILE

MR-22

METAL BUILDING RIDGE CAP; 4" END LAPS WITH CONTINUOUS CAULK AT LAPS.

SUB FLASHING 4" END LAPS WITH CONTINUOUS CAULK AT LAPS

BERRIDGE M OR R PANEL

PANEL FASTENER WITH METAL BACKED NEOPRENE WASHER

FASTENERS WITH METAL BACKED NEOPRENE WASHER 20" O.C.

FASTENER 20" O.C.

OUTSIDE FOAM CLOSURE WITH TAPE SEALER TOP AND BOTTOM.

FASTENER 20" O.C.

PANEL FASTENER WITH METAL BACKED NEOPRENE WASHER

BERRIDGE M OR R PANEL

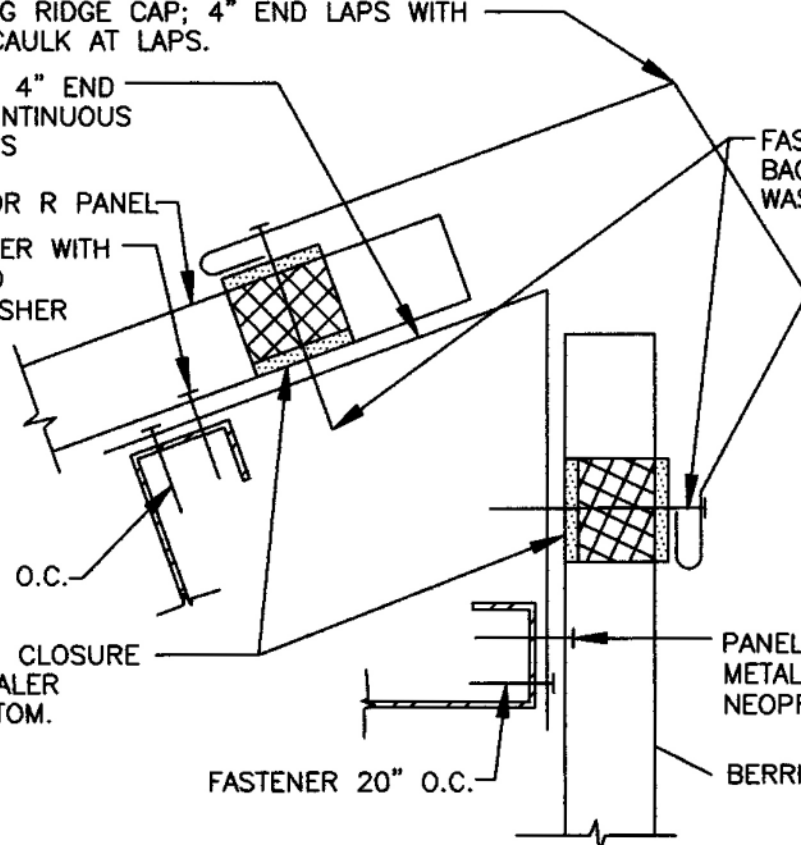

1. CAULKING AND FASTENERS ARE ITEMS TO BE FURNISHED AND INSTALLED BY THE ROOFING INSTALLER AT THE DISCRETION OF THE ARCHITECT.

F = FINISH SIDE

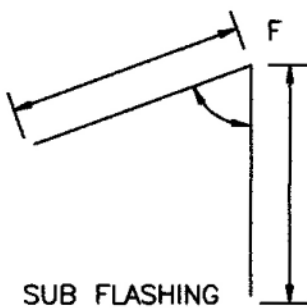

SUB FLASHING

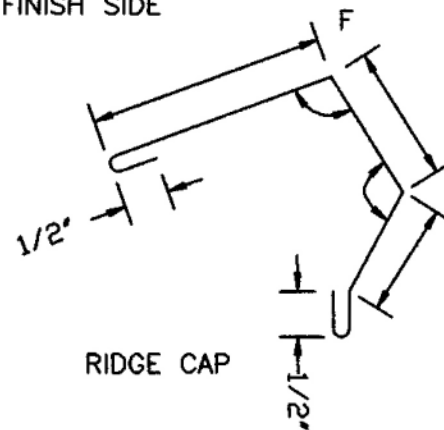

RIDGE CAP

DATE: 11/05/02

SHED RIDGE DETAIL
OPEN FRAMING

PAGE \ FILE

MR-23

M & R PANEL



Berridge
Manufacturing
Company

SECTION VIEW

FIELD FORM END OF RIDGE FLASHING AND EXTEND UNDER UPPER PANEL

RIDGE FLASHING; 4" END LAPS WITH CONTINUOUS CAULK AT LAPS

FIELD TAPERED OUTSIDE CLOSURE

BERRIDGE M OR R PANEL

EXPANDABLE FOAM CLOSURE WITH TAPE SEALER TOP AND BOTTOM

MR-20

30 FELT UNDERLAYMENT

PANEL FASTENER WITH METAL BACKED NEOPRENE WASHER

SOLID SHEATHING

VALLEY FLASHING; 12" LAPS WITH CONTINUOUS CAULK AT LAPS

PLAN VIEW

MAIN ROOF PANELS

RIDGE FLASHING

INSIDE FOAM CLOSURE

VALLEY FLASHING

DORMER PANEL

RIDGE TERMINATION AT DORMER VALLEY

DATE: 11/05/02

B Berridge Manufacturing Company

M & R PANEL

PAGE \ FILE

MR-24



GABLE CHANNEL 4" END LAPS WITH CONTINUOUS CAULK AT LAPS

CONTINUOUS BEAD OF CAULK

1/2"

GABLE FLASHING; 4" END LAPS WITH CONTINUOUS CAULK AT LAPS

FASTENER WITH METAL BACKED NEOPRENE WASHER 20" O.C.

BERRIDGE M OR R PANEL

FASTENERS; 20" O.C. MAX.

30 FELT UNDERLAYMENT

TOP LAYER OF FELT TO BE PARALLEL WITH ROOF SLOPE

FASTENERS; 20" O.C. MAX.

SOLID SHEATHING

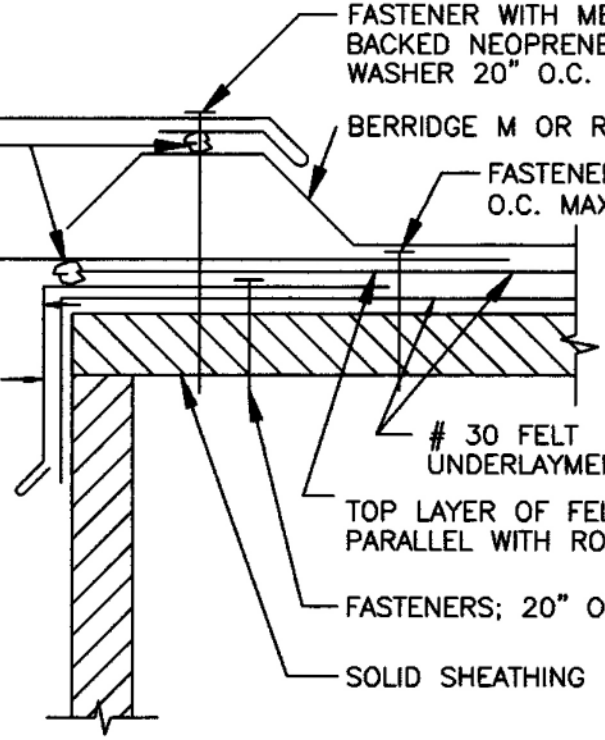

1. SOLID SHEATHING (BY OTHERS) TO BE MINIMUM 1/2" PLYWOOD OR EQUIVALENT IN STRENGTH FOR HOLDING POWER OF FASTENERS.
2. ALL FELT UNDERLAYMENT, CAULKING, AND FASTENERS, ARE ITEMS TO BE FURNISHED AND INSTALLED BY THE ROOFING INSTALLER AT THE DISCRETION OF THE ARCHITECT.

F = FINISH SIDE

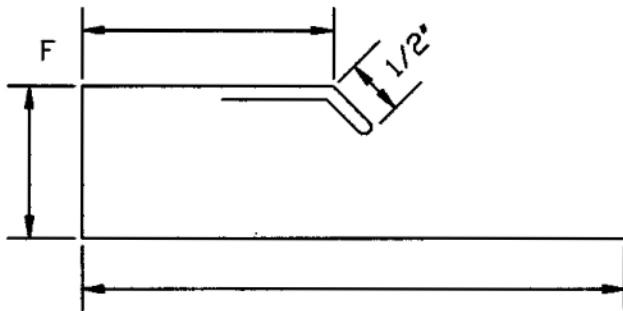

GABLE CHANNEL

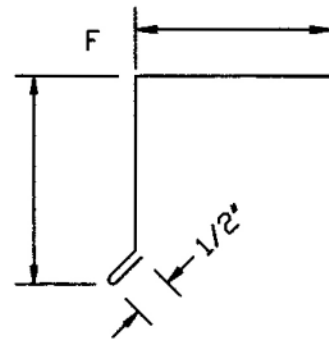

GABLE FLASHING



**Berridge
Manufacturing
Company**

GABLE DETAIL

M & R PANEL

DATE: 11/05/02

PAGE \ FILE

MR-30

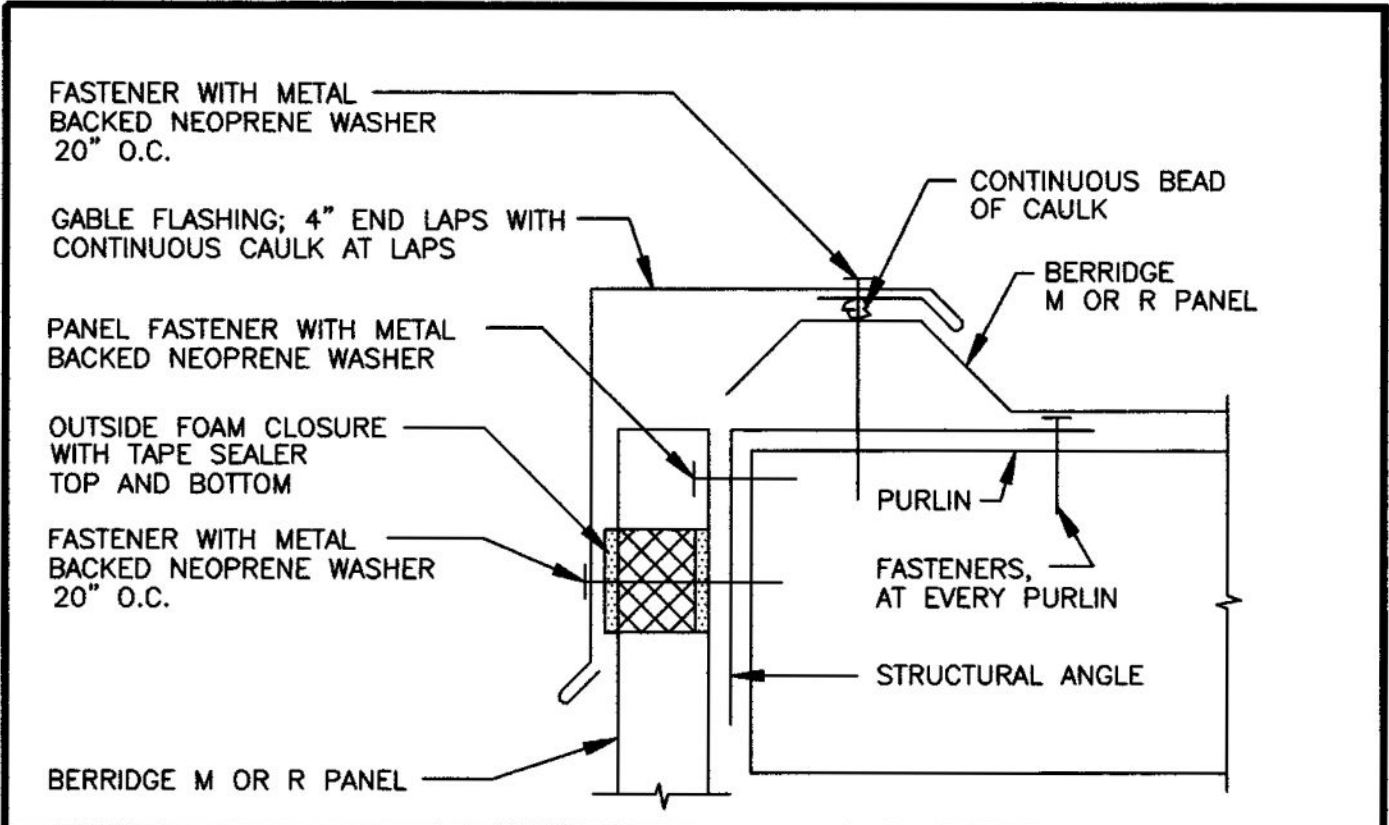

1. CAULKING AND FASTENERS ARE ITEMS TO BE FURNISHED AND INSTALLED BY THE ROOFING INSTALLER AT THE DISCRETION OF THE ARCHITECT.

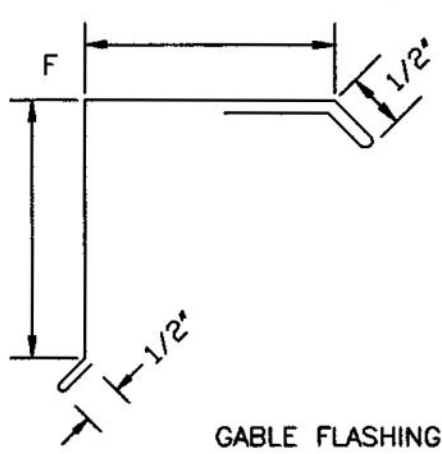

F = FINISH SIDE

GABLE FLASHING

DATE: 11/05/02	<p>GABLE DETAIL OPEN FRAMING</p> <p>M & R PANEL</p>	 <p>Berridge Manufacturing Company</p> <p><i>Roofs of Distinction</i></p>
PAGE\FILE MR-31		

FASTENER WITH METAL
BACKED NEOPRENE WASHER
20" O.C.

GABLE FLASHING; 4" END LAPS WITH
CONTINUOUS CAULK AT LAPS

CONTINUOUS BEAD
OF CAULK

BERRIDGE
M OR R PANEL

PANEL FASTENER WITH METAL
BACKED NEOPRENE WASHER

OUTSIDE FOAM CLOSURE
WITH TAPE SEALER
TOP AND BOTTOM

PURLIN

FASTENERS,
AT EVERY PURLIN

FASTENER WITH METAL
BACKED NEOPRENE WASHER
20" O.C.

STRUCTURAL ANGLE

BERRIDGE M OR R PANEL

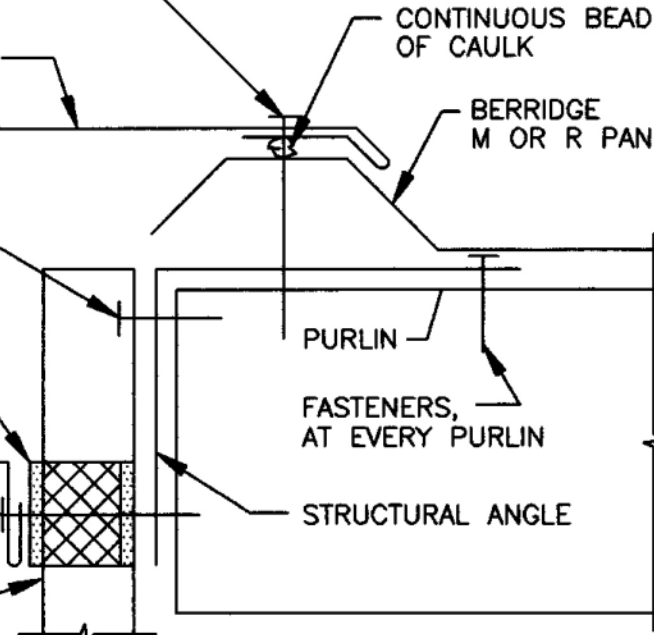

1. CAULKING AND FASTENERS ARE ITEMS TO BE FURNISHED AND INSTALLED BY THE ROOFING INSTALLER AT THE DISCRETION OF THE ARCHITECT.

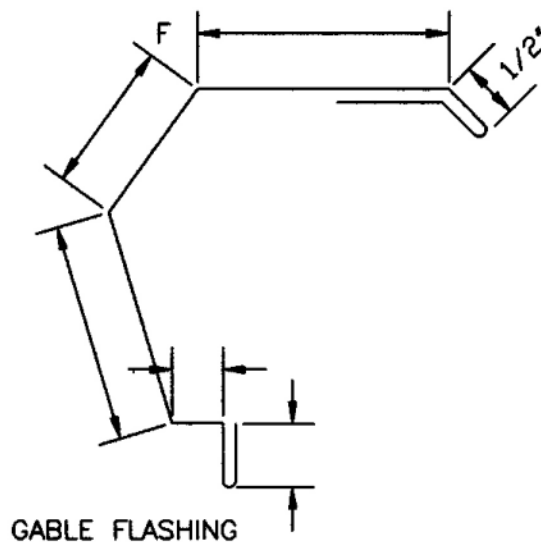

F = FINISH SIDE

GABLE FLASHING



Berridge
Manufacturing
Company

Roofs of Distinction

GABLE DETAIL
OPEN FRAMING

DATE: 11/05/02

M & R PANEL

PAGE\FILE
MR-32

CAP FLASHING; 4" END LAPS WITH CONTINUOUS CAULK AT LAPS. POP RIVET TO COUNTER FLASHING 40" O.C. MAX. CAULK ALL RIVET HEADS

FASTENERS; 20" O.C. MAX.

COUNTERFLASHING; 4" END LAPS WITH CONTINUOUS CAULK AT LAPS

SUB-FLASHING; 4" END LAPS WITH CONTINUOUS CAULK AT LAPS

30 FELT UNDERLAYMENT

OUTSIDE FOAM CLOSURE WITH TAPE SEALER TOP AND BOTTOM

BERRIDGE M OR R PANEL

SOLID SHEATHING

FASTENERS AT LAPS AND STAGGERED; 20" O.C. AND CAULK FASTENER HEADS

30 FELT UNDERLAYMENT

FASTENERS; WITH METAL BACKED NEOPRENE WASHER. 40" O.C. MAX.

PANEL FASTENERS; WITH METAL BACKED NEOPRENE WASHER.

FASTENERS; WITH METAL BACKED NEOPRENE WASHER. 20" O.C. MAX.

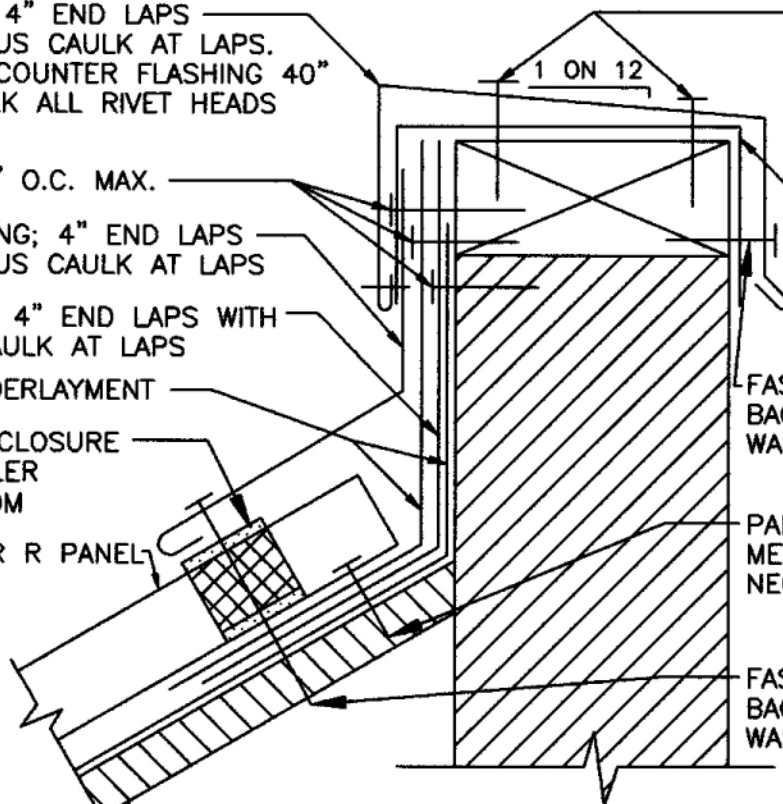

1. SOLID SHEATHING (BY OTHERS) TO BE MINIMUM 1/2" PLYWOOD OR EQUIVALENT IN STRENGTH FOR HOLDING POWER OF FASTENERS.
2. ALL FELT UNDERLAYMENT, CAULKING, AND FASTENERS, ARE ITEMS TO BE FURNISHED AND INSTALLED BY THE ROOFING INSTALLER AT THE DISCRETION OF THE ARCHITECT.

F = FINISH SIDE

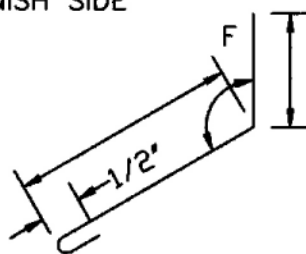

COUNTERFLASHING

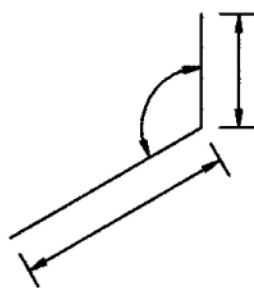

SUB-FLASHING

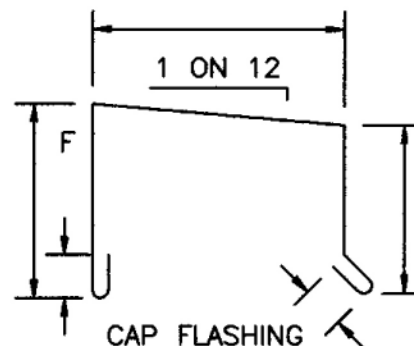

CAP FLASHING



**Berridge
Manufacturing
Company**

Roofs of Distinction

PARAPET DETAIL

DATE: 11/05/02

M & R PANEL

PAGE \ FILE

MR-40

BERRIDGE M OR R PANEL

COUNTERFLASHING; 4" END LAPS WITH CONTINUOUS CAULK AT LAPS.

SUB-FLASHING; 4" END LAPS WITH CONTINUOUS CAULK AT LAPS

INSIDE FOAM CLOSURE WITH TAPE SEALER TOP AND BOTTOM.

OUTSIDE FOAM CLOSURE WITH TAPE SEALER TOP AND BOTTOM.

FASTENERS; WITH METAL BACKED NEOPRENE WASHER. 20" O.C.

BERRIDGE M OR R PANEL

FASTENERS; 20" O.C. MAX.

PANEL FASTENERS; WITH METAL BACKED NEOPRENE WASHER

PANEL FASTENERS; WITH METAL BACKED NEOPRENE WASHER

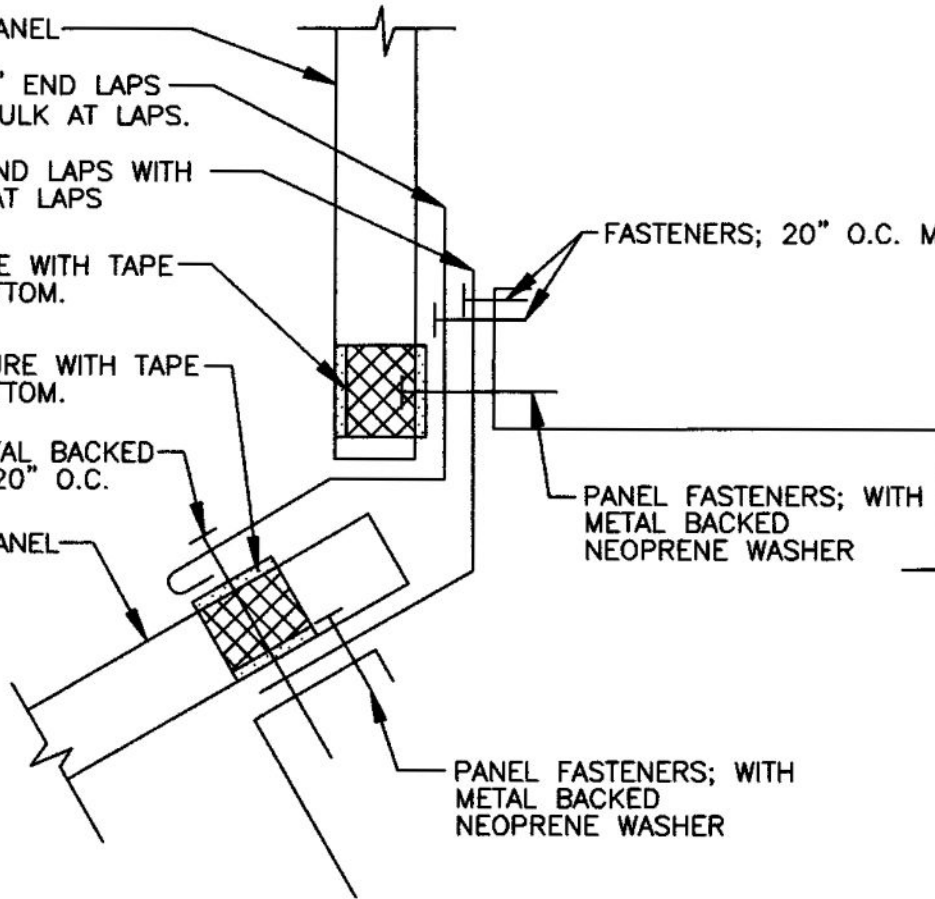

1. CAULKING AND FASTENERS ARE ITEMS TO BE FURNISHED AND INSTALLED BY THE ROOFING INSTALLER AT THE DISCRETION OF THE ARCHITECT.

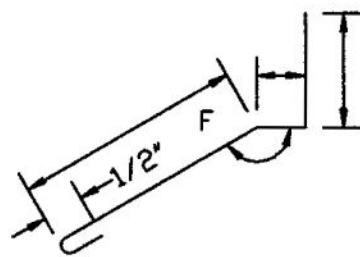

COUNTERFLASHING

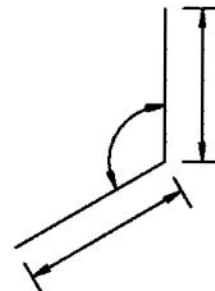

SUB-FLASHING

F = FINISH SIDE

DATE: 11/05/02

HEAD WALL DETAIL OPEN FRAMING

PAGE\FILE
MR-41

M & R PANEL



**Berridge
Manufacturing
Company**

REGLET FLASHING; 4" END LAPS WITH CONTINUOUS CAULK AT LAPS

FASTENERS; 20" O.C. MAX.

COUNTERFLASHING; 4" END LAPS WITH CONTINUOUS CAULK AT LAPS.

SUB-FLASHING; 4" END LAPS WITH CONTINUOUS CAULK AT LAPS

BERRIDGE M OR R PANEL

OUTSIDE FOAM CLOSURE WITH TAPE SEALER TOP AND BOTTOM.

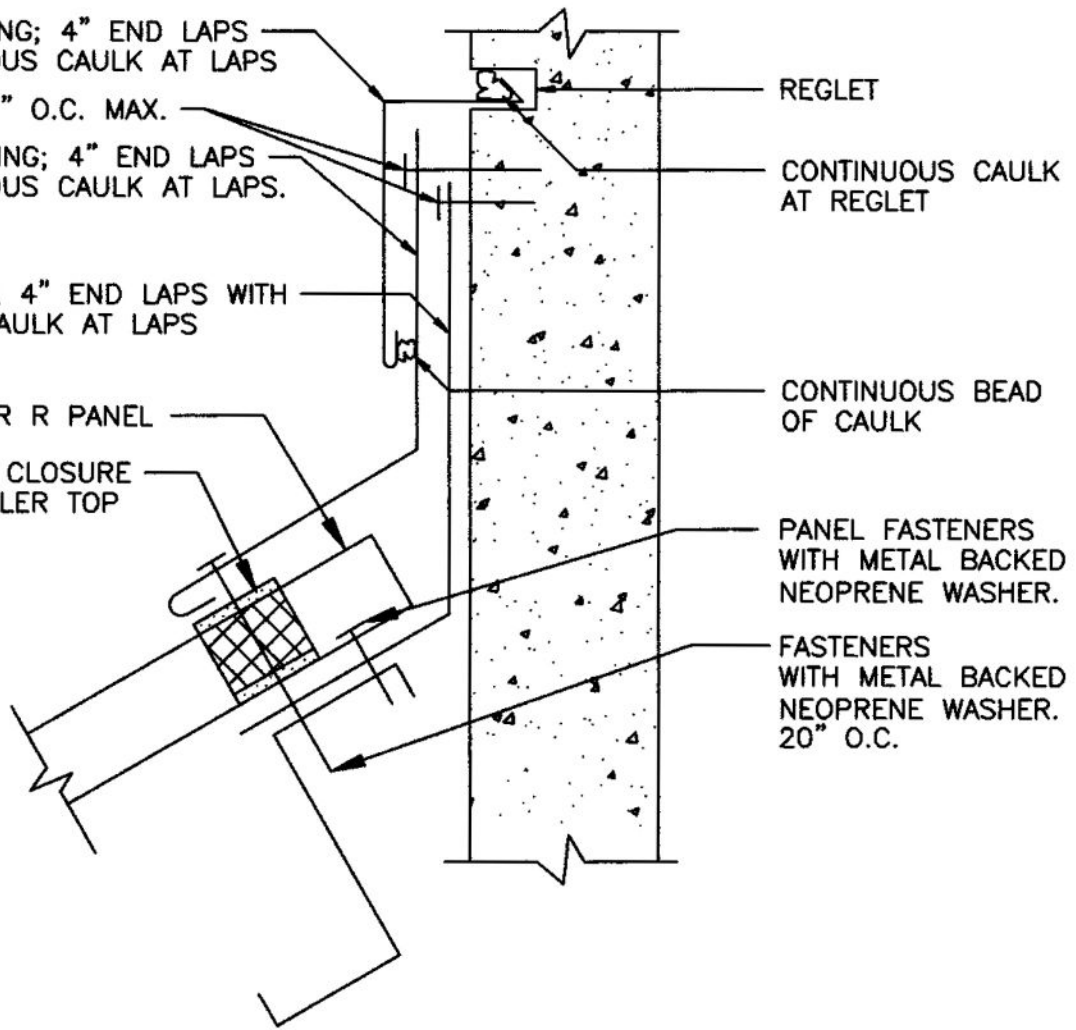

1. CAULKING AND FASTENERS ARE ITEMS TO BE FURNISHED AND INSTALLED BY THE ROOFING INSTALLER AT THE DISCRETION OF THE ARCHITECT.

F = FINISH SIDE

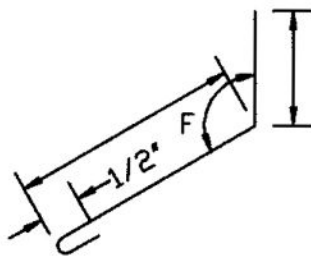

COUNTERFLASHING

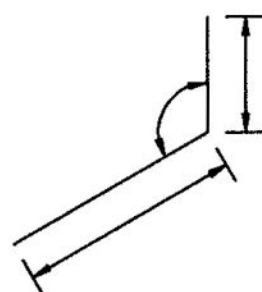

SUB-FLASHING

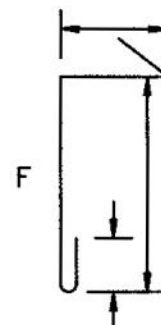

REGLET FLASHING



**Berridge
Manufacturing
Company**

HEAD WALL DETAIL
OPEN FRAMING

M & R PANEL

DATE: 11/05/02

PAGE\FILE

MR-42

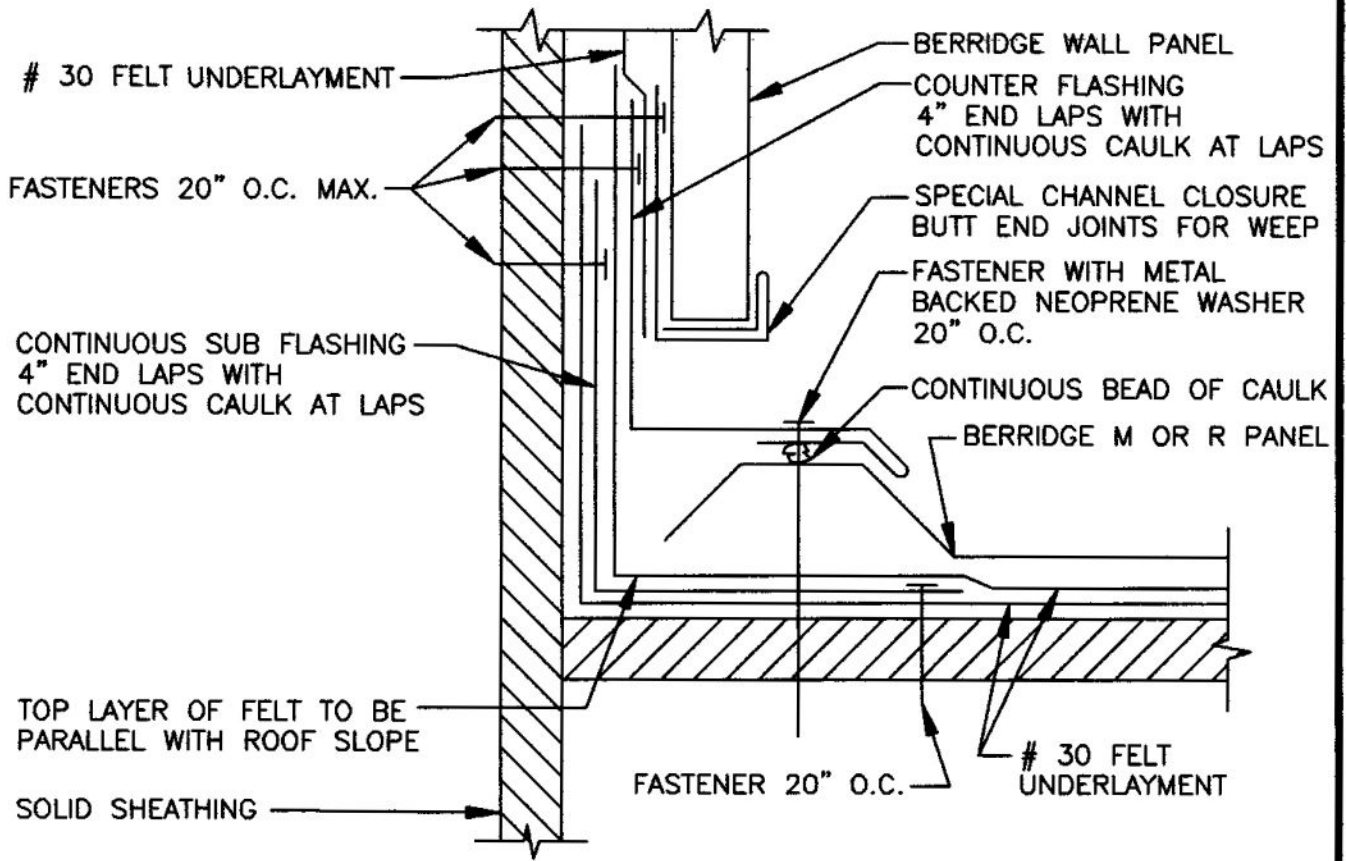

1. SOLID SHEATHING (BY OTHERS) TO BE MINIMUM 1/2" PLYWOOD OR EQUIVALENT IN STRENGTH FOR HOLDING POWER OF FASTENERS.
2. ALL FELT UNDERLAYMENT, CAULKING, AND FASTENERS, ARE ITEMS TO BE FURNISHED AND INSTALLED BY THE ROOFING INSTALLER AT THE DISCRETION OF THE ARCHITECT.

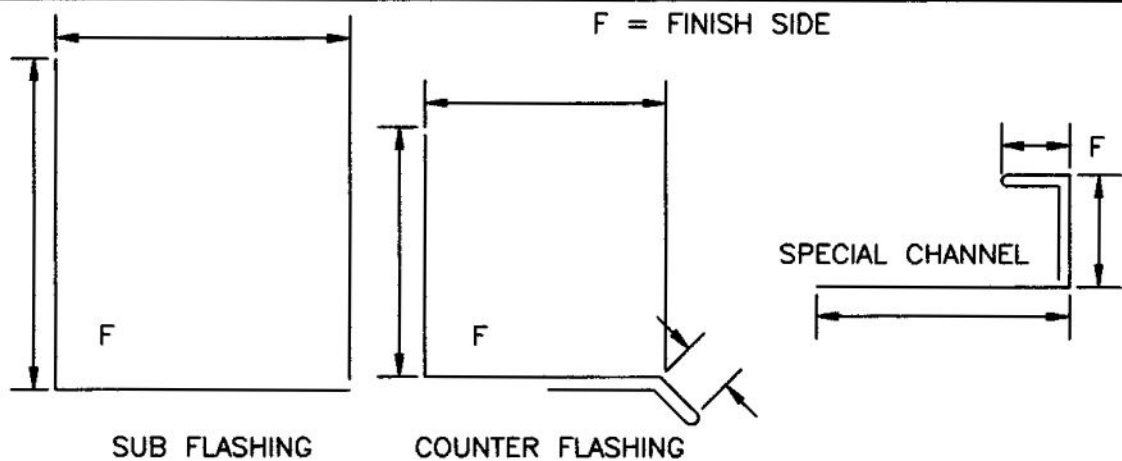

**Berridge
Manufacturing
Company**

Roofs of Distinction

RAKE WALL
WITH WALL PANEL

M & R PANEL

DATE: 11/05/02

PAGE\FILE

MR-50

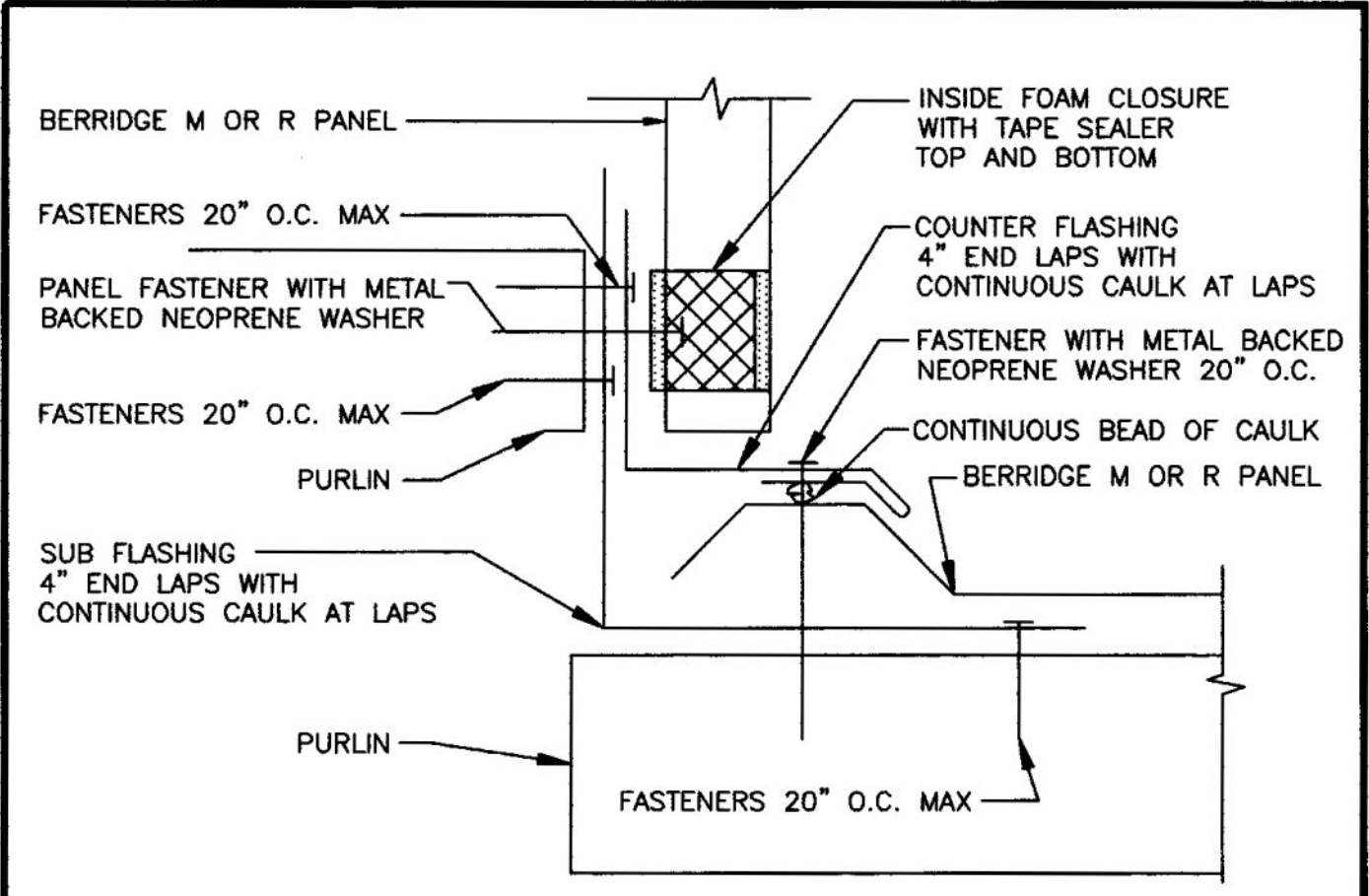

1. CAULKING AND FASTENERS ARE ITEMS TO BE FURNISHED AND INSTALLED BY THE ROOFING INSTALLER AT THE DISCRETION OF THE ARCHITECT.

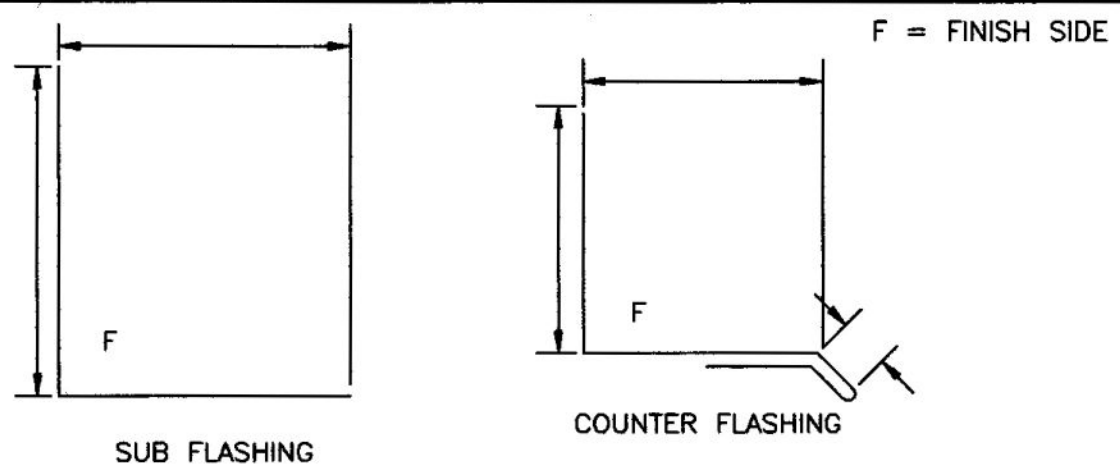

DATE: 11/05/02

PAGE\FILE
MR-51

RAKE WALL DETAIL
OPEN FRAMING

M & R PANEL

**Berridge
Manufacturing
Company**

Roofs of Distinction

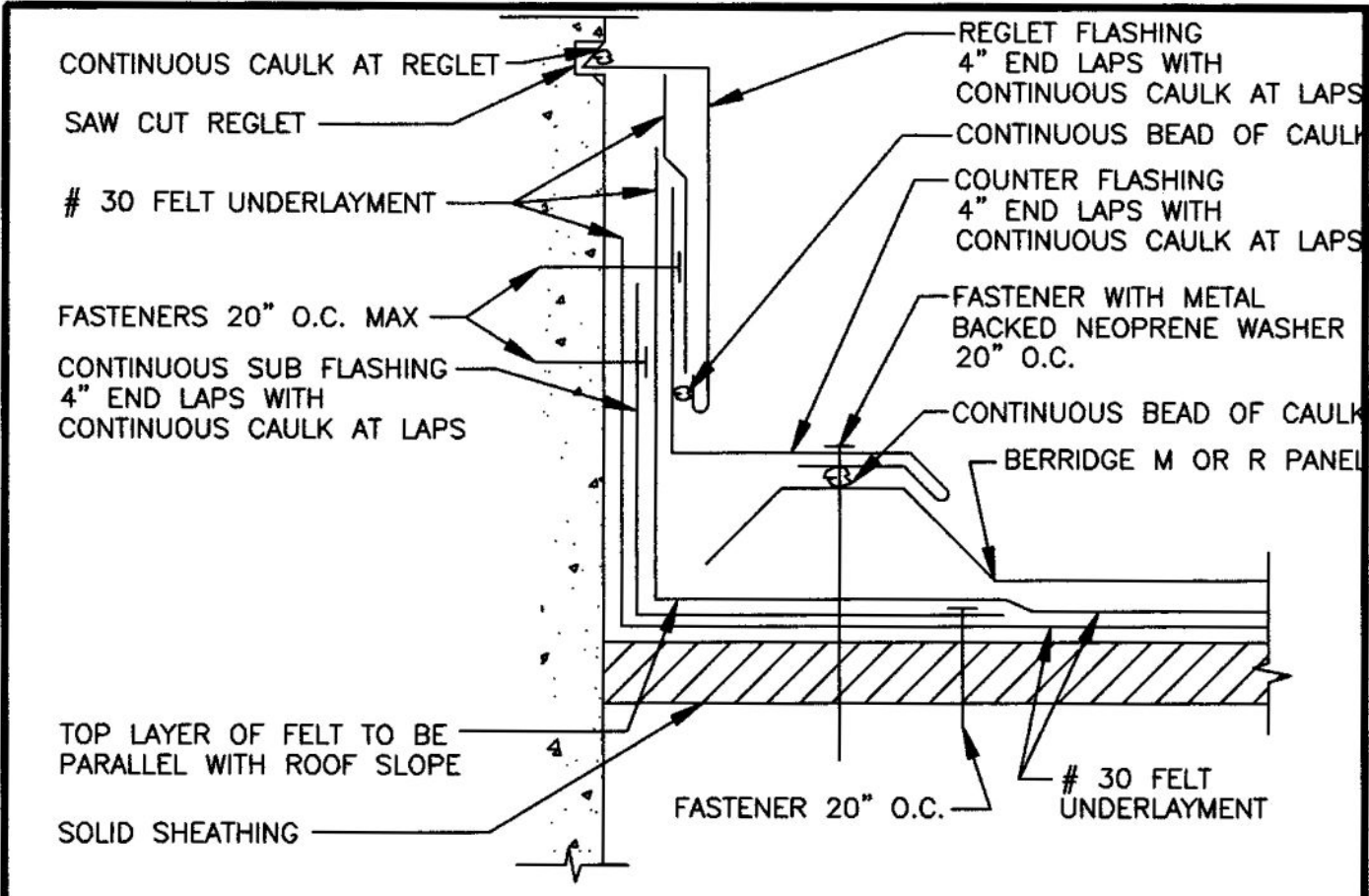

1. SOLID SHEATHING (BY OTHERS) TO BE MINIMUM 1/2" PLYWOOD OR EQUIVALENT IN STRENGTH FOR HOLDING POWER OF FASTENERS.
2. ALL FELT UNDERLAYMENT, CAULKING, AND FASTENERS, ARE ITEMS TO BE FURNISHED AND INSTALLED BY THE ROOFING INSTALLER AT THE DISCRETION OF THE ARCHITECT.

F = FINISH SIDE

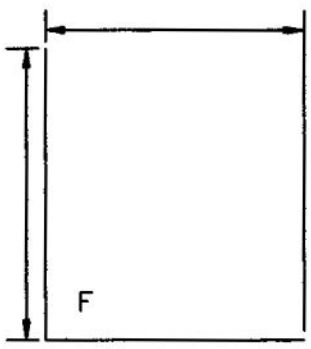

SUB FLASHING

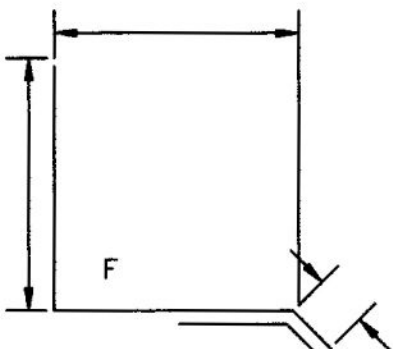

COUNTER FLASHING

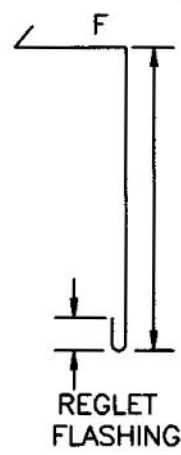

REGLET FLASHING

RAKE WALL DETAIL
WITH REGLET

M & R PANEL

DATE: 11/05/02

PAGE\FILE
MR-52

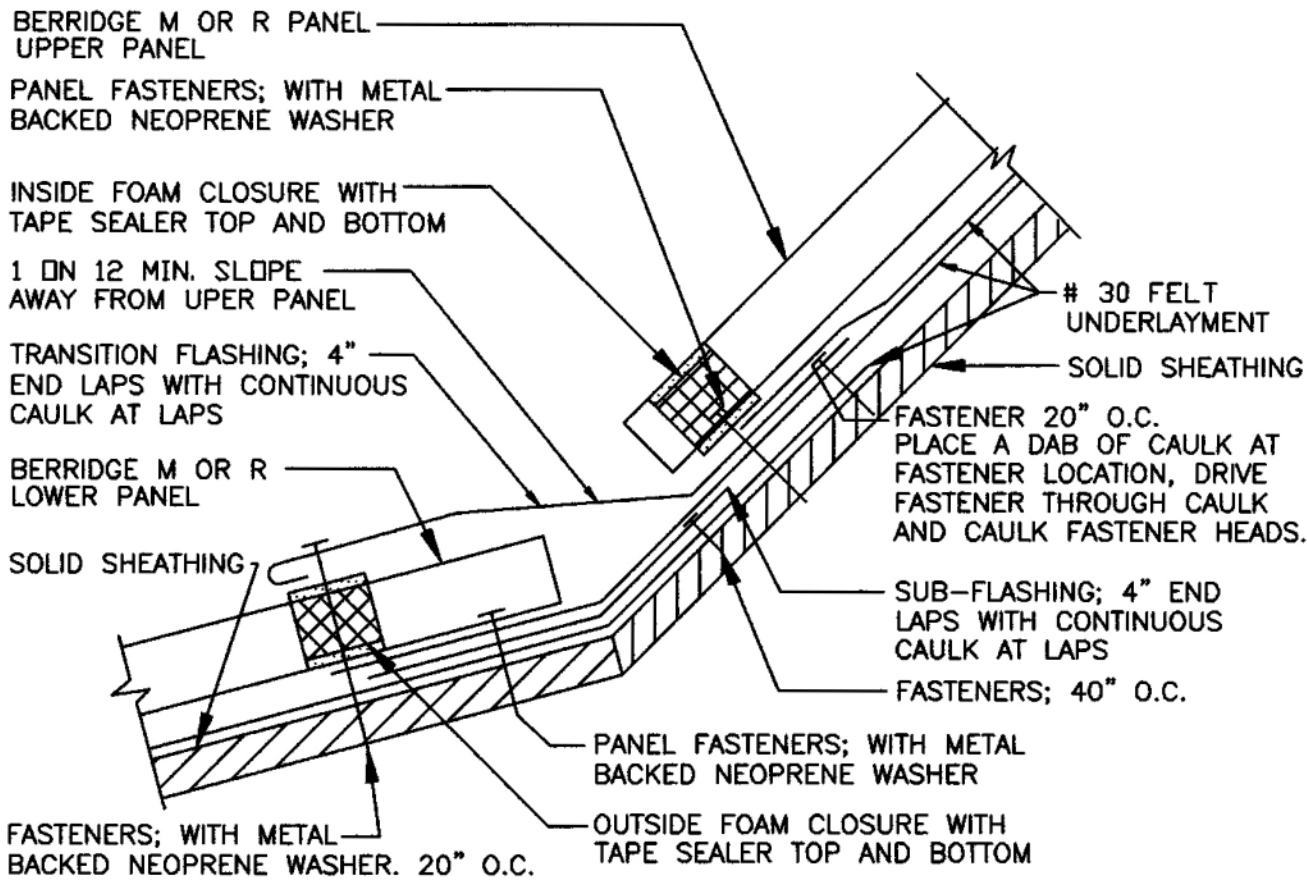

1. SOLID SHEATHING (BY OTHERS) TO BE MINIMUM 1/2" PLYWOOD OR EQUIVALENT IN STRENGTH FOR HOLDING POWER OF FASTENERS.
2. ALL FELT UNDERLAYMENT, CAULKING, AND FASTENERS, ARE ITEMS TO BE FURNISHED AND INSTALLED BY THE ROOFING INSTALLER AT THE DISCRETION OF THE ARCHITECT.

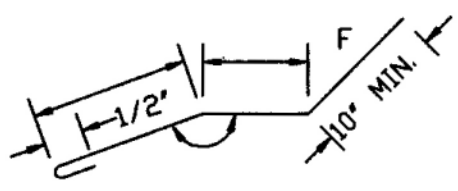

TRANSITION FLASHING

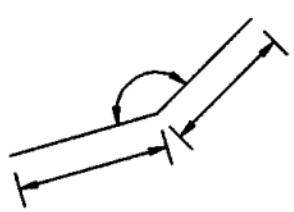

SUB-FLASHING

F = FINISH SIDE

B
Berridge
Manufacturing
Company
Roofs of Distinction

SLOPE TRANSITION DETAIL
M & R PANEL

DATE: 11/05/02
 PAGE\FILE
MR-60

BERRIDGE M OR R PANEL

CONTINUOUS BEAD OF CAULK
BETWEEN VALLEY FLASHING
AND FELT UNDERLAYMENT

EXPANDABLE FOAM
CLOSURE WITH TAPE
SEALER TOP AND BOTTOM

FASTENERS
20" O.C. MAX.

30 FELT
UNDERLAYMENT

VALLEY FLASHING
12" END LAPS WITH (2)
CONTINUOUS BEADS CAULK
AT LAPS

SOLID SHEATHING

9" MIN.

PANEL FASTENER WITH
METAL BACKED NEOPRENE
WASHER

1. SOLID SHEATHING (BY OTHERS) TO BE A MINIMUM OF 1/2" PLYWOOD OR EQUIVALENT IN STRENGTH FOR HOLDING POWER OF FASTENERS.
2. ALL FELT UNDERLAYMENT, CAULKING, AND FASTENERS, ARE ITEMS TO BE FURNISHED AND INSTALLED BY THE ROOFING INSTALLER AT THE DISCRETION OF THE ARCHITECT.

F = FINISH SIDE

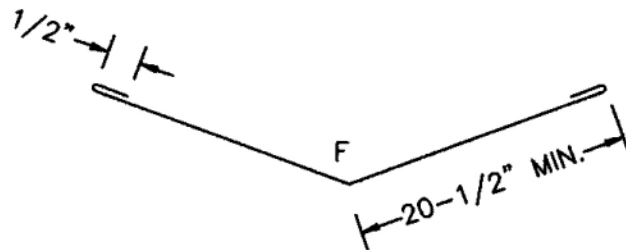

VALLEY FLASHING



**Berridge
Manufacturing
Company**

VALLEY DETAIL

DATE: 11/05/02

M & R PANEL

PAGE \ FILE
MR-70

BERRIDGE M OR R PANEL

CONTINUOUS BEAD OF CAULK BETWEEN VALLEY FLASHING AND FELT UNDERLAYMENT

EXPANDABLE FOAM CLOSURE WITH TAPE SEALER TOP AND BOTTOM

FASTENERS 20" O.C. MAX.

GRACE ICE AND WATERSHIELD

VALLEY FLASHING 12" END LAPS WITH (2) CONTINUOUS BEADS CAULK AT LAPS

FLAT SHEET VALLEY SUB-FLASHING

BERRIDGE CORRUGATED S-DECK

9" MIN.

PANEL FASTENER WITH METAL BACKED NEOPRENE WASHER

GRACE ICE AND WATER SHIELD RUN RIDGE TO EAVE

FLAT SHEET VALLEY SUB-FLASHING RUN RIDGE TO EAVE

BERRIDGE CORRUGATED S-DECK

RIDGE

SLOPE

PURLINS

EACH SIDE

SEE SECTION

FLAT SHEET VALLEY SUB-FLASHING

GRACE ICE AND WATER SHIELD

16 GA. HAT SECTION

PURLIN

BERRIDGE CORRUGATED S-DECK SECTION

16 GA. HAT SECTION SIZED TO FIT OVER PURLIN AND TO ACCOMMODATE THE DEPTH OF THE BERRIDGE CORRUGATED S-DECK.

ROOFS WITH A SLOPE OF 4:12 OR LESS 6'-0" MIN.
ROOFS ABOVE 4:12 3'-0" MIN.

DATE: 11/05/02

VALLEY DETAIL OPEN FRAMING

PAGE FILE
MR-71

M & R PANEL



Berridge
Manufacturing
Company

Roofs of Distinction

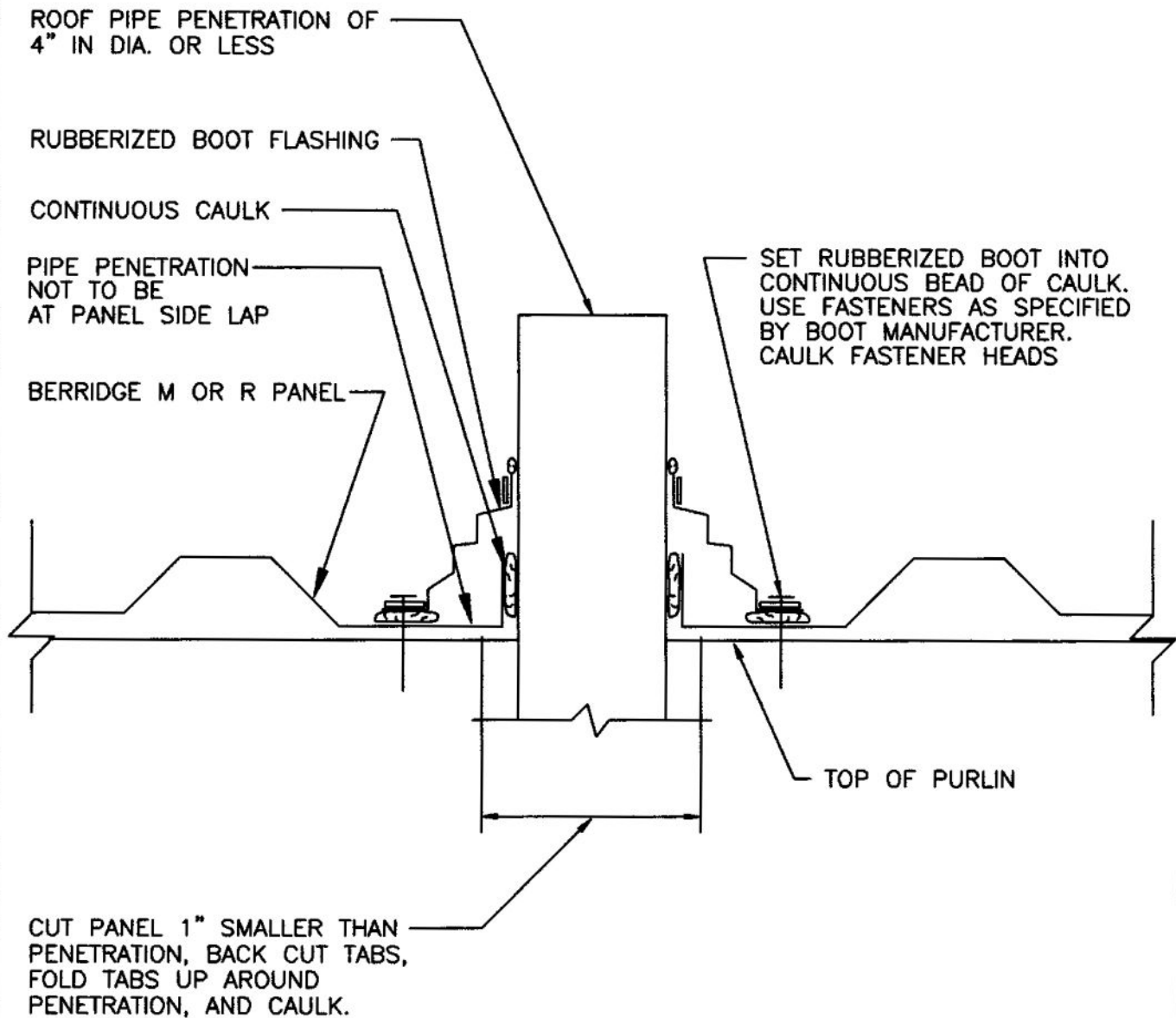

NOTE: IF PIPE IS MADE OF METAL, IT MUST BE PAINTED TO PREVENT RUST RUN-OFF FROM STAINING PANELS.

NOTE: POSITION SQUARE BASED BOOTS IN A DIAMOND ORIENTATION WHERE POSSIBLE TO AID IN DIVERTING WATER.



PIPE PENETRATION
(PREFERRED METHOD)
IN PAN OF PANEL ONLY
4" DIA. OR LESS

DATE: 11/05/02

PAGE\FILE
MR-80

M & R PANEL

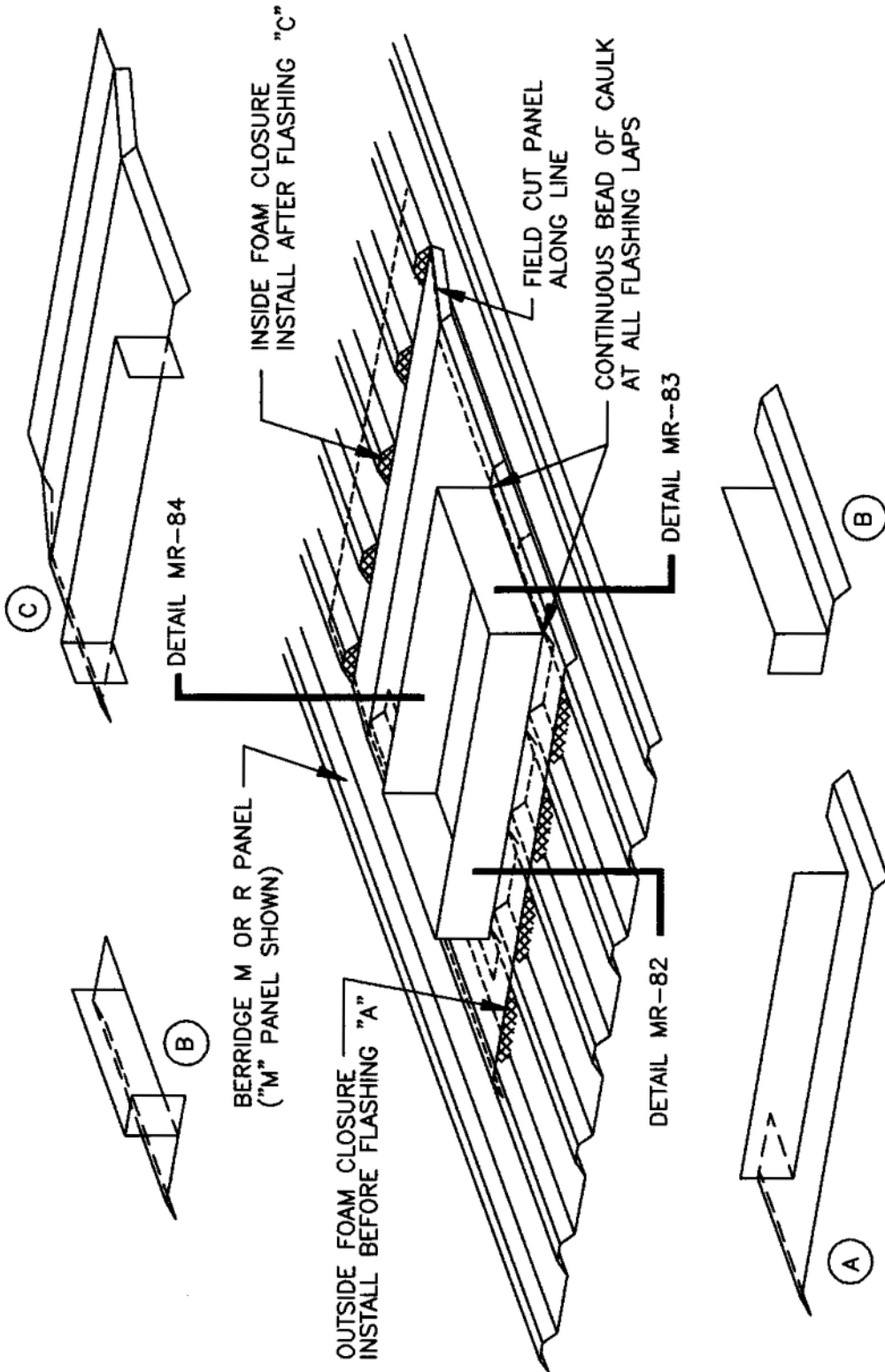

FIELD CUT PANEL ALONG DOTTED LINE AND INSTALL PANEL. INSTALL FLASHING "A" FIRST ALONG WITH FOAM CLOSURE. INSTALL FLASHING "B" SECOND. CAULK ALL FLASHING LAPS. INSTALL FLASHING "C" LAST. THIS FLASHING IS TO BE SLIPPED UNDER THE M OR R PANEL AND FELT AS SHOWN IN DETAIL MR-84 BEFORE THE FOAM CLOSURE OR FASTENERS ARE INSTALLED. SEE ALSO DETAILS MR-82 AND MR-83 FOR FELTING AND SUBFLASHING.

DATE: 11/05/02

ROOF PENETRATION

PAGE \ FILE
MR-81

M & R PANEL



Berridge
Manufacturing
Company

Roofs of Distinction

FASTENERS; 20" O.C. MAX.

COUNTERFLASHING; 4" END LAPS WITH CONTINUOUS CAULK AT LAPS

PANEL FASTENERS WITH METAL BACKED NEOPRENE WASHER.

OUTSIDE FOAM CLOSURE WITH TAPE SEALER TOP AND BOTTOM

BERRIDGE M OR R PANEL

SOLID SHEATHING

FLASHING FROM MECHANICAL EQUIPMENT BY OTHERS

CONTINUOUS ANGLE FLASHING TYPICAL ALL 4 SIDES OF PENETRATION

30 FELT UNDERLAYMENT

TOP LAYER OF # 30 FELT UNDERLAYMENT TO BE PERPENDICULAR TO ROOF SLOPE

FASTENERS WITH METAL BACKED NEOPRENE WASHER. 20" O.C. MAX.

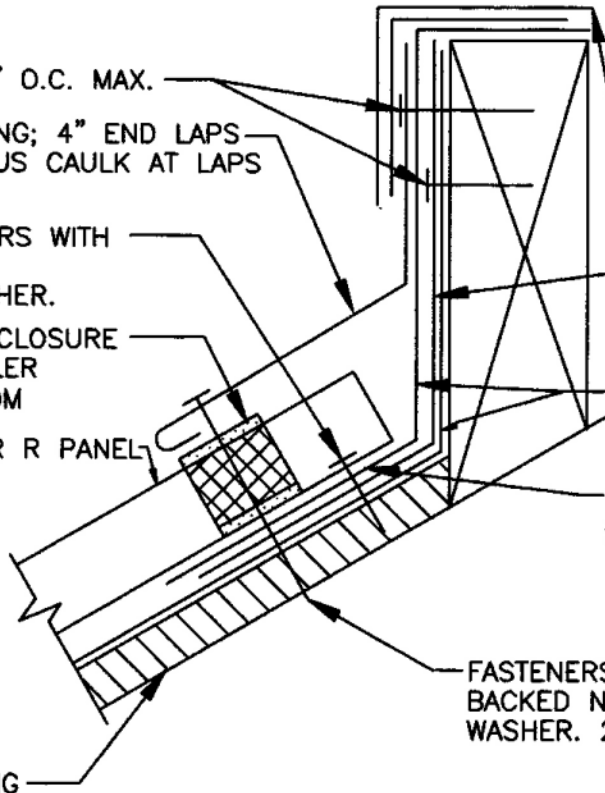

1. SOLID SHEATHING (BY OTHERS) TO BE MINIMUM 1/2" PLYWOOD OR EQUIVALENT IN STRENGTH FOR HOLDING POWER OF FASTENERS.

2. ALL FELT UNDERLAYMENT, CAULKING, AND FASTENERS, ARE ITEMS TO BE FURNISHED AND INSTALLED BY THE ROOFING INSTALLER AT THE DISCRETION OF THE ARCHITECT.

F = FINISH SIDE

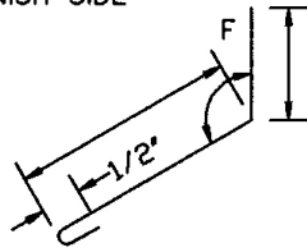

COUNTER FLASHING SIDE A

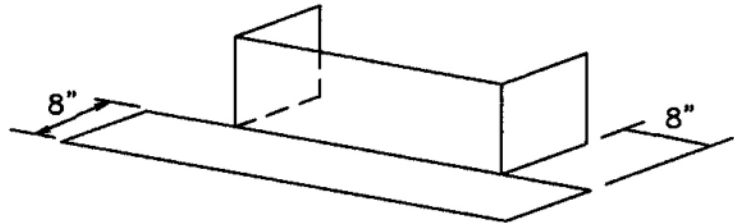

ANGLE FLASHING



Berridge Manufacturing Company

Roofs of Distinction

ROOF PENETRATION SIDE A

M & R PANEL

DATE: 11/05/02

PAGE\FILE

MR-82

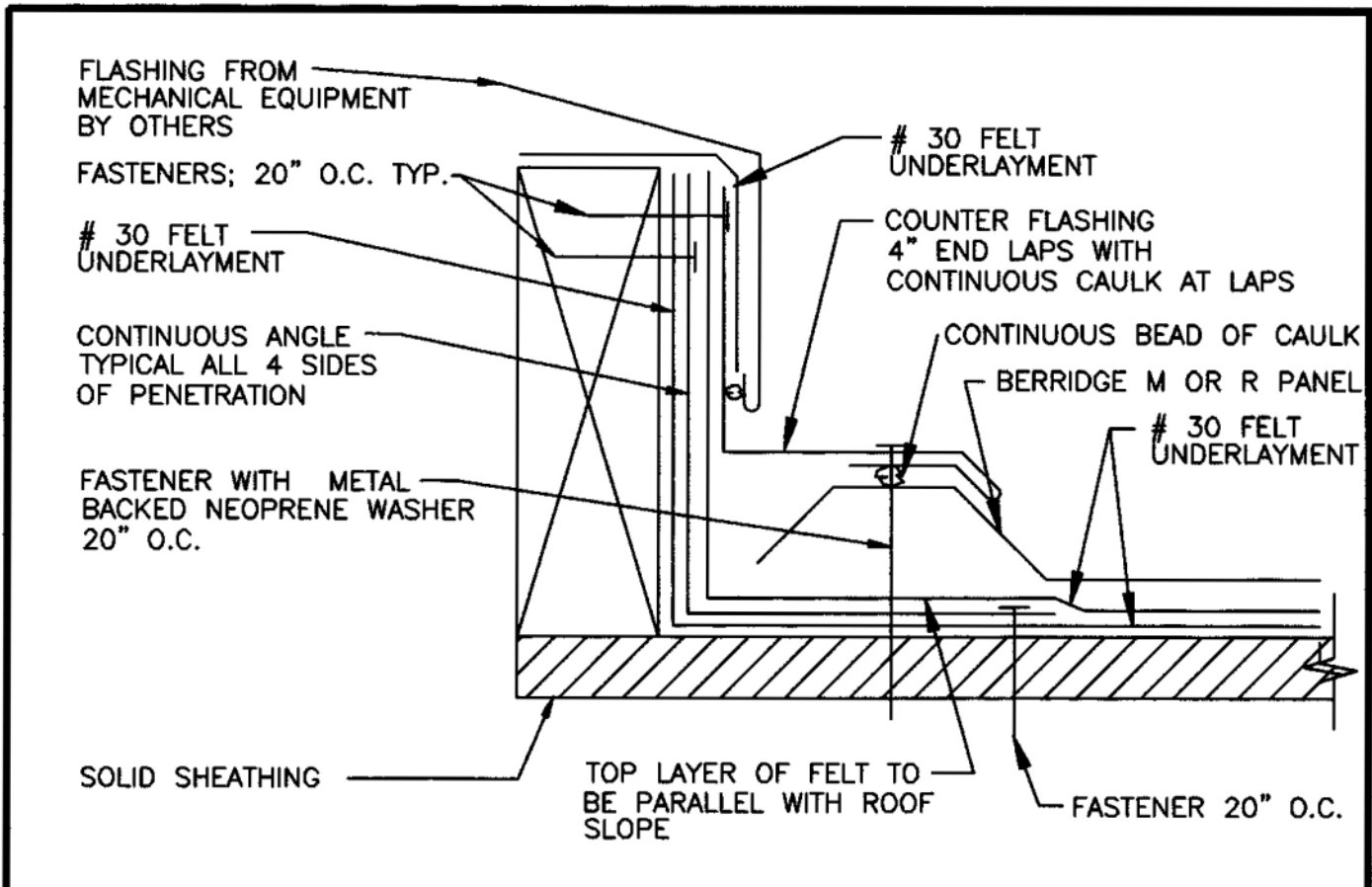

1. SOLID SHEATHING (BY OTHERS) TO BE MINIMUM 1/2" PLYWOOD OR EQUIVALENT IN STRENGTH FOR HOLDING POWER OF FASTENERS.
2. ALL FELT UNDERLAYMENT, CAULKING, AND FASTENERS, ARE ITEMS TO BE FURNISHED AND INSTALLED BY THE ROOFING INSTALLER AT THE DISCRETION OF THE ARCHITECT.

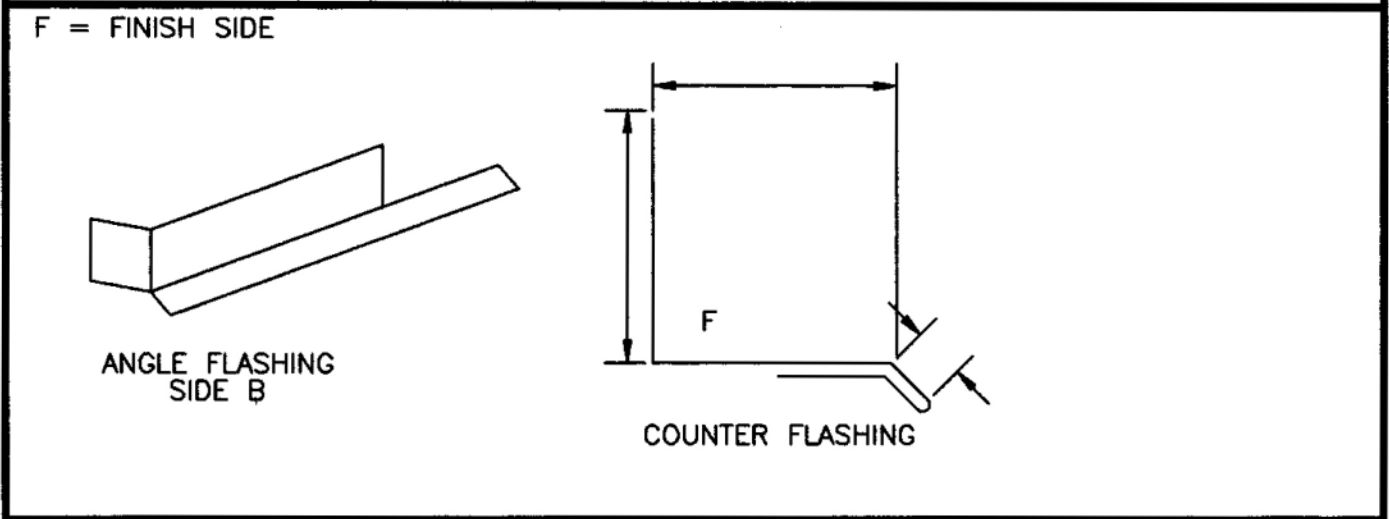

DATE: 11/05/02

PAGE\FILE
MR-83

ROOF PENETRATION
SIDE B

M & R PANEL

Berridge
Manufacturing
Company

Roofs of Distinction

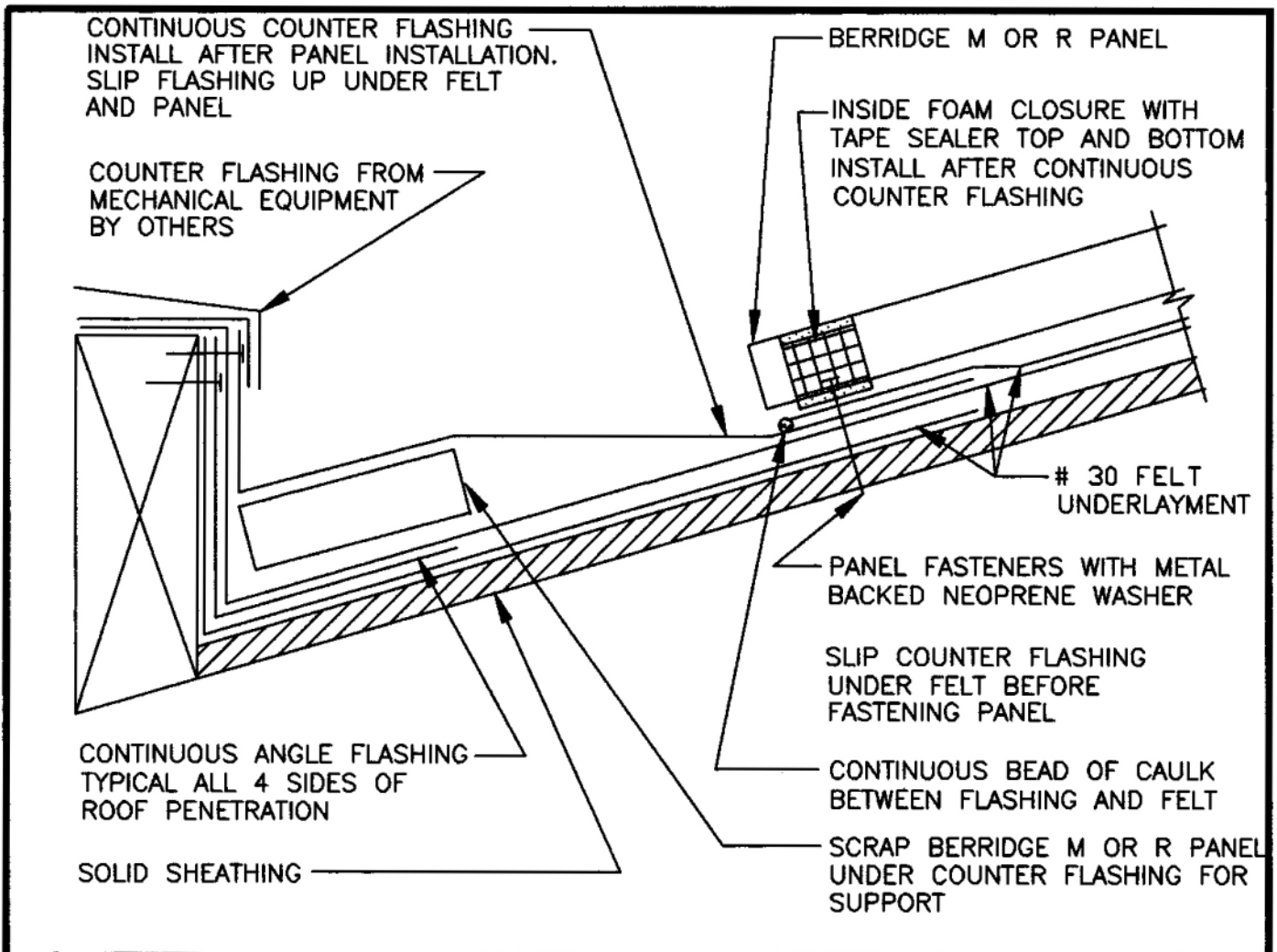

1. SOLID SHEATHING (BY OTHERS) TO BE MINIMUM 1/2" PLYWOOD OR EQUIVALENT IN STRENGTH FOR HOLDING POWER OF FASTENERS.
2. ALL FELT UNDERLAYMENT, CAULKING, AND FASTENERS, ARE ITEMS TO BE FURNISHED AND INSTALLED BY THE ROOFING INSTALLER AT THE DISCRETION OF THE ARCHITECT.

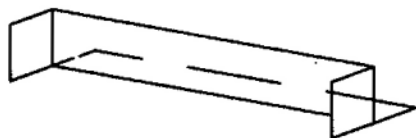

ANGLE FLASHING

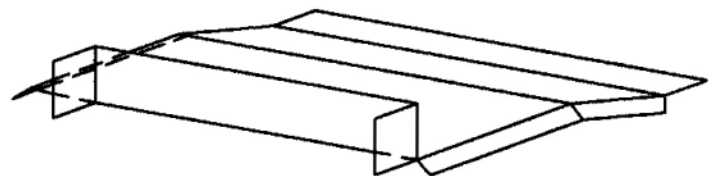

COUNTER FLASHING
SIDE C

F = FINISH SIDE



**Berridge
Manufacturing
Company**

Roofs of Distinction

ROOF PENETRATION
SIDE C

M & R PANEL

DATE: 11/05/02

PAGE\FILE

MR-84

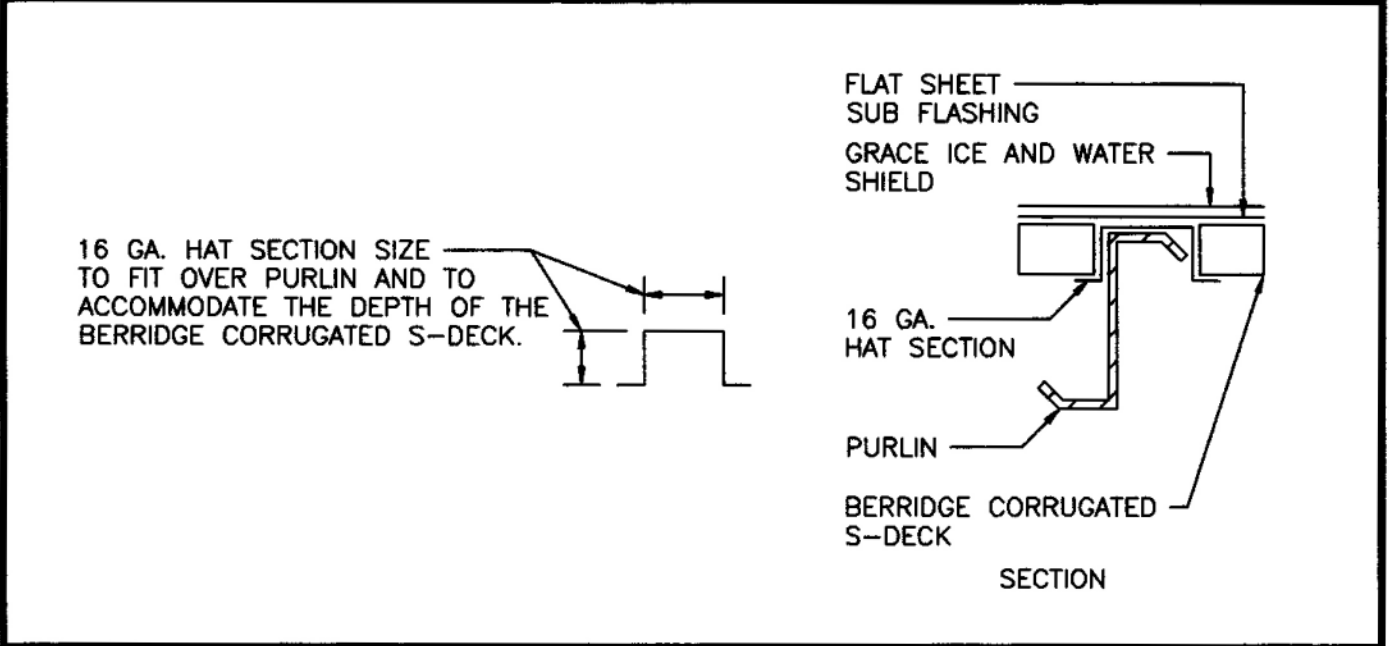
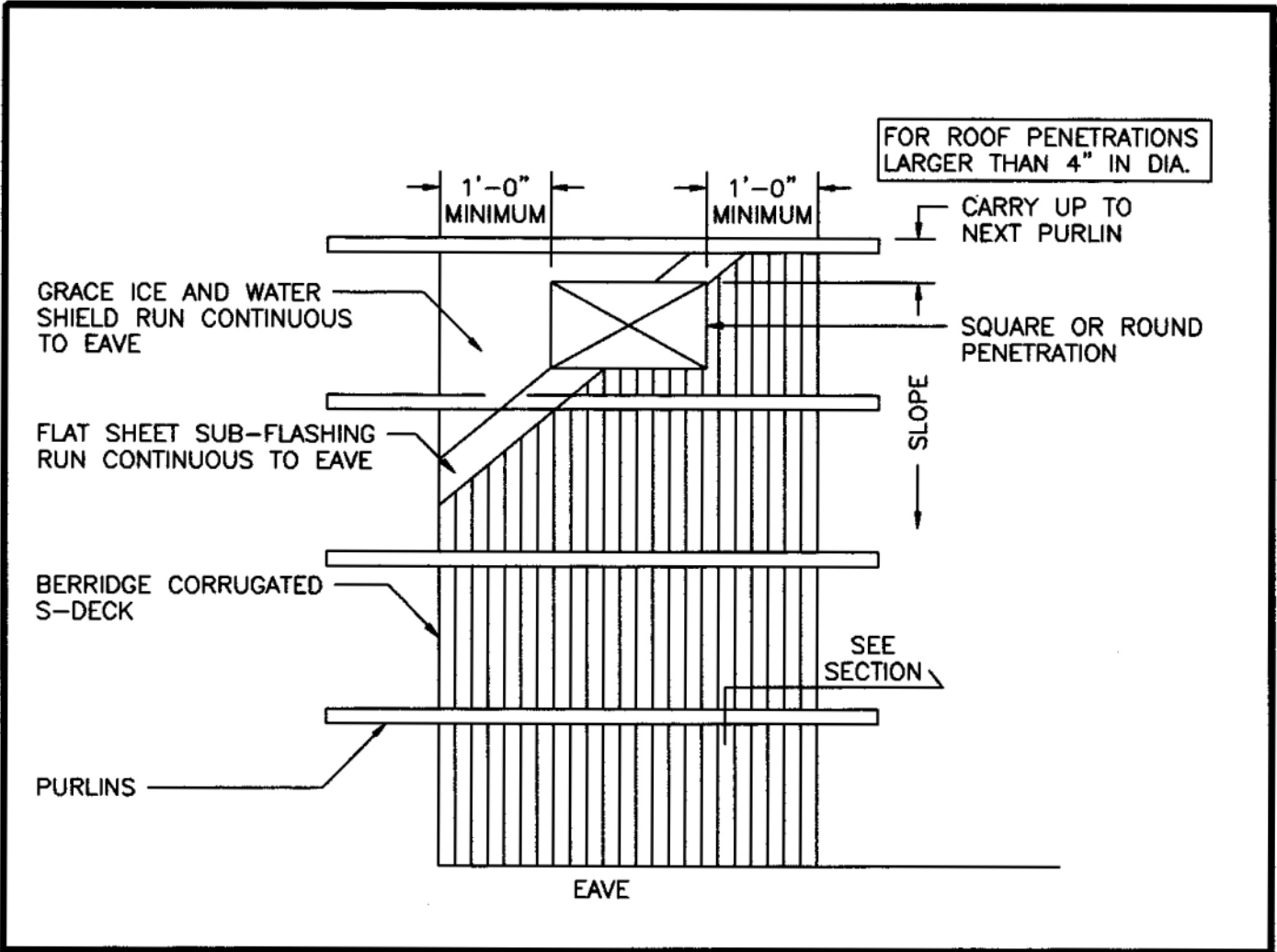

DATE: 11/05/02

PAGE\FILE
MR-85

PENETRATION LARGER THAN 4" OPEN FRAMING

M & R PANEL

Berridge Manufacturing Company

Roofs of Distinction

CONSTRUCTION NO. 39

UPLIFT: CLASS 90
FIRE NOT INVESTIGATED

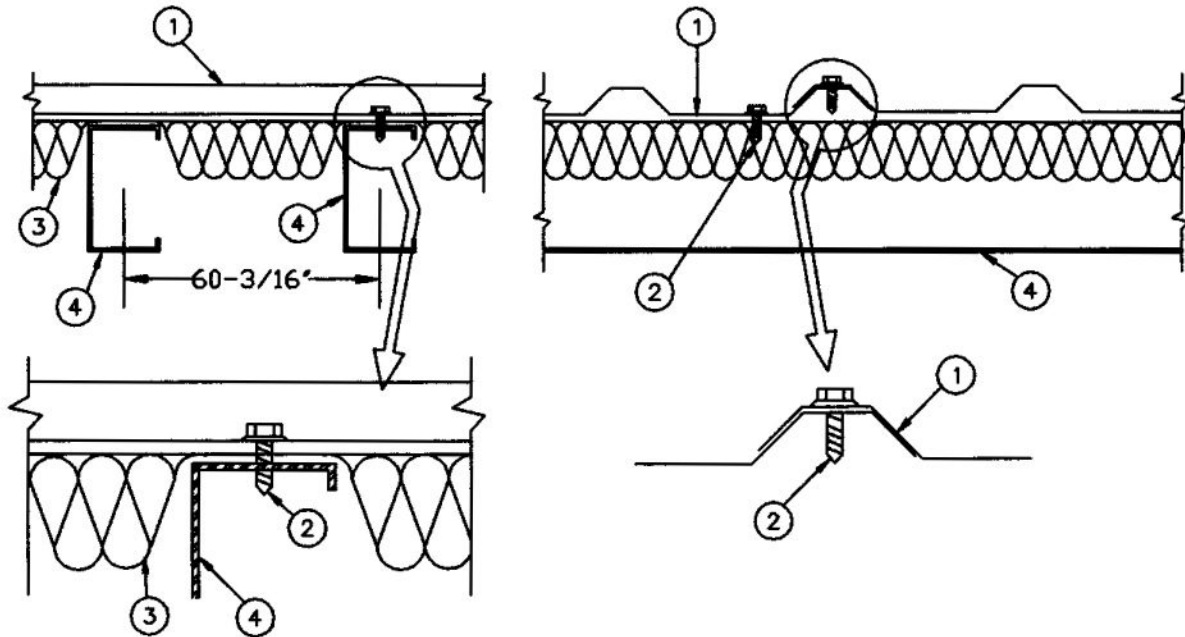

1. METAL ROOF DECK PANELS*: NO. 26 MSG MIN GAUGE COATED STEEL. PANELS CONTINUOUS OVER TWO OR MORE SPANS. END LAPS TO OCCUR OVER PURLINS WITH PANELS OVERLAPPED 6 IN. WITH LAP BEGINNING 1 IN. FROM EDGE OF PURLIN FLANGE AND EXTENDING ACROSS PURLIN. A BEAD OF SEALANT MAY BE USED AT PANEL END AND SIDE LAPS.
BERRIDGE MFG CO.: TYPE "M"
2. PANEL FASTENERS: FOR PANEL TO PURLIN AND PANEL TO PANEL CONNECTIONS TO BE NO.14 SELF-TAPPING, HEX-HEAD, PLATED STEEL OR STAINLESS STEEL SCREWS WITH A SEPARATE 5/8 IN. O.D. STEEL OR ALUMINUM WASHER AND A SEPARATE NEOPRENE SEALING WASHER. LENGTH: FOR PANEL TO PURLIN FASTENERS TO BE 3/4 IN. FOR INSULATION UP TO 3 IN. AND 1-1/4 IN. FOR INSULATION OVER 3 IN. FOR PANEL TO PANEL FASTENERS TO BE 3/4 IN. SPACING FOR PANEL TO PURLIN FASTENERS TO BE 6 IN. O.C. WITH FASTENERS LOCATED ADJACENT TO THE MAJOR RIBS. PILOT HOLES: FOR PANEL TO PURLIN FASTENERS TO BE 13/64 IN. DIAM.
FOR PANEL TO PANEL FASTENERS TO BE 1/8 IN. DIAM.
AT END LAPS SPACING TO BE 6 IN. O.C. WITH FASTENERS LOCATED ADJACENT TO MAJOR RIBS.
SPACING FOR PANEL TO PANEL FASTENERS TO BE 12 IN. O.C.
PILOT HOLES: FOR PANEL TO PURLIN FASTENERS TO BE 13/64 IN. DIAM.
FOR PANEL TO PANEL FASTENERS TO BE 1/8 IN. DIAM.
AS AN ALTERNATE FASTENER: NO. 12-14 SELF-DRILLING, SELF-TAPPING, 1/2 IN. HEX-WASHER HEAD TYPE B STEEL OR STAINLESS STEEL SCREWS WITH NEOPRENE SEALING WASHER MAY BE USED. LENGTH: FOR PANEL TO PURLIN FASTENERS TO BE 1 IN. FOR INSULATION UP TO 3 IN. AND 1-1/2 IN. FOR INSULATION OVER 3 IN. FOR PANEL TO PANEL FASTENERS TO BE 1 IN. SPACING TO BE THE SAME.
3. INSULATION: (OPTIONAL) ANY COMPRESSIBLE BLANKET INSULATION 4 IN. MAX THICKNESS BEFORE COMPRESSION.
4. PURLINS: NO. 16 MSG MIN GAUGE STEEL (55,000 PSI MIN YIELD STRENGTH). REFER TO GENERAL INFORMATION. ROOF DECK CONSTRUCTION (ROOFING MATERIALS AND SYSTEMS DIRECTORY) FOR ITEMS NOT EVALUATED.
*BEARING THE UL CLASSIFICATION MARKING

B
Berridge
Manufacturing
Company
Roofs of Distinction

UL 90 APPROVED
ASSEMBLY
CONSTRUCTION NO. 39

M PANEL

DATE: 11/05/02

PAGE \ FILE

MR-90

CONSTRUCTION NO. 30

UPLIFT: CLASS 90 OR CLASS 30
FIRE NOT INVESTIGATED

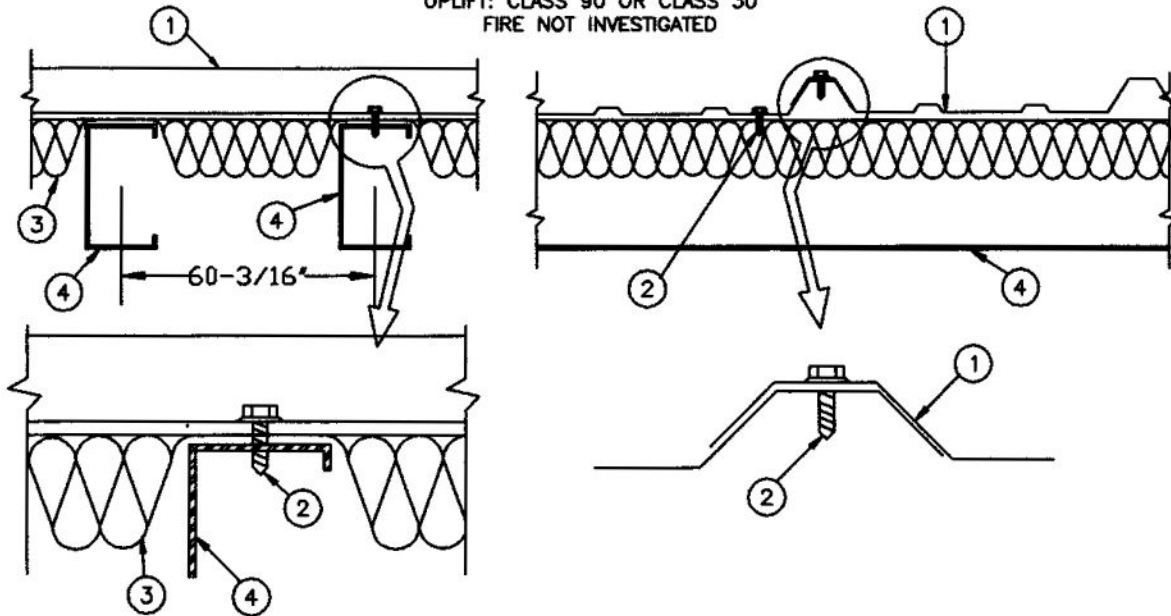

1. METAL ROOF DECK PANELS*: NO. 26 MSG MIN GAUGE COATED STEEL. PANELS CONTINUOUS OVER TWO OR MORE SPANS. END LAPS TO OCCUR OVER PURLINS WITH PANELS OVERLAPPED 6 IN. WITH LAP BEGINNING EVEN WITH PURLIN WEB AND EXTENDING ACROSS PURLIN FLANGE. A BEAD OF SEALANT MAY BE USED AT PANEL END AND SIDE LAPS.
BERRIDGE MFG CO.: "R PANEL"
2. PANEL FASTENERS: FOR PANEL TO PURLIN AND PANEL TO PANEL CONNECTIONS TO BE NO.14 SELF-TAPPING, HEX-HEAD, PLATED STEEL OR STAINLESS STEEL SCREWS WITH A SEPARATE 5/8 IN. O.D. STEEL OR ALUMINUM WASHER AND A SEPARATE NEOPRENE SEALING WASHER. LENGTH: FOR PANEL TO PANEL FASTENERS TO BE 3/4 IN. FOR INSULATION UP TO 3 IN. THICK AND 1-1/4 IN. FOR INSULATION OVER 3 IN. THICK. FOR PANEL TO PANEL FASTENERS TO BE 3/4 IN. FOR CLASS 90: SPACING FOR PANEL TO PURLIN CONNECTIONS TO BE IN A 4-8-4-8 IN. PATTERN LOCATED 2 IN. FROM THE CENTER LINE ON BOTH SIDES OF EACH MAJOR RIB. SPACING AT END LAPS TO BE THE SAME. SPACING FOR PANEL TO PANEL CONNECTIONS TO BE 20 IN. O.C. MAX WITH FASTENER LOCATION OVER EACH PURLIN.
FOR CLASS 30: FOR PANEL TO PURLIN CONNECTIONS TO BE 12 IN. O.C. LOCATED 2 IN. FROM THE CENTER LINE OF EACH MAJOR RIB. SPACING AT END LAPS TO BE THE SAME. SPACING FOR PANEL TO PANEL CONNECTIONS TO BE 20 IN. O.C. WITH FASTENER LOCATION OVER EACH PURLIN.
PILOT HOLES: FOR PANEL TO PURLIN FASTENERS TO BE 13/64 IN. DIAM.
FOR PANEL TO PANEL FASTENERS TO BE 1/8 IN. DIAM.
AS AN ALTERNATE FASTENER: NO. 12-14 SELF-DRILLING, SELF-TAPPING, 1/2 IN. HEX-WASHER HEAD TYPE B STEEL OR STAINLESS STEEL SCREWS WITH NEOPRENE SEALING WASHER MAY BE USED. LENGTH: FOR PANEL TO PURLIN FASTENERS TO BE 1 IN. FOR INSULATION UP TO 3 IN. AND 1-1/2 IN. FOR INSULATION OVER 3 IN. FOR PANEL TO PANEL CONNECTIONS TO BE 1 IN. SPACING TO BE THE SAME.
3. INSULATION: (OPTIONAL) ANY COMPRESSIBLE BLANKET INSULATION 4 IN. MAX THICKNESS BEFORE COMPRESSION.
4. PURLINS:
FOR CLASS 90: NO. 14 MSG MIN GAUGE STEEL.
FOR CLASS 30: NO. 16 MSG MIN GAUGE STEEL.
(50,000 PSI MIN YIELD STRENGTH).
5. LATERAL BRACING: (NOT ILLUSTRATED) AS REQUIRED.
REFER TO GENERAL INFORMATION, ROOF DECK CONSTRUCTION, (ROOFING MATERIALS AND SYSTEM DIRECTORY) FOR ITEMS NOT EVALUATED.

*BEARING THE UL CLASSIFICATION MARKING

DATE: 11/05/02

UL 90 APPROVED
ASSEMBLY
CONSTRUCTION NO. 30

PAGE \ FILE

MR-91

R PANEL



Berridge
Manufacturing
Company

CONSTRUCTION NO. 79

UPLIFT: CLASS 90
FIRE NOT INVESTIGATED

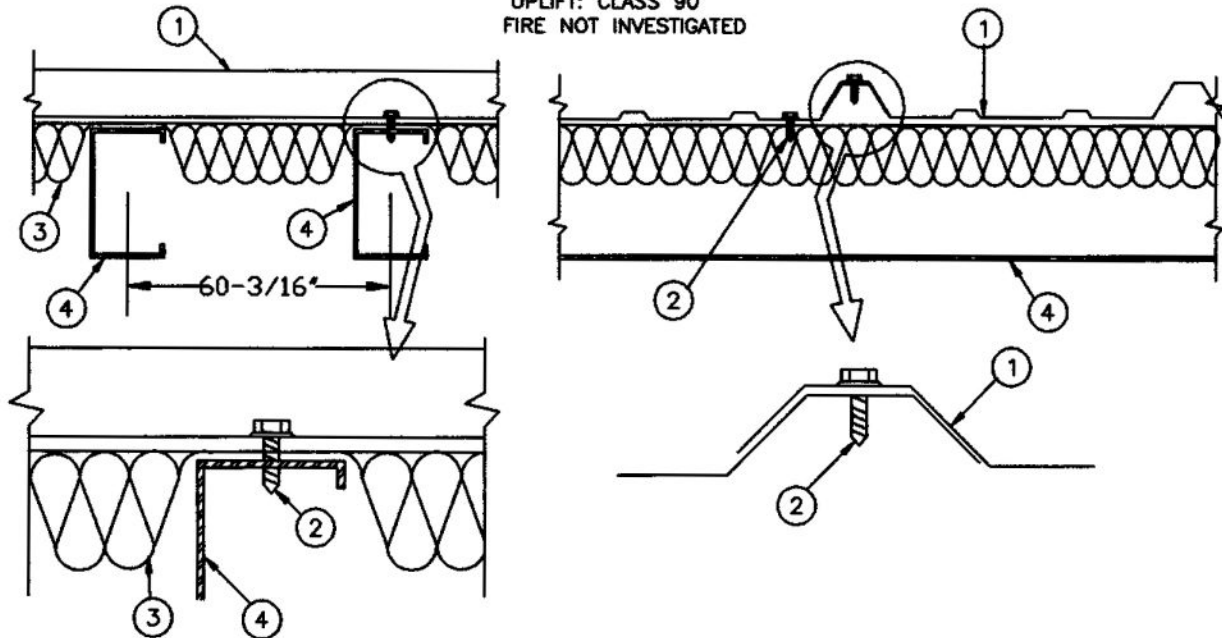

1. METAL ROOF DECK PANELS*: NO. 26 MSG MIN GAUGE COATED STEEL. PANELS CONTINUOUS OVER TWO OR MORE SPANS. END LAPS TO OCCUR OVER PURLINS WITH PANELS OVERLAPPED 3 IN. MIN. WITH LAP CENTERED OVER PURLIN WEB. A LINE OF TAPE SEALANT MAY BE USED AT PANEL SIDE AND END LAPS.
BERRIDGE MFG CO.: "R PANEL"
 2. PANEL FASTENERS: FOR PANEL TO PURLIN AND PANEL TO PANEL CONNECTIONS TO BE NO.14 SELF-TAPPING, HEX-HEAD, PLATED STEEL OR STAINLESS STEEL SCREWS WITH A SEPARATE 5/8 IN. O.D. STEEL OR ALUMINUM WASHER AND A SEPARATE NEOPRENE SEALING WASHER. LENGTH: FOR PANEL TO PURLIN FASTENERS TO BE 3/4 IN. FOR INSULATION UP TO 3 IN. AND 1-1/4 IN. FOR INSULATION OVER 3 IN. FOR PANEL TO PANEL FASTENERS TO BE 3/4 IN. SPACING FOR PANEL TO PURLIN FASTENERS TO BE 6 IN. O.C. WITH FASTENERS LOCATED 3 IN. FROM THE CENTER LINE ON BOTH SIDES OF EACH MAJOR RIB. OR; IN A 5-7-5-7 IN. PATTERN WITH FASTENERS LOCATED 2-1/2 IN. FROM THE CENTER LINE ON BOTH SIDES OF EACH MAJOR RIB. SPACING AT END LAPS TO FOLLOW SAME SPACING AS THAT USED FOR CONTINUOUS PANELS. AT END LAPS SPACING TO BE 6 IN. O.C. WITH FASTENERS LOCATED ADJACENT TO MAJOR RIBS.
SPACING FOR PANEL TO PANEL FASTENERS TO BE 20 IN. O.C.
PILOT HOLES: FOR PANEL TO PURLIN FASTENERS TO BE 13/64 IN. DIAM.
FOR PANEL TO PANEL FASTENERS TO BE 1/8 IN. DIAM.
AS AN ALTERNATE FASTENER: NO. 12-14 SELF-DRILLING, SELF-TAPPING, 1/2 IN. HEX-WASHER HEAD, TYPE B STEEL OR STAINLESS STEEL SCREWS WITH NEOPRENE SEALING WASHER MAY BE USED. LENGTH: FOR PANEL TO PURLIN FASTENERS TO BE 1 IN. FOR INSULATION UP TO 3 IN. AND 1-1/2 IN. FOR INSULATION OVER 3 IN. FOR PANEL TO PANEL FASTENERS TO BE 1 IN. SPACING TO BE THE SAME.
 3. INSULATION: (OPTIONAL) ANY COMPRESSIBLE BLANKET INSULATION 4 IN. MAX THICKNESS BEFORE COMPRESSION.
 4. PURLINS: NO. 16 MSG MIN GAUGE STEEL (50,000 PSI MIN YIELD). OR; MIN H SERIES OPEN WEB STEEL JOISTS.
 5. LATERAL BRACING: (NOT ILLUSTRATED) AS REQUIRED.
REFER TO GENERAL INFORMATION, ROOF DECK CONSTRUCTION, (ROOFING MATERIALS AND SYSTEM DIRECTORY) FOR ITEMS NOT EVALUATED.
- *BEARING THE UL CLASSIFICATION MARKING

CONSTRUCTION NO. 161

UPLIFT: CLASS 90
FIRE NOT INVESTIGATED

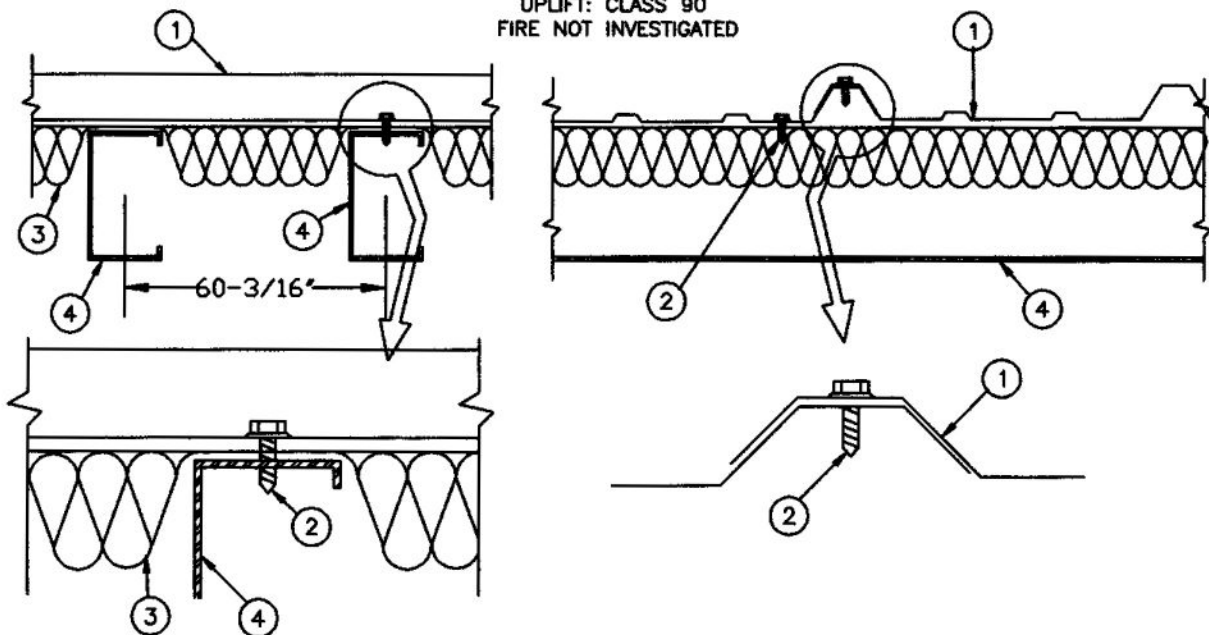

1. METAL ROOF DECK PANELS*: NO. 26 MSG MIN GAUGE COATED STEEL PANELS CONTINUOUS OVER TWO OR MORE SPANS. END LAPS TO OCCUR OVER PURLINS WITH PANELS OVERLAPPED 4 IN. WITH LAP CENTERED OVER PURLIN WEB. A LINE OF TAPE SEALANT MAY BE USED AT PANEL SIDE AND END LAPS.

BERRIDGE MFG CO.: "R PANEL"

2. PANEL FASTENERS: FOR PANEL TO PANEL AND PANEL TO PURLIN CONNECTIONS TO BE NO. 12-14 BY 1 IN. SELF-DRILLING, SELF-TAPPING, HEX HEAD, PLATED STEEL SCREWS WITH A 5/8 IN. OD FORMED STEEL WASHER AND A NEOPRENE SEALING WASHER.

AS ALTERNATE FASTENERS; FOR PANEL TO PURLIN CONNECTIONS, 1/4-14 HHAB SELF-TAPPING, PLATED STEEL SCREWS, WITH A SEPARATE 5/8 IN. OD DOME SHAPED STEEL WASHER AND A NEOPRENE SEALING WASHER MAY BE USED. OR; NO. 14-10HHA, SELF-TAPPING, PLATED STEEL SCREWS, WITH A SEPARATE, 5/8 IN. OD DOME SHAPED STEEL WASHER AND A NEOPRENE SEALING WASHER MAY BE USED.

SPACING FOR PANEL TO PURLIN CONNECTIONS TO BE 12 IN. O.C. BEGINNING 2-1/2 IN. FROM THE CENTER LINE ON ONE SIDE OF EACH MAJOR RIB. SPACING AT END LAPS TO BE 5-7-5-7 IN. PATTERN BEGINNING 2-1/2 IN. FROM THE CENTER LINE ON BOTH SIDES OF EACH MAJOR RIB.

FASTENER FOR PANEL TO PURLIN CONNECTION TO BE 1-1/4 IN. LONG WHEN INSULATION (ITEM 3) IS GREATER THAN 4-1/2 IN.

SPACING FOR PANEL TO PANEL CONNECTIONS TO BE 20 IN. ON CENTER WITH A FASTENER LOCATED IN LINE WITH THE PURLIN FASTENERS.

3. INSULATION: (OPTIONAL) ANY COMPRESSIBLE BLANKET INSULATION 6 IN. MAX THICKNESS BEFORE COMPRESSION.

4. PURLINS: NO. 16 MSG MIN GAUGE STEEL. (50,000 PSI MIN YIELD).

5. LATERAL BRACING: (NOT ILLUSTRATED) AS REQUIRED.

REFER TO GENERAL INFORMATION, ROOF DECK CONSTRUCTION, (ROOFING MATERIALS AND SYSTEM DIRECTORY) FOR ITEMS NOT EVALUATED.

*BEARING THE UL CLASSIFICATION MARKING

DATE: 11/05/02

PAGE\FILE

MR-93

UL 90 APPROVED
ASSEMBLY
CONSTRUCTION NO. 161

R PANEL



**Berridge
Manufacturing
Company**

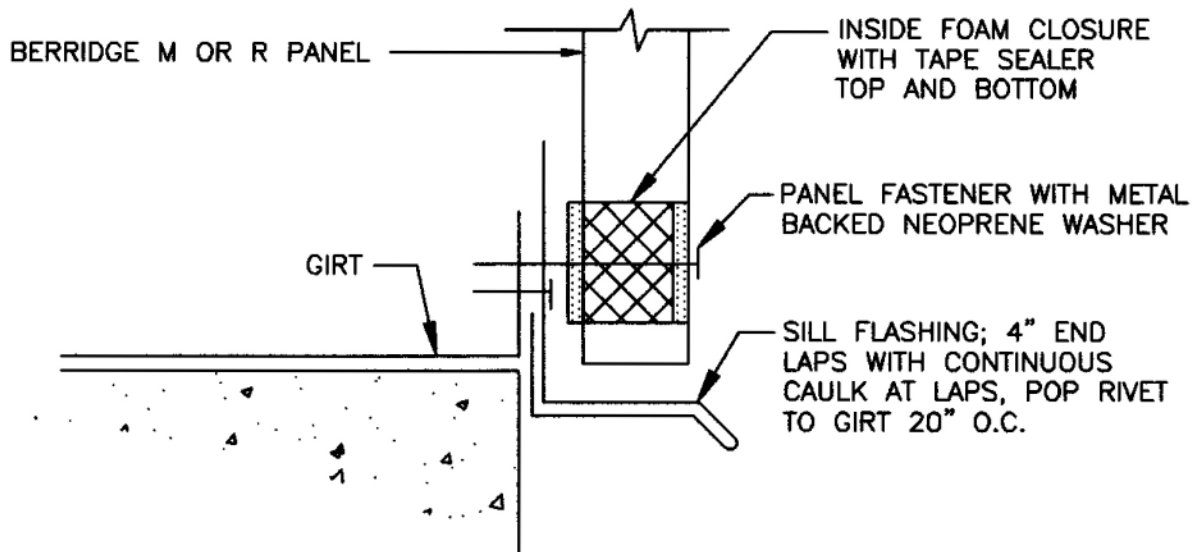

1. CAULKING AND FASTENERS ARE ITEMS TO BE FURNISHED AND INSTALLED BY THE ROOFING INSTALLER AT THE DISCRETION OF THE ARCHITECT.

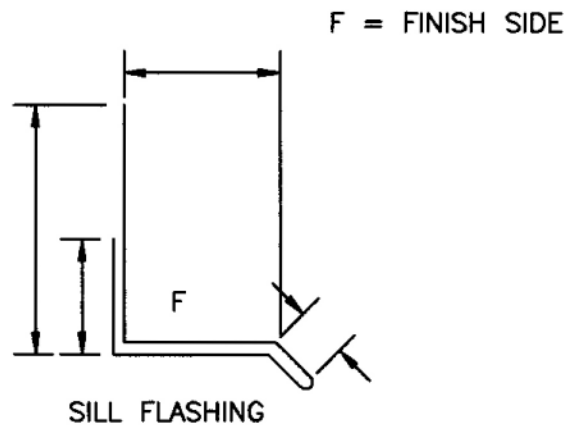

**Berridge
Manufacturing
Company**

GRADE DETAIL
OPEN FRAMING

M & R PANEL

DATE: 11/05/02

PAGE\FILE

MR-100

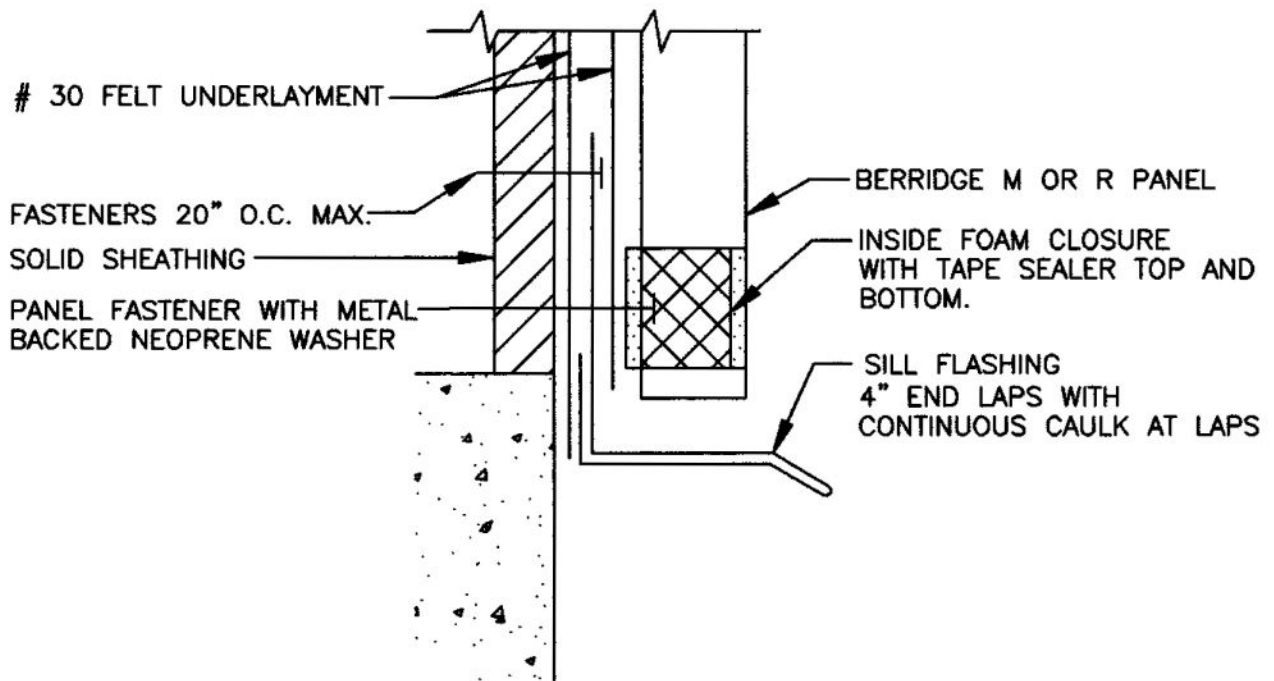

1. SOLID SHEATHING (BY OTHERS) TO BE MINIMUM 1/2" PLYWOOD OR EQUIVALENT IN STRENGTH FOR HOLDING POWER OF FASTENERS.
2. ALL FELT UNDERLAYMENT, CAULKING, AND FASTENERS, ARE ITEMS TO BE FURNISHED AND INSTALLED BY THE ROOFING INSTALLER AT THE DISCRETION OF THE ARCHITECT.

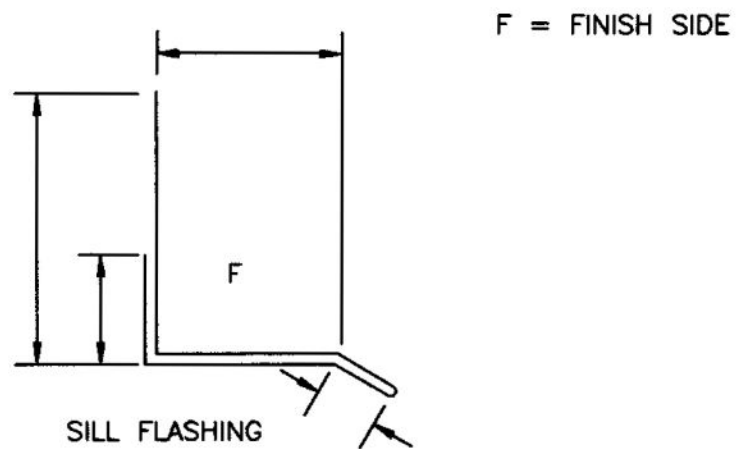

DATE: 11/05/02

GRADE DETAIL

PAGE\FILE
MR-101

M & R PANEL



**Berridge
Manufacturing
Company**

Roofs of Distinction

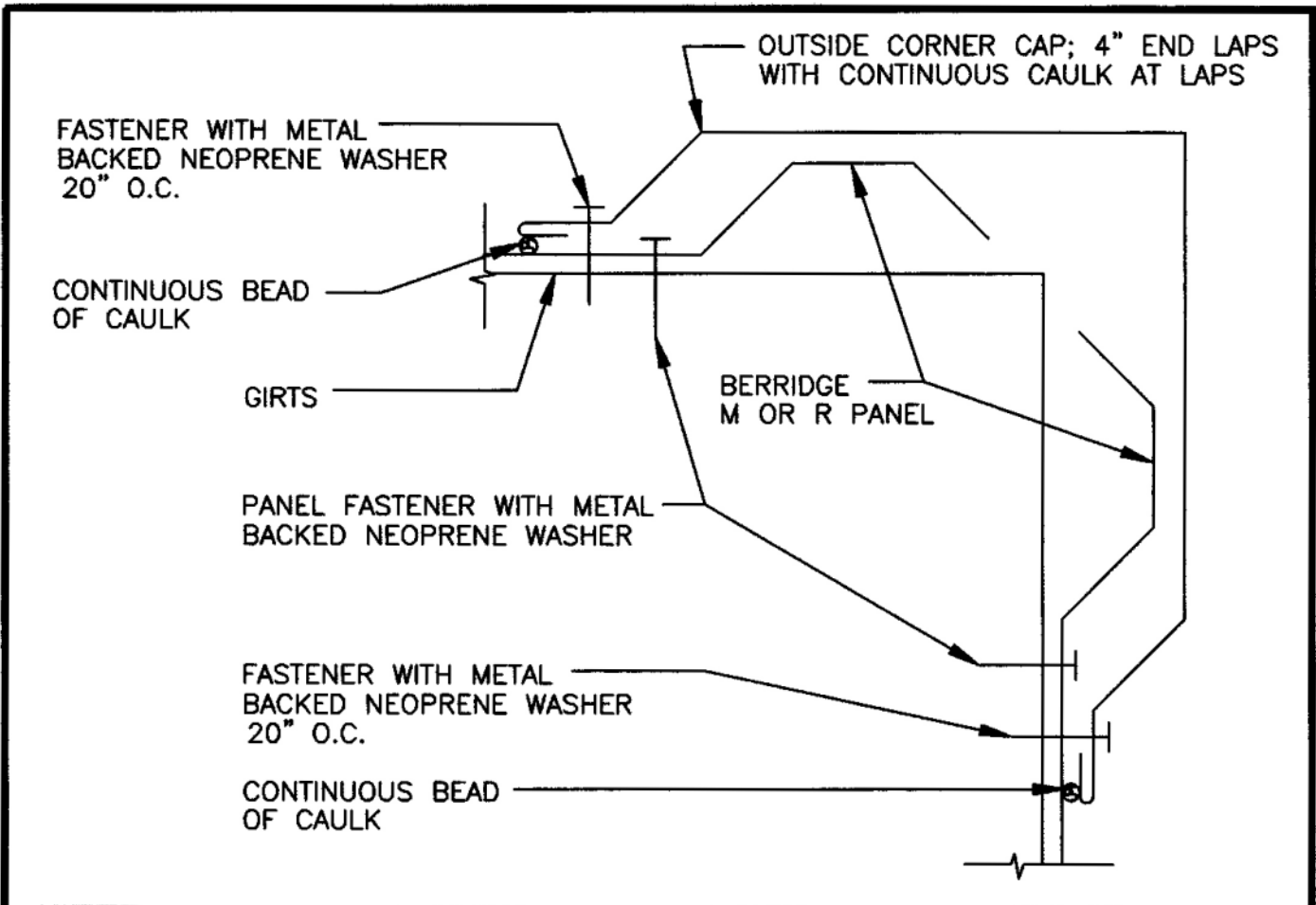

1. CAULKING AND FASTENERS ARE ITEMS TO BE FURNISHED AND INSTALLED BY THE ROOFING INSTALLER AT THE DISCRETION OF THE ARCHITECT.

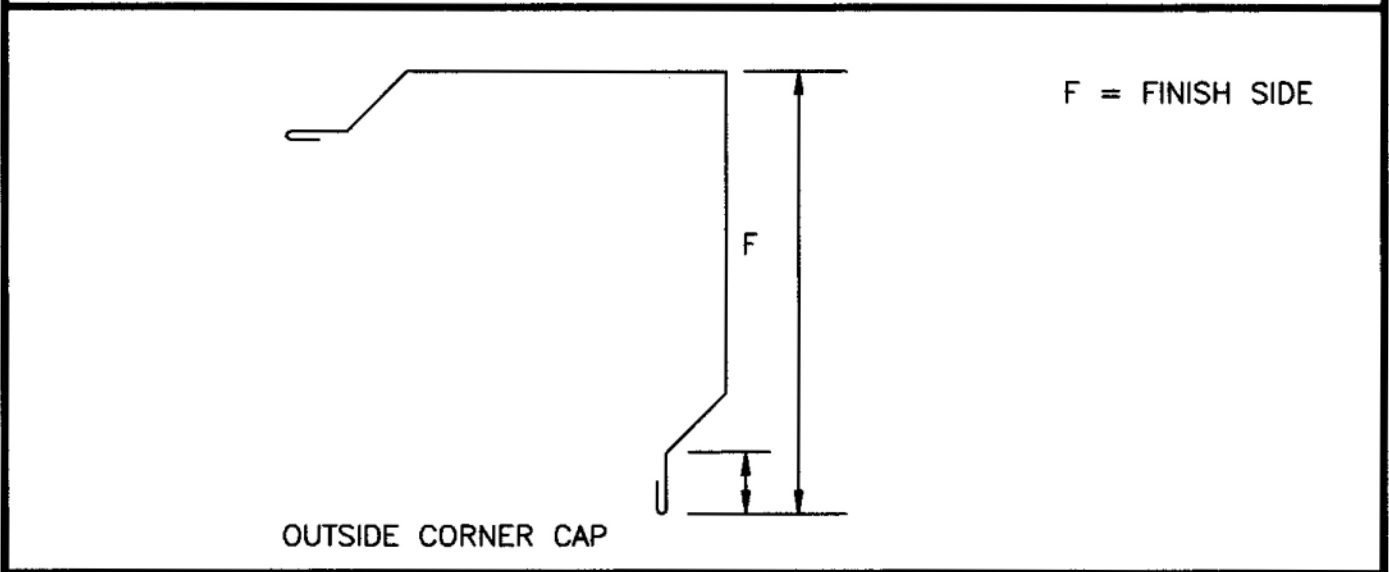

B
Berridge
Manufacturing
Company
Roofs of Distinction

OUTSIDE CORNER
 OPEN FRAMING

M & R PANEL

DATE: 11/05/02

PAGE\FILE
MR-102

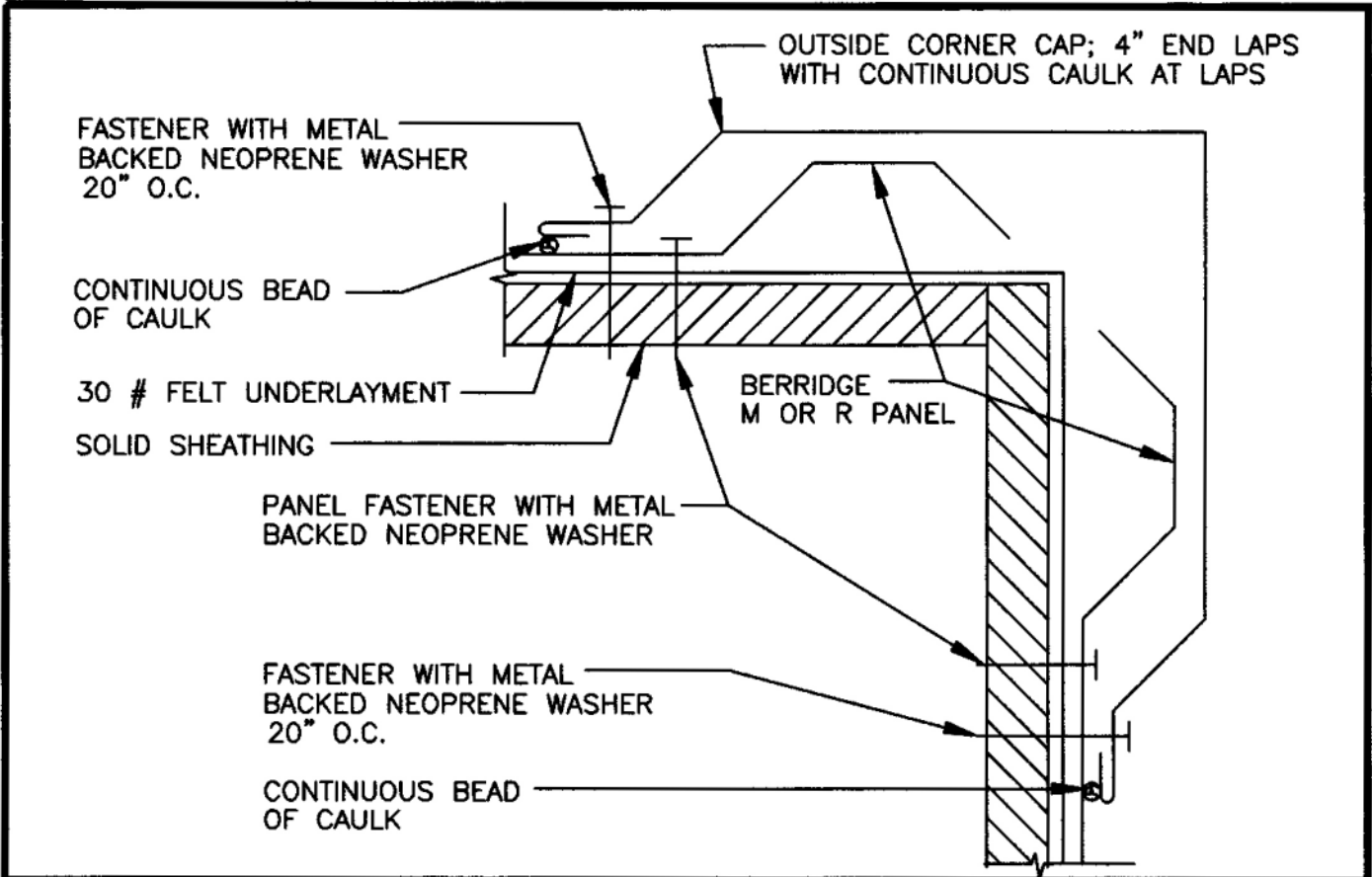

1. SOLID SHEATHING (BY OTHERS) TO BE MINIMUM 1/2" PLYWOOD OR EQUIVALENT IN STRENGTH FOR HOLDING POWER OF FASTENERS.
2. ALL FELT UNDERLAYMENT, CAULKING AND FASTENERS ARE ITEMS TO BE FURNISHED AND INSTALLED BY THE ROOFING INSTALLER AT THE DISCRETION OF THE ARCHITECT.

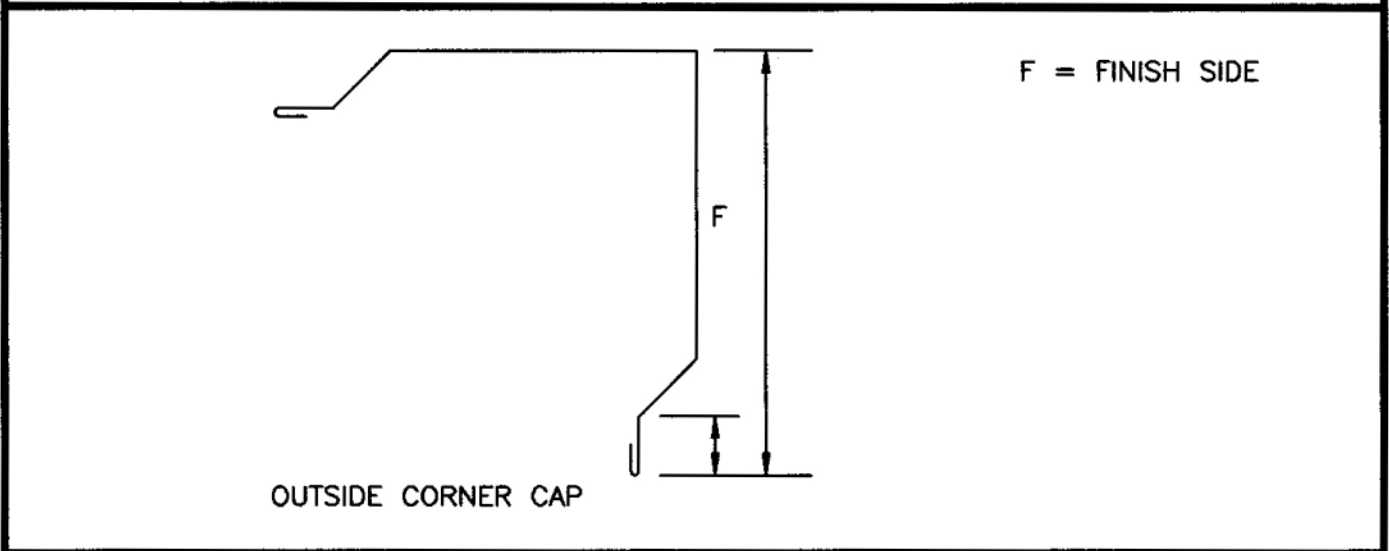

DATE: 11/05/02

PAGE\FILE
MR-103

OUTSIDE CORNER

M & R PANEL

Berridge
Manufacturing
Company

Roofs of Distinction

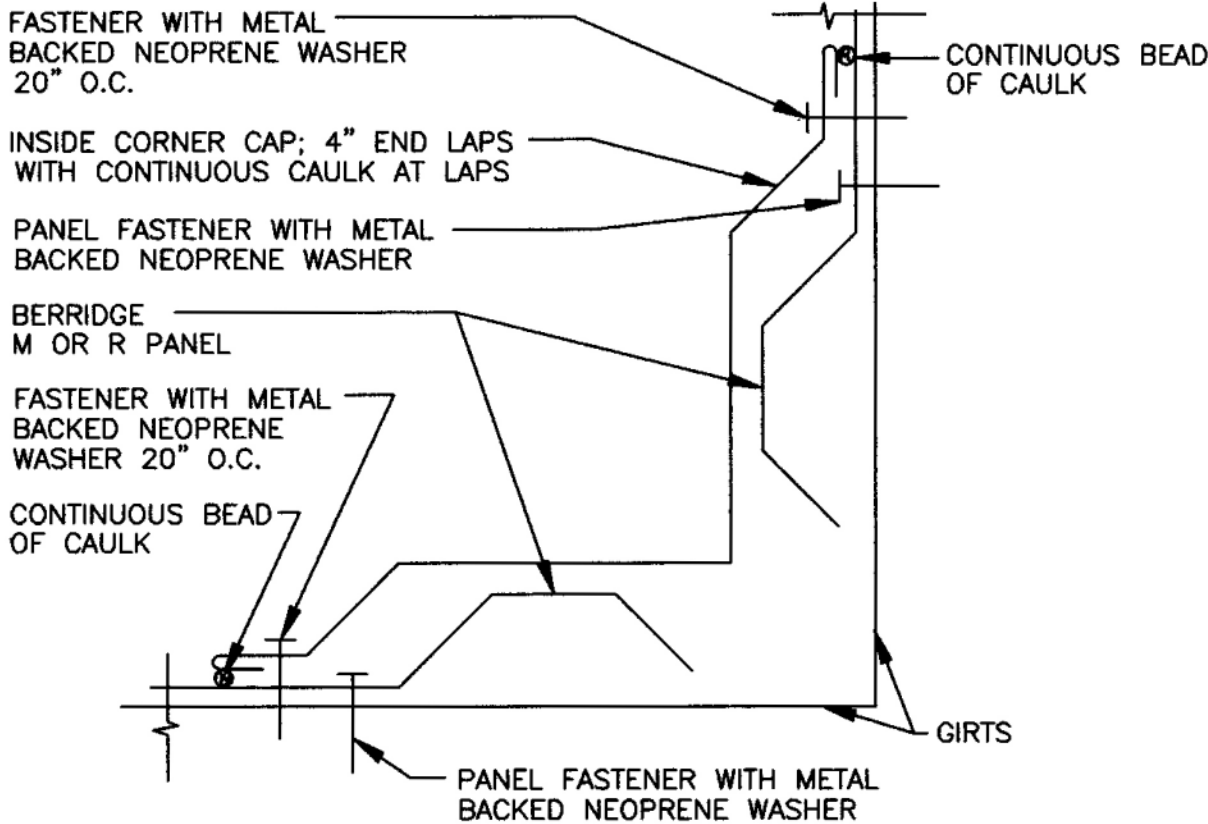

1. CAULKING AND FASTENERS ARE ITEMS TO BE FURNISHED AND INSTALLED BY THE ROOFING INSTALLER AT THE DISCRETION OF THE ARCHITECT.

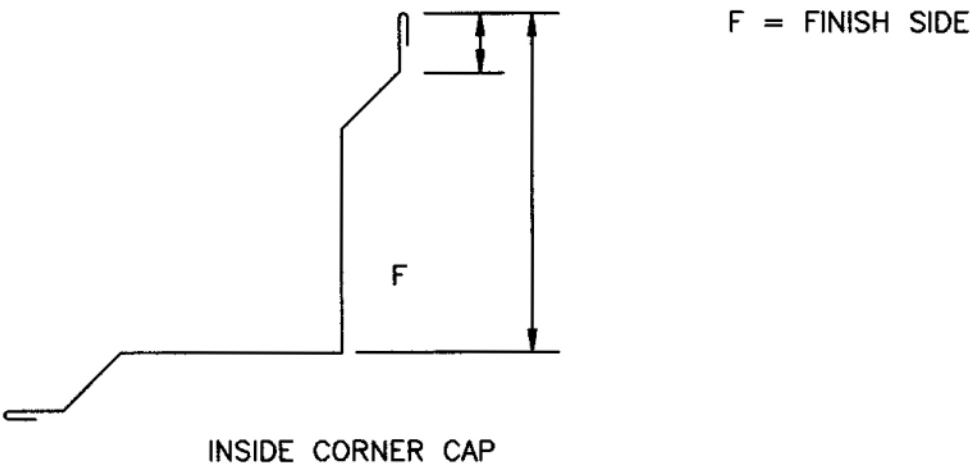

INSIDE CORNER
OPEN FRAMING

M & R PANEL

DATE: 11/05/02

PAGE\FILE
MR-104

FASTENER WITH METAL BACKED NEOPRENE WASHER 20" O.C.

INSIDE CORNER CAP; 4" END LAPS WITH CONTINUOUS CAULK AT LAPS

PANEL FASTENER WITH METAL BACKED NEOPRENE WASHER

BERRIDGE M OR R PANEL

FASTENER WITH METAL BACKED NEOPRENE WASHER 20" O.C.

CONTINUOUS BEAD OF CAULK

CONTINUOUS BEAD OF CAULK

30 # FELT UNDERLAYMENT

SOLID SHEATHING

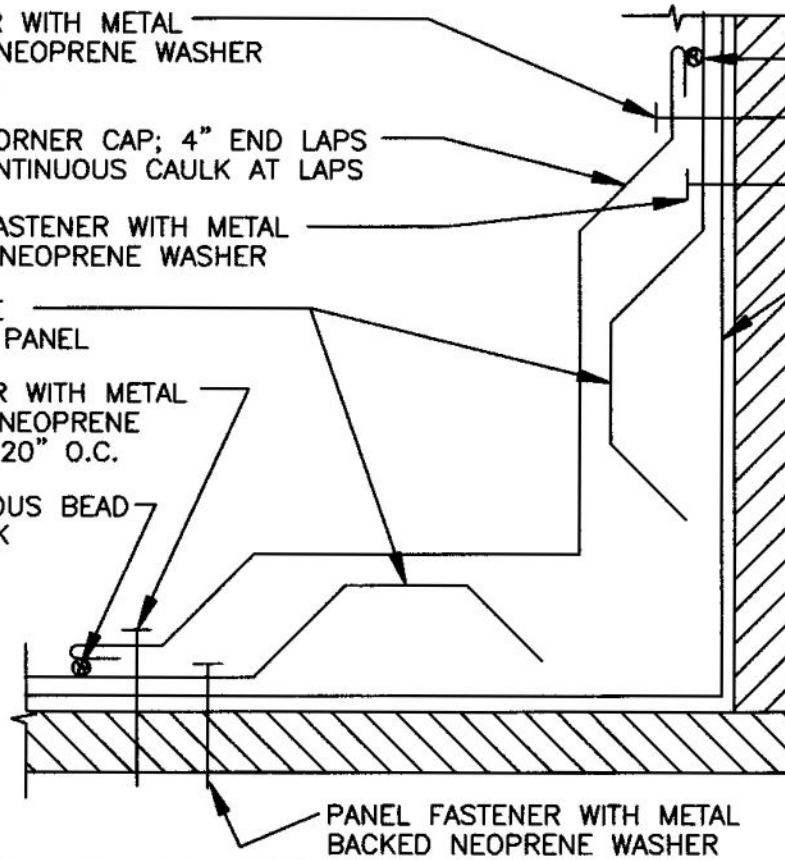

PANEL FASTENER WITH METAL BACKED NEOPRENE WASHER

1. SOLID SHEATHING (BY OTHERS) TO BE MINIMUM 1/2" PLYWOOD OR EQUIVALENT IN STRENGTH FOR HOLDING POWER OF FASTENERS.
2. ALL FELT UNDERLAYMENT, CAULKING AND FASTENERS ARE ITEMS TO BE FURNISHED AND INSTALLED BY THE ROOFING INSTALLER AT THE DISCRETION OF THE ARCHITECT.

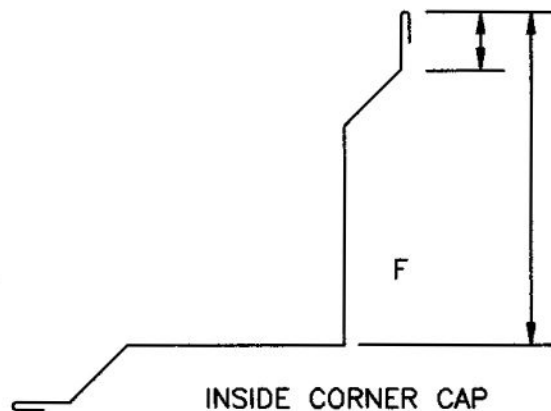

F = FINISH SIDE

INSIDE CORNER CAP

DATE: 11/05/02

INSIDE CORNER

PAGE\FILE

MR-105

M & R PANEL



Berridge
Manufacturing
Company

Roofs of Distinction

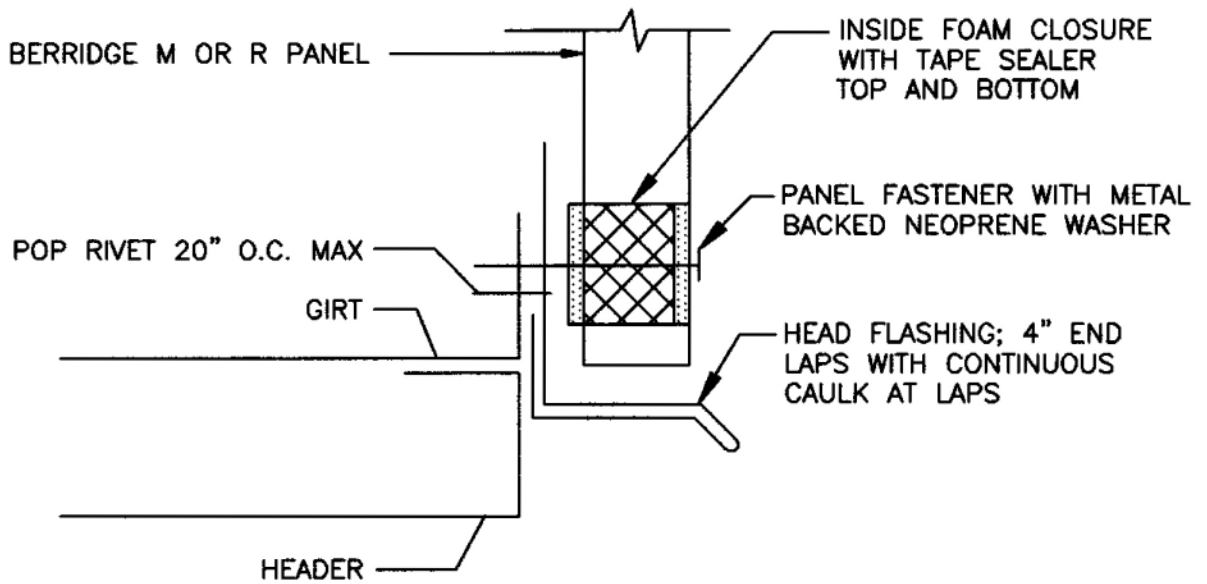

1. CAULKING AND FASTENERS ARE ITEMS TO BE FURNISHED AND INSTALLED BY THE ROOFING INSTALLER AT THE DISCRETION OF THE ARCHITECT.

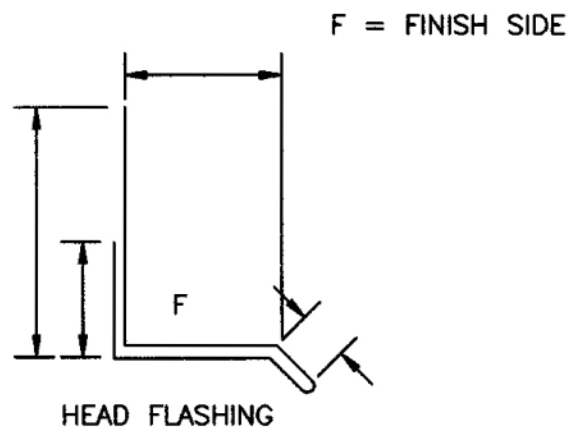

**Berridge
Manufacturing
Company**

HEAD DETAIL
OPEN FRAMING

M & R PANEL

DATE: 11/05/02

PAGE \ FILE

MR-106

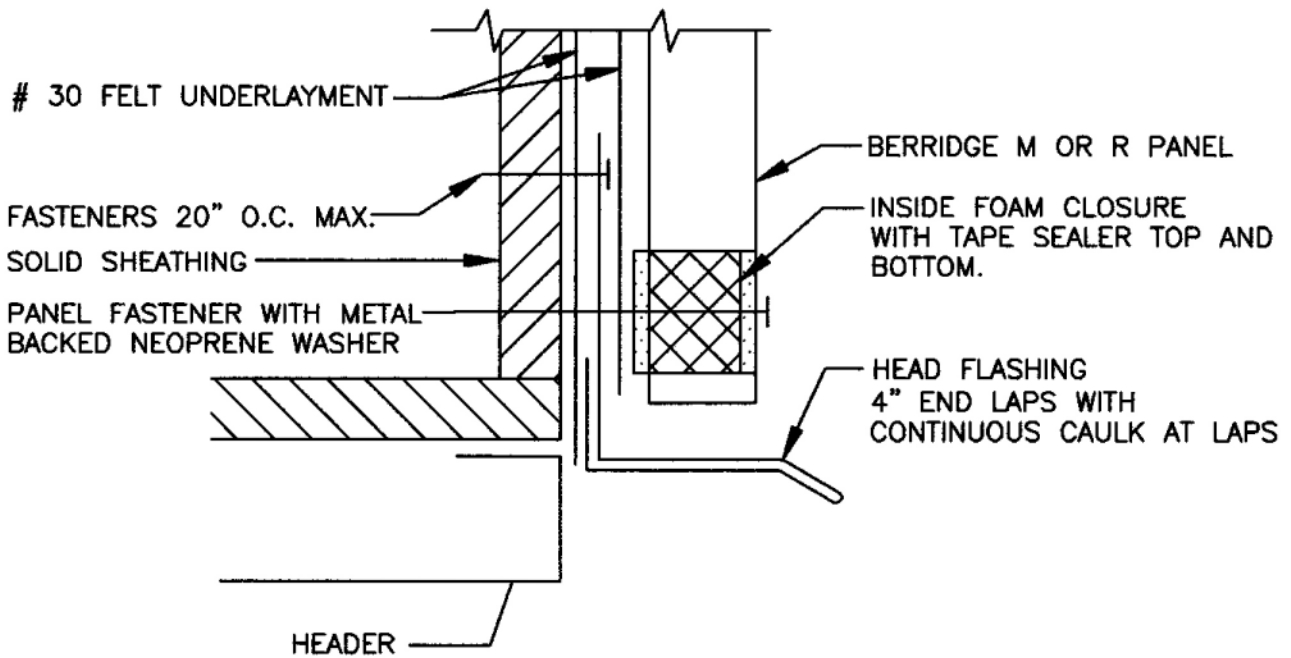

1. SOLID SHEATHING (BY OTHERS) TO BE MINIMUM 1/2" PLYWOOD OR EQUIVALENT IN STRENGTH FOR HOLDING POWER OF FASTENERS.
2. ALL FELT UNDERLAYMENT, CAULKING, AND FASTENERS, ARE ITEMS TO BE FURNISHED AND INSTALLED BY THE ROOFING INSTALLER AT THE DISCRETION OF THE ARCHITECT.

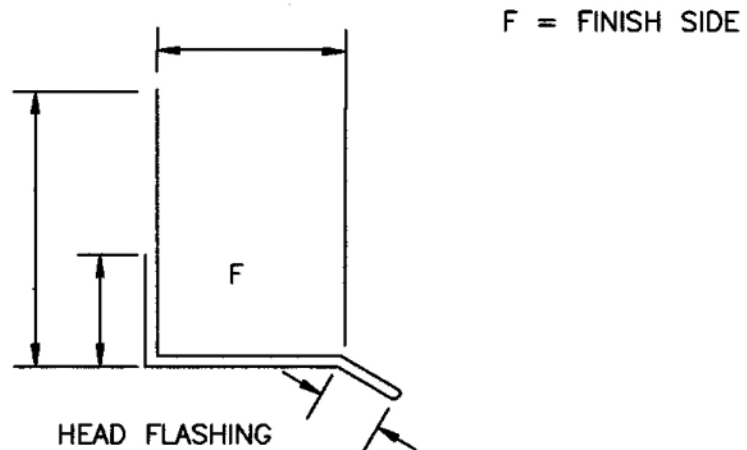

DATE: 11/05/02

HEAD DETAIL

PAGE\FILE
MR-107

M & R PANEL



Berridge
Manufacturing
Company

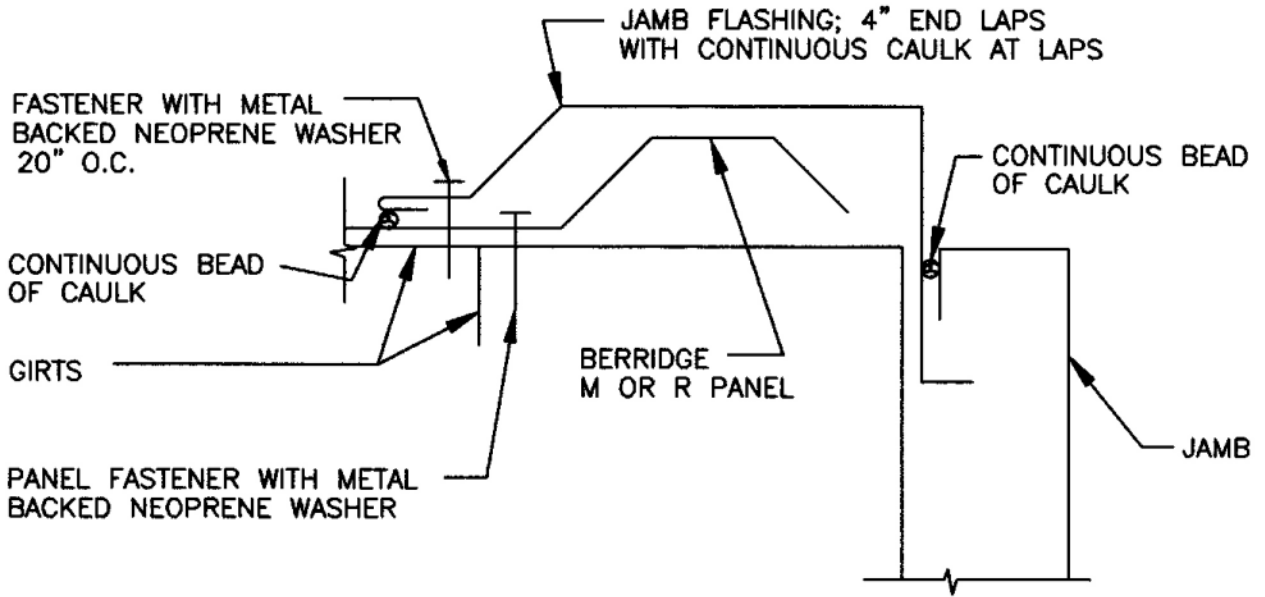

1. CAULKING AND FASTENERS ARE ITEMS TO BE FURNISHED AND INSTALLED BY THE ROOFING INSTALLER AT THE DISCRETION OF THE ARCHITECT.

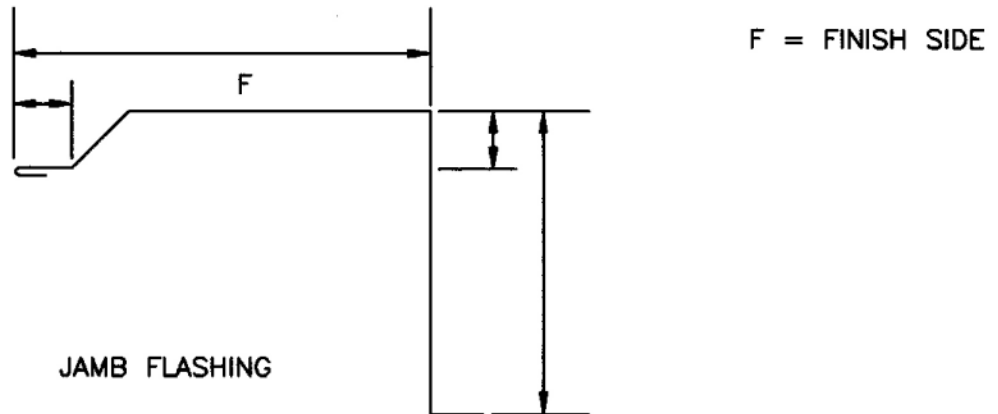

**Berridge
Manufacturing
Company**

Roofs of Distinction

JAMB DETAIL
OPEN FRAMING

M & R PANEL

DATE: 11/05/02

PAGE\FILE

MR-108

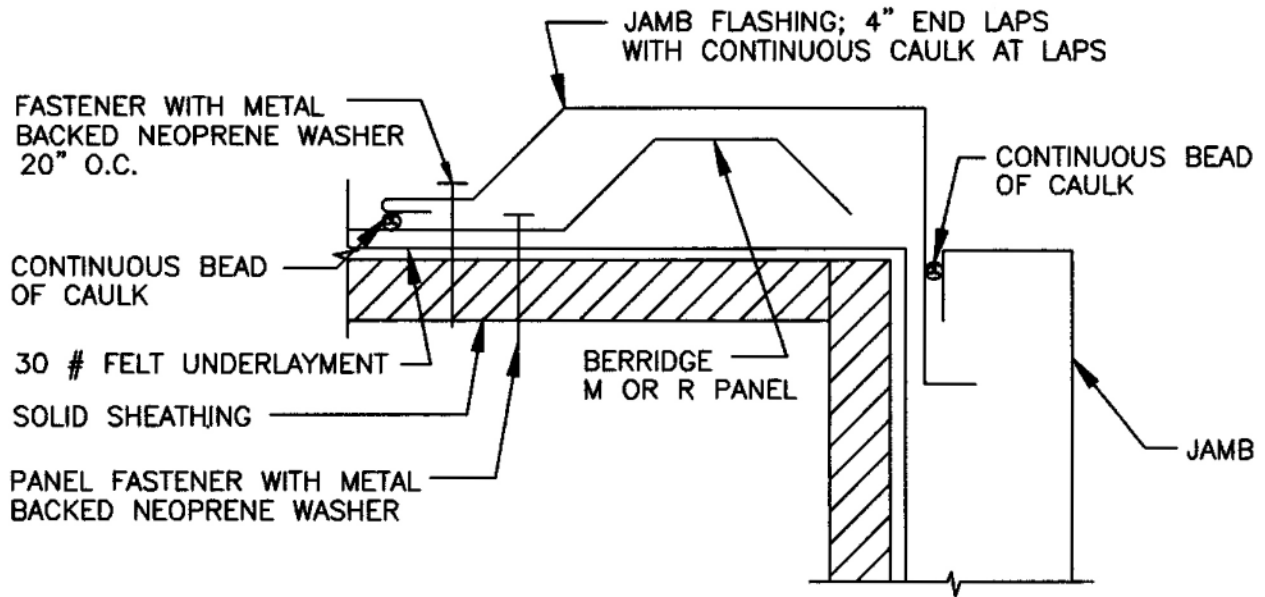

1. SOLID SHEATHING (BY OTHERS) TO BE MINIMUM 1/2" PLYWOOD OR EQUIVALENT IN STRENGTH FOR HOLDING POWER OF FASTENERS.
2. ALL FELT UNDERLAYMENT, CAULKING AND FASTENERS ARE ITEMS TO BE FURNISHED AND INSTALLED BY THE ROOFING INSTALLER AT THE DISCRETION OF THE ARCHITECT.

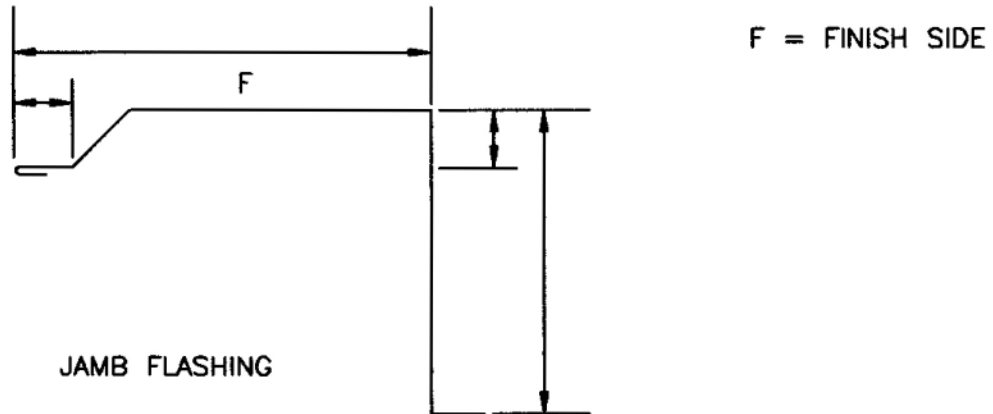

DATE: 11/05/02

JAMB DETAIL

PAGE\FILE

MR-109

M & R PANEL



Berridge
Manufacturing
Company

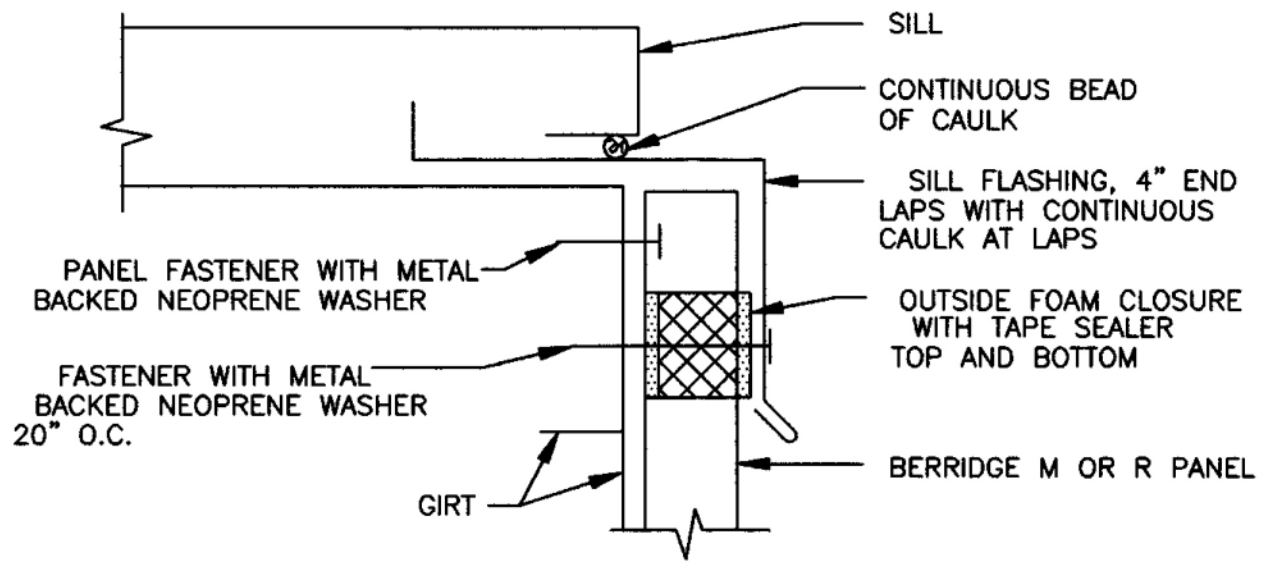

1. CAULKING AND FASTENERS ARE ITEMS TO BE FURNISHED AND INSTALLED BY THE ROOFING INSTALLER AT THE DISCRETION OF THE ARCHITECT.

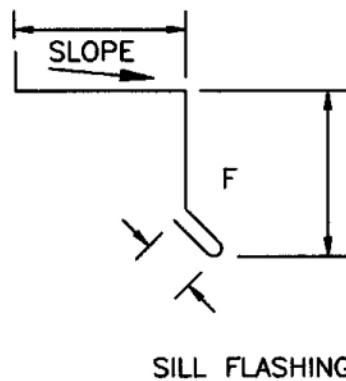

F = FINISH SIDE



**Berridge
Manufacturing
Company**

Roofs of Distinction

SILL DETAIL
OPEN FRAMING

M & R PANEL

DATE: 11/05/02

PAGE \ FILE
MR-110