

S-DECK PANEL INSTALLATION DETAILS

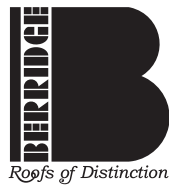
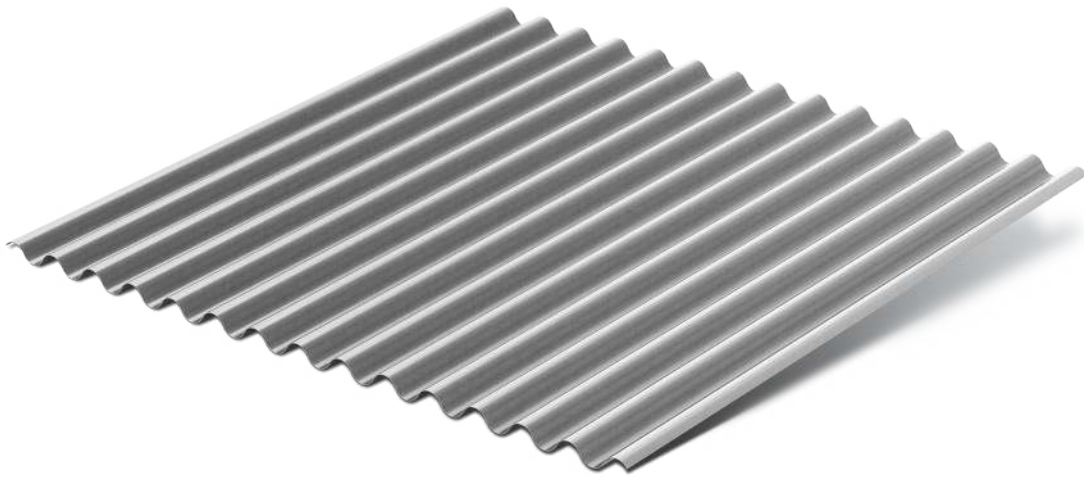

**BERRIDGE
MANUFACTURING
COMPANY**

800-669-0009 • www.Berridge.com

INDEX	SD-0
INDEX	SD-1
INSTALLATION INSTRUCTION	SDI-1
INSTALLATION INSTRUCTION	SDI-2
INSTALLATION INSTRUCTION	SDI-3
INSTALLATION INSTRUCTION	SDI-4
INTRODUCTION TO TYPICAL DETAILS	SD-2
OVERVIEW S-DECK SYSTEM	SD-3
EAVE DETAIL; SOLID SHEATHING	SD-10
EAVE DETAIL; OPEN FRAMING	SD-11
EAVE DETAIL; W/S-DECK WALL PANEL; SOLID SHEATHING	SD-12
HIP RIDGE; SOLID SHEATHING	SD-20
SHED ROOF RIDGE	SD-21
HIP RIDGE; OPEN FRAMING	SD-22
RIDGE; TERMINATION AT DORMER VALLEY	SD-23
GABLE	SD-30
GABLE; WITH S-DECK WALL PANEL	SD-31
GABLE; WITH WALL PANEL	SD-32
GABLE; CURVED S-DECK	SD-33
HEAD WALL; WITH PARAPET	SD-40
HEAD WALL; WITH S-DECK	SD-41
HEAD WALL; WITH REGLET	SD-42
RAKE WALL; WITH WALL PANEL	SD-50
RAKE WALL; WITH S-DECK WALL PANEL	SD-51
RAKE WALL; WITH REGLET	SD-52
RAKE WALL; WITH PARAPET	SD-53
RAKE WALL; OPEN FRAMING; S-DECK WALL PANEL	SD-54
RAKE WALL; CURVED S-DECK; WITH WALL PANEL	SD-55
SLOPE TRANSITION WITH FLASHING	SD-60
VALLEY	SD-70
VALLEY; OPEN FRAMING	SD-71
ROOF PENETRATION; PIPE PENETRATION	SD-80



**BERRIDGE
MANUFACTURING
COMPANY**

INDEX

S-Deck System

DATE: 11-20-00

PAGE/FILE

SD-0

ROOF PENETRATION; SQUARE (PLAN VIEW)	SD-81
ROOF PENETRATION; SIDE A	SD-82
ROOF PENETRATION; SIDE B	SD-83
ROOF PENETRATION; SIDE C	SD-84
ROOF PENETRATION; LARGER THAN 4"; OPEN FRAMING	SD-85
INSIDE CORNER; SOLID SHEATHING	SD-90
OUTSIDE CORNER; SOLID SHEATHING	SD-91
INSIDE CORNER; OPEN FRAMING	SD-92
OUTSIDE CORNER; OPEN FRAMING	SD-93
INSIDE CORNER; SOLID SHEATHING; HORIZONTAL	SD-94
OUTSIDE CORNER; SOLID SHEATHING; HORIZONTAL	SD-95
HEAD DETAIL; SOLID SHEATHING	SD-96
SLAB DETAIL; SOLID SHEATHING	SD-97
SILL DETAIL; SOLID SHEATHING	SD-98
JAMB DETAIL; SOLID SHEATHING	SD-99



**BERRIDGE
MANUFACTURING
COMPANY**

INDEX

S-Deck System

DATE: 11-20-00

PAGE/FILE
SD-1

A. BERRIDGE S-DECK PANEL: THE BERRIDGE S-DECK PANEL IS FACTORY FABRICATED TO A CONSTANT CORRUGATION DEPTH OF 7/8" AND A NOMINAL PANEL COVERAGE OF 32" OR 34.667".

PANEL MAY BE ORDERED FROM THE FACTORY STRAIGHT OR CURVED (MINIMUM RADIUS 5'-0"). USED ICE AND WATERSHIELD AS UNDERLAYMENT UNDER CURVED ROOF.

PANELS ARE FABRICATED TO A MINIMUM LENGTH OF 5'-0" AND A MAXIMUM LENGTH OF 40'-0".

B. MINIMUM SLOPE: THE S-DECK PANEL IS RECOMMENDED FOR ROOF SLOPES OF 3 ON 12 OR GREATER. SLOPES LESS CONSULT BERRIDGE MANUFACTURING COMPANY.

C. MATERIAL STORAGE: CAUTION MUST BE EXERCISED IN STORAGE OF MATERIAL PRIOR TO INSTALLATION. KEEP ALL BERRIDGE PREFINISHED MATERIAL IN A DRY LOCATION WITH ADEQUATE VENTILATION AND OUT OF DIRECT SUNLIGHT.

EXPOSURE TO DIRECT SUNLIGHT AND/OR MOISTURE MAY CAUSE THE FACTORY APPLIED STRIPPABLE PLASTIC FILM TO ADHERE TO THE METAL PERMANENTLY AND DISCOLOR THE FINISH. IF THIS SHOULD OCCUR THE PAINT WARRANTY WILL BE VOID.

D. STRIPPABLE FILM: THE STRIPPABLE PLASTIC FILM, WHICH IS APPLIED OVER MOST BERRIDGE PREFINISHED PRODUCTS, PANELS, FLASHINGS, COILS AND FLAT SHEETS, PROVIDES PROTECTION OF THE FINISH DURING FABRICATION AND TRANSIT. THIS FILM MUST BE REMOVED PRIOR TO INSTALLATION.

E. SOLID SHEATHING REQUIREMENTS: BERRIDGE MANUFACTURING COMPANY RECOMMENDS THE USE OF EITHER BERRIDGE 24 GA. CORRUGATED SHEATHING (NOMINAL 2 1/2" PITCH BY 7/8" DEPTH) OR A MINIMUM OF 1/2" PLYWOOD SHEATHING TO PROVIDE SUFFICIENT HOLDING POWER FOR FASTENERS. CONTACT BERRIDGE MANUFACTURING'S ENGINEERING DEPARTMENT FOR USE OF ANY OTHER TYPE OF SOLID SHEATHING. (# 30 FELT UNDERLAYMENT OR EQUAL MUST BE USED OVER ANY SOLID SHEATHING).

DUE TO # 30 FELTS TENDENCY TO TEAR WHEN USED OVER CORRUGATED DECKING, BERRIDGE MANUFACTURING RECOMMENDS GRACE ICE AND WATERSHIELD OR EQUAL TO BE USED AS AN UNDERLAYMENT FOR ALL CORRUGATED DECKS.

F. SHEATHING INSPECTION:

1. SHEATHING END JOINTS SHOULD BE STAGGERED.
2. ALL END JOINTS SHOULD MEET AT EITHER A JOIST OR RAFTER.
3. BLOCKING OF "H" CLIPS SHOULD BE USED IF JOINTS DO NOT REMAIN FLAT UNDER THE WEIGHT OF WORKMEN.
4. USE SHIMS TO KEEP ENTIRE SUBSTRATE EVEN; UNEVEN SUBSTRATE WILL RESULT IN "OIL-CANNING" IN THE PANELS. SUBSTRATE SHOULD BE LEVEL TO 1/4" IN 20'-0".
5. ALL CUTS AT PENETRATIONS SHOULD BE TIGHT, WITHOUT GAPS.
6. USE WOOD FRAMED CRICKETS AT LARGE PENETRATIONS.
7. MAKE SURE SUBSTRATE JOINT ARE TIGHT AT ALL HIPS, VALLEYS AND RIDGES.

G. INSTALLATION OVER OPEN FRAMING: REFER TO ALLOWABLE UNIFORM LOAD TABLE PAGE SD-3.

FOR DIAPHRAGM CAPABILITIES OF "S" DECK CONSULT BERRIDGE TECHNICAL DEPT. PURLIN OR OTHER STRUCTURAL BRACING IN THE RESPONSIBILITY OF OTHERS.



**BERRIDGE
MANUFACTURING
COMPANY**

INSTALLATION INSTRUCTIONS

S-Deck System

DATE: 05-14-09

PAGE/FILE
SDI-1

H. OPEN FRAMING INSPECTION:

1. PURLINS SHOULD BE ALIGNED WITH TOP FLANGES IN THE SAME PLANE TO A TOLERANCE OF 1/4" IN 20'-0". UNEVENNESS IN THE TOP PLANE OF THE PURLINS WILL RESULT IN ABNORMAL "OIL-CANNING" OF PANELS. PURLINS SHALL BE ADEQUATELY BRACED.
2. BERRIDGE MANUFACTURING COMPANY RECOMMENDS SOLID SHEATHING IN VALLEY AND AROUND ROOF PENETRATIONS. DO NOT APPLY PANELS ON OPEN FRAMING AT VALLEYS OR ROOF PENETRATIONS WITHOUT REFERRING TO DETAILS SD-71 AND SD-85.
3. FOOT TRAFFIC IN THE PANELS MUST BE KEPT TO A MINIMUM. ARCHITECTURAL PANELS ARE DESIGNED FOR AESTHETICS AND CAN BE EASILY DAMAGED OR DEFORMED IF EXTREME CARE IS NOT USED.

I. FASCIA/RAKE INSPECTION:

1. STRIKE A LINE THE FULL LENGTH OF THE FASCIA OR RAKE. IF NOT STRAIGHT, CORRECT WITH SHIMS.
2. MAKE SURE FASCIA/RAKE IS FLUSH WITH SHEATHING.

- J. FELT UNDERLAYMENT: A SINGLE LAYER OF NUMBER THIRTY FELT UNDERLAYMENT (OR EQUAL) MUST BE APPLIED OVER SOLD SHEATHING, AS SHOWN IN THE BERRIDGE MANUFACTURING COMPANY TYPICAL FELTING DETAILS. THE USE OF ADDITIONAL LAYERS OF NUMBER THIRTY FELT IS RECOMMENDED ON LOW SLOPED ROOFS, AT ALL VALLEY CONDITIONS, AT ROOF PENETRATIONS AND AT CERTAIN OTHER FLASHING CONDITIONS AS DEPICTED IN THE S-DECK PANEL TYPICAL DETAILS.

GRACE ICE AND WATERSHIELD MAY BE REQUIRED ON LOW SLOPED ROOFS OR AT CERTAIN FLASHING CONDITIONS.

K. FELTING INSTALLATION:

1. DO NOT USE RED ROSIN PAPER UNDER METAL ROOFING PANELS.
2. SWEEP ROOF AREA CLEAN.
3. USE FLAT HEAD GALVANIZED ROOFING NAILS 1 1/4" LONG WITH BERRIDGE GALVANIZED FELT CAPS.
4. INSTALL VALLEY FELT FIRST.
5. INSTALL FELT PARALLEL TO THE EAVE, (2 LAYERS REQUIRED AT EAVE) STARTING AT EAVE AND USING MINIMUM 6" LAPS. USE 2 LAYERS OF FELT ON ENTIRE ROOF DECK IF ROOF SLOPE IS 3 ON 12.
6. REFER TO FELTING DETAILS WHEN VALLEYS OR ROOF PENETRATIONS ARE INVOLVED ON OPEN FRAMING CONDITIONS.
7. INSULATE BETWEEN WOOD BLOCKING AND METAL WITH FELT OR GRACE ICE AND WATERSHIELD.
8. USE GRACE ICE AND WATERSHIELD AS UNDERLAYMENT FOR CURVED ROOFS.
9. VERIFY CORRECT METHOD OF INSTALLING ICE AND WATERSHIELD WITH ICE AND WATERSHIELD MANUFACTURE.

- L. ELECTROLYSIS: AVOID ALLOWING FLASHINGS AND PANELS TO COME INTO CONTACT WITH EITHER LEAD, COPPER OR OTHER DISSIMILAR METALS AND PREVENT EXPOSURE TO WATER RUNDOWN FROM COPPER AND/OR LEAD.

- M. SEALANT RECOMMENDATIONS: TREMCO, INC. SPECTREM 1 SILICONE SEALANT. DO NOT USE CLEAR CAULK.

- N. FLASHING: IF BERRIDGE MANUFACTURING COMPANY IS TO SUPPLY FLASHING, ALL FLASHINGS WILL BE FABRICATED IN 10'-0" LENGTHS WITH SQUARE END CUTS ONLY. THE PURCHASER MUST PROVIDE ALL DIMENSIONS AND DEGREES OF ANGLE.



**BERRIDGE
MANUFACTURING
COMPANY**

INSTALLATION INSTRUCTIONS

S-Deck System

DATE: 11-20-00

PAGE/FILE
SDI-2

- O. FLASHING INSTALLATION:
 REMOVE STRIPPABLE PLASTIC FILM FROM ALL FLASHINGS PRIOR TO INSTALLATION.
 ALWAYS STAGGER JOINTS WHEN ONE FLASHING IS INSTALLED OVER OTHER FLASHINGS.
 INSTALL ALL FLASHINGS AS PER BERRIDGE TYPICAL DETAILS.
 ALL FLASHINGS ARE TO BE DESIGNED AND INSTALLED TO AVOID TRAPPING WATER.
- P. PANELS: BERRIDGE MANUFACTURING COMPANY WILL PROVIDE SQUARE END CUTS ONLY ON ALL S-DECK PANELS. COMPUTATION OF ALL QUANTITIES AND DIMENSIONS ARE THE RESPONSIBILITY OF THE PURCHASER.
- Q. PANEL INSTALLATION:
1. REMOVE STRIPPABLE PLASTIC FILM FROM EACH PANEL PRIOR TO INSTALLATION.
 2. START AT ONE GABLE END OF THE ROOF AND WORK TOWARD THE OTHER GABLE.
 3. EACH PANEL IS TO BE KEPT TIGHT AGAINST THE ADJOINING PANEL. NEVER PERMIT A GAP BETWEEN VERTICAL LAP. ANY CRIMPS OR BENDS MUST BE STRAIGHTENED PRIOR INSTALLATION.
 4. KEEP PANELS ALIGNED SO THAT RIBS MATCH AT HIPS, VALLEYS AND WHERE VERTICAL PANELS ADJOIN ROOF PANELS. DO NOT INSTALL LONG CONTINUOUS RUNS OF PANELS ALL AT ONE TIME WHERE RIB LINES MUST MATCH. INSTALL TEN OR TWELVE PANELS IN ONE ELEVATION AND THEN FOLLOW WITH A LIKE NUMBER OF PANELS ON THE OTHER ELEVATION. WHEN YOU INSTALL PANELS IN THIS MANNER, YOU WILL BE ABLE TO MAKE ANY ADJUSTMENTS REQUIRED TO INSURE RIB MATCHING.
 5. COPPER-COTE™, CHAMPAGNE, LEAD-COTE™ AND PREWEATHERED GALVALUME® PANEL INSTALLATION: NOTE THE SERIES OF ARROWS PAINTED ON THE UNDERSIDE OF THE PANEL. ALL PANELS MUST BE INSTALLED IN A CONSISTENT MANNER, MEANING THAT THE ARROWS ON EVERY PANEL ARE ALL POINTING IN THE SAME DIRECTION. IF A PANEL IS REVERSED (ARROWS POINTING OPPOSITE OF THOSE ON OTHER PANELS) IT WILL APPEAR, FROM A DISTANCE, A DIFFERENT SHADE DUE TO THE GRANULAR EFFECT OF THE PIGMENTS IN THE FINISH. METALLIC FINISHES ARE MATCH-Lot FINISHES. DO NOT MIX Lots.
- R. FASTENERS: INSTALL FASTENERS AS PER TYPICAL DETAILS. USE #10 HEX HEAD ZINC PLATED FASTENER WITH METAL BACKED NEOPRENE FASTENER WHEN FASTENING TO WOOD. USE #12 HEX HEAD ZINC PLATED FASTENER WITH A METAL BACKED NEOPRENE WASHER WHEN FASTENING TO METAL * WHEN USING POP RIVETS ON FLASHING, STAINLESS STEEL RIVETS ARE RECOMMENDED TO AVOID RUST STAINS.

MAKE SURE ALL FASTENERS ARE DRIVEN STRAIGHT AND SET FLAT. DO NOT OVER DRIVE FASTENERS AS THIS WILL CAUSE THE CLIP AND/OR FLASHINGS TO BUCKLE OR BECOME RECESSED BELOW THE ELEVATION OF THE SUBSTRATE.

* CONSULT BERRIDGE MANUFACTURING'S ENGINEERING DEPARTMENT REGARDING FASTENER SPACING TO MEET DESIGN CRITERIA AND THE USE OF ANY OTHER TYPE OF FASTENER.



**BERRIDGE
 MANUFACTURING
 COMPANY**

INSTALLATION INSTRUCTIONS

S-Deck System

DATE: 11-20-00

PAGE/FILE
 SDI-3

BERRIDGE MANUFACTURING COMPANY STRIVES TO PROVIDE ITS CUSTOMERS WITH THE HIGHEST QUALITY STRETCHER LEVELED STEEL AVAILABLE. THE LATEST TECHNOLOGY IS ALSO INCORPORATED IN BERRIDGE'S HIGH-PRECISION COIL HANDLING AND ROLL FORMING EQUIPMENT TO MINIMIZE THE STRESS ON METAL DURING PRODUCTION. FURTHERMORE, BERRIDGE UTILIZES HEAVIER 24 GAUGE METAL RATHER THAN 26 GAUGE STEEL TO LIGHT GAUGE ALUMINUM AS OFFERED BY MANY COMPETITORS. ALL THESE MEASURES HAVE BEEN TAKEN TO MINIMIZE THE AMOUNT OF "OILCANNING" (WAVINESS) WHICH IS NATURALLY INHERENT IN FLAT SHEET METAL. MANY TIMES, HOWEVER, THE CAUSE OF WAVINESS OR "OIL-CANNING" CAN BE TRACED TO UNEVEN SHEATHING, IMPROPER FELT INSTALLATION OR, IN THE CASE OF OPEN FRAMING, UNEVENNESS OF THE TOP PLANE OF THE PURLINS OR FOOT TRAFFIC ON THE PANELS.

ALL ARCHITECTURAL PANELS REQUIRE CARE IN HANDLING AND INSTALLATION TO AVOID DAMAGING OR DEFORMING THE PANELS.

THESE INSTALLATION INSTRUCTIONS AND THE FOLLOWING TYPICAL DETAILS ARE INTENDED TO PROVIDE OUR CUSTOMERS WITH THE INFORMATION REQUIRED FOR AN AESTHETICALLY PLEASING AND FUNCTIONAL INSTALLATION OF THE BERRIDGE S-DECK PANEL SYSTEM.

NOTE: ALL PRODUCT SPECIFICATIONS, DETAIL AND INSTALLATION INSTRUCTIONS SUBJECT TO CHANGE WITHOUT NOTICE. FOR SPECIFIC PROJECT DETAILS, CONTACT BERRIDGE.



**BERRIDGE
MANUFACTURING
COMPANY**

INSTALLATION INSTRUCTIONS

S-Deck System

DATE: 11-20-00

PAGE/FILE
SDI-4

THE DETAILS CONTAINED IN THE FOLLOWING PAGES ARE MERELY RECOMMENDATIONS AS TO HOW BERRIDGE MANUFACTURING MATERIALS SHOULD BE INSTALLED. THEY MAY REQUIRE ADAPTATIONS OR MODIFICATIONS FOR A SPECIFIC PROJECT AS CONDITIONS VARY IN BOTH BUILDING DESIGN AND LOCAL WEATHER PECULIARITIES.

BERRIDGE MANUFACTURING COMPANY SHALL BE HELD HARMLESS FROM ANY AND ALL CLAIMS ARISING FROM LACK OF WATERTIGHTNESS AS A RESULT OF FOLLOWING THESE RECOMMENDED DETAILS. ENSURING WATERTIGHTNESS ON ANY GIVEN PROJECT IS THE FUNCTION OF THE INSTALLER. THE ARCHITECT/GENERAL CONTRACTOR/INSTALLER MUST ACCEPT THE RESPONSIBILITY TO ADAPT THESE DETAILS TO MEET PARTICULAR BUILDING REQUIREMENTS AND TO ASSURE ADEQUATE WATERTIGHTNESS.

THE INSTALLER CAN VIRTUALLY ASSURE WATERTIGHTNESS IF THESE FLASHING DETAILS HAVE BEEN PROPERLY ADAPTED, ADEQUATE LAPS HAVE BEEN PROVIDED, CORRECT TYPE OF SEALANT USED, ALL JOINTS ADEQUATELY CAULKED, AND PROFESSIONAL WORKMANSHIP EMPLOYED.



**BERRIDGE
MANUFACTURING
COMPANY**

INTRODUCTION TO TYPICAL DETAILS

S-Deck System

DATE: 05-14-09

PAGE/FILE
SD-2

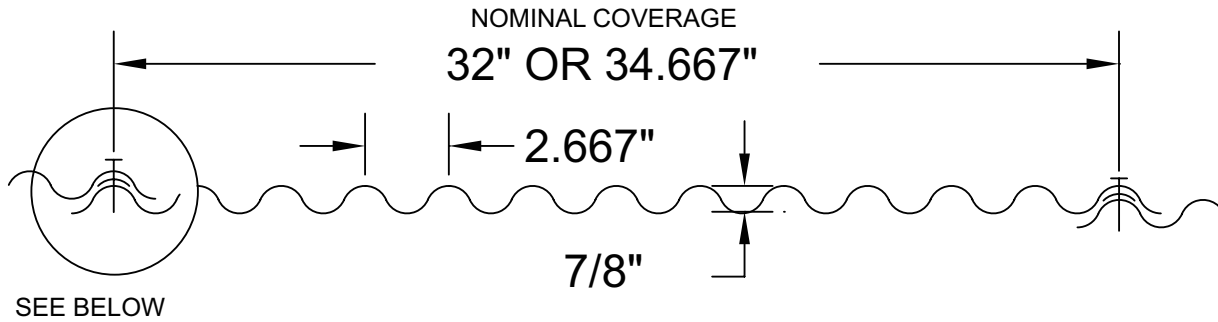

SECTION PROPERTIES

GAGE	THICKNESS	WT. (PSF)	FY (KSI)	IX (IN4/FT)	MA (FT-LBS/FT)
	INCHES (STEEL)				
24	.0239	1.24	40	0.0194	103.7

ALLOWABLE UNIFORM LOADS (PSF)

THICKNESS (INCHES)	DEAD + LIVE LOAD (STRESS)					LIVE LOAD DEFL (L/240)				
	3'-0	3'-6	4'-0	4'-6	5'-0	3'-0	3'-6	4'-0	4'-6	5'-0
.0239	104	77	58	46	37	88	55	37	25	20

1. SECTION PROPERTIES AND ALLOWABLE STRESSES HAVE BEEN CALCULATED IN ACCORDANCE WITH 1986 AISI SPECIFICATIONS FOR THE DESIGN OF COLD-FORMED STEEL STRUCTURAL MEMBERS.
2. PANEL STEEL CONFORMS TO ASTM A653 GRADE C.
3. VALUES SHOWN AS ALLOWABLE LOADS ARE BASED ON PANELS COVERING THREE EQUAL CONTINUOUS SPANS. MULTIPLY THE VALUES BY 0.8 FOR TWO SPAN ALLOWABLE LOADS.
4. THE PANEL WEIGHT HAS BEEN DEDUCTED FROM THE ALLOWABLE LOAD TABLES.
5. THE ALLOWABLE LOADS SHOWN ABOVE MAY BE INCREASED BY 33% FOR WIND UPLIFT.
6. SHEER DIAPHRAGM VALUE = 210#/L.F. NOMINAL

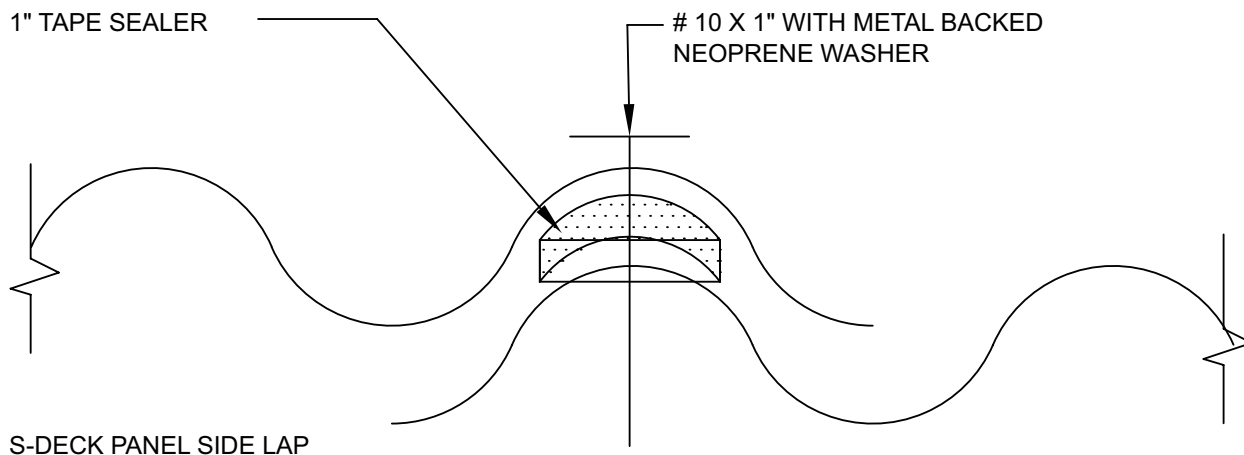

**BERRIDGE
MANUFACTURING
COMPANY**

Roofs of Distinction

**OVERVIEW
S-DECK**

S-Deck System

DATE: 05-14-09

PAGE/FILE
SD-3

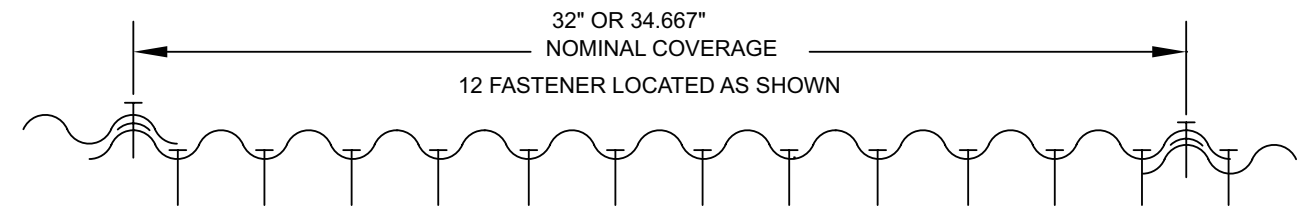

S-DECK PANEL FASTENER SPACING AT END LAP

FASTENER WITH METAL BACKED NEOPRENE WASHER
SEE PAGE SDI-3 FOR FASTENER TYPES

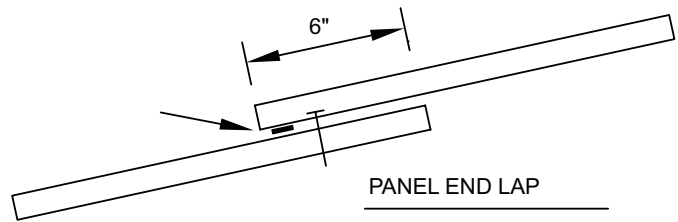

PANEL END LAP

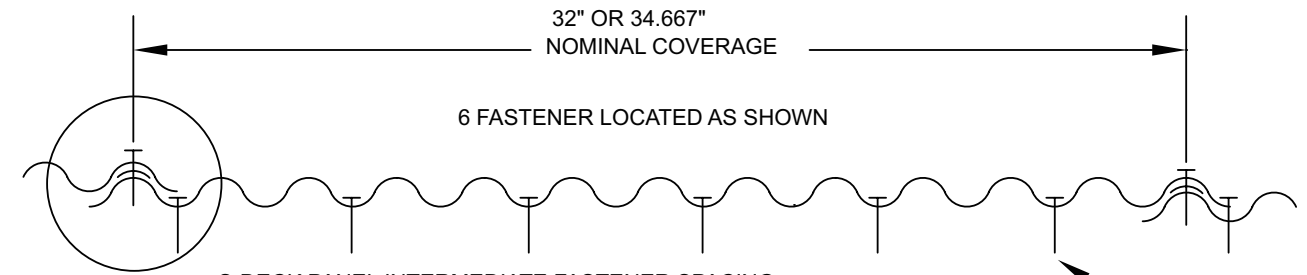

S-DECK PANEL INTERMEDIATE FASTENER SPACING

FASTENER WITH METAL BACKED NEOPRENE WASHER
SEE PAGE SDI-3 FOR FASTENER TYPES

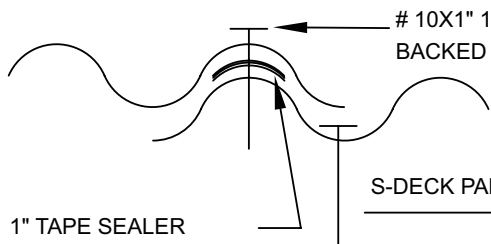

S-DECK PANEL SIDE LAP TYPICAL

1" TAPE SEALER

10X1" 12" O.C. WITH METAL BACKED NEOPRENE WASHER

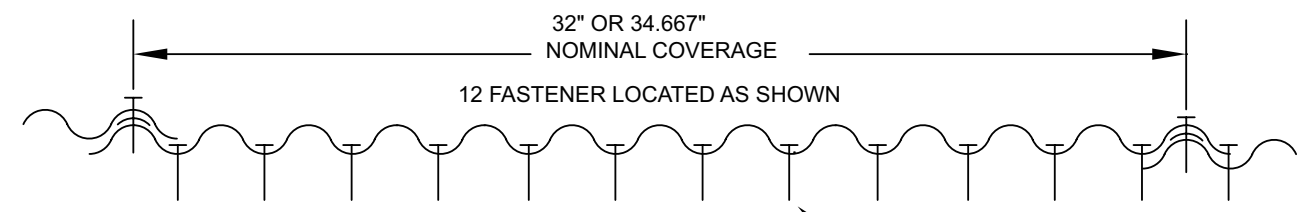

S-DECK PANEL EAVE FASTENER SPACING

FASTENER WITH METAL BACKED NEOPRENE WASHER
SEE PAGE SDI-3 FOR FASTENER TYPES

REFERENCE DETAIL SD-10
SD-11 & SD-12 FOR
EAVE FLASHING AND CLOSURE/TAPE
SEALER INFORMATION



**BERRIDGE
MANUFACTURING
COMPANY**

Roofs of Distinction

FASTENER LAYOUT

S-Deck System

DATE: 05-14-09

PAGE/FILE
SD-4

BERRIDGE S-DECK PANEL

INSIDE FOAM CLOSURE WITH TAPE SEALER TOP & BOTTOM

PANEL FASTENER WITH METAL BACKED NEOPRENE WASHER AT 5 1/2" O.C.

EAVE FLASHING, 4" END LAPS WITH CONTINUOUS CAULK AT LAPS

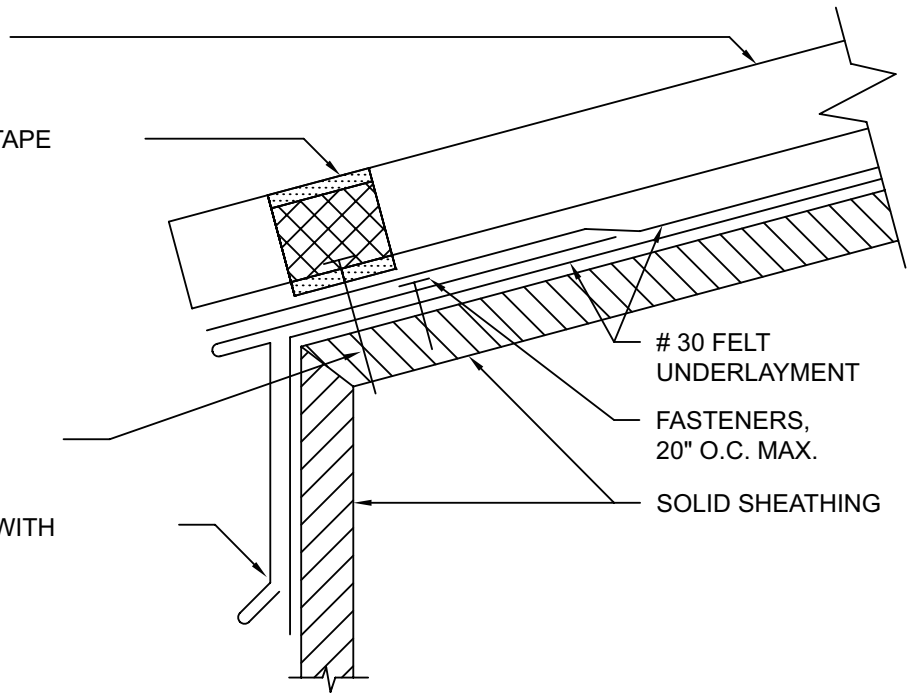

30 FELT UNDERLAYMENT

FASTENERS, 20" O.C. MAX.

SOLID SHEATHING

1. SOLID SHEATHING (BY OTHERS) TO BE MINIMUM 1/2" PLYWOOD OR EQUIVALENT IN STRENGTH FOR HOLDING POWER OF FASTENERS.
2. ALL FELT UNDERLAYMENT, CAULKING AND FASTENERS ARE ITEMS TO BE FURNISHED AND INSTALLED BY THE ROOFING INSTALLER AT THE DISCRETION OF THE ARCHITECT.
3. USE ICE AND WATERSHIELD AS UNDERLAYMENT FOR CURVED S-DECK.

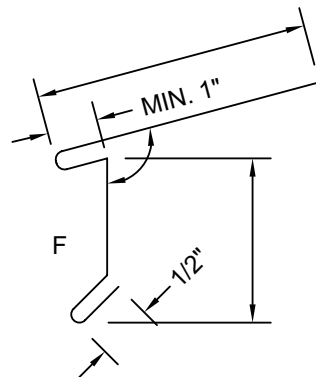

F = FINISH SIDE

EAVE FLASHING



**BERRIDGE
MANUFACTURING
COMPANY**

Roofs of Distinction

**EAVE DETAIL
SOLID SHEATHING**

S-Deck System

DATE: 11-20-00

PAGE/FILE
SD-10

BERRIDGE S-DECK PANEL

INSIDE FOAM CLOSURE WITH TAPE SEALER TOP & BOTTOM

PANEL FASTENER WITH METAL BACKED NEOPRENE WASHER AT 5 1/2" O.C.

EAVE FLASHING, 4" END LAPS WITH CONTINUOUS CAULK AT LAPS

BERRIDGE WALL PANEL

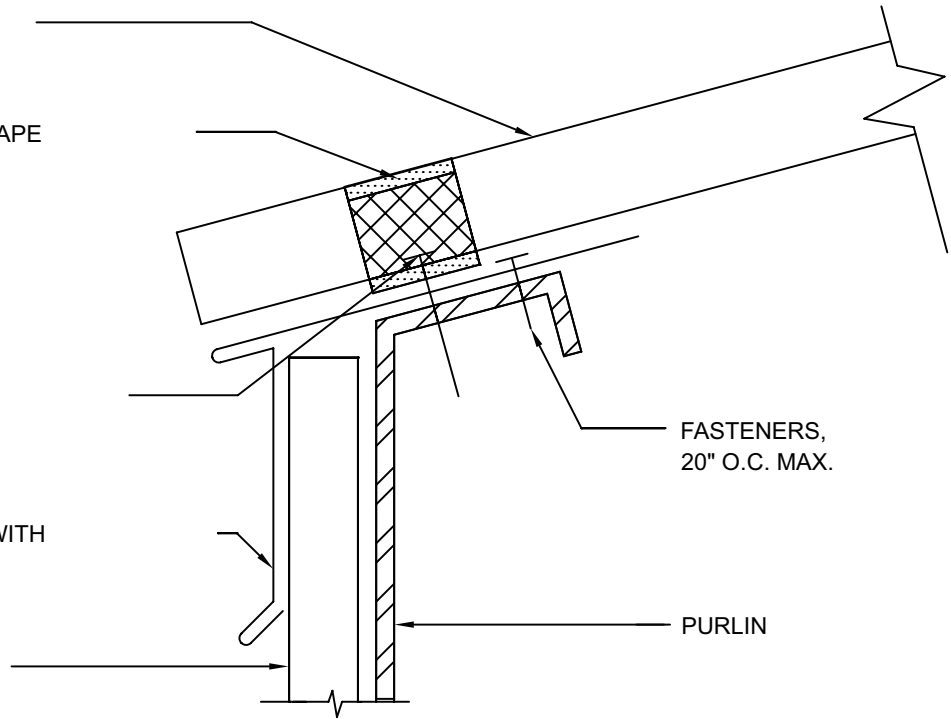

FASTENERS, 20" O.C. MAX.

PURLIN

1. CAULKING AND FASTENERS ARE ITEMS TO BE FURNISHED AND INSTALLED BY THE ROOFING INSTALLER AT THE DISCRETION OF THE ARCHITECT.

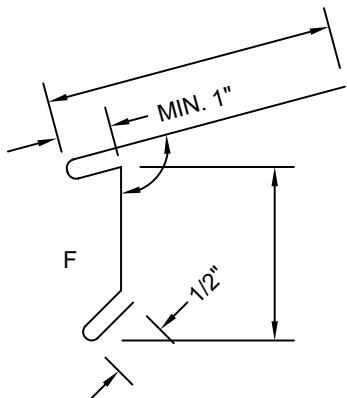

F = FINISH SIDE

EAVE FLASHING



**BERRIDGE
MANUFACTURING
COMPANY**

Roofs of Distinction

**EAVE DETAIL
OPEN FRAMING**

S-Deck System

DATE: 11-20-00

PAGE/FILE
SD-11

BERRIDGE S-DECK PANEL

INSIDE FOAM CLOSURE WITH TAPE SEALER TOP AND BOTTOM

PANEL FASTENER WITH METAL BACKED NEOPRENE WASHER AT 5 1/2" O.C.

OUTSIDE FOAM CLOSURE WITH TAPE SEALER TOP AND BOTTOM

FASTENER WITH METAL BACKED NEOPRENE WASHER 20" O.C.

EAVE FLASHING, 4" END LAPS WITH CONTINUOUS CAULK AT LAPS

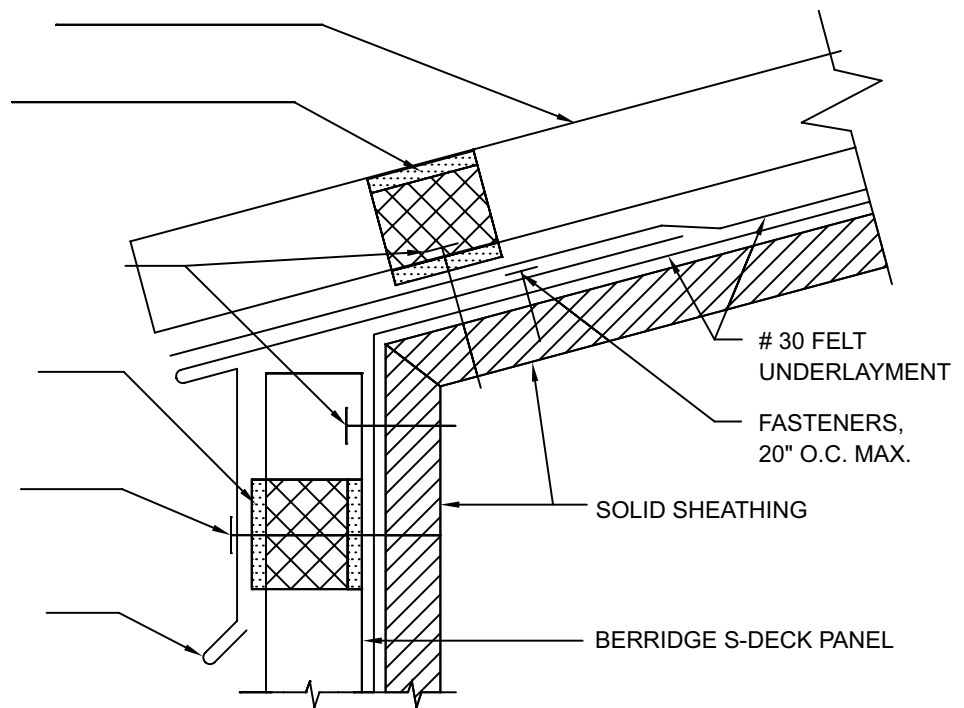

1. SOLID SHEATHING (BY OTHERS) TO BE MINIMUM 1/2" PLYWOOD OR EQUIVALENT IN STRENGTH FOR HOLDING POWER OF FASTENERS.
2. ALL FELT UNDERLAYMENT, CAULKING AND FASTENERS ARE ITEMS TO BE FURNISHED AND INSTALLED BY THE ROOFING INSTALLER AT THE DISCRETION OF THE ARCHITECT.
3. USE ICE AND WATERSHIELD AS UNDERLAYMENT FOR CURVED S-DECK.

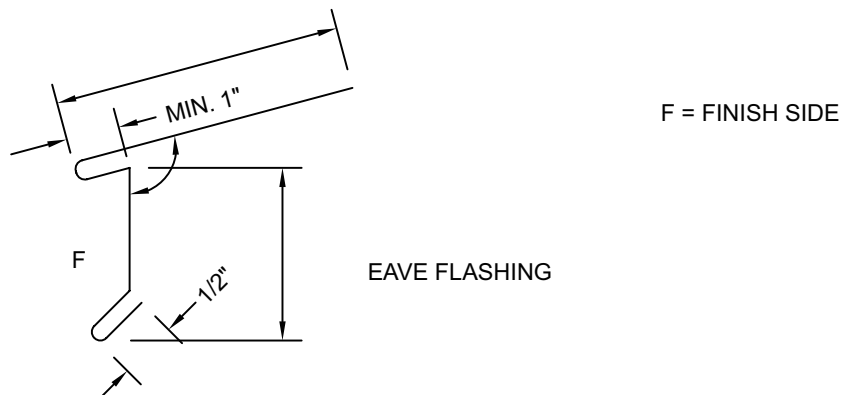

**BERRIDGE
MANUFACTURING
COMPANY**

Roofs of Distinction

**EAVE DETAIL
SOLID SHEATHING**

S-Deck System

DATE: 11-20-00

PAGE/FILE
SD-12

RIDGE/HIP CAP; 4" END LAPS WITH CONTINUOUS CAULK AT LAPS. POP RIVET AT LAPS

BERRIDGE S-DECK PANEL

PANEL FASTENER WITH METAL BACKED NEOPRENE WASHER

FASTENERS WITH METAL BACKED NEOPRENE WASHER 20" O.C.

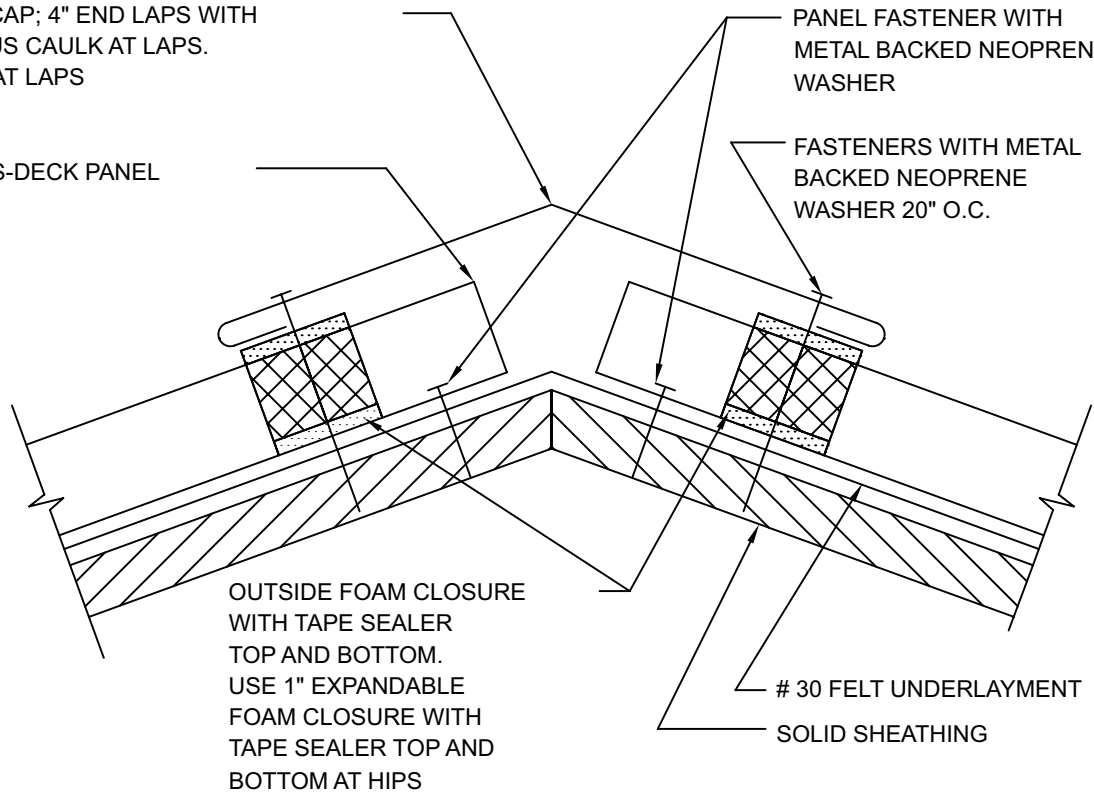

1. SOLID SHEATHING (BY OTHERS) TO BE MINIMUM 1/2" PLYWOOD OR EQUIVALENT IN STRENGTH FOR HOLDING POWER OF FASTENERS.
2. ALL FELTING UNDERLAYMENT, CAULKING, AND FASTENERS, ARE ITEMS TO BE FURNISHED AND INSTALLED BY THE ROOFING INSTALLER AT THE DISCRETION OF THE ARCHITECT.

F = FINISH SIDE

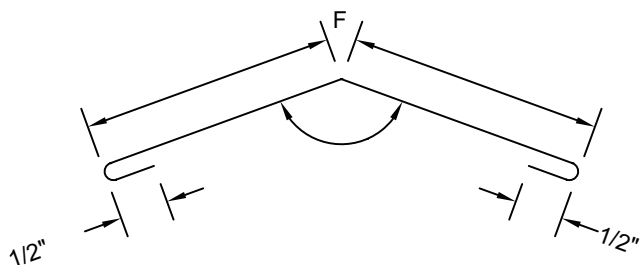

RIDGE/HIP CAP



**BERRIDGE
MANUFACTURING
COMPANY**

Roofs of Distinction

RIDGE AND HIP DETAIL

S-Deck System

DATE: 11-20-00

PAGE/FILE
SD-20

RIDGE CAP; 4" END LAPS WITH
CONTINUOUS CAULK AT LAPS.
POP RIVET AT LAPS

BERRIDGE S-DECK PANEL

FASTENERS WITH METAL
BACKED NEOPRENE
WASHER 20" O.C.

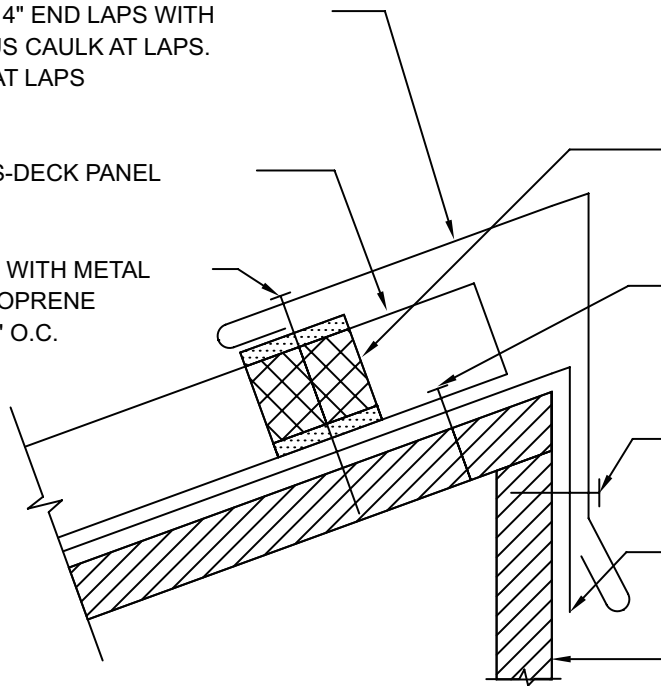

OUTSIDE FOAM CLOSURE
WITH TAPE SEALER
TOP AND BOTTOM

PANEL FASTENER WITH
METAL BACKED NEOPRENE
WASHER

FASTENER WITH
METAL BACKED NEOPRENE
WASHER. 40" O.C. MAX

30 FELT UNDERLAYMENT
LAP FELT OVER RIDGE

SOLID SHEATHING

1. SOLID SHEATHING (BY OTHERS) TO BE MINIMUM 1/2" PLYWOOD OR EQUIVALENT IN STRENGTH FOR HOLDING POWER OF FASTENERS.
2. ALL FELTING UNDERLAYMENT, CAULKING, AND FASTENERS, ARE ITEMS TO BE FURNISHED AND INSTALLED BY THE ROOFING INSTALLER AT THE DISCRETION OF THE ARCHITECT.

F = FINISH SIDE

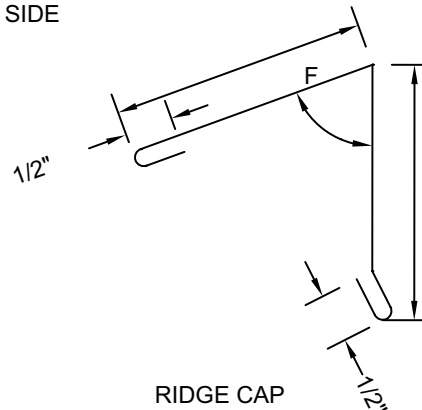

RIDGE CAP



**BERRIDGE
MANUFACTURING
COMPANY**

SHED ROOF RIDGE CAP DETAIL

S-Deck System

DATE: 11-20-00

PAGE/FILE

SD-21

RIDGE/HIP CAP; 4" END LAPS WITH CONTINUOUS CAULK AT LAPS.

BERRIDGE S-DECK PANEL

OUTSIDE FOAM CLOSURE WITH TAPE SEALER TOP AND BOTTOM. USE 1" EXPANDABLE FOAM CLOSURE WITH TAPE SEALER TOP AND BOTTOM AT HIPS

PANEL FASTENER WITH METAL BACKED NEOPRENE WASHER

FASTENERS WITH METAL BACKED NEOPRENE WASHER 20" O.C.

SUB FLASHING 4" END LAPS WITH CONTINUOUS CAULK AT LAPS

PURLINS

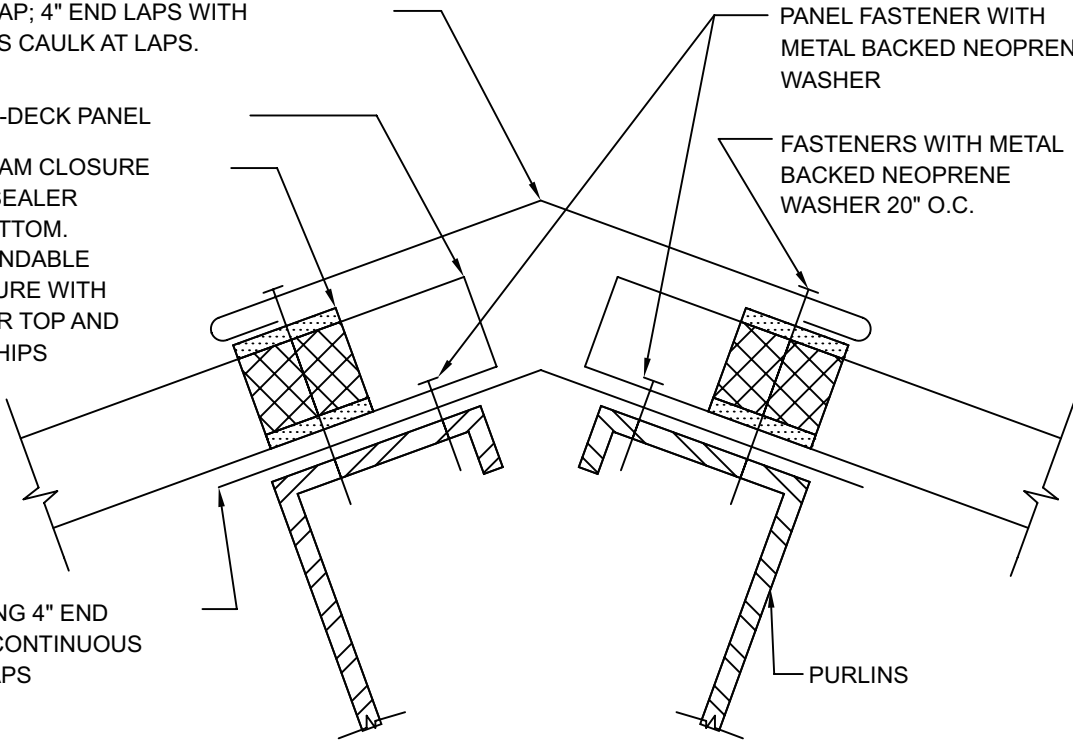

1. ALL CAULKING, AND FASTENERS, ARE ITEMS TO BE FURNISHED AND INSTALLED BY THE ROOFING INSTALLER AT THE DISCRETION OF THE ARCHITECT.

F = FINISH SIDE

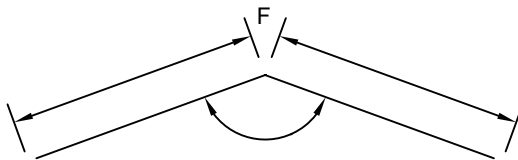

SUB FLASHING

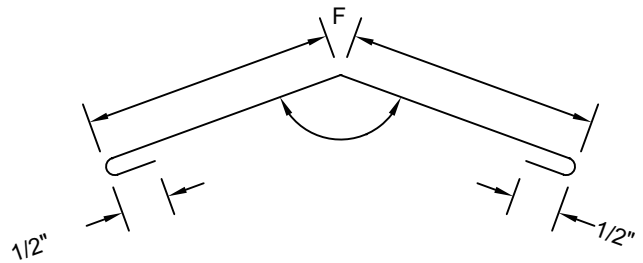

RIDGE/HIP CAP



BERRIDGE
MANUFACTURING
COMPANY

Roofs of Distinction

RIDGE AND HIP DETAIL
OPEN FRAMING

S-Deck System

DATE: 11-20-00

PAGE/FILE
 SD-22

SECTION VIEW

FIELD FORM END OF RIDGE FLASHING
AND EXTEND UNDER UPPER PANEL

RIDGE FLASHING; 4" END LAPS
WITH CONTINUOUS CAULK AT LAPS

FIELD TAPERED OUTSIDE CLOSURE

SD-20

SOLID SHEATHING

VALLEY FLASHING; 12" LAPS WITH
CONTINUOUS CAULK AT LAPS

BERRIDGE S-DECK
PANEL

1" EXPANDABLE FOAM
CLOSURE WITH TAPE
SEALER TOP AND BOTTOM

30 FELT
UNDERLAYMENT

PANEL FASTENER WITH
METAL BACKED
NEOPRENE WASHER
AT 5 1/2" O.C.

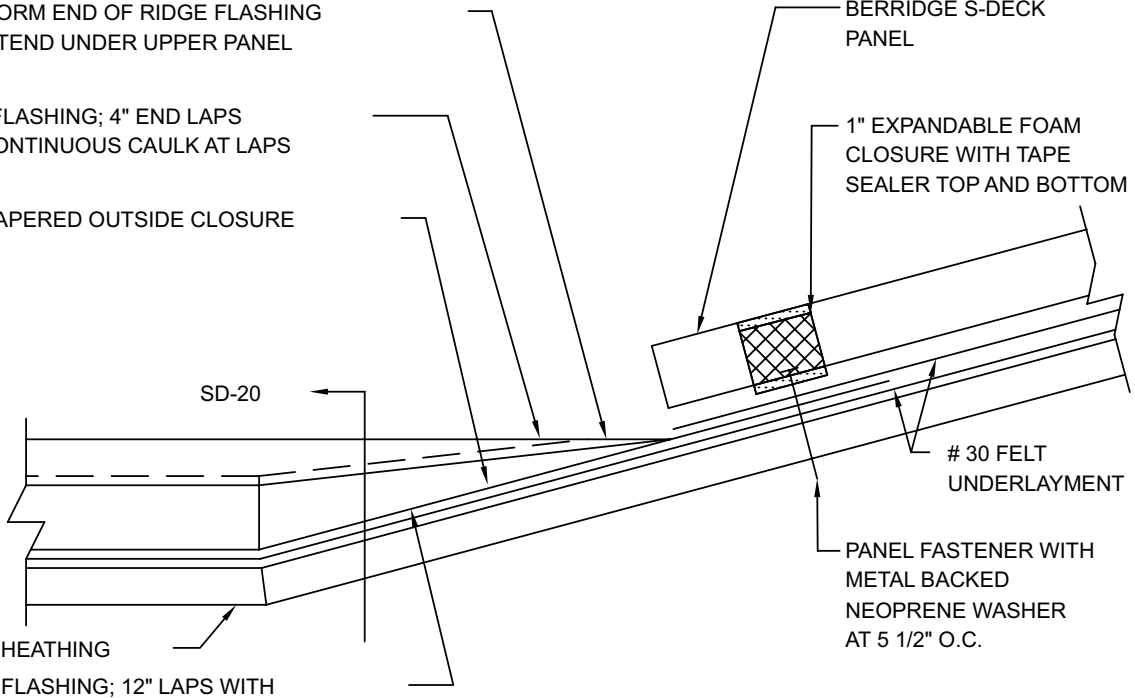

PLAN VIEW

MAIN ROOF
PANELS

RIDGE FLASHING

INSIDE FOAM CLOSURE

VALLEY FLASHING

DORMER PANEL

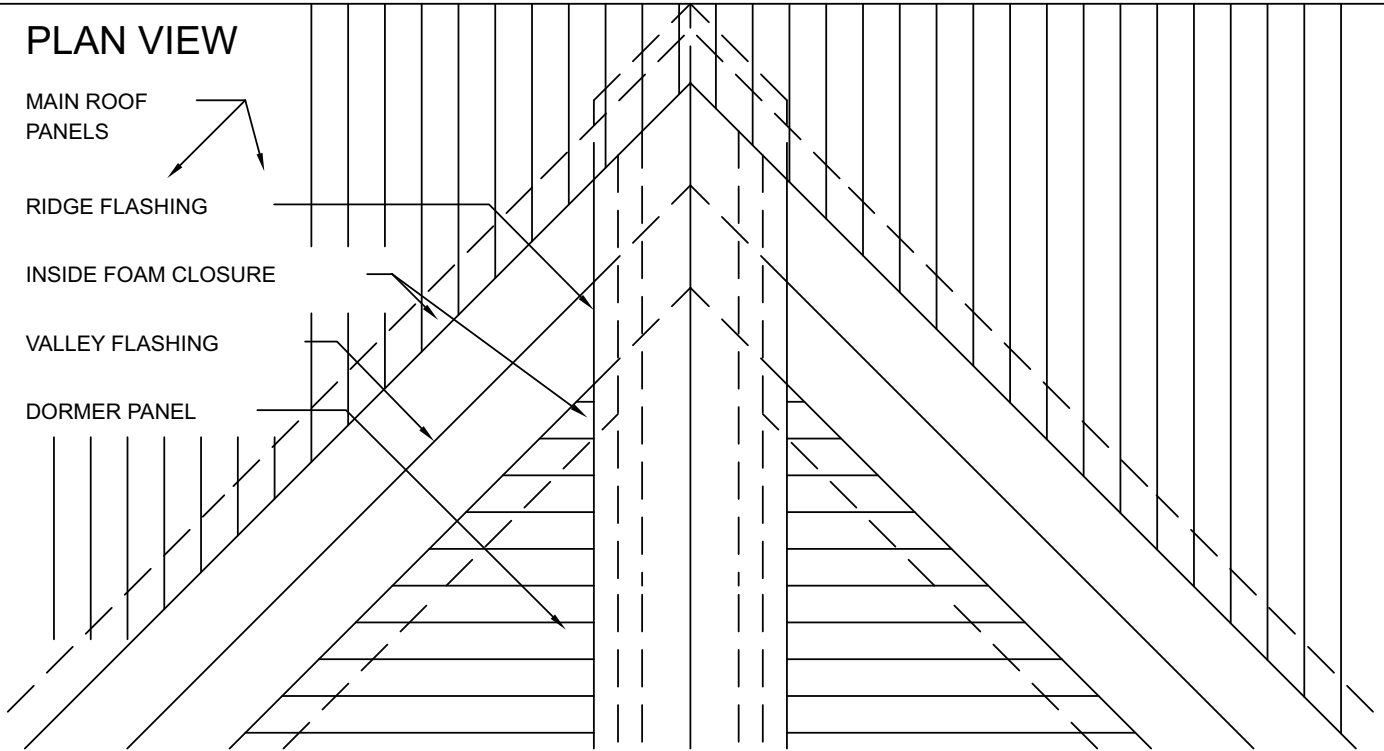

**BERRIDGE
MANUFACTURING
COMPANY**

Roofs of Distinction

**RIDGE TERMINATION
AT DORMER VALLEY**

S-Deck System

DATE: 11-20-00

PAGE/FILE

SD-23

CONTINUOUS BEAD OF CAULK

GABLE CHANNEL 4" END LAPS WITH CONTINUOUS CAULK AT LAPS

1" EXPANDABLE FOAM CLOSURE WITH TAPE SEALER TOP AND BOTTOM

CONTINUOUS BEAD OF CAULK

FASTENERS; 20" O.C. MAX.

DRIP FLASHING; 4" END LAPS WITH CONTINUOUS CAULK AT LAPS

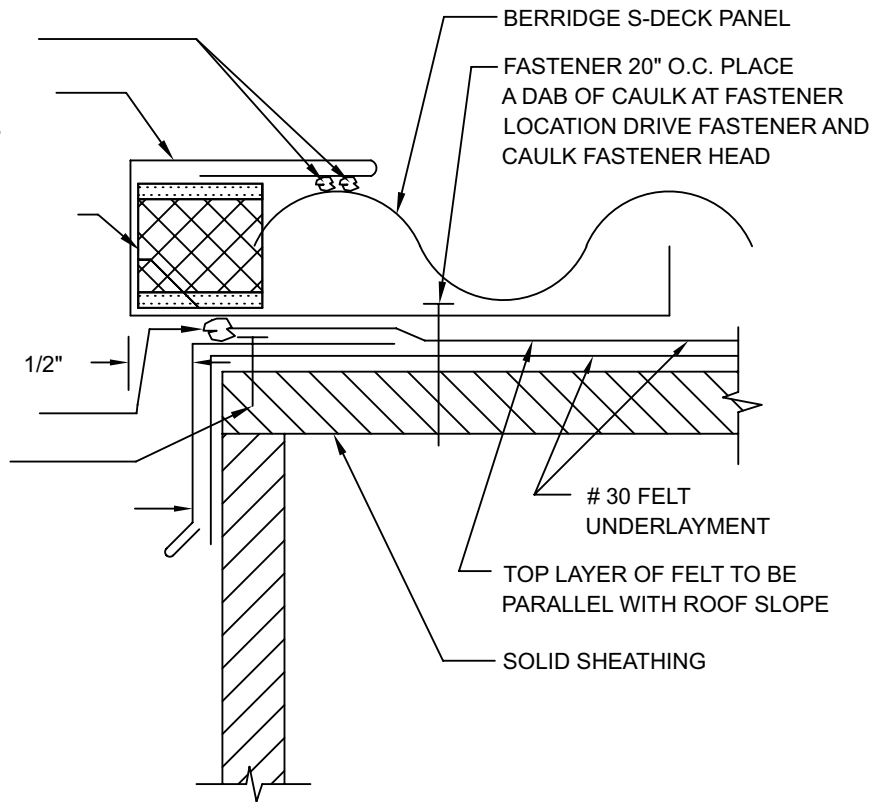

1. SOLID SHEATHING (BY OTHERS) TO BE MINIMUM 1/2" PLYWOOD OR EQUIVALENT IN STRENGTH FOR HOLDING POWER OF FASTENERS.
2. ALL FELT UNDERLAYMENT, CAULKING, AND FASTENERS, ARE ITEMS TO BE FURNISHED AND INSTALLED BY THE ROOFING INSTALLER AT THE DISCRETION OF THE ARCHITECT.

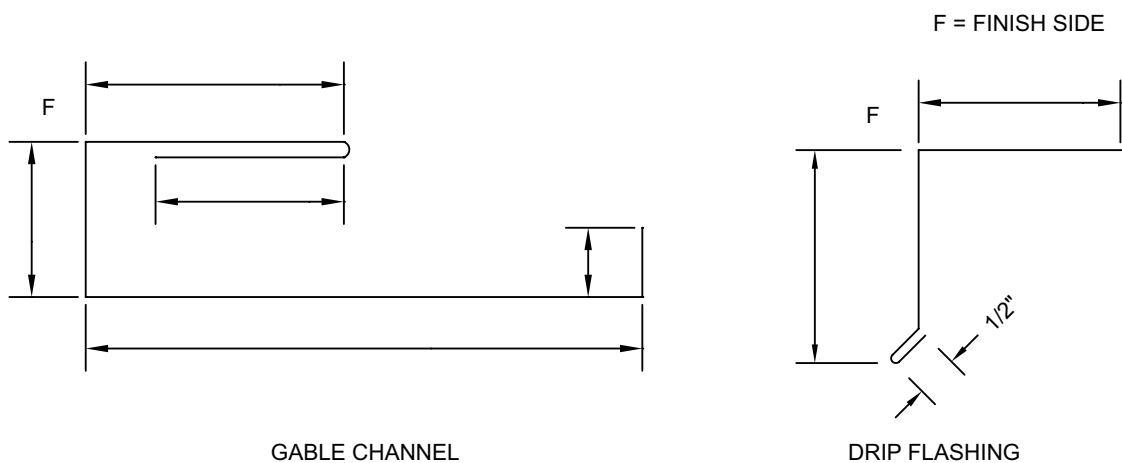

BERRIDGE
MANUFACTURING
COMPANY

GABLE DETAIL

S-Deck System

DATE: 11-20-00

PAGE/FILE

SD-30

CONTINUOUS BEAD OF CAULK

GABLE CHANNEL; 4" END LAPS WITH CONTINUOUS CAULK AT LAPS

1" EXPANDABLE FOAM CLOSURE WITH TAPE SEALER TOP AND BOTTOM.

CONTINUOUS BEAD OF CAULK

FASTENERS; 20" O.C. WITH METAL BACKED NEOPRENE WASHER

DRIP FLASHING; 4" END LAPS WITH CONTINUOUS CAULK AT LAPS

OUTSIDE FOAM CLOSURE WITH TAPE SEALER TOP AND BOTTOM

BERRIDGE S-DECK PANEL

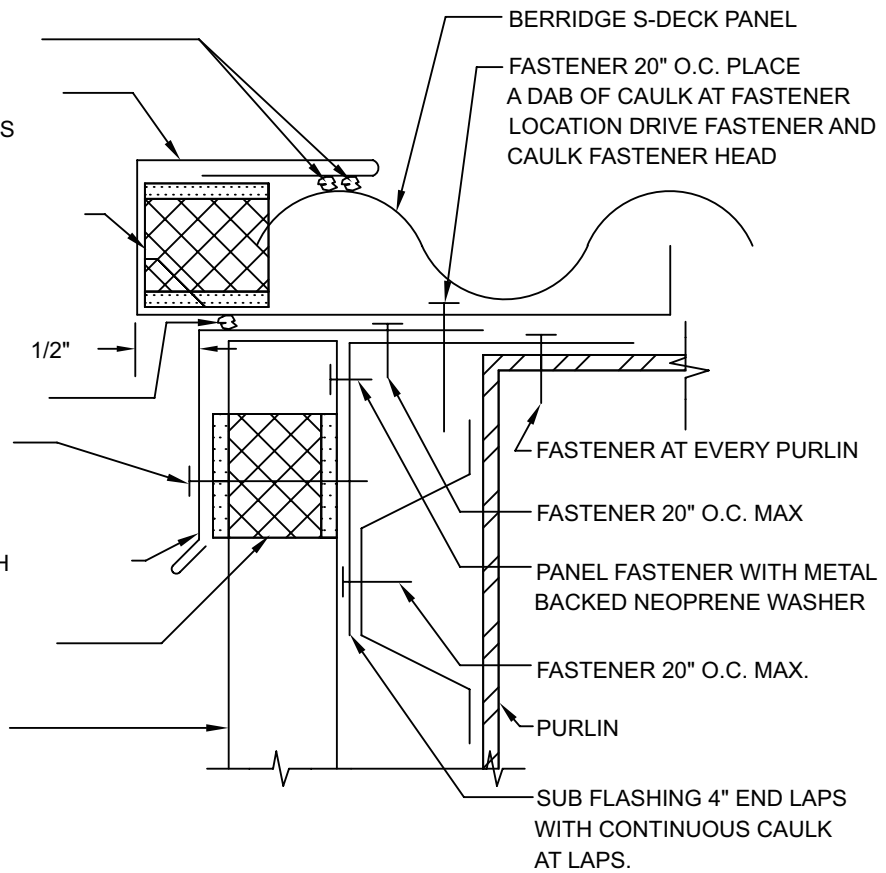

1. ALL CAULKING, AND FASTENERS, ARE ITEMS TO BE FURNISHED AND INSTALLED BY THE ROOFING INSTALLER AT THE DISCRETION OF THE ARCHITECT.

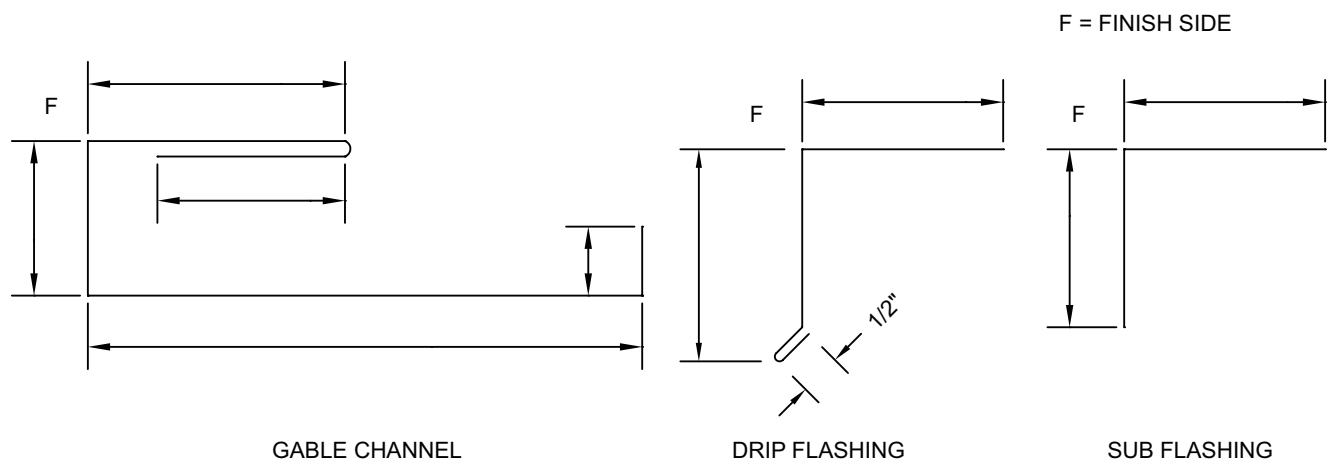

BERRIDGE
MANUFACTURING
COMPANY

GABLE DETAIL

S-Deck System

DATE: 11-20-00

PAGE/FILE
 SD-31

CONTINUOUS BEAD OF CAULK
 GABLE CHANNEL 4" END LAPS
 WITH CONTINUOUS CAULK AT LAPS

1" EXPANDABLE FOAM CLOSURE
 WITH TAPE SEALER TOP AND
 BOTTOM

CONTINUOUS BEAD OF CAULK

DRIP FLASHING; 4" END LAPS WITH
 CONTINUOUS CAULK AT LAPS

BERRIDGE WALL PANEL

30# FELT UNDERLAYMENT

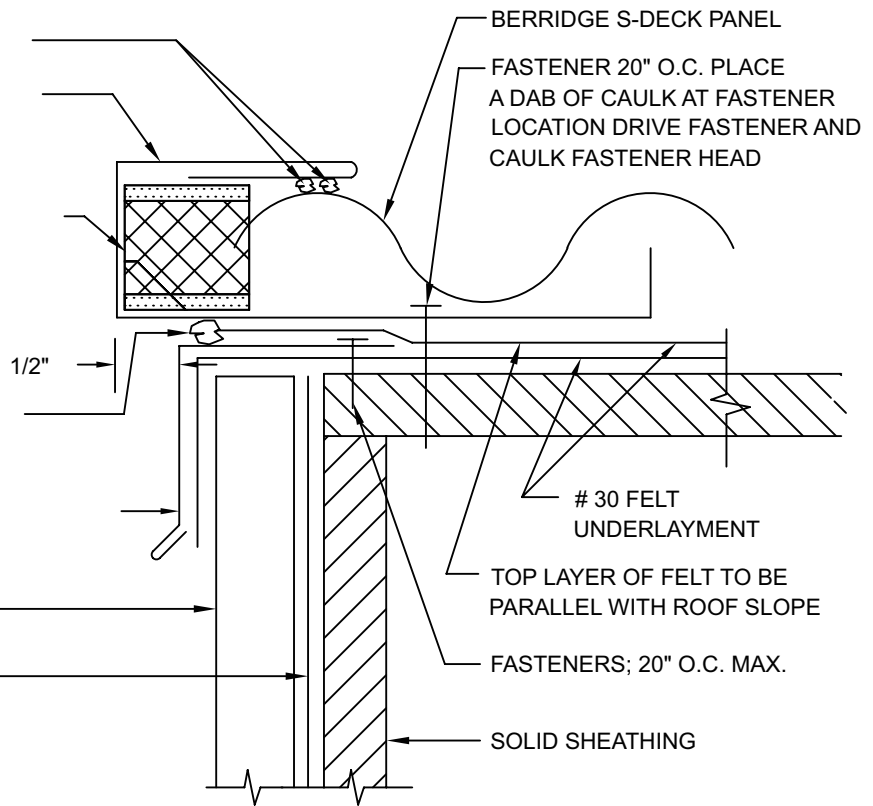

1. SOLID SHEATHING (BY OTHERS) TO BE MINIMUM 1/2" PLYWOOD OR EQUIVALENT IN STRENGTH FOR HOLDING POWER OF FASTENERS.
2. ALL FELT UNDERLAYMENT, CAULKING, AND FASTENERS, ARE ITEMS TO BE FURNISHED AND INSTALLED BY THE ROOFING INSTALLER AT THE DISCRETION OF THE ARCHITECT.

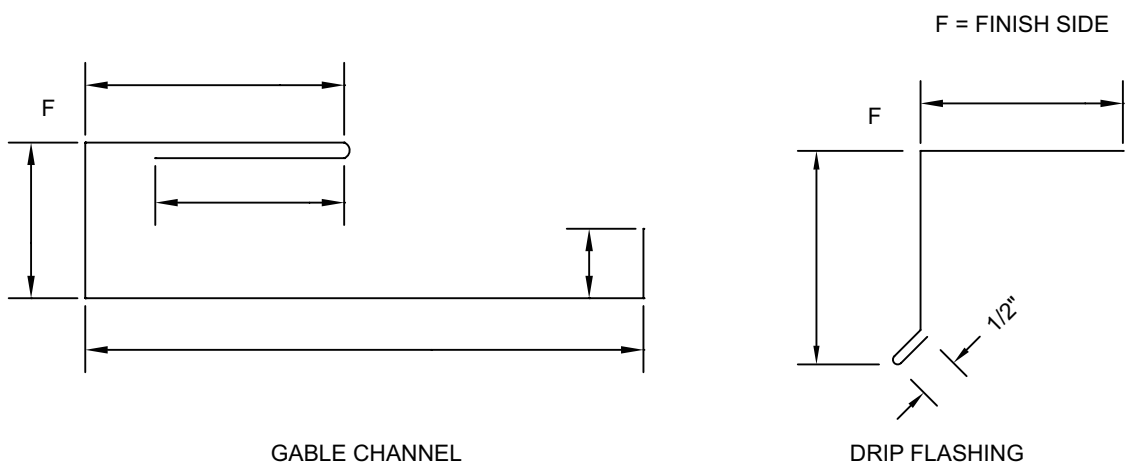

**BERRIDGE
 MANUFACTURING
 COMPANY**

GABLE DETAIL

S-Deck System

DATE: 11-20-00

PAGE/FILE
 SD-32

FASTENERS WITH METAL BACKED
NEOPRENE WASHER 20" O.C. MAX.

1" EXPANDABLE FOAM CLOSURE
WITH TAPE SEALER TOP AND
BOTTOM.

DRIP FLASHING; 4" END LAPS WITH
CONTINUOUS CAULK AT LAPS

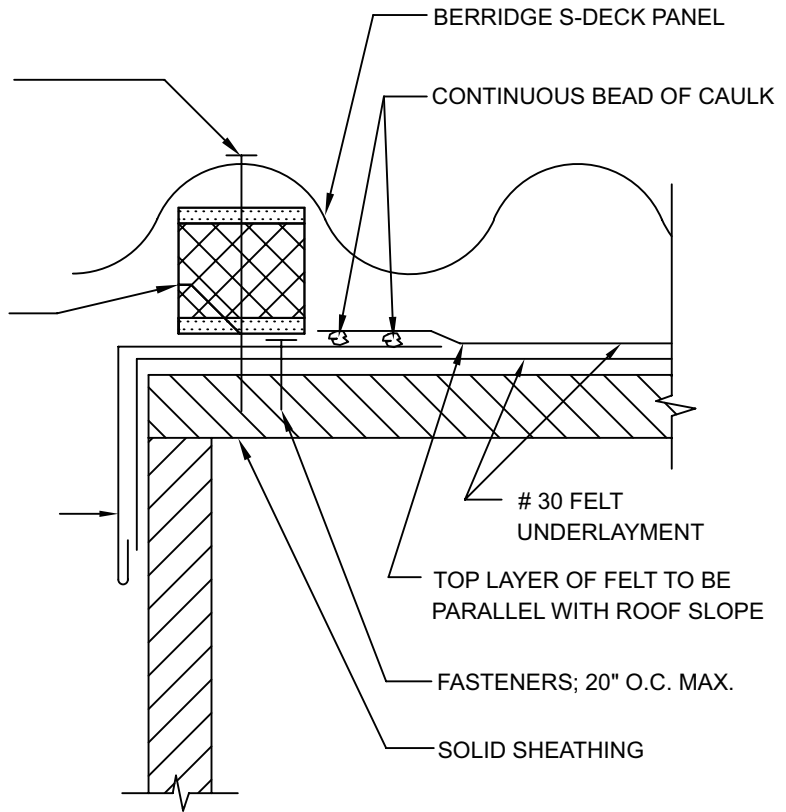

1. SOLID SHEATHING (BY OTHERS) TO BE MINIMUM 1/2" PLYWOOD OR EQUIVALENT IN STRENGTH FOR HOLDING POWER OF FASTENERS.
2. ALL ICE AND WATERSHIELD UNDERLAYMENT, CAULKING, AND FASTENERS, ARE ITEMS TO BE FURNISHED AND INSTALLED BY THE ROOFING INSTALLER AT THE DISCRETION OF THE ARCHITECT.
3. UNDERLAYMENT TO BE ICE AND WATERSHIELD FOR CURVED PANELS.

F = FINISH SIDE

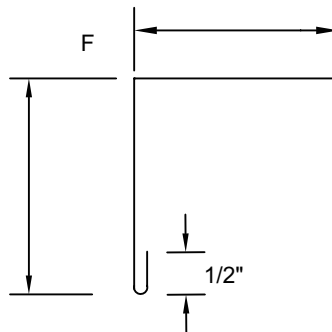

DRIP FLASHING



**BERRIDGE
MANUFACTURING
COMPANY**

GABLE DETAIL CURVED PANELS

S-Deck System

DATE: 11-20-00

PAGE/FILE
SD-33

CAP FLASHING; 4" END LAPS WITH CONTINUOUS CAULK AT LAPS. POP RIVET TO COUNTER FLASHING 40" O.C. MAX. CAULK ALL RIVET HEADS

FASTENERS; 20" O.C. MAX.

COUNTERFLASHING; 4" END LAPS WITH CONTINUOUS CAULK AT LAPS

SUB-FLASHING; 4" END LAPS WITH CONTINUOUS CAULK AT LAPS

30 FELT UNDERLAYMENT

OUTSIDE FOAM CLOSURE WITH TAPE SEALER TOP AND BOTTOM

BERRIDGE S-DECK PANEL

SOLID SHEATHING

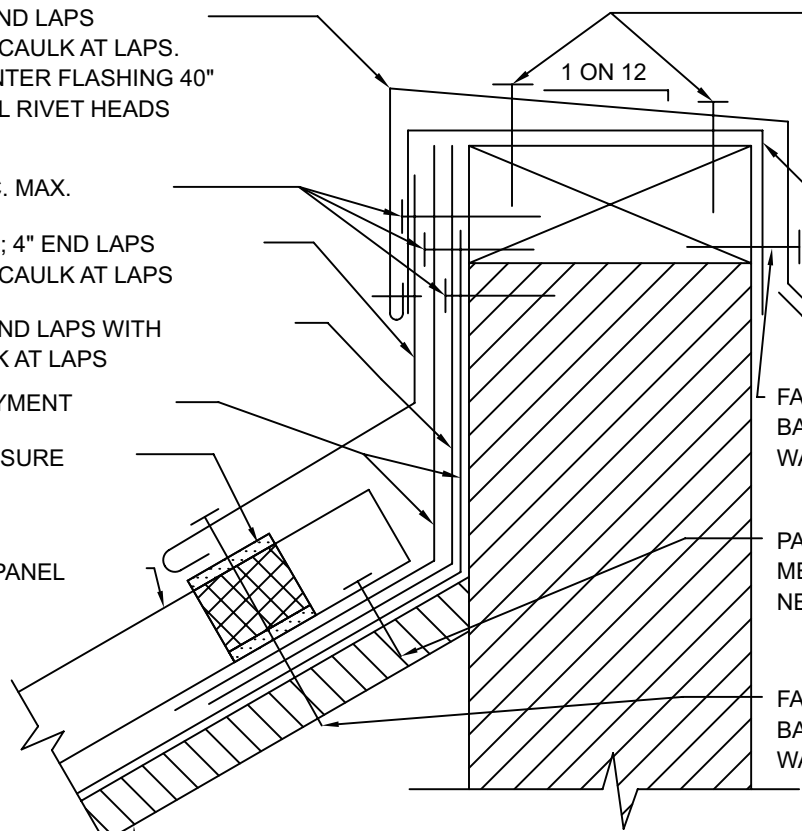

FASTENERS AT LAPS AND STAGGERED; 20" O.C. AND CAULK FASTENER HEADS
30 FELT UNDERLAYMENT

FASTENERS; WITH METAL BACKED NEOPRENE WASHER. 40" O.C. MAX.

PANEL FASTENERS; WITH METAL BACKED NEOPRENE WASHER.

FASTENERS; WITH METAL BACKED NEOPRENE WASHER. 20" O.C. MAX.

1. SOLID SHEATHING (BY OTHERS) TO BE MINIMUM 1/2" PLYWOOD OR EQUIVALENT IN STRENGTH FOR HOLDING POWER OF FASTENERS.

2. ALL FELT UNDERLAYMENT, CAULKING, AND FASTENERS, ARE ITEMS TO BE FURNISHED AND INSTALLED BY THE ROOFING INSTALLER AT THE DISCRETION OF THE ARCHITECT.

F = FINISH SIDE

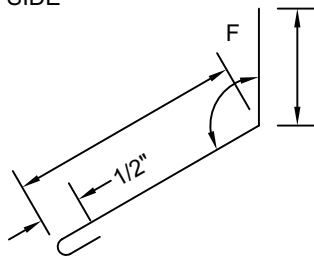

COUNTERFLASHING

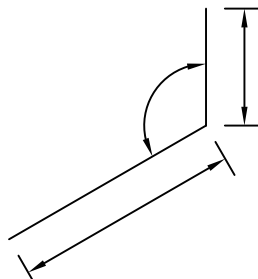

SUB-FLASHING

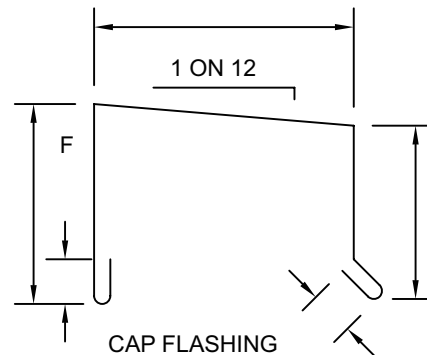

CAP FLASHING



BERRIDGE
MANUFACTURING
COMPANY

PARAPET DETAIL

S-Deck System

DATE: 11-20-00

PAGE/FILE
SD-40

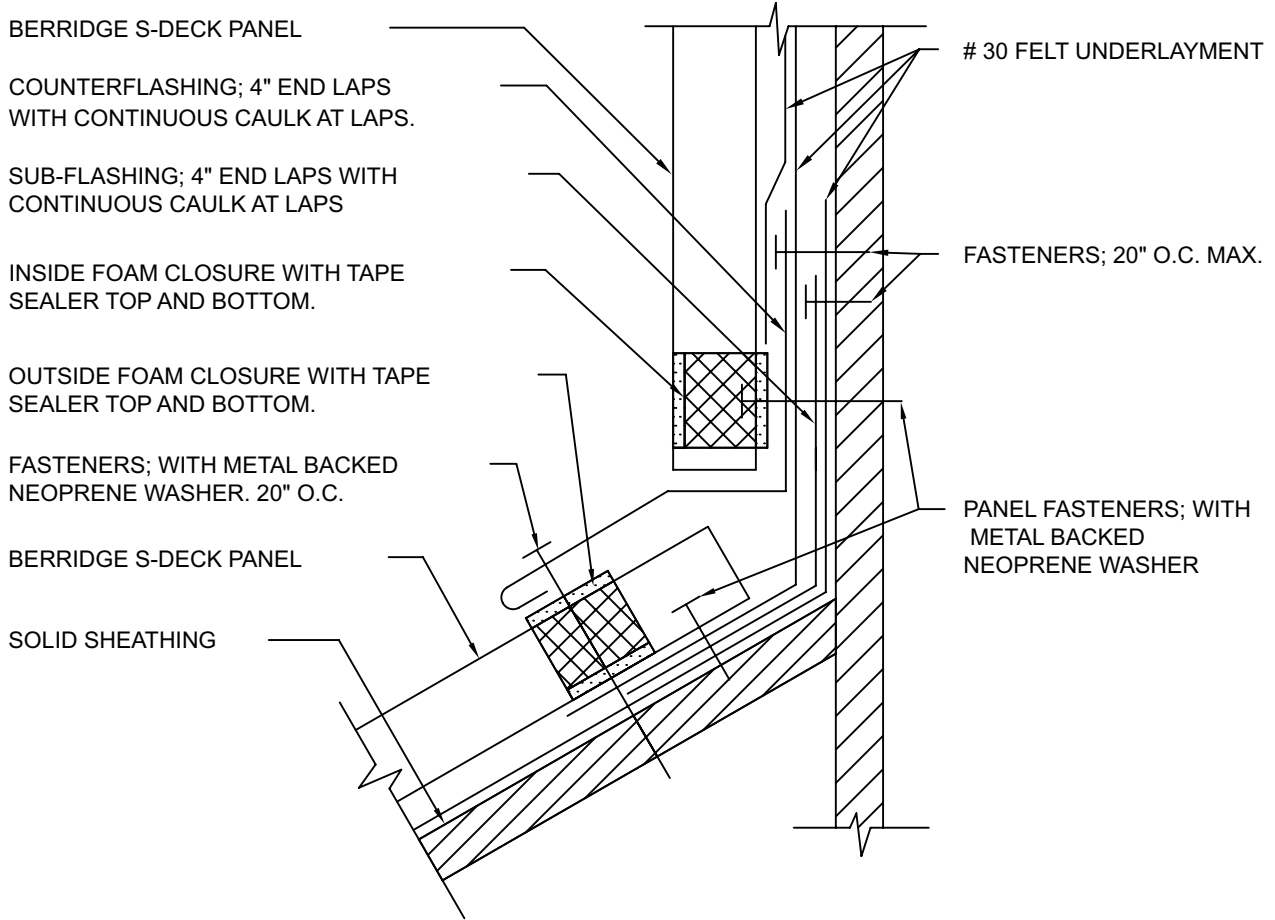

1. SOLID SHEATHING (BY OTHERS) TO BE MINIMUM 1/2" PLYWOOD OR EQUIVALENT IN STRENGTH FOR HOLDING POWER OF FASTENERS.
2. ALL FELT UNDERLAYMENT, CAULKING, AND FASTENERS, ARE ITEMS TO BE FURNISHED AND INSTALLED BY THE ROOFING INSTALLER AT THE DISCRETION OF THE ARCHITECT.

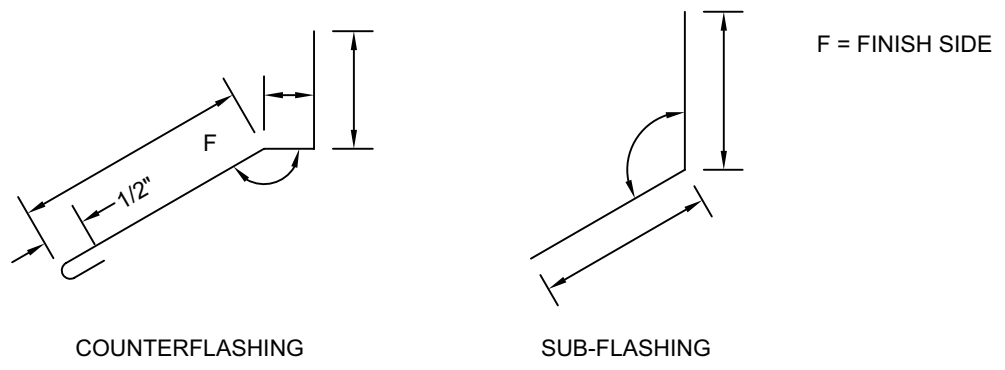

**BERRIDGE
MANUFACTURING
COMPANY**

HEAD WALL DETAIL

S-Deck System

DATE: 11-20-00

PAGE/FILE
SD-41

REGLET FLASHING; 4" END LAPS
WITH CONTINUOUS CAULK AT LAPS

FASTENERS; 20" O.C. MAX.

COUNTERFLASHING; 4" END LAPS
WITH CONTINUOUS CAULK AT LAPS.

SUB-FLASHING; 4" END LAPS WITH
CONTINUOUS CAULK AT LAPS

30 FELT UNDERLAYMENT

BERRIDGE S-DECK PANEL

OUTSIDE FOAM CLOSURE
WITH TAPE SEALER TOP
AND BOTTOM.

SOLID SHEATHING

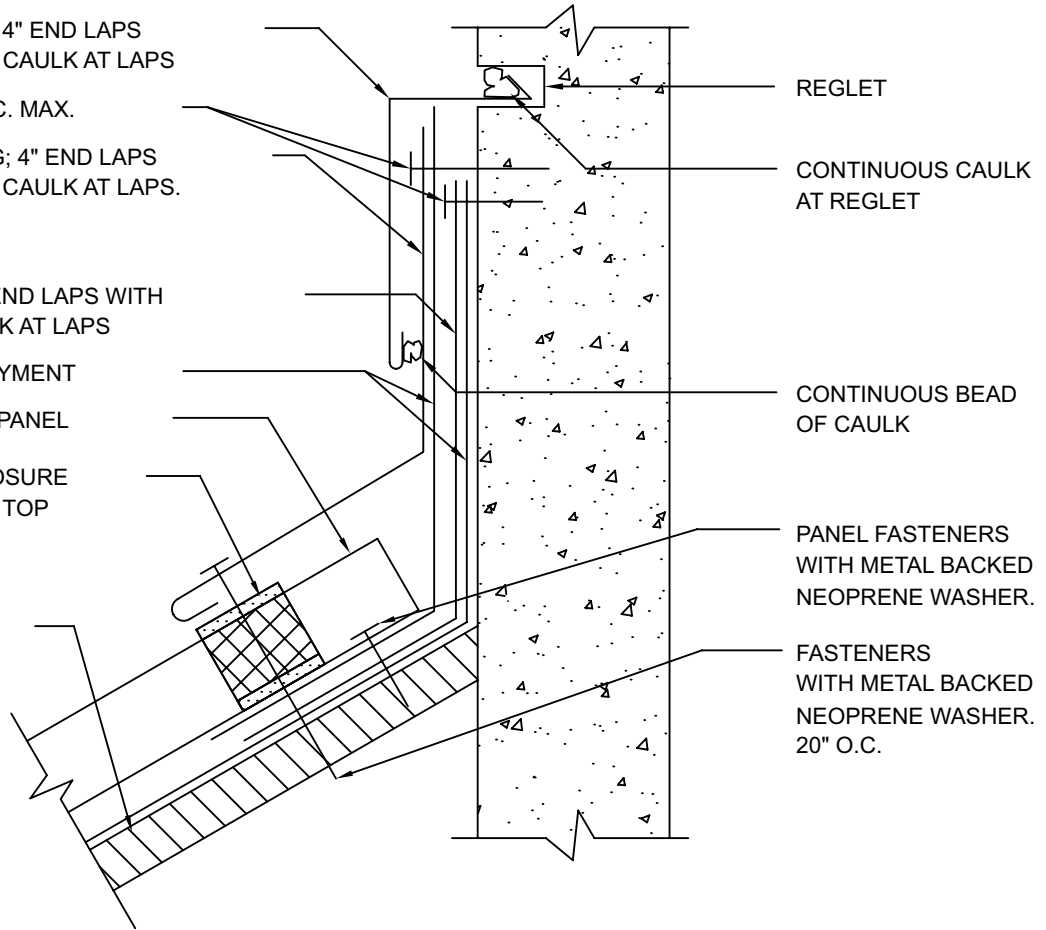

REGLET

CONTINUOUS CAULK
AT REGLET

CONTINUOUS BEAD
OF CAULK

PANEL FASTENERS
WITH METAL BACKED
NEOPRENE WASHER.

FASTENERS
WITH METAL BACKED
NEOPRENE WASHER.
20" O.C.

1. SOLID SHEATHING (BY OTHERS) TO BE MINIMUM 1/2" PLYWOOD OR EQUIVALENT IN STRENGTH FOR HOLDING POWER OF FASTENERS.

2. ALL FELT UNDERLAYMENT, CAULKING, AND FASTENERS, ARE ITEMS TO BE FURNISHED AND INSTALLED BY THE ROOFING INSTALLER AT THE DISCRETION OF THE ARCHITECT.

F = FINISH SIDE

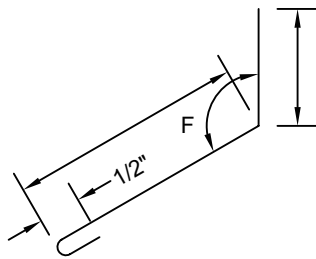

COUNTERFLASHING

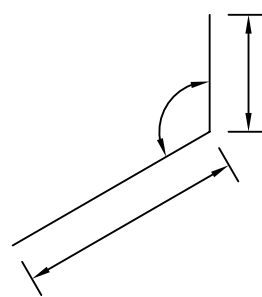

SUB-FLASHING

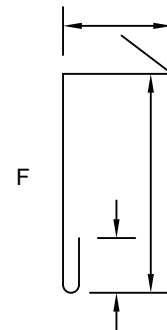

REGLET FLASHING



**BERRIDGE
MANUFACTURING
COMPANY**

Roofs of Distinction

HEAD WALL DETAIL

S-Deck System

DATE: 11-20-00

PAGE/FILE
SD-42

30 FELT UNDERLAYMENT

FASTENERS 20" O.C. MAX.

CONTINUOUS SUB FLASHING
4" END LAPS WITH
CONTINUOUS CAULK AT LAPS

RAKE CHANNEL 4" END LAPS
WITH CONTINUOUS CAULK
AT LAPS

1" EXPANDABLE FOAM CLOSURE
WITH TAPE SEALER TOP AND
BOTTOM.

TOP LAYER OF FELT TO BE
PARALLEL WITH ROOF SLOPE

SOLID SHEATHING

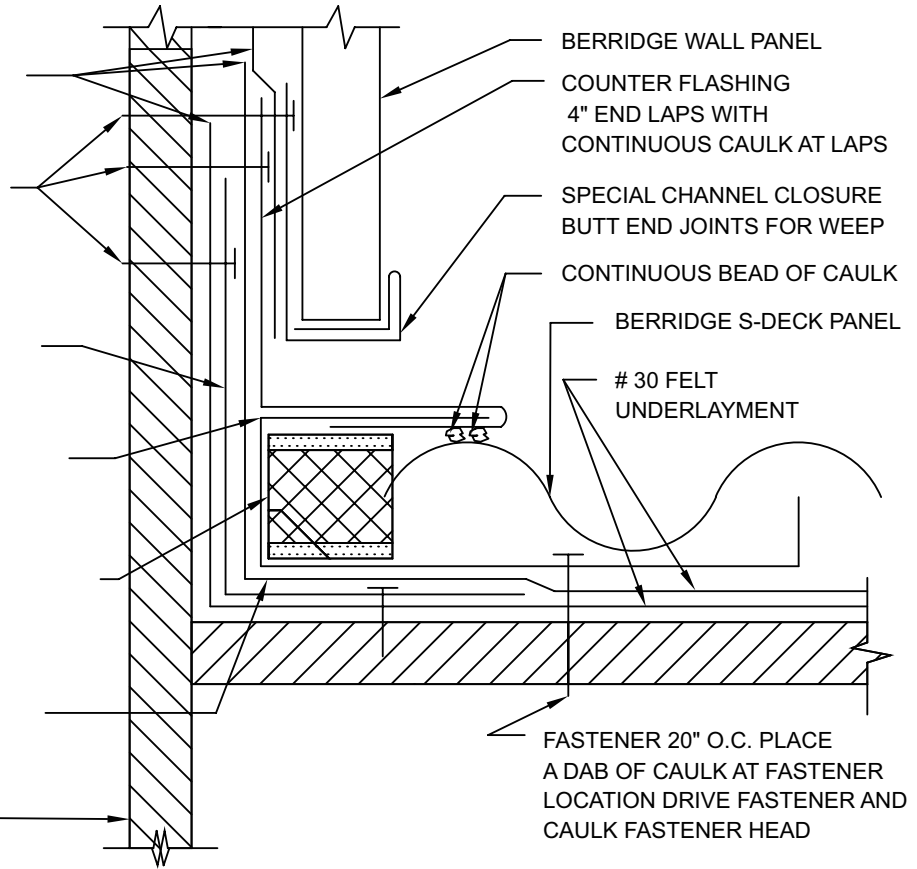

BERRIDGE WALL PANEL

COUNTER FLASHING
4" END LAPS WITH
CONTINUOUS CAULK AT LAPS

SPECIAL CHANNEL CLOSURE
BUTT END JOINTS FOR WEEP

CONTINUOUS BEAD OF CAULK

BERRIDGE S-DECK PANEL

30 FELT
UNDERLAYMENT

FASTENER 20" O.C. PLACE
A DAB OF CAULK AT FASTENER
LOCATION DRIVE FASTENER AND
CAULK FASTENER HEAD

1. SOLID SHEATHING (BY OTHERS) TO BE MINIMUM 1/2" PLYWOOD OR EQUIVALENT IN STRENGTH FOR HOLDING POWER OF FASTENERS.

2. ALL FELT UNDERLAYMENT, CAULKING, AND FASTENERS, ARE ITEMS TO BE FURNISHED AND INSTALLED BY THE ROOFING INSTALLER AT THE DISCRETION OF THE ARCHITECT.

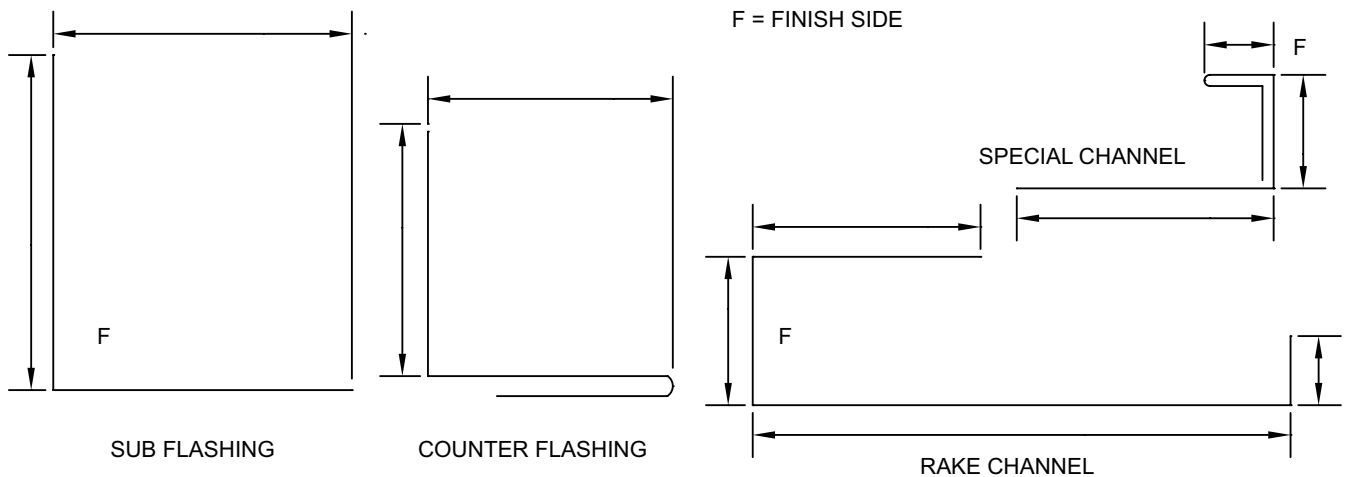

BERRIDGE
MANUFACTURING
COMPANY

**RAKE WALL
WITH WALL PANEL**

S-Deck System

DATE: 11-20-00

PAGE/FILE
SD-50

BERRIDGE S-DECK PANEL
 # 30 FELT UNDERLAYMENT
 FASTENERS 20" O.C. MAX
 PANEL FASTENER WITH METAL
 BACKED NEOPRENE WASHER
 AT 5 1/2" O.C.
 FASTENERS 20" O.C. MAX
 CONTINUOUS SUB FLASHING
 4" END LAPS WITH
 CONTINUOUS CAULK AT LAPS
 RAKE CHANNEL 4" END LAPS
 WITH CONTINUOUS CAULK
 AT LAPS
 1" EXPANDABLE FOAM CLOSURE
 WITH TAPE SEALER
 TOP AND
 BOTTOM.
 TOP LAYER OF FELT TO BE
 PARALLEL WITH ROOF SLOPE
 SOLID SHEATHING

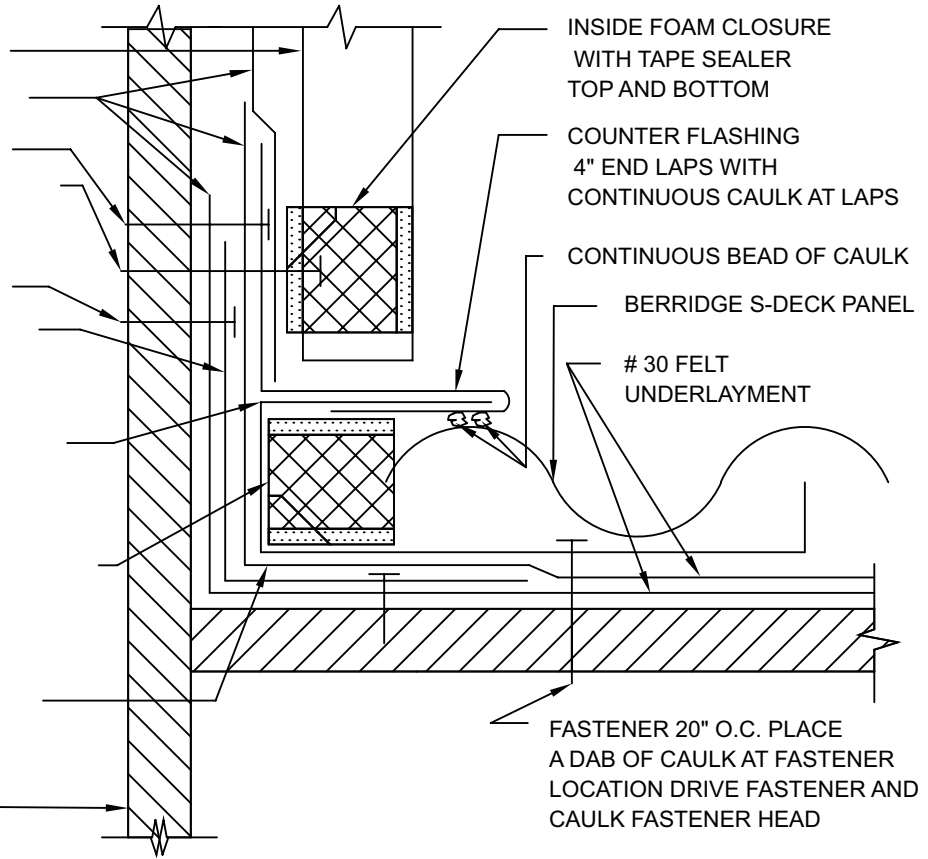

1. SOLID SHEATHING (BY OTHERS) TO BE MINIMUM 1/2" PLYWOOD OR EQUIVALENT IN STRENGTH FOR HOLDING POWER OF FASTENERS.
2. ALL FELT UNDERLAYMENT, CAULKING, AND FASTENERS, ARE ITEMS TO BE FURNISHED AND INSTALLED BY THE ROOFING INSTALLER AT THE DISCRETION OF THE ARCHITECT.

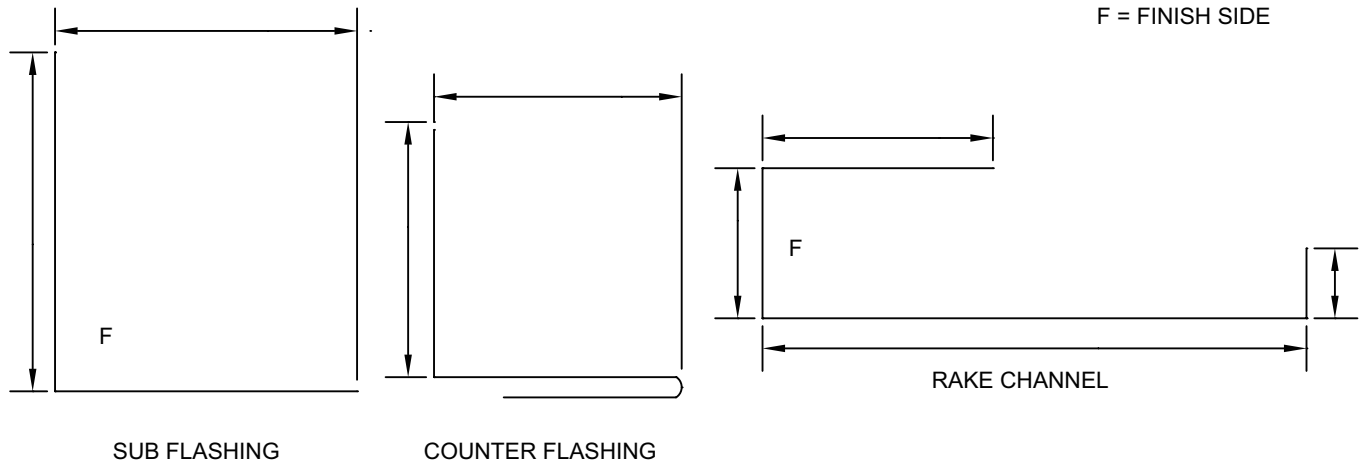

BERRIDGE
MANUFACTURING
COMPANY

RAKE WALL DETAIL

S-Deck System

DATE: 11-20-00

PAGE/FILE
 SD-51

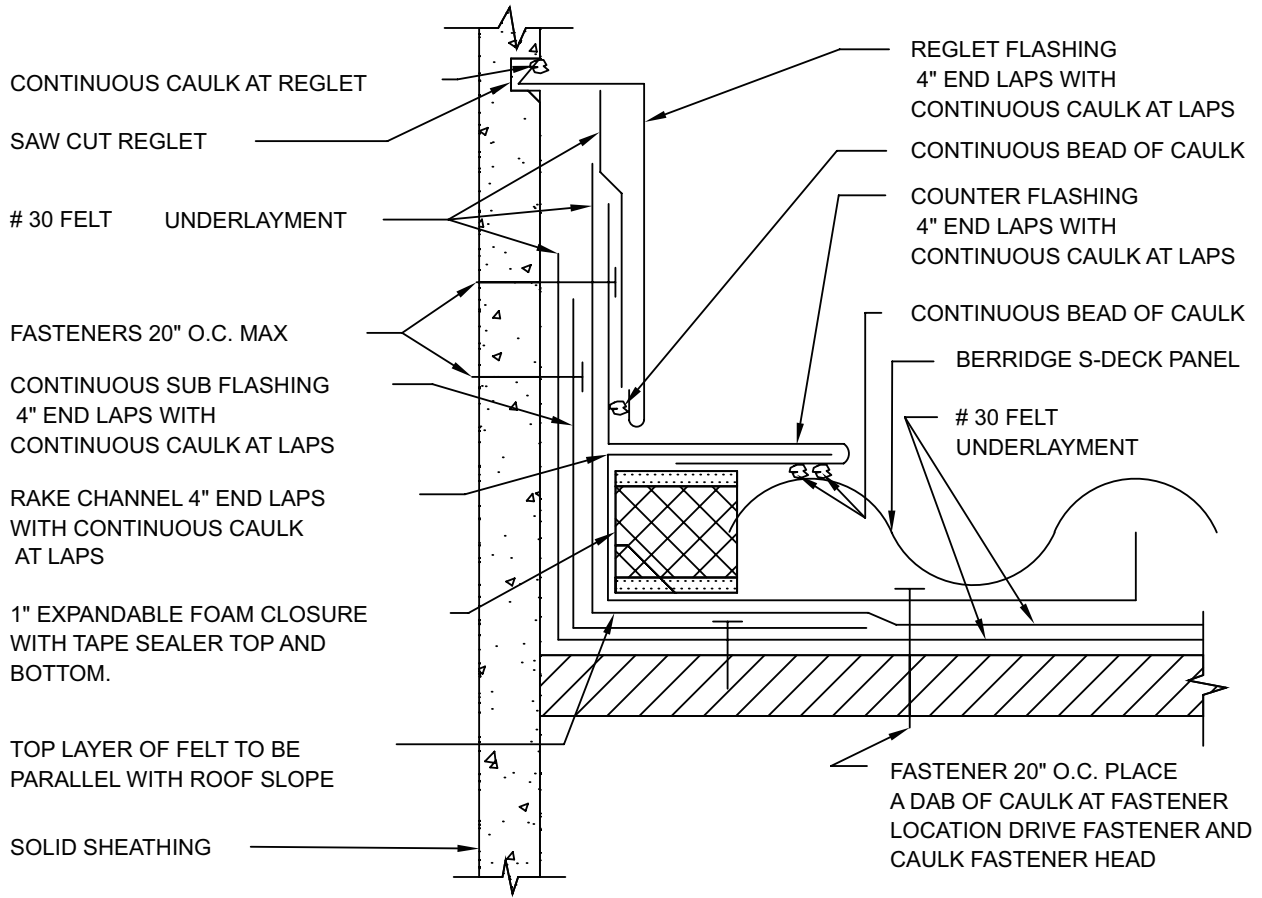

1. SOLID SHEATHING (BY OTHERS) TO BE MINIMUM 1/2" PLYWOOD OR EQUIVALENT IN STRENGTH FOR HOLDING POWER OF FASTENERS.
2. ALL FELT UNDERLAYMENT, CAULKING, AND FASTENERS, ARE ITEMS TO BE FURNISHED AND INSTALLED BY THE ROOFING INSTALLER AT THE DISCRETION OF THE ARCHITECT.

F = FINISH SIDE

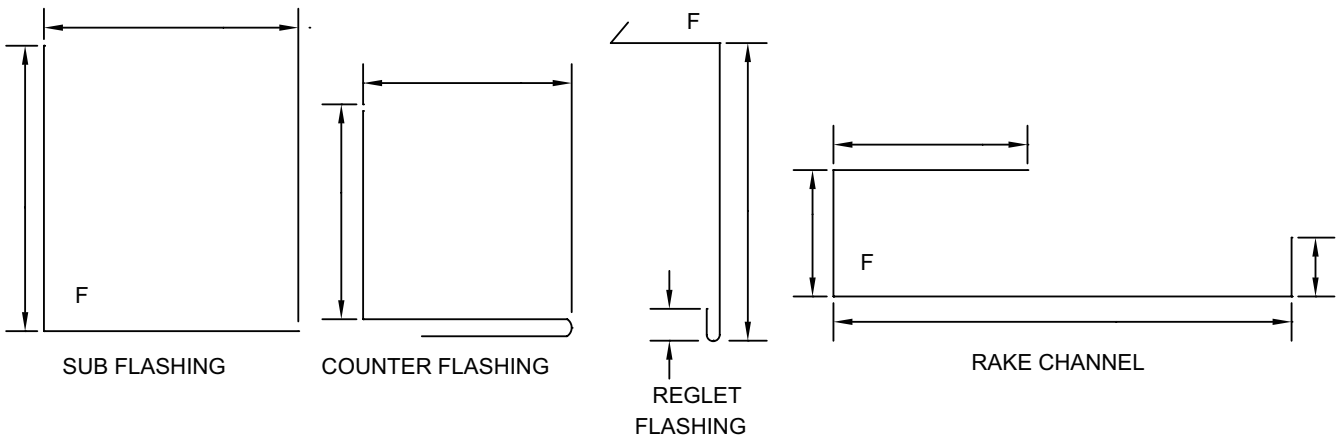

**BERRIDGE
MANUFACTURING
COMPANY**

Roofs of Distinction

RAKE WALL DETAIL WITH REGLET

S-Deck System

DATE: 11-20-00

PAGE/FILE
SD-52

CAP FLASHING 4" END LAPS WITH CONTINUOUS CAULK AT LAPS

30 FELT UNDERLAYMENT

CONTINUOUS CLEAT

CONTINUOUS SUB FLASHING 4" END LAPS WITH CONTINUOUS CAULK AT LAPS

1" EXPANDABLE FOAM CLOSURE WITH TAPE SEALER TOP AND BOTTOM.

TOP LAYER OF FELT TO BE PARALLEL WITH ROOF SLOPE

SOLID SHEATHING

1 ON 12

FASTENERS 20" O.C. MAX.

CONTINUOUS CLEAT

COUNTER FLASHING 4" END LAPS WITH CONTINUOUS CAULK AT LAPS

CONTINUOUS BEAD OF CAULK

BERRIDGE S-DECK PANEL

30 FELT UNDERLAYMENT

RAKE CHANNEL 4" END LAPS WITH CONTINUOUS CAULK AT LAPS

FASTENER 20" O.C. PLACE A DAB OF CAULK AT FASTENER LOCATION DRIVE FASTENER AND CAULK FASTENER HEAD

1. SOLID SHEATHING (BY OTHERS) TO BE MINIMUM 1/2" PLYWOOD OR EQUIVALENT IN STRENGTH FOR HOLDING POWER OF FASTENERS.

2. ALL FELT UNDERLAYMENT, CAULKING, AND FASTENERS, ARE ITEMS TO BE FURNISHED AND INSTALLED BY THE ROOFING INSTALLER AT THE DISCRETION OF THE ARCHITECT.

F = FINISH SIDE

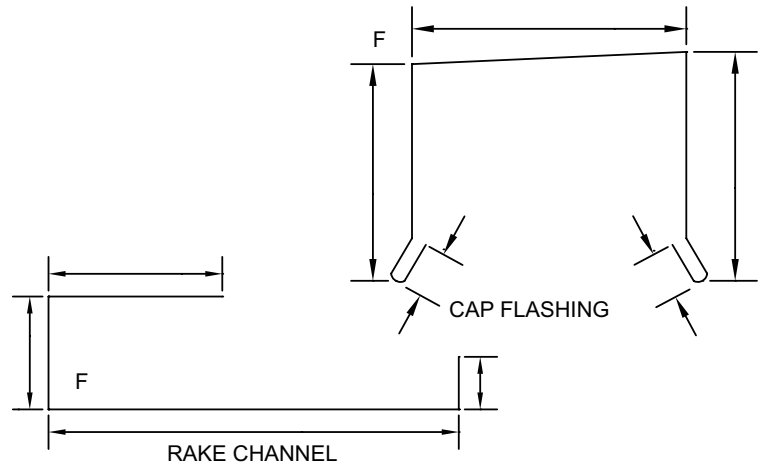
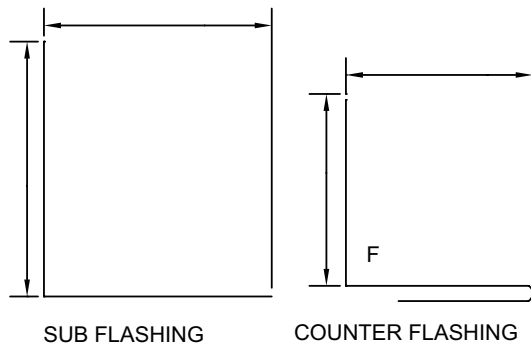

**BERRIDGE
MANUFACTURING
COMPANY**

Roofs of Distinction

**RAKE WALL
PARAPET WALL**

S-Deck System

DATE: 11-20-00

PAGE/FILE
SD-53

BERRIDGE S-DECK PANEL

PANEL FASTENER WITH METAL BACKED NEOPRENE WASHER AT 5 1/2" O.C.

FASTENERS 20" O.C. MAX

CONTINUOUS SUB FLASHING 4" END LAPS WITH CONTINUOUS CAULK AT LAPS

RAKE CHANNEL 4" END LAPS WITH CONTINUOUS CAULK AT LAPS

1" EXPANDABLE FOAM CLOSURE WITH TAPE SEALER TOP AND BOTTOM.

FASTENERS AT EVERY PURLIN

PURLIN

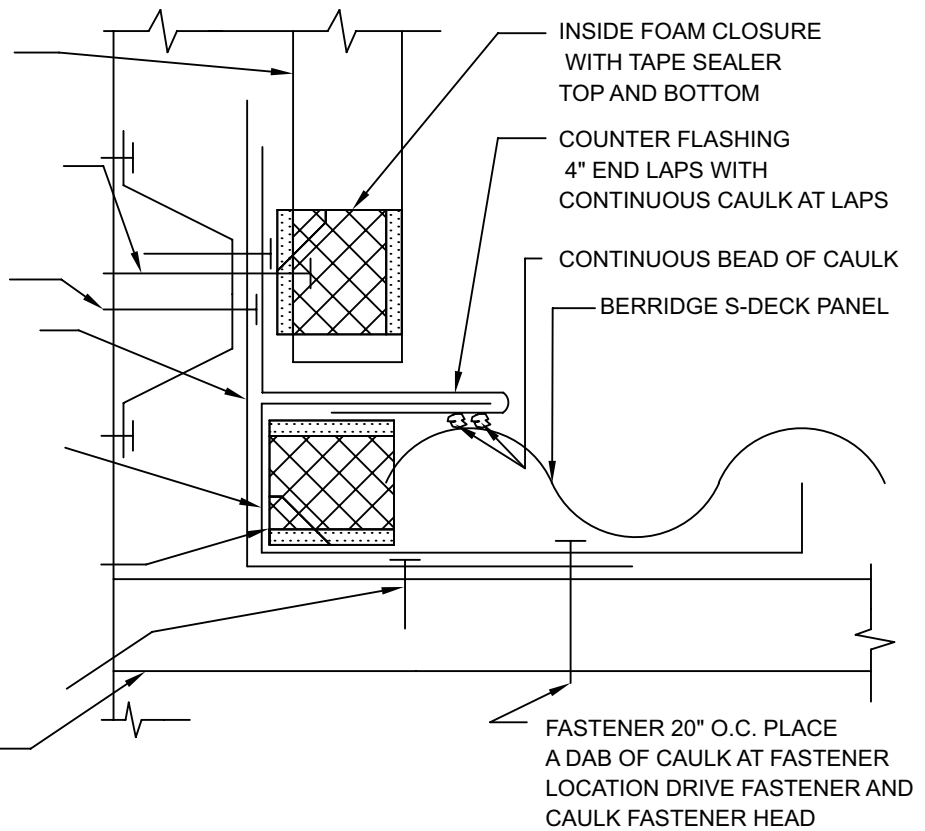

1. ALL CAULKING, AND FASTENERS, ARE ITEMS TO BE FURNISHED AND INSTALLED BY THE ROOFING INSTALLER AT THE DISCRETION OF THE ARCHITECT.

F = FINISH SIDE

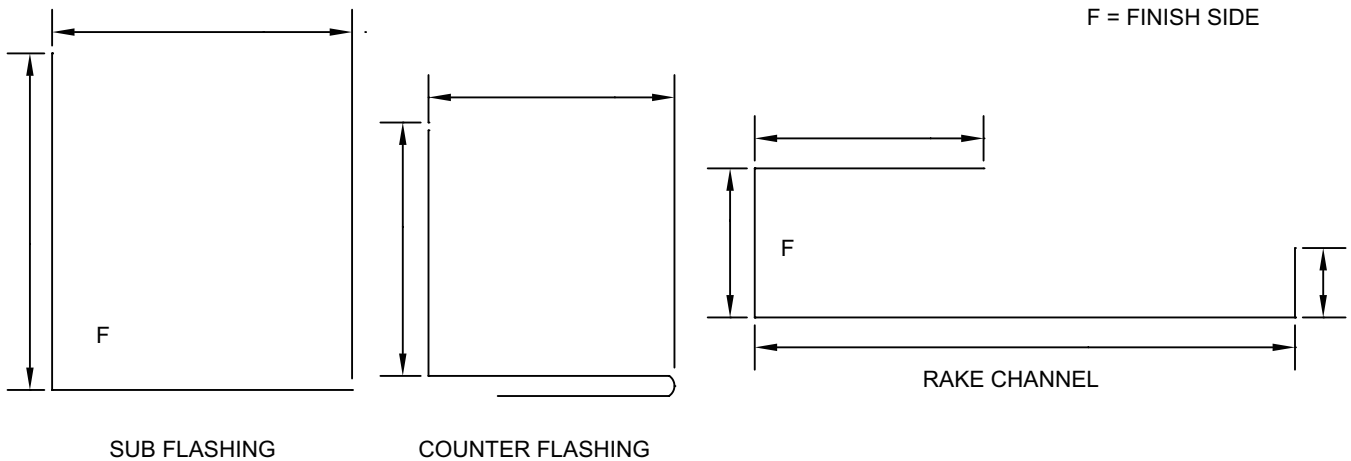

**BERRIDGE
MANUFACTURING
COMPANY**

Roofs of Distinction

RAKE WALL DETAIL OPEN FRAMING

S-Deck System

DATE: 11-20-00

PAGE/FILE
SD-54

FASTENERS 20" O.C. MAX.

RAKE FLASHING; BACK CUT VERTICAL LEG AND FORM TO RADIUS OF ROOF. 4" END LAPS WITH CONTINUOUS CAULK AT LAPS

1" EXPANDABLE FOAM CLOSURE WITH TAPE SEALER TOP AND BOTTOM

SUB FLASHING; BACK CUT VERTICAL LEG AND FORM TO RADIUS OF ROOF. 4" END LAPS WITH CONTINUOUS CAULK AT LAPS

SOLID SHEATHING

FASTENERS 20" O.C. MAX

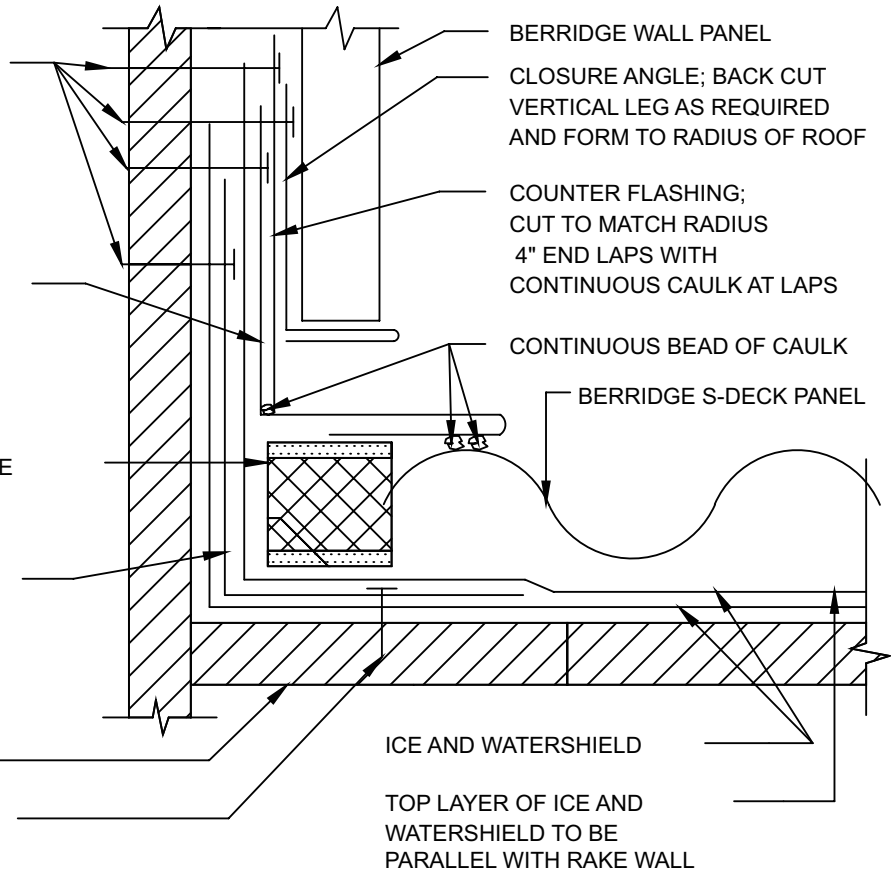

1. SOLID SHEATHING (BY OTHERS) TO BE MINIMUM 1/2" PLYWOOD OR EQUIVALENT IN STRENGTH FOR HOLDING POWER OF FASTENERS.
2. ALL ICE AND WATERSHIELD UNDERLAYMENT, CAULKING, AND FASTENERS, ARE ITEMS TO BE FURNISHED AND INSTALLED BY THE ROOFING INSTALLER AT THE DISCRETION OF THE ARCHITECT.
3. UNDERLAYMENT TO BE ICE AND WATERSHIELD FOR CURVED PANELS.

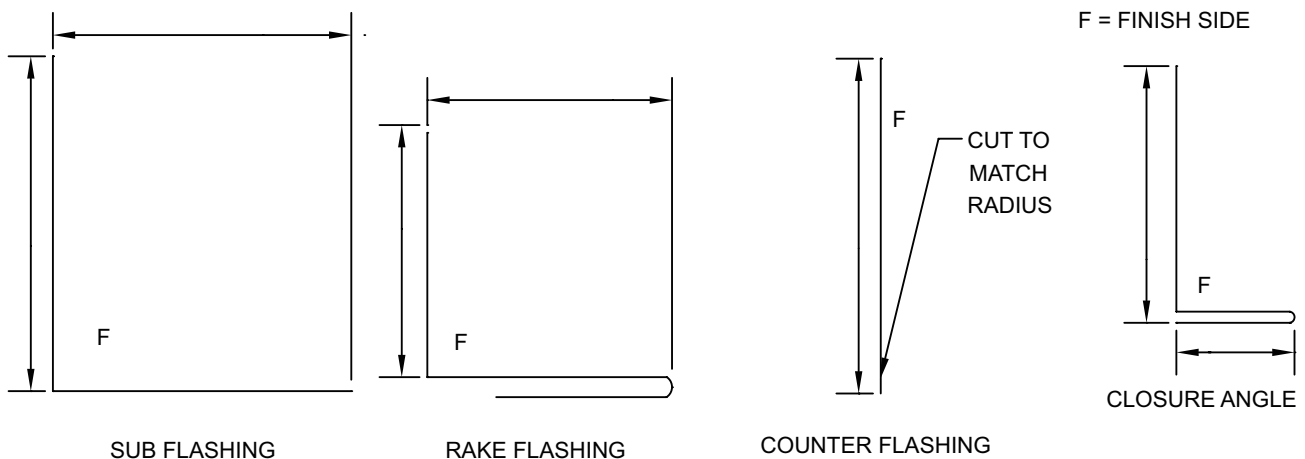

BERRIDGE
MANUFACTURING
COMPANY

RAKE WALL
CURVED PANELS

S-Deck System

DATE: 11-20-00

PAGE/FILE
 SD-55

BERRIDGE S-DECK PANEL
UPPER PANEL

PANEL FASTENERS; WITH METAL
BACKED NEOPRENE WASHER
AT 5 1/2" O.C.

INSIDE FOAM CLOSURE WITH
TAPE SEALER TOP AND BOTTOM

1 ON 12 MIN. SLOPE
AWAY FROM UPER PANEL

TRANSITION FLASHING; 4"
END LAPS WITH CONTINUOUS
CAULK AT LAPS

BERRIDGE S-DECK
LOWER PANEL

SOLID SHEATHING

FASTENERS; WITH METAL
BACKED NEOPRENE WASHER. 20" O.C.

30 FELT
UNDERLAYMENT

SOLID SHEATHING

FASTENER 20" O.C.
PLACE A DAB OF CAULK AT
FASTENER LOCATION, DRIVE
FASTENER THROUGH CAULK
AND CAULK FASTENER HEADS.

SUB-FLASHING; 4" END
LAPS WITH CONTINUOUS
CAULK AT LAPS

FASTENERS; 40" O.C.

PANEL FASTENERS; WITH METAL
BACKED NEOPRENE WASHER

OUTSIDE FOAM CLOSURE WITH
TAPE SEALER TOP AND BOTTOM

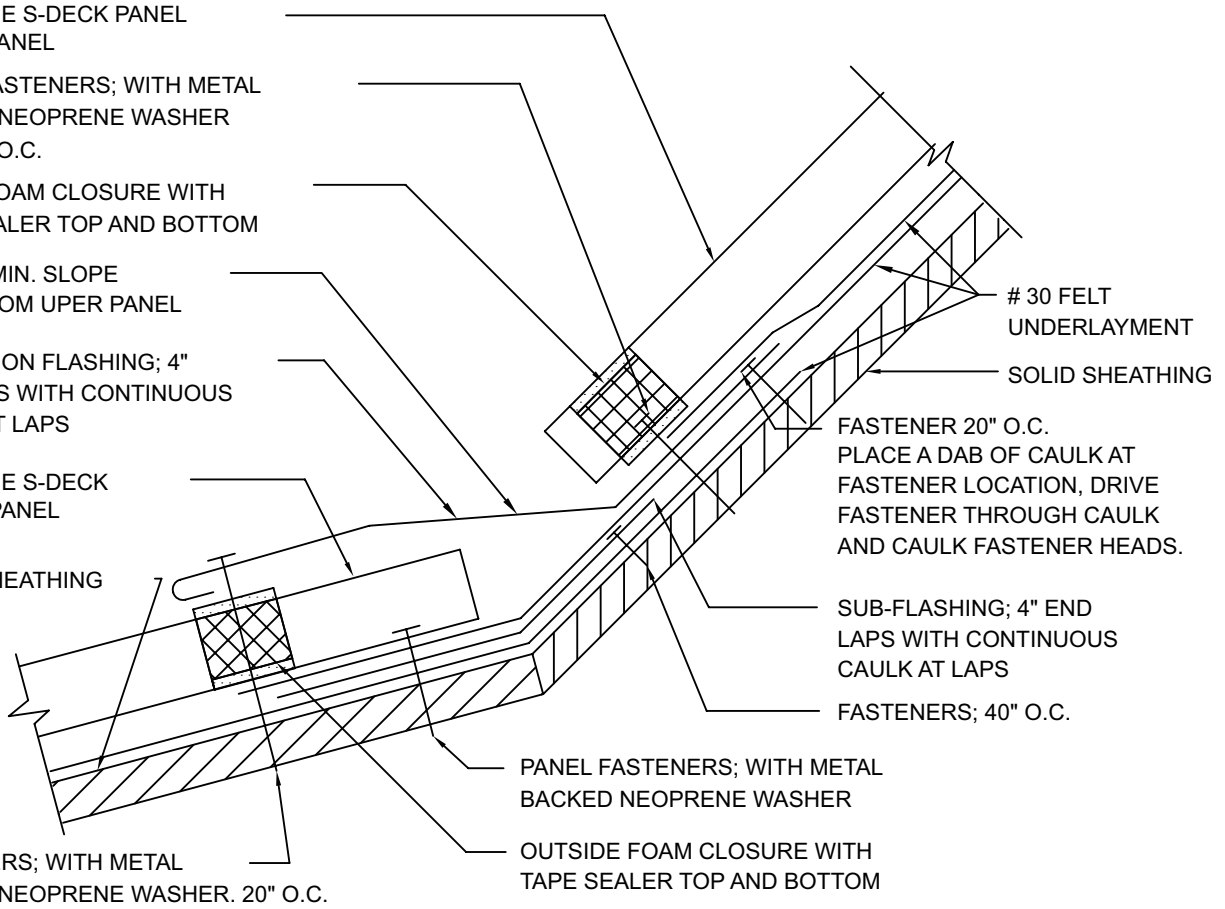

1. SOLID SHEATHING (BY OTHERS) TO BE MINIMUM 1/2" PLYWOOD OR EQUIVALENT IN STRENGTH FOR HOLDING POWER OF FASTENERS.

2. ALL FELT UNDERLAYMENT, CAULKING, AND FASTENERS, ARE ITEMS TO BE FURNISHED AND INSTALLED BY THE ROOFING INSTALLER AT THE DISCRETION OF THE ARCHITECT.

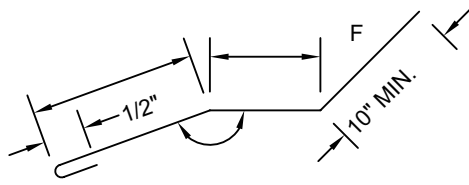

TRANSITION FLASHING

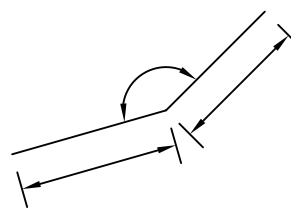

SUB-FLASHING

F = FINISH SIDE



**BERRIDGE
MANUFACTURING
COMPANY**

SLOPE TRANSITION DETAIL

S-Deck System

DATE: 11-20-00

PAGE/FILE
SD-60

BERRIDGE S-DECK PANEL

CONTINUOUS BEAD OF CAULK
BETWEEN VALLEY FLASHING
AND FELT UNDERLAYMENT

1" EXPANDABLE FOAM
CLOSURE WITH TAPE
SEALER TOP AND BOTTOM

FASTENERS 20" O.C. MAX.

30 FELT
UNDERLAYMENT

VALLEY FLASHING
12" END LAPS WITH (2)
CONTINUOUS BEADS CAULK
AT LAPS

SOLID SHEATHING

PANEL FASTENER WITH
METAL BACKED NEOPRENE
WASHER AT 5 1/2" O.C.

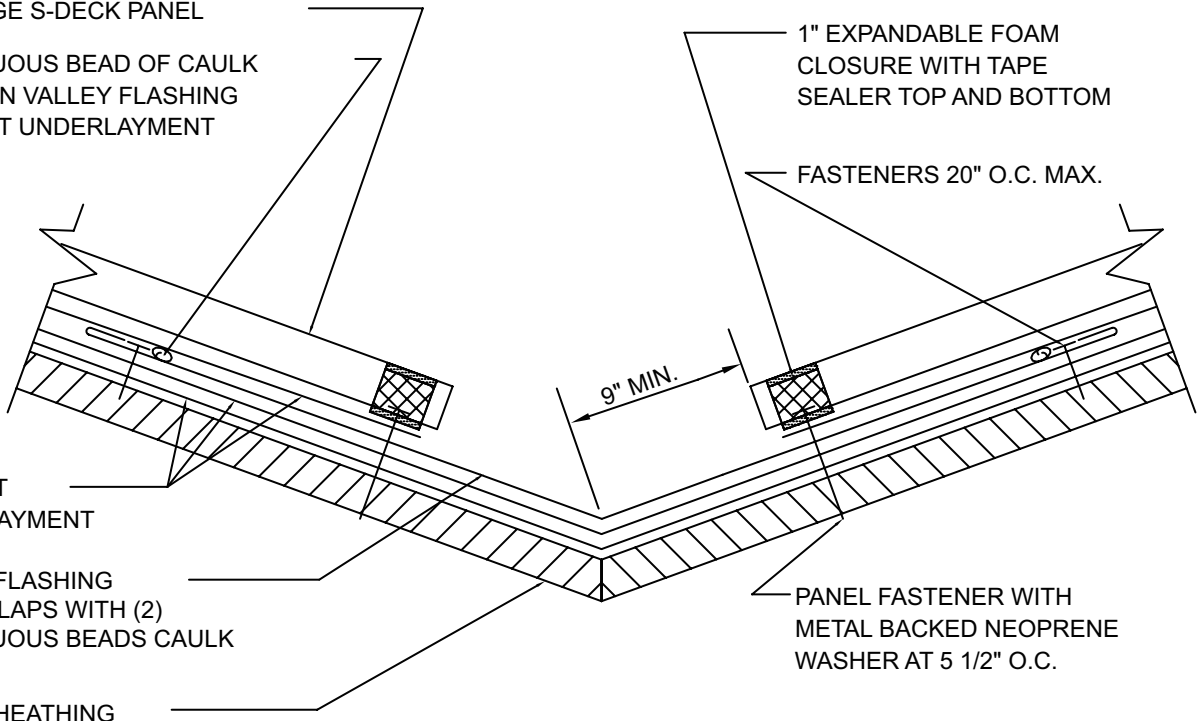

1. SOLID SHEATHING (BY OTHERS) TO BE A MINIMUM OF 1/2" PLYWOOD OR EQUIVALENT IN STRENGTH FOR HOLDING POWER OF FASTENERS.
2. ALL FELT UNDERLAYMENT, CAULKING, AND FASTENERS, ARE ITEMS TO BE FURNISHED AND INSTALLED BY THE ROOFING INSTALLER AT THE DISCRETION OF THE ARCHITECT.

F = FINISH SIDE

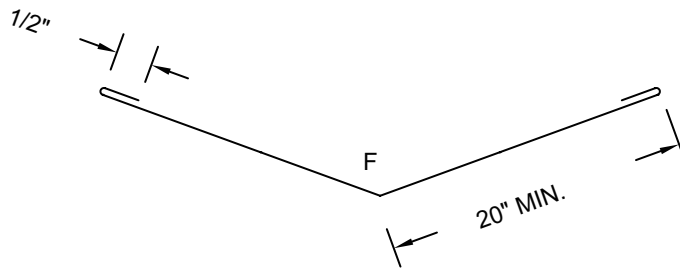

VALLEY FLASHING



BERRIDGE
MANUFACTURING
COMPANY

VALLEY DETAIL

S-Deck System

DATE: 11-20-00

PAGE/FILE
SD-70

BERRIDGE S-DECK PANEL

CONTINUOUS BEAD OF CAULK BETWEEN VALLEY FLASHING AND FELT UNDERLAYMENT

1" EXPANDABLE FOAM CLOSURE WITH TAPE SEALER TOP AND BOTTOM

FASTENERS 20" O.C. MAX.

GRACE ICE AND WATERSHIELD

VALLEY FLASHING 12" END LAPS WITH (2) CONTINUOUS BEADS CAULK AT LAPS

FLAT SHEET VALLEY SUB-FLASHING

BERRIDGE CORRUGATED S-DECK

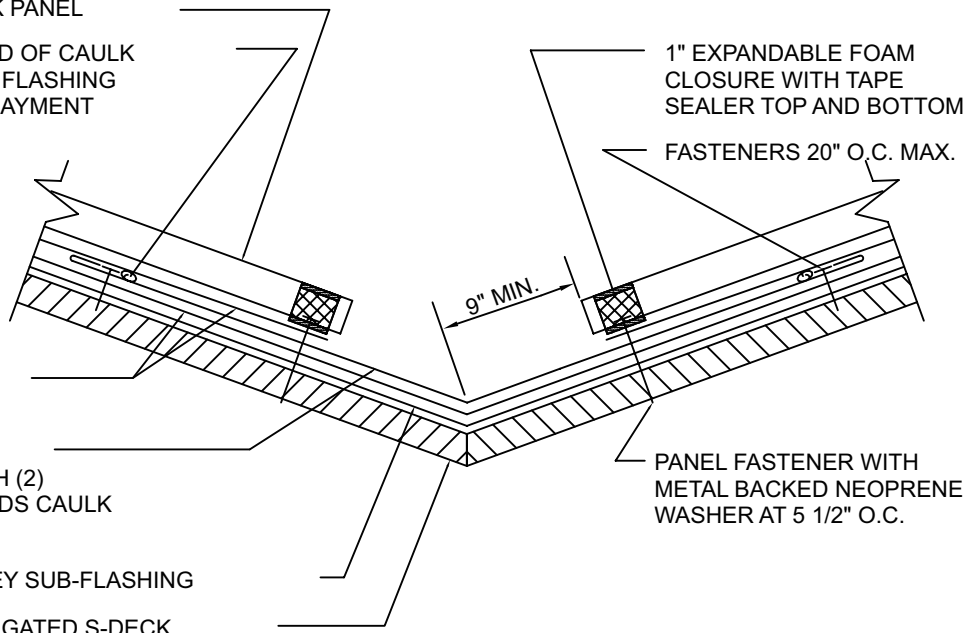

GRACE ICE AND WATER SHIELD RUN RIDGE TO EAVE

FLAT SHEET VALLEY SUB-FLASHING RUN RIDGE TO EAVE

BERRIDGE CORRUGATED S-DECK

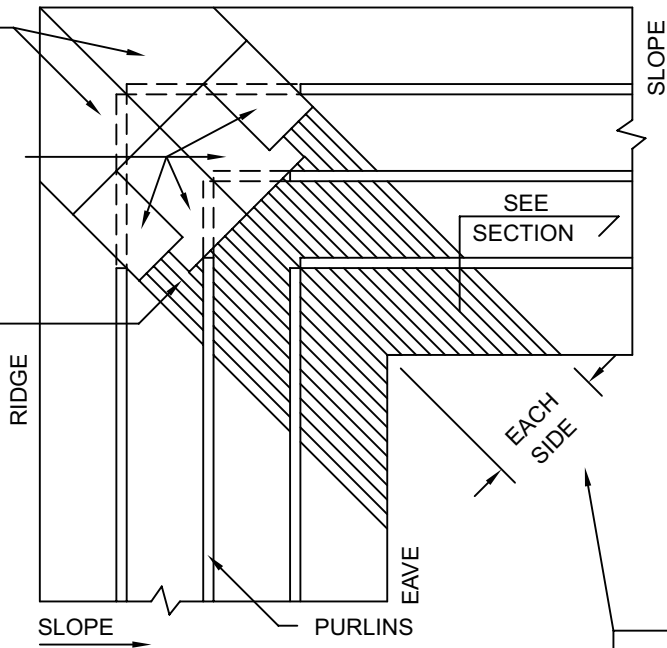

FLAT SHEET VALLEY SUB-FLASHING

GRACE ICE AND WATER SHIELD

16 GA. HAT SECTION

PURLIN

BERRIDGE CORRUGATED S-DECK SECTION

ROOFS WITH A SLOPE OF 4:12 OR LESS 6'-0" MIN.
ROOFS ABOVE 4:12 3'-0" MIN.

16 GA. HAT SECTION SIZED TO FIT OVER PURLIN AND TO ACCOMMODATE THE DEPTH OF THE BERRIDGE CORRUGATED S-DECK.

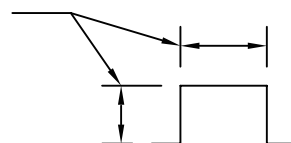

BERRIDGE
MANUFACTURING
COMPANY

VALLEY DETAIL OPEN FRAMING

S-Deck System

DATE: 11-20-00

PAGE/FILE
SD-71

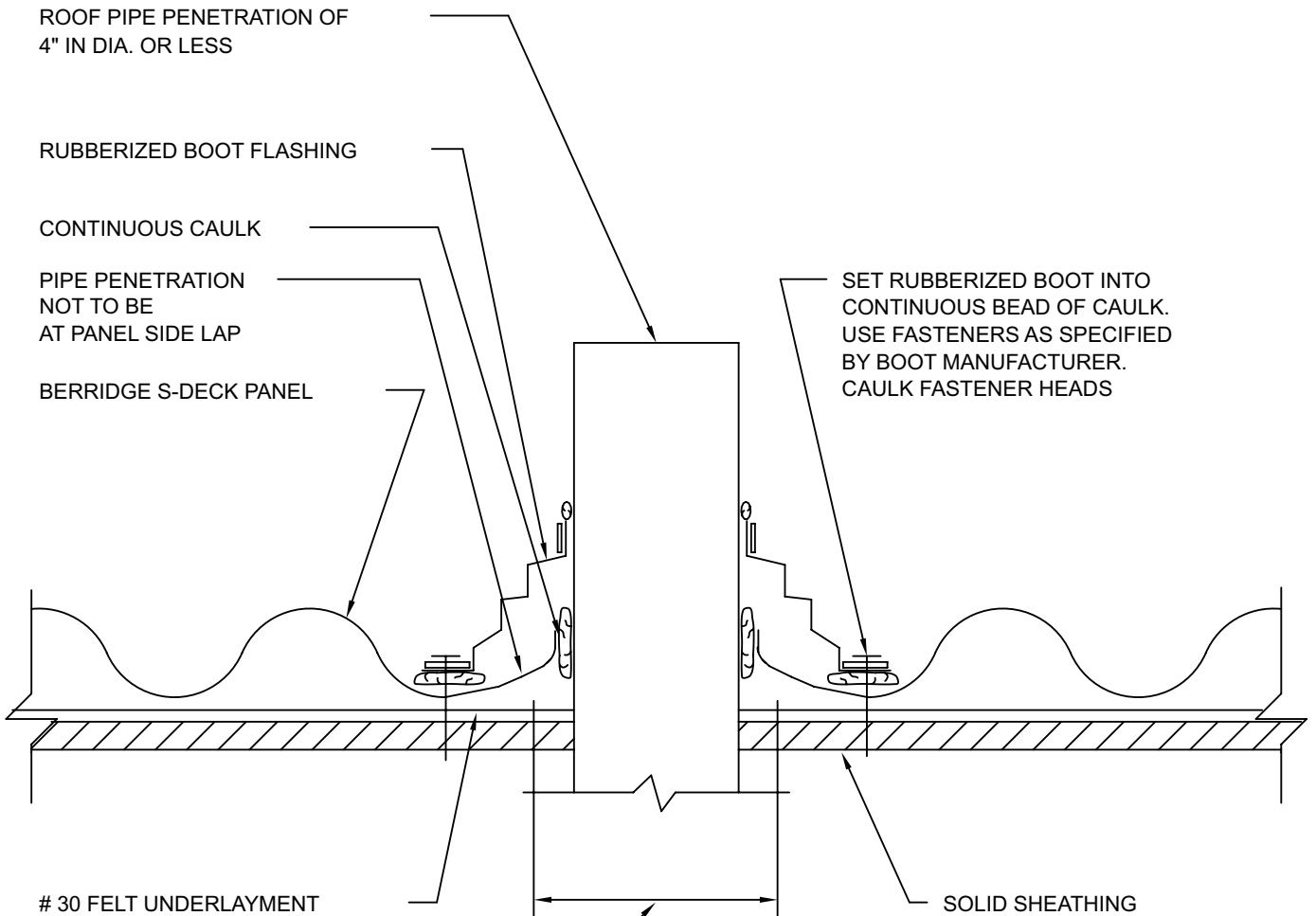

ROOF PIPE PENETRATION OF
4" IN DIA. OR LESS

RUBBERIZED BOOT FLASHING

CONTINUOUS CAULK

PIPE PENETRATION
NOT TO BE
AT PANEL SIDE LAP

BERRIDGE S-DECK PANEL

SET RUBBERIZED BOOT INTO
CONTINUOUS BEAD OF CAULK.
USE FASTENERS AS SPECIFIED
BY BOOT MANUFACTURER.
CAULK FASTENER HEADS

30 FELT UNDERLAYMENT

SOLID SHEATHING

CUT PANEL 1" SMALLER THAN
PENETRATION, BACK CUT TABS,
FOLD TABS UP AROUND
PENETRATION, AND CAULK.

NOTE: IF PIPE IS MADE OF METAL,
IT MUST BE PAINTED TO PREVENT RUST
RUN-OFF FROM STAINING PANELS.

NOTE: POSITION SQUARE BASED BOOTS IN A DIAMOND
ORIENTATION WHERE POSSIBLE TO AID IN DIVERTING WATER.



**BERRIDGE
MANUFACTURING
COMPANY**

Roofs of Distinction

PIPE PENETRATION (PREFERRED METHOD)
IN PAN OF PANEL ONLY
4" DIA. OR LESS

DATE: 11-20-00

S-Deck System

PAGE/FILE
SD-80

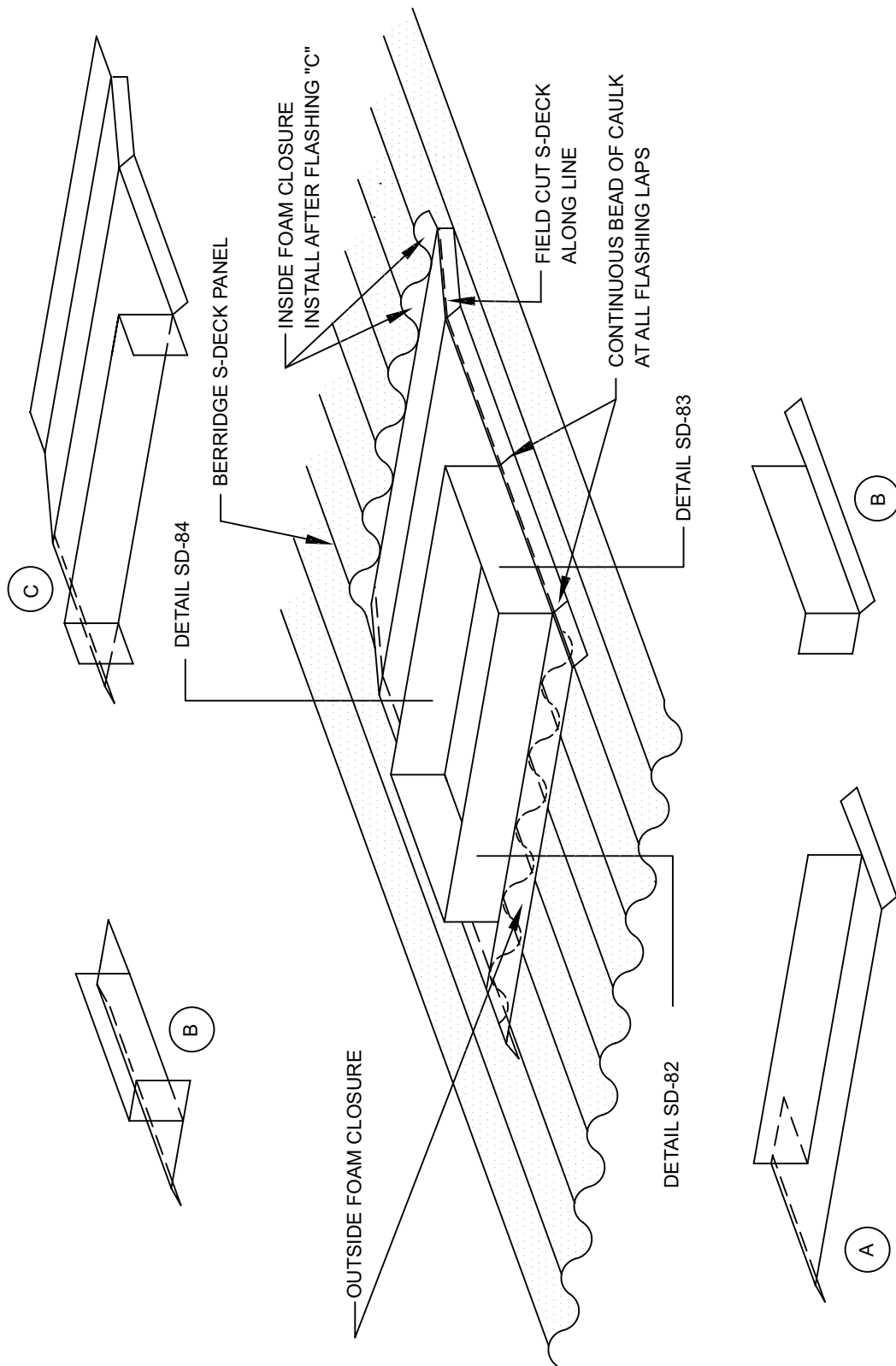

FIELD CUT PANEL ALONG DOTTED LINE AND INSTALL PANEL. INSTALL FLASHING "A" FIRST ALONG WITH FOAM CLOSURE. INSTALL FLASHING "B" SECOND. CAULK ALL FLASHING LAPS. INSTALL FLASHING "C" LAST. THIS FLASHING IS TO BE SLIPPED UNDER THE S-DECK PANEL AND FELT AS SHOWN IN DETAIL SD-84 BEFORE THE FOAM CLOSURE OR FASTENERS ARE INSTALLED. SEE ALSO DETAILS SD-82 AND SD-83 FOR FELTING AND SUBFLASHING.



**BERRIDGE
MANUFACTURING
COMPANY**

Roofs of Distinction

ROOF PENETRATION

S-Deck System

DATE: 11-20-00

PAGE/FILE
SD-81

FASTENERS; 20" O.C. MAX.

COUNTERFLASHING; 4" END LAPS WITH CONTINUOUS CAULK AT LAPS

PANEL FASTENERS WITH METAL BACKED NEOPRENE WASHER.

OUTSIDE FOAM CLOSURE WITH TAPE SEALER TOP AND BOTTOM

BERRIDGE S-DECK PANEL

SOLID SHEATHING

FLASHING FROM MECHANICAL EQUIPMENT BY OTHERS

CONTINUOUS ANGLE FLASHING TYPICAL ALL 4 SIDES OF PENETRATION

30 FELT UNDERLAYMENT

TOP LAYER OF # 30 FELT UNDERLAYMENT TO BE PERPENDICULAR TO ROOF SLOPE

FASTENERS WITH METAL BACKED NEOPRENE WASHER. 20" O.C. MAX.

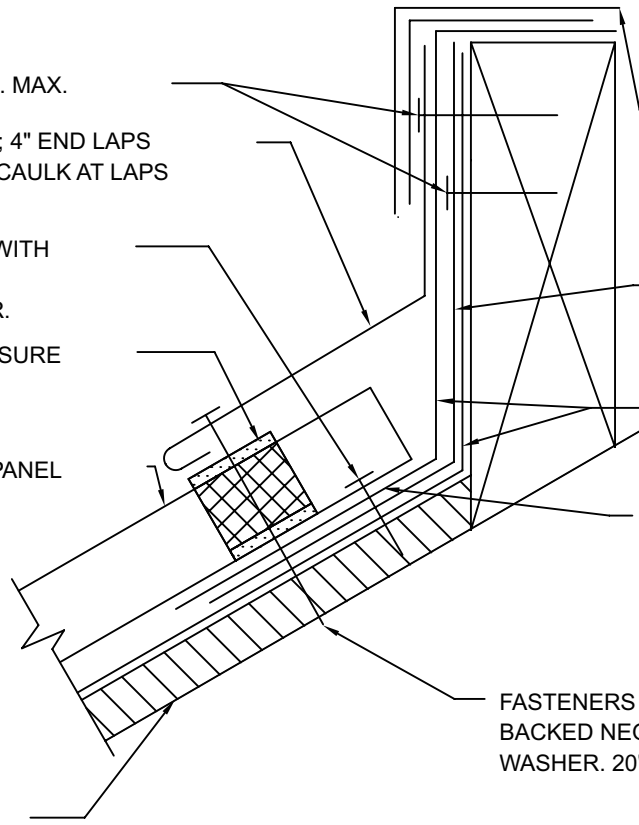

1. SOLID SHEATHING (BY OTHERS) TO BE MINIMUM 1/2" PLYWOOD OR EQUIVALENT IN STRENGTH FOR HOLDING POWER OF FASTENERS.

2. ALL FELT UNDERLAYMENT, CAULKING, AND FASTENERS, ARE ITEMS TO BE FURNISHED AND INSTALLED BY THE ROOFING INSTALLER AT THE DISCRETION OF THE ARCHITECT.

F = FINISH SIDE

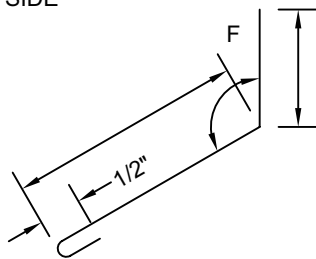

COUNTER FLASHING
SIDE A

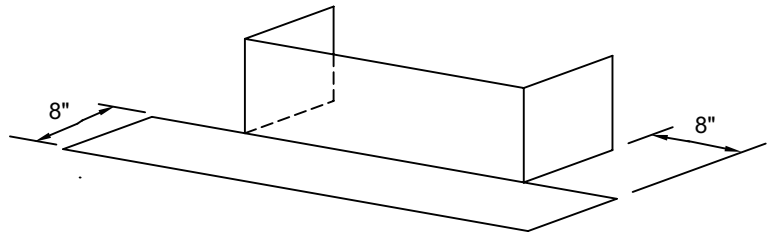

ANGLE FLASHING



**BERRIDGE
MANUFACTURING
COMPANY**

Roofs of Distinction

ROOF PENETRATION SIDE A

S-Deck System

DATE: 11-20-00

PAGE/FILE
SD-82

FLASHING FROM MECHANICAL EQUIPMENT BY OTHERS

FASTENERS; 20" O.C. TYP.

30 FELT UNDERLAYMENT

CONTINUOUS ANGLE TYPICAL ALL 4 SIDES OF PENETRATION

1" EXPANDABLE FOAM CLOSURE WITH TAPE SEALER TOP AND BOTTOM

TOP LAYER OF FELT TO BE PARALLEL WITH ROOF SLOPE

SOLID SHEATHING

RAKE CHANNEL 4" END LAPS WITH CONTINUOUS CAULK AT LAPS

30 FELT UNDERLAYMENT

COUNTER FLASHING 4" END LAPS WITH CONTINUOUS CAULK AT LAPS

CONTINUOUS BEAD OF CAULK

BERRIDGE S-DECK PANEL

30 FELT UNDERLAYMENT

FASTENER 20" O.C. PLACE A DAB OF CAULK AT FASTENER LOCATION DRIVE FASTENER AND CAULK FASTENER HEAD

1. SOLID SHEATHING (BY OTHERS) TO BE MINIMUM 1/2" PLYWOOD OR EQUIVALENT IN STRENGTH FOR HOLDING POWER OF FASTENERS.

2. ALL FELT UNDERLAYMENT, CAULKING, AND FASTENERS, ARE ITEMS TO BE FURNISHED AND INSTALLED BY THE ROOFING INSTALLER AT THE DISCRETION OF THE ARCHITECT.

F = FINISH SIDE

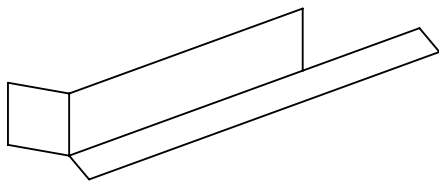

ANGLE FLASHING SIDE B

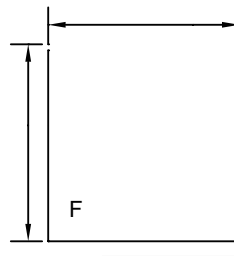

COUNTER FLASHING

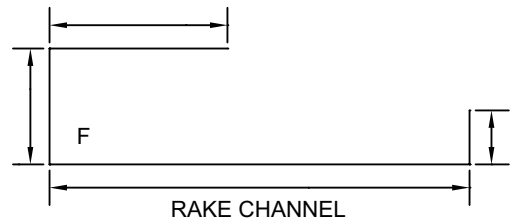

RAKE CHANNEL



BERRIDGE MANUFACTURING COMPANY

Roofs of Distinction

ROOF PENETRATION SIDE B

S-Deck System

DATE: 11-20-00

PAGE/FILE
SD-83

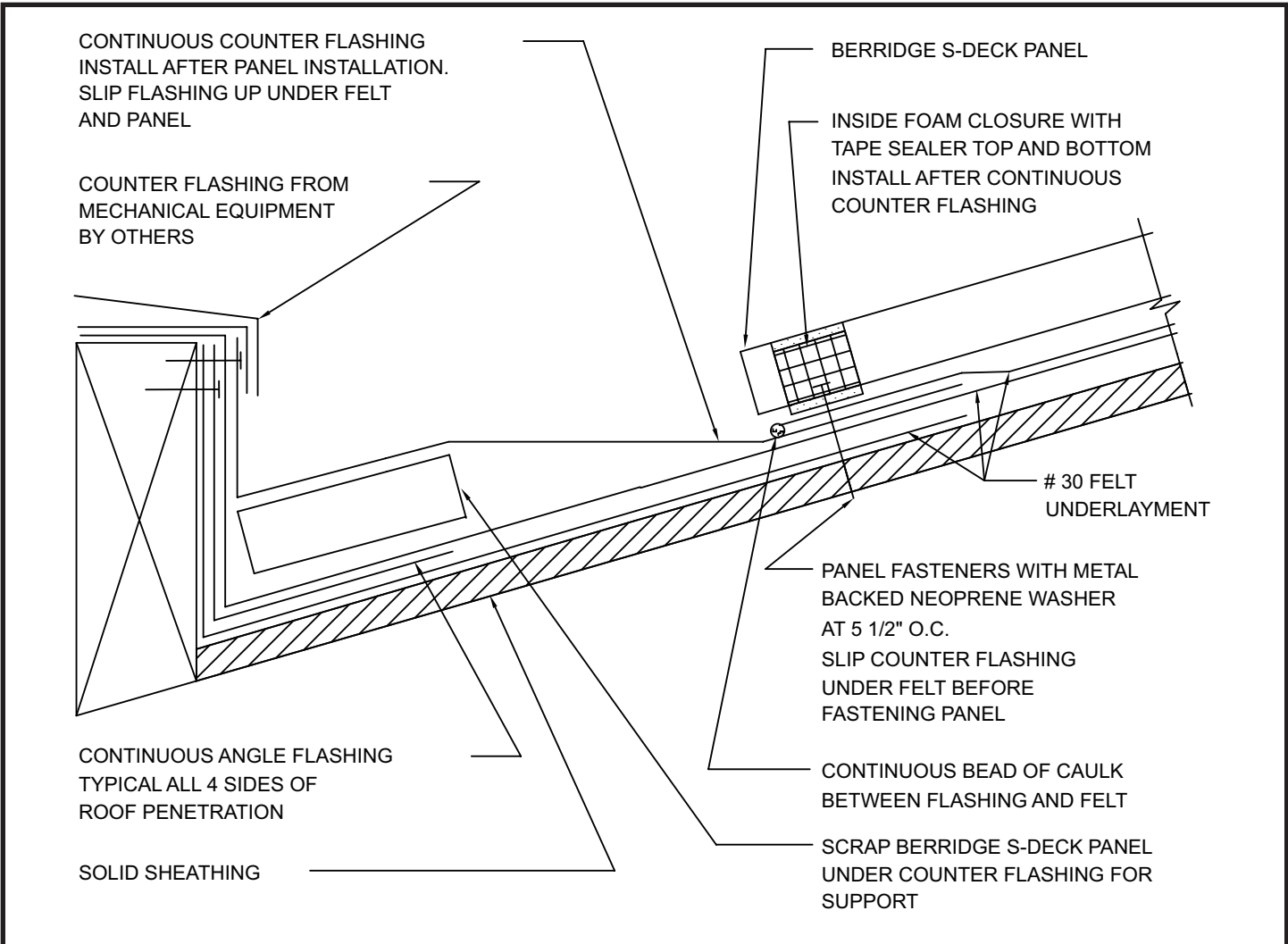

1. SOLID SHEATHING (BY OTHERS) TO BE MINIMUM 1/2" PLYWOOD OR EQUIVALENT IN STRENGTH FOR HOLDING POWER OF FASTENERS.
2. ALL FELT UNDERLAYMENT, CAULKING, AND FASTENERS, ARE ITEMS TO BE FURNISHED AND INSTALLED BY THE ROOFING INSTALLER AT THE DISCRETION OF THE ARCHITECT.

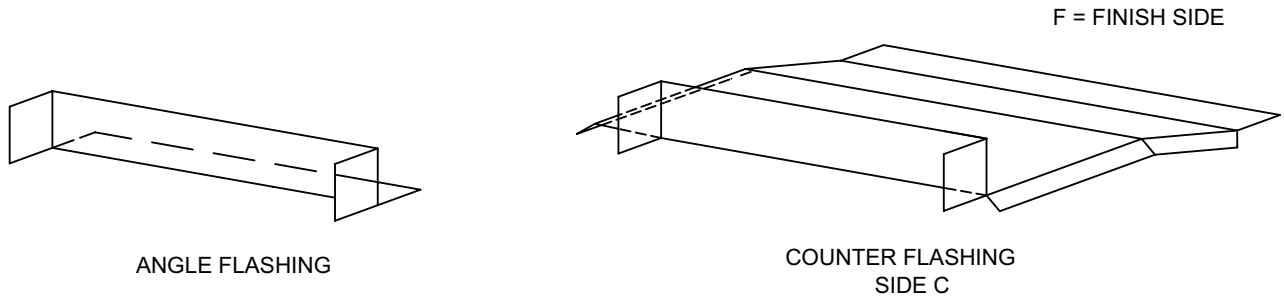

**BERRIDGE
MANUFACTURING
COMPANY**

Roofs of Distinction

**ROOF PENETRATION
SIDE C**

S-Deck System

DATE: 11-20-00

PAGE/FILE
SD-84

FOR ROOF PENETRATIONS LARGER THAN 4" IN DIA.

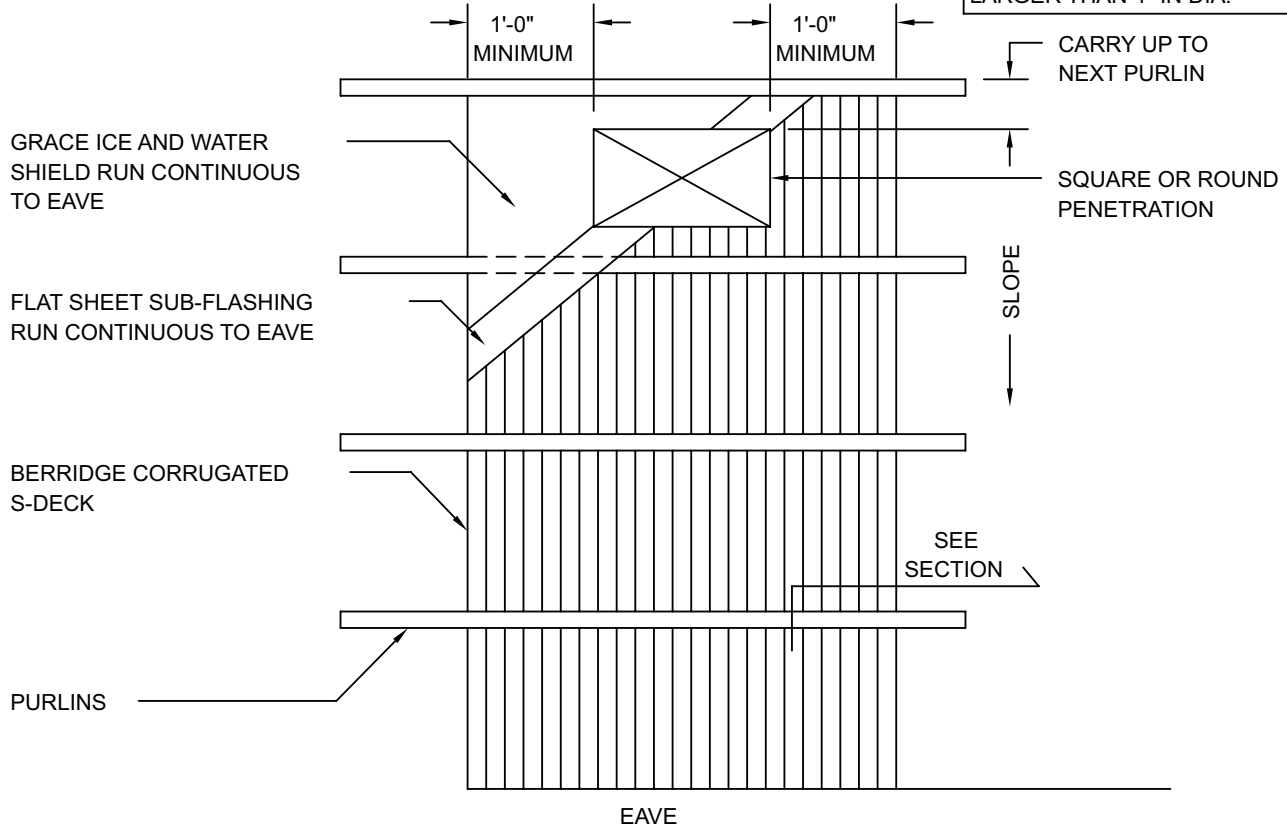

16 GA. HAT SECTION SIZE TO FIT OVER PURLIN AND TO ACCOMMODATE THE DEPTH OF THE BERRIDGE CORRUGATED S-DECK.

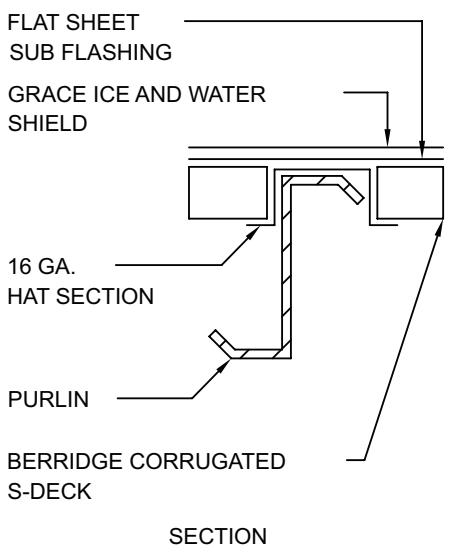
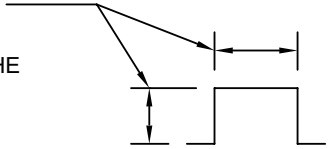

**BERRIDGE
MANUFACTURING
COMPANY**

PENETRATION
LARGER THAN 4"
OPEN FRAMING

S-Deck System

DATE: 11-20-00

PAGE/FILE
SD-85

BERRIDGE S-DECK PANEL
 CONTINUOUS BEADS OF CAULK
 INSIDE CORNER FLASHING; 4" END LAPS WITH CONTINUOUS CAULK AT LAPS
 POP RIVET 20" O.C.
 RAKE CHANNEL; 4" END LAPS WITH CONTINUOUS CAULK AT LAPS.
 1" EXPANDABLE FOAM CLOSURE WITH TAPE SEALER TOP AND BOTTOM
 SUB-FLASHING; 4" END LAPS WITH CONTINUOUS CAULK AT LAPS

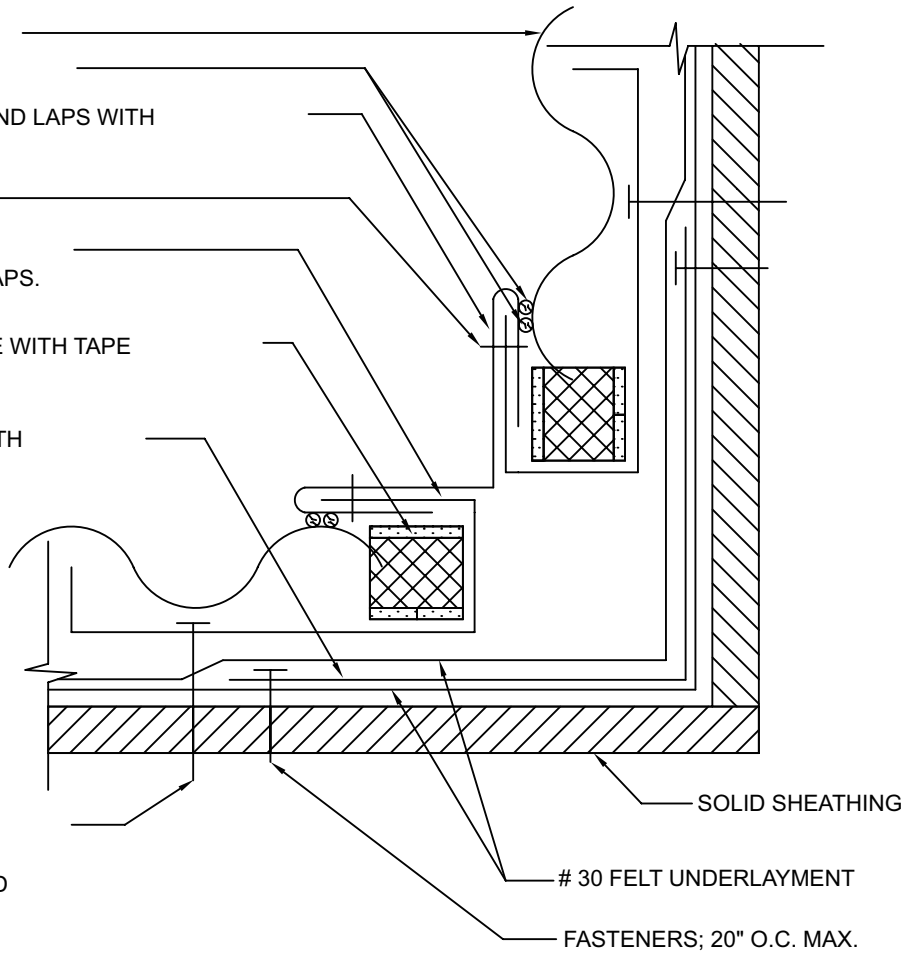

FASTENERS 20" O.C. PLACE A DAB OF CAULK AT FASTENER LOCATION DRIVE FASTENER AND CAULK FASTENER HEAD.

1. SOLID SHEATHING (BY OTHERS) TO BE MINIMUM 1/2" PLYWOOD OR EQUIVALENT IN STRENGTH FOR HOLDING POWER OF FASTENERS.
2. ALL FELT UNDERLAYMENT, CAULKING, AND FASTENERS, ARE ITEMS TO BE FURNISHED AND INSTALLED BY THE ROOFING INSTALLER AT THE DISCRETION OF THE ARCHITECT.

F = FINISH SIDE

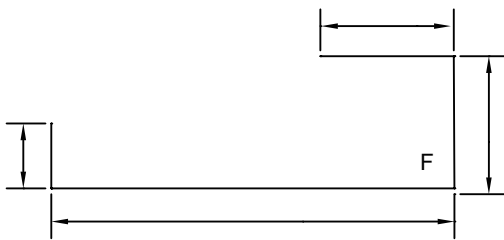

RAKE CHANNEL

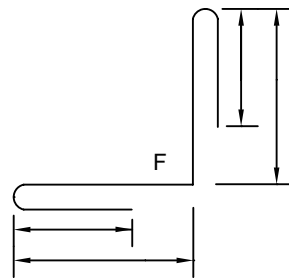

CORNER FLASHING

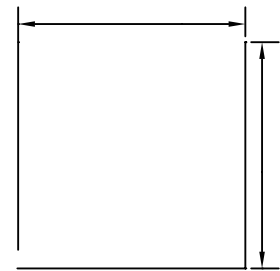

SUB-FLASHING



**BERRIDGE
 MANUFACTURING
 COMPANY**

Roofs of Distinction

**INSIDE CORNER
 SOLID SHEATHING**

S-Deck System

DATE: 11-20-00

PAGE/FILE
 SD-90

OUTSIDE CORNER FLASHING; 4" END LAPS WITH CONTINUOUS CAULK AT LAPS.

POP RIVET 20" O.C.

CONTINUOUS BEADS OF CAULK

BERRIDGE S-DECK PANEL

RAKE CHANNEL; 4" END LAPS WITH CONTINUOUS CAULK AT LAPS.

30 FELT UNDERLAYMENT

SUB-FLASHING; 4" END LAPS WITH CONTINUOUS CAULK AT LAPS

1" EXPANDABLE FOAM CLOSURE WITH TAPE SEALER TOP AND BOTTOM.

FASTENERS; 20" O.C. MAX.

FASTENERS; 20" O.C. PLACE A DAB OF CAULK AT FASTENER LOCATION DRIVE FASTENER AND CAULK FASTENER HEAD.

SOLID SHEATHING

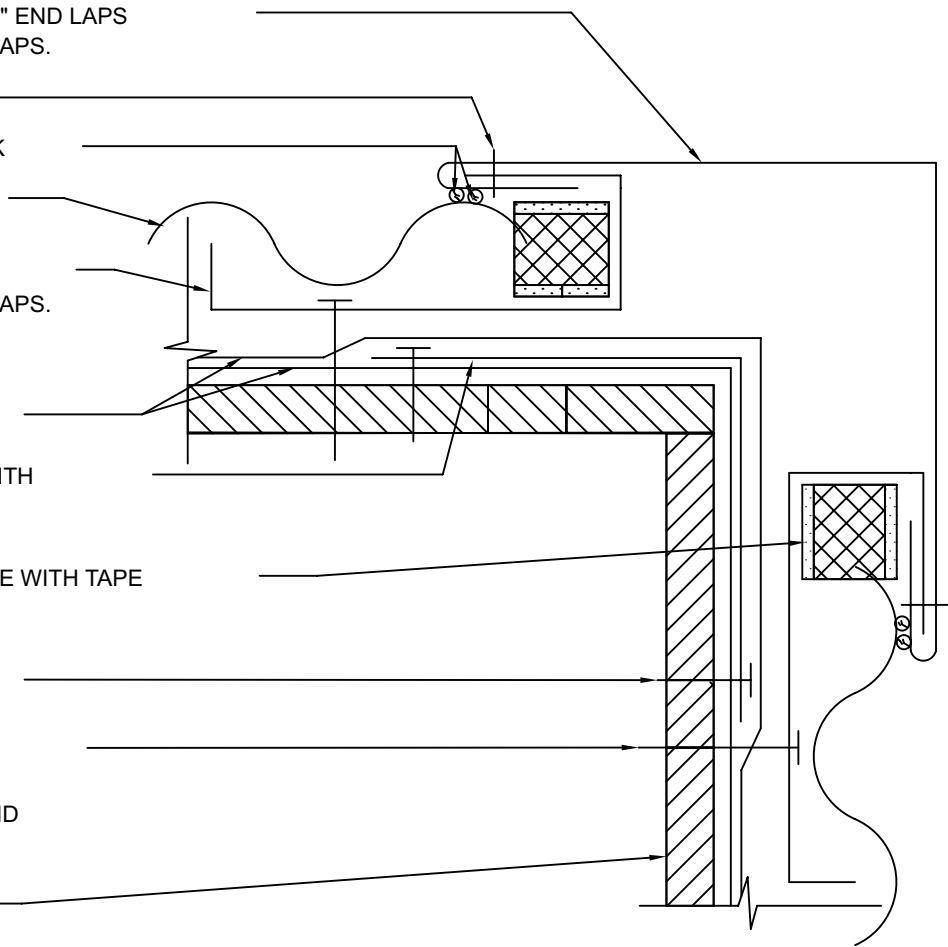

1. SOLID SHEATHING (BY OTHERS) TO BE MINIMUM 1/2" PLYWOOD OR EQUIVALENT IN STRENGTH FOR HOLDING POWER OF FASTENERS.

2. ALL FELT UNDERLAYMENT, CAULKING, AND FASTENERS, ARE ITEMS TO BE FURNISHED AND INSTALLED BY THE ROOFING INSTALLER AT THE DISCRETION OF THE ARCHITECT.

F = FINISH SIDE

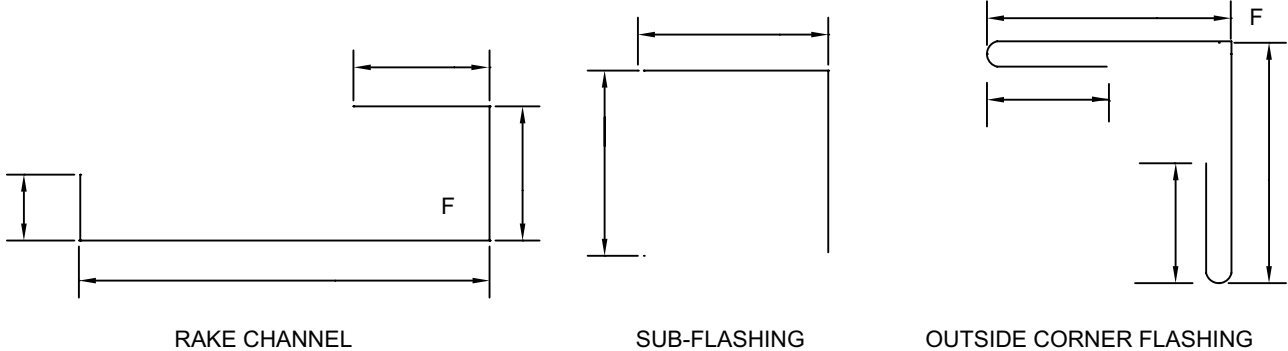

**BERRIDGE
MANUFACTURING
COMPANY**

Roofs of Distinction

**OUTSIDE CORNER
SOLID SHEATHING**

S-Deck System

DATE: 11-20-00

PAGE/FILE
SD-91

BERRIDGE S-DECK PANEL

CONTINUOUS BEADS OF CAULK

INSIDE CORNER FLASHING; 4" END LAPS WITH CONTINUOUS CAULK AT LAPS

POP RIVET 20" O.C.

RAKE CHANNEL; 4" END LAPS WITH CONTINUOUS CAULK AT LAPS

1" EXPANDABLE FOAM CLOSURE WITH TAPE SEALER TOP AND BOTTOM

SUB-FLASHING; 4" END LAPS WITH CONTINUOUS CAULK AT LAPS

PURLIN

FASTENERS; AT PURLINS

FASTENERS 20" O.C. PLACE A DAB OF CAULK AT FASTENER LOCATION DRIVE FASTENER AND CAULK FASTENER HEAD.

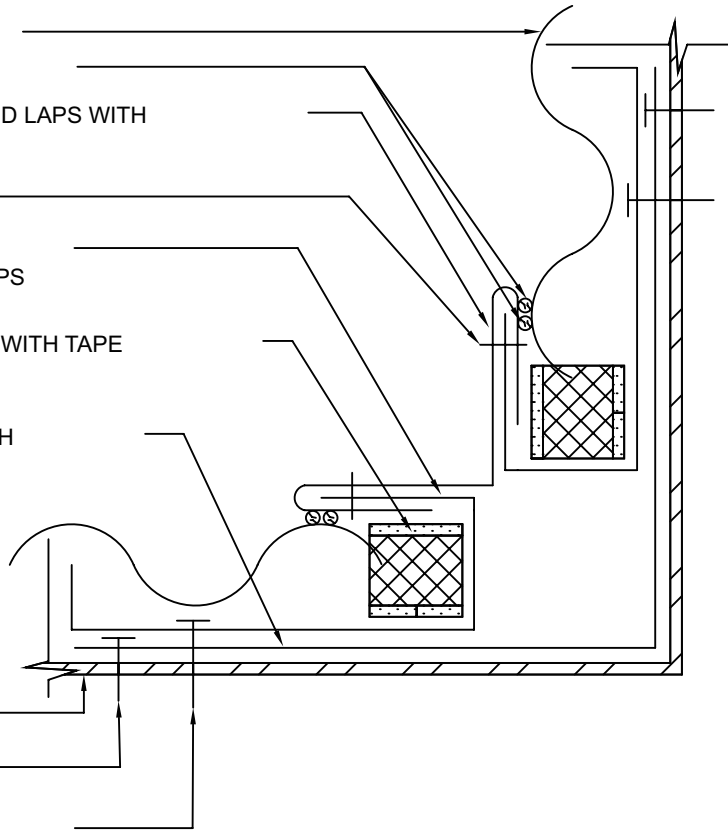

1. ALL CAULKING, AND FASTENERS, ARE ITEMS TO BE FURNISHED AND INSTALLED BY THE ROOFING INSTALLER AT THE DISCRETION OF THE ARCHITECT.

F = FINISH SIDE

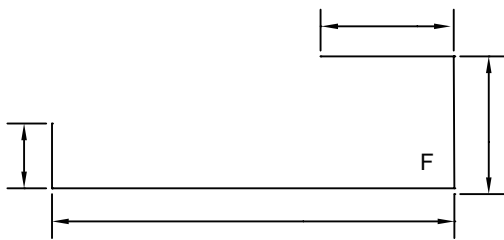

RAKE CHANNEL

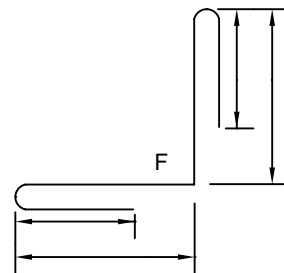

CORNER FLASHING

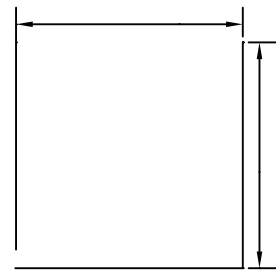

SUB-FLASHING



**BERRIDGE
MANUFACTURING
COMPANY**

Roofs of Distinction

**INSIDE CORNER
OPEN FRAMING**

S-Deck System

DATE: 11-20-00

PAGE/FILE
SD-92

OUTSIDE CORNER FLASHING; 4" END LAPS WITH CONTINUOUS CAULK AT LAPS

POP RIVET 20" O.C.

CONTINUOUS BEADS OF CAULK

BERRIDGE S-DECK PANEL

RAKE CHANNEL; 4" END LAPS WITH CONTINUOUS CAULK AT LAPS

FASTENERS AT PURLINS

FASTENERS; 20" O.C. PLACE A DAB OF CAULK AT FASTENER LOCATION DRIVE FASTENER AND CAULK FASTENER HEAD.

SUB-FLASHING; 4" END LAPS WITH CONTINUOUS CAULK AT LAPS

1" EXPANDABLE FOAM CLOSURE WITH TAPE SEALER TOP AND BOTTOM.

PURLIN

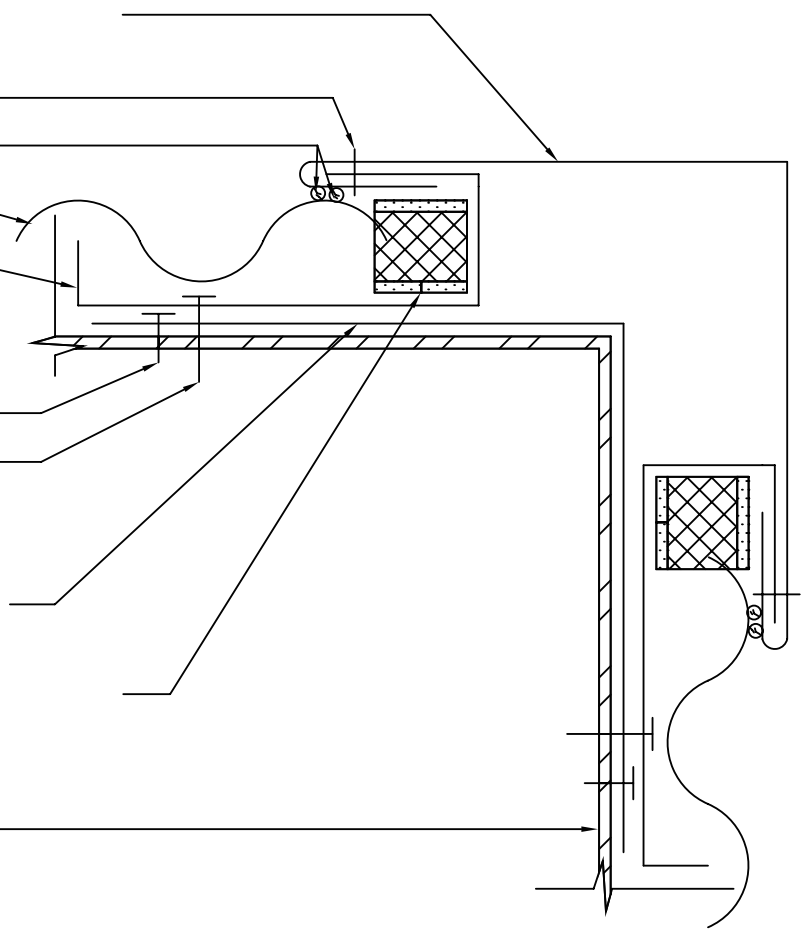

1. ALL CAULKING, AND FASTENERS, ARE ITEMS TO BE FURNISHED AND INSTALLED BY THE ROOFING INSTALLER AT THE DISCRETION OF THE ARCHITECT.

F = FINISH SIDE

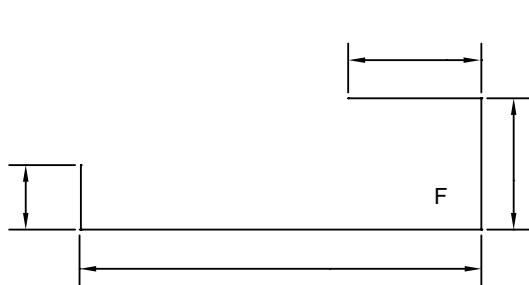

RAKE CHANNEL

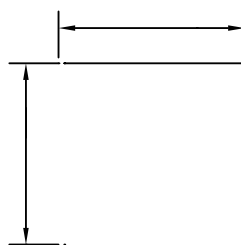

SUB-FLASHING

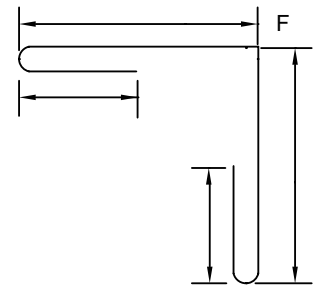

OUTSIDE CORNER FLASHING



**BERRIDGE
MANUFACTURING
COMPANY**

Roofs of Distinction

**OUTSIDE CORNER
OPEN FRAMING**

S-Deck System

DATE: 11-20-00

PAGE/FILE
SD-93

BERRIDGE S-DECK PANEL

INSIDE CORNER FLASHING;
4" END LAPS WITH
CONTINUOUS CAULK AT LAPS

OUTSIDE FOAM CLOSURE WITH TAPE
SEALER TOP AND BOTTOM.

FASTENERS; WITH METAL
BACKED NOEPRENE WASHER.
20" O.C.

BERRIDGE
S-DECK PANEL

FASTENERS; 20" O.C. MAX.

SUB-FLASHING; 4"
END LAPS WITH
CONTINUOUS CAULK AT LAPS

SOLID SHEATHING

30 FELT UNDERLAYMENT

FASTENERS; 20" O.C. MAX.

FASTENERS; WITH METAL
BACKED NOEPRENE WASHER.
20" O.C.

PANEL FASTENERS;
WITH METAL BACKED
NOEPRENE WASHER

PANEL FASTENERS;
WITH METAL BACKED
NOEPRENE WASHER

1. SOLID SHEATHING (BY OTHERS) TO BE MINIMUM 1/2" PLYWOOD OR EQUIVALENT IN STRENGTH FOR HOLDING POWER OF FASTENERS.
2. ALL FELT UNDERLAYMENT, CAULKING, AND FASTENERS, ARE ITEMS TO BE FURNISHED AND INSTALLED BY THE ROOFING INSTALLER AT THE DISCRETION OF THE ARCHITECT.

F = FINISH SIDE

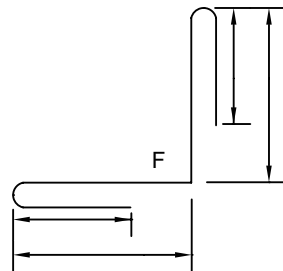

CORNER FLASHING

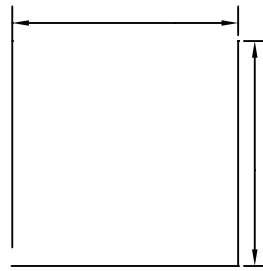

SUB-FLASHING



**BERRIDGE
MANUFACTURING
COMPANY**

**INSIDE CORNER
SOLID SHEATHING**

S-Deck System

DATE: 11-20-00

PAGE/FILE
SD-94

OUTSIDE CORNER FLASHING; 4" END LAPS WITH CONTINUOUS CAULK AT LAPS.

PANEL FASTENERS; WITH METAL BACKED NEOPRENE WASHER.

FASTENERS; WITH METAL BACKED NEOPRENE WASHER. 20" O.C.

BERRIDGE S-DECK PANEL

30 FELT UNDERLAYMENT

FASTENERS; 20" O.C. MAX.

SUB-FLASHING; 4" END LAPS WITH CONTINUOUS CAULK AT LAPS

OUTSIDE FOAM CLOSURE WITH TAPE SEALER TOP AND BOTTOM.

FASTENERS; WITH METAL BACKED NEOPRENE WASHER. 20" O.C.

FASTENERS; 20" O.C. MAX.

BERRIDGE S-DECK PANEL

SOLID SHEATHING

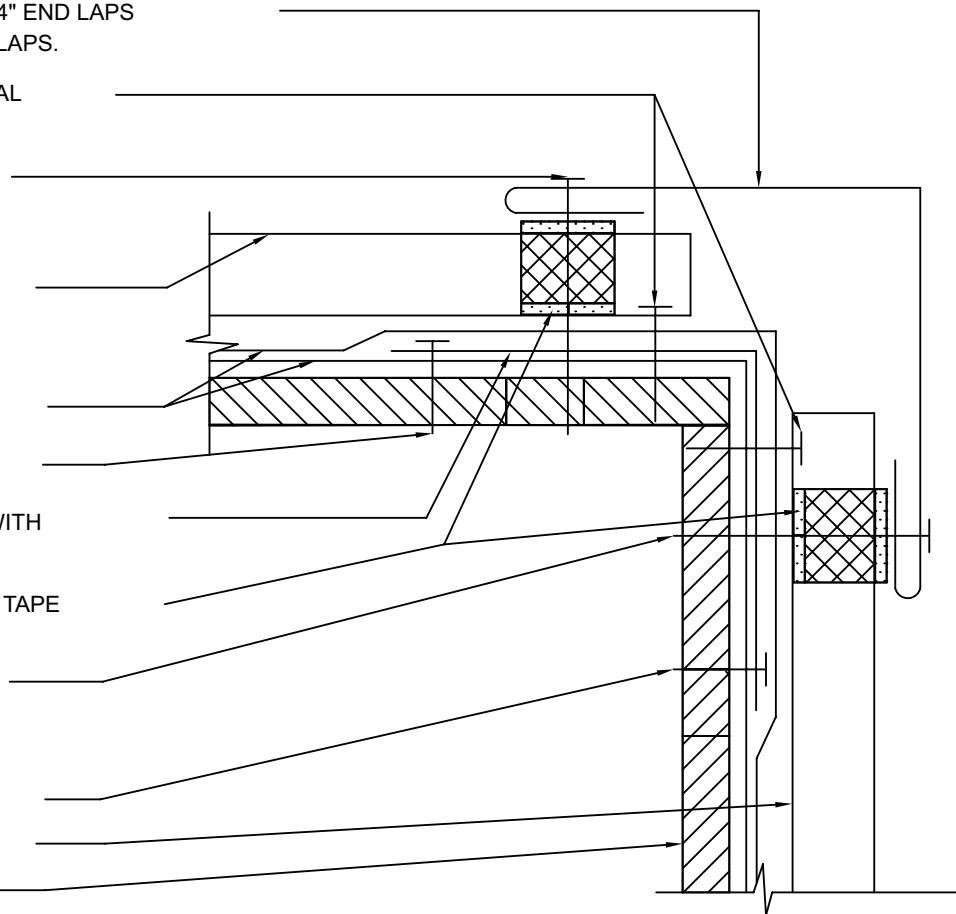

1. SOLID SHEATHING (BY OTHERS) TO BE MINIMUM 1/2" PLYWOOD OR EQUIVALENT IN STRENGTH FOR HOLDING POWER OF FASTENERS.

2. ALL FELT UNDERLAYMENT, CAULKING, AND FASTENERS, ARE ITEMS TO BE FURNISHED AND INSTALLED BY THE ROOFING INSTALLER AT THE DISCRETION OF THE ARCHITECT.

F = FINISH SIDE

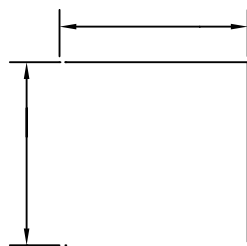

SUB-FLASHING

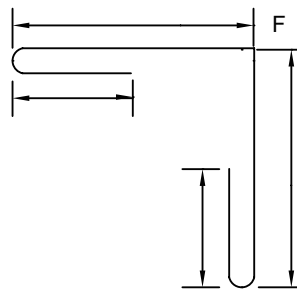

OUTSIDE CORNER FLASHING



**BERRIDGE
MANUFACTURING
COMPANY**

Roofs of Distinction

OUTSIDE CORNER SOLID SHEATHING

S-Deck System

DATE: 11-20-00

PAGE/FILE
SD-95

30 FELT UNDERLAYMENT

FASTENERS 20" O.C. MAX.

PANEL FASTENER WITH METAL BACKED NEOPRENE WASHER AT 5 1/2" O.C.

SOLID SHEATHING

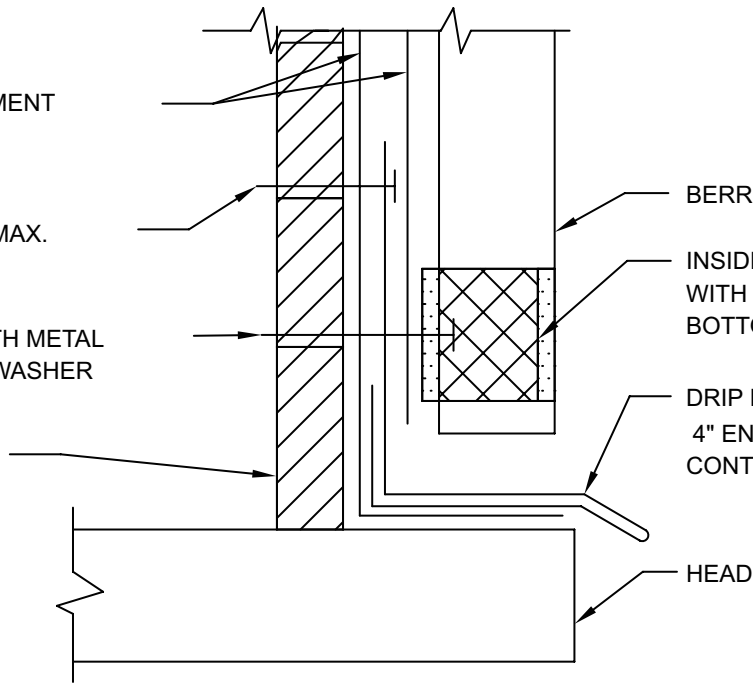

BERRIDGE S-DECK PANEL

INSIDE FOAM CLOSURE WITH TAPE SEALER TOP AND BOTTOM.

DRIP FLASHING 4" END LAPS WITH CONTINUOUS CAULK AT LAPS

HEAD

1. SOLID SHEATHING (BY OTHERS) TO BE MINIMUM 1/2" PLYWOOD OR EQUIVALENT IN STRENGTH FOR HOLDING POWER OF FASTENERS.
2. ALL FELT UNDERLAYMENT, CAULKING, AND FASTENERS, ARE ITEMS TO BE FURNISHED AND INSTALLED BY THE ROOFING INSTALLER AT THE DISCRETION OF THE ARCHITECT.

F = FINISH SIDE

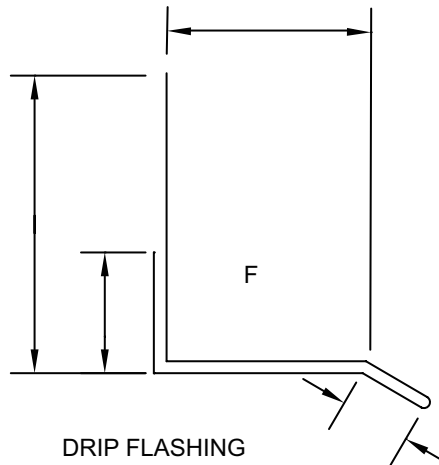

DRIP FLASHING



BERRIDGE
MANUFACTURING
COMPANY

**HEAD DETAIL
SOLID SHEATHING**

S-Deck System

DATE: 11-20-00

PAGE/FILE
SD-96

30 FELT UNDERLAYMENT

FASTENERS 20" O.C. MAX.

SOLID SHEATHING

PANEL FASTENER WITH METAL BACKED NEOPRENE WASHER AT 5 1/2" O.C.

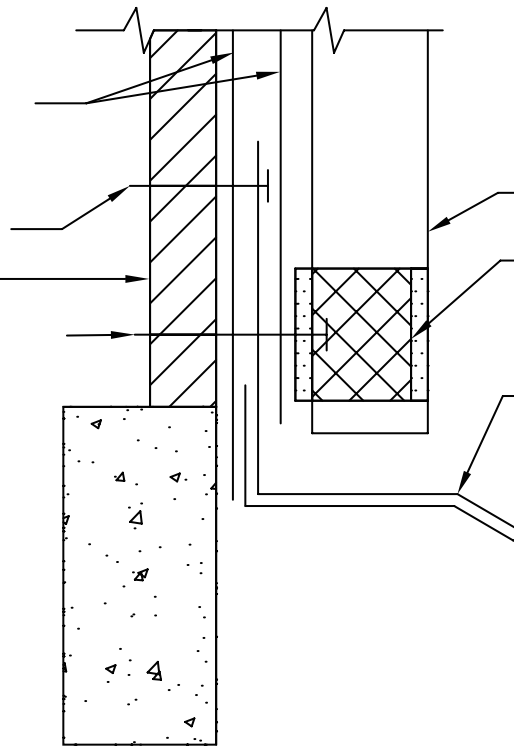

BERRIDGE S-DECK PANEL

INSIDE FOAM CLOSURE WITH TAPE SEALER TOP AND BOTTOM.

DRIP FLASHING
4" END LAPS WITH CONTINUOUS CAULK AT LAPS

1. SOLID SHEATHING (BY OTHERS) TO BE MINIMUM 1/2" PLYWOOD OR EQUIVALENT IN STRENGTH FOR HOLDING POWER OF FASTENERS.

2. ALL FELT UNDERLAYMENT, CAULKING, AND FASTENERS, ARE ITEMS TO BE FURNISHED AND INSTALLED BY THE ROOFING INSTALLER AT THE DISCRETION OF THE ARCHITECT.

F = FINISH SIDE

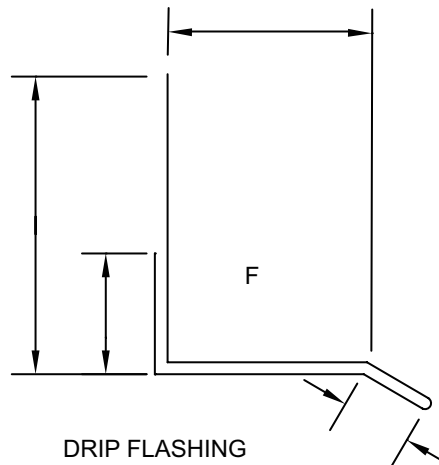

DRIP FLASHING



BERRIDGE
MANUFACTURING
COMPANY

**SLAB DETAIL
SOLID SHEATHING**

S-Deck System

DATE: 11-20-00

PAGE/FILE
SD-97

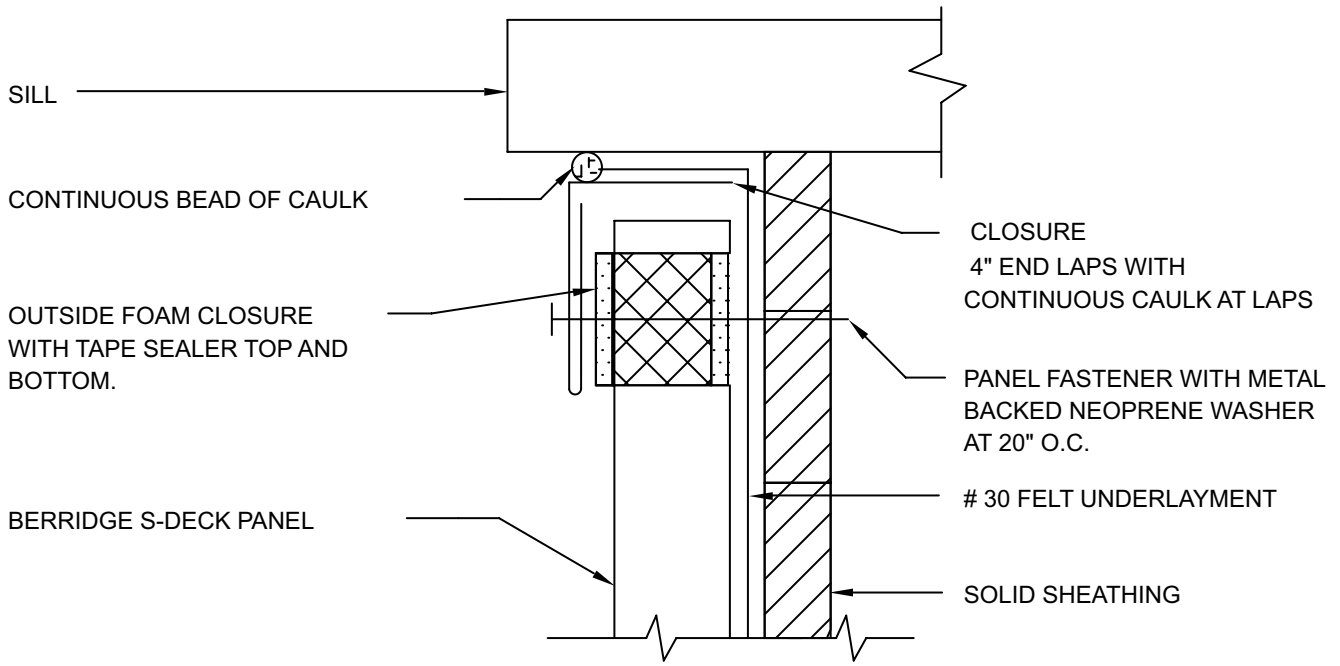

1. SOLID SHEATHING (BY OTHERS) TO BE MINIMUM 1/2" PLYWOOD OR EQUIVALENT IN STRENGTH FOR HOLDING POWER OF FASTENERS.
2. ALL FELT UNDERLAYMENT, CAULKING, AND FASTENERS, ARE ITEMS TO BE FURNISHED AND INSTALLED BY THE ROOFING INSTALLER AT THE DISCRETION OF THE ARCHITECT.

F = FINISH SIDE

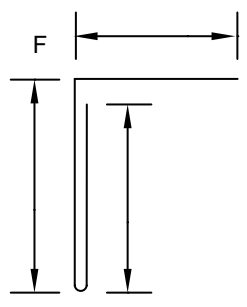

CLOSURE

BERRIDGE
MANUFACTURING
COMPANY
Roofs of Distinction

SILL DETAIL
SOLID SHEATHING

S-Deck System

DATE: 11-20-00

PAGE/FILE
 SD-98

FASTENER 20" O.C. PLACE
A DAB OF CAULK AT FASTENER
LOCATION DRIVE FASTENER AND
CAULK FASTENER HEAD

GABLE CHANNEL 4" END LAPS
WITH CONTINUOUS CAULK
AT LAPS

1" EXPANDABLE FOAM CLOSURE
WITH TAPE SEALER TOP AND
BOTTOM.

BERRIDGE S-DECK PANEL

CONTINUOUS BEAD OF CAULK

30 FELT
UNDERLAYMENT

JAMB

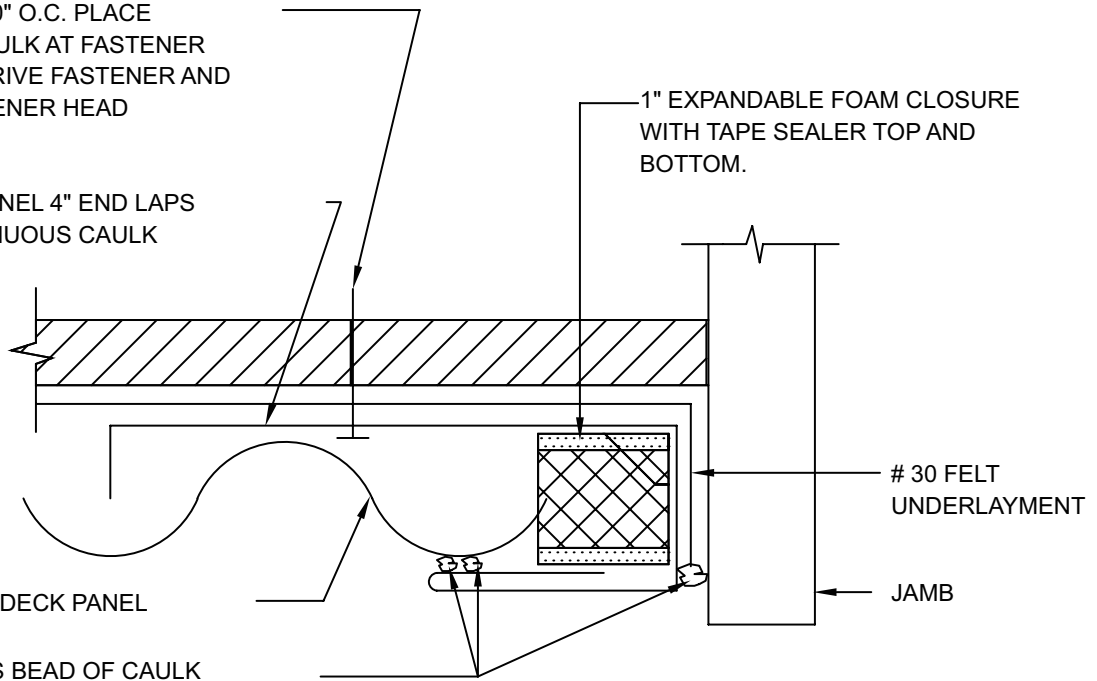

1. SOLID SHEATHING (BY OTHERS) TO BE MINIMUM 1/2" PLYWOOD OR EQUIVALENT IN STRENGTH FOR HOLDING POWER OF FASTENERS.

2. ALL FELT UNDERLAYMENT, CAULKING, AND FASTENERS, ARE ITEMS TO BE FURNISHED AND INSTALLED BY THE ROOFING INSTALLER AT THE DISCRETION OF THE ARCHITECT.

F = FINISH SIDE

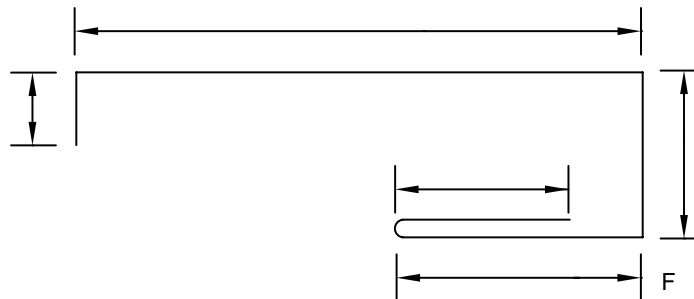

GABLE CHANNEL



**BERRIDGE
MANUFACTURING
COMPANY**

Roofs of Distinction

**JAMB DETAIL
SOLID SHEATHING**

S-Deck System

DATE: 11-20-00

PAGE/FILE
SD-99